

CONSTRUCT PAVED DRIVES		
LOCATION/TYPE	RADII STA/OFFSET	APPROX. WIDTH
STA 108+92 LT/ (C)	STA 108+57.16/42.00 FT STA 109+25.95/42.00 FT	24 FT

REMOVAL OF EXISTING FENCE  
 STA 104+19 - 104+51 LT (ABANDONED WOVEN WIRE)  
 STEEL BEAM GUARDRAIL, GALVANIZED  
 STA 104+00 - 104+38 LT  
 STA 105+38 - 105+88 LT  
 STA 105+38 - 105+88 RT

REMOVAL AND DISPOSAL OF GUIDE POSTS  
 STA 104+73 RT  
 STA 104+75 LT  
 STA 104+82 LT  
 STA 104+89 RT  
 STA 104+98 LT  
 STA 105+04 RT  
 STA 107+24 LT

SPECIAL PROVISION (REMOVE AND RESET COMMERCIAL SIGN)  
 STA 108+63 LT

SPECIAL PROVISION (HAND-PLACED BITUMINOUS CONCRETE MATERIAL, DRIVES)  
 STA 108+92 LT

MANUFACTURED TERMINAL SECTION, FLARED  
 STA 104+00 - 104+38 RT  
 STA 105+88 - 106+26 RT  
 STA 105+88 - 106+26 LT

STEEL BEAM GUARDRAIL, GALVANIZED/NESTED  
 STA 104+38 - 105+38 LT  
 STA 104+38 - 105+38 RT

REMOVE & REPLACE PROPERTY MARKERS	
EXISTING	PROPOSED
IP 108+61.90 52.83'RT	IP 108+62.14 48.05'RT
IP 109+21.75 53.00'RT	IP 109+22.26 47.21'RT

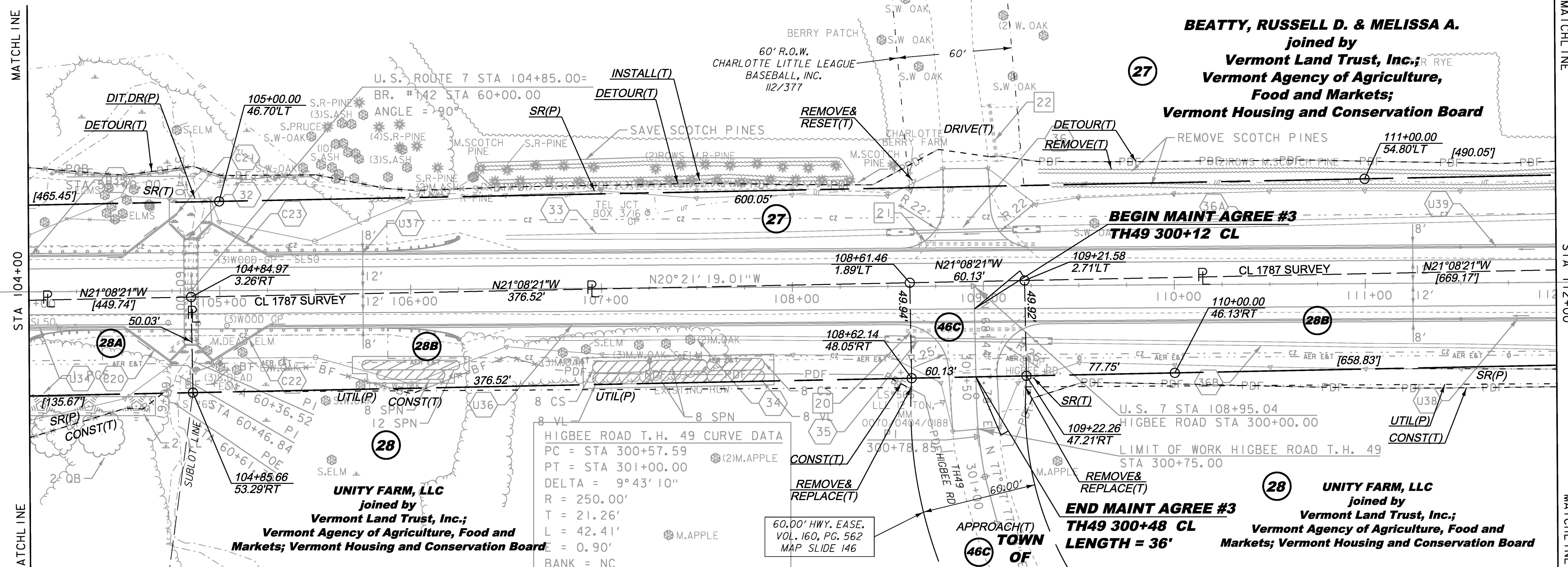
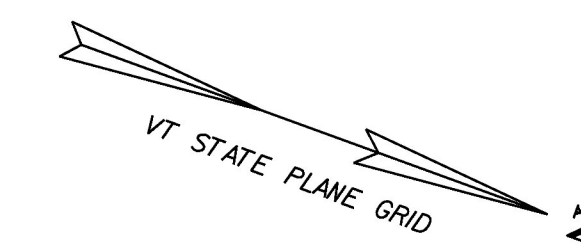

**BEATTY, RUSSELL D. & MELISSA A.**  
 joined by  
**Vermont Land Trust, Inc.;**  
**Vermont Agency of Agriculture, Food and Markets;**  
**Vermont Housing and Conservation Board**

**UNITY FARM, LLC**  
 joined by  
**Vermont Land Trust, Inc.;**  
**Vermont Agency of Agriculture, Food and Markets;**  
**Vermont Housing and Conservation Board**

**UNITY FARM, LLC**  
 joined by  
**Vermont Land Trust, Inc.;**  
**Vermont Agency of Agriculture, Food and Markets;**  
**Vermont Housing and Conservation Board**

**HIGBEE ROAD T.H. 49 CURVE DATA**  
 PC = STA 300+57.59  
 PT = STA 301+00.00  
 DELTA = 9°43'10"  
 R = 250.00'  
 T = 21.26'  
 L = 42.41'  
 E = 0.90'  
 BANK = NC

- |   |   |
|---|---|
| <p><b>EXISTING DRAINAGE</b></p> <ul style="list-style-type: none"> <li>20 STA 108+59 - 109+22 RT REMOVE EXISTING 18" CPEP</li> <li>21 STA 108+66 - 109+29 LT REMOVE EXISTING 18" CPEP &amp; HDW</li> <li>22 STA 109+08 LT RETAIN EXISTING 15" CGMP &amp; HDW (2)</li> </ul> <p><b>NEW DRAINAGE</b></p> <ul style="list-style-type: none"> <li>32 STA 104+85 BR #142 ANGLE = 90° NEW 6' X 7' X 56' PRECAST CONCRETE BOX W/ PRECAST HEADWALLS &amp; WINGWALLS STONE FILL TYPE II AT INLET &amp; OUTLET SEE BRIDGE DETAIL SHEETS</li> <li>34 STA 106+60 - 108+48 RT CONSTRUCT GRASS LINED TREATMENT SWALE SEE GRASS LINED TREATMENT SWALE DETAILS</li> <li>35 STA 108+64 - 109+20 RT NEW 18" X 56' CPEP W/STONE PAD AT INLET &amp; OUTLET</li> <li>36 STA 108+64 - 109+16 LT NEW 18" X 52' CPEP W/STONE PAD AT INLET &amp; OUTLET</li> <li>36A STA 109+20 - 112+00 LT CONSTRUCT GRASS LINED TREATMENT SWALE SEE GRASS LINED TREATMENT SWALE DETAILS</li> <li>36B STA 109+30 - 112+00 RT CONSTRUCT GRASS LINED TREATMENT SWALE SEE GRASS LINED TREATMENT SWALE DETAILS</li> </ul> | <p><b>NEW DRAINAGE</b></p> <ul style="list-style-type: none"> <li>U34 STA 104+00 - 104+50 RT NEW 8" X 50' UNDERDRAIN W/FLUSHING BASIN AT 100+00 RT</li> <li>U35 STA 104+00 - 104+50 LT NEW 8" X 50' UNDERDRAIN W/FLUSHING BASIN AT 100+00 LT</li> <li>U36 STA 105+25 - 111+50 RT NEW 8" X 625' UNDERDRAIN W/FLUSHING BASIN AT 111+50 RT</li> <li>U37 STA 105+25 - 111+50 LT NEW 8" X 625' UNDERDRAIN W/FLUSHING BASIN AT 111+50 LT</li> <li>U38 STA 109+22.26 47.21'RT</li> <li>U39 STA 111+50 - 112+00 LT NEW 8" X 50' UNDERDRAIN W/FLUSHING BASIN AT 118+00 LT</li> <li>C20 STA 104+50 - 104+75 RT NEW 8" X 32' UD CARRIER PIPE</li> <li>C21 STA 104+50 - 104+78 LT NEW 8" X 35' UD CARRIER PIPE</li> <li>C22 STA 104+95 - 105+25 RT NEW 8" X 35' UD CARRIER PIPE</li> <li>C23 STA 104+95 - 105+25 LT NEW 8" X 35' UD CARRIER PIPE</li> </ul> |
|---|---|

LINES SHOWN ON THIS PLAN AS EXISTING PROPERTY LINES P/L ARE BELIEVED TO BE ACCURATE BUT SHOULD NOT BE RELIED UPON FOR PURPOSES UNRELATED TO THE STATE OF VERMONT'S ACQUISITION OF LAND AND RIGHTS FOR THIS PROJECT.

**FOR R.O.W. USE ONLY**



PROJECT NAME: CHARLOTTE	FILE NAME: r78d062_lay13.dgn	PLOT DATE: 15-MAR-2016
PROJECT NUMBER: F EGC 019-4(20)	PROJECT LEADER: K. UPMAL	DRAWN BY: E. PIERCE
	DESIGNED BY: B. KIPP	CHECKED BY: E. PIERCE
	ROW LAYOUT SHEET 13 OF 20	SHEET 55 OF 499