

REMOVAL AND DISPOSAL OF GUIDE POSTS  
STA 78+49 LT

STONE FILL, TYPE II  
STA 75+30 - STA 75+50 LT  
STA 75+32 - STA 75+48 RT

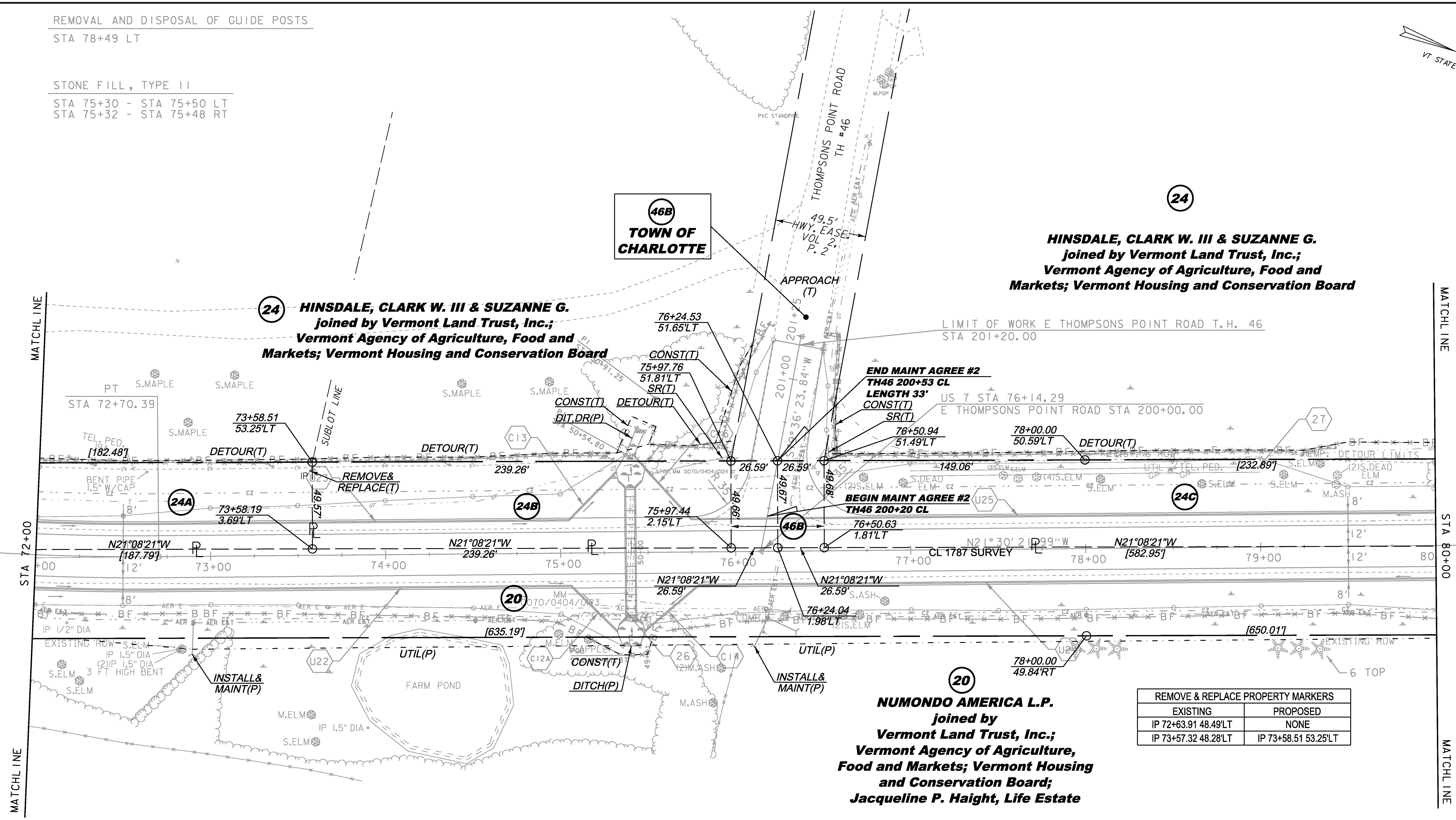
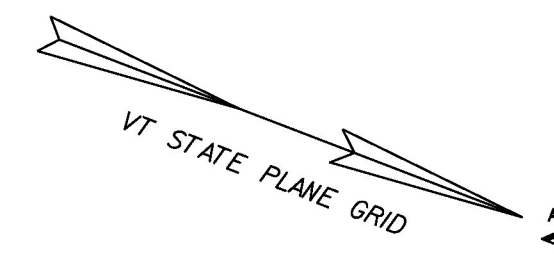

MATCHLINE  
STA 72+00  
MATCHLINE

MATCHLINE  
STA 80+00  
MATCHLINE

REMOVE & REPLACE PROPERTY MARKERS	
EXISTING	PROPOSED
IP 72+63.91 48.49'LT	NONE
IP 73+57.32 48.28'LT	IP 73+58.51 53.25'LT

- |   |   |   |
|---|---|---|
| <p><b>NEW DRAINAGE</b></p> <p>26 STA 75+40 C/L ANGLE = 90°00'00"<br/>NEW 5' X 3' X 74' PRECAST CONCRETE BOX<br/>W/PRECAST HEADWALLS &amp; WINGWALLS.<br/>STONE FILL TYPE II AT INLET &amp; OUTLET<br/>SEE DETAIL SHEETS<br/>REMOVE EXISTING 30" RCP &amp; HEADWALL</p> <p>27 STA 77+00 - 79+00 LT<br/>CONSTRUCT GRASS LINED TREATMENT SWALE<br/>SEE GRASS LINED TREATMENT SWALE DETAILS</p> | <p><b>8-INCH UNDERDRAIN</b></p> <p>U22 STA 72+00 - 75+06 RT<br/>NEW 8" X 306' UNDERDRAIN<br/>W/FLUSHING BASIN AT 68+00 RT</p> <p>U23 STA 72+00 - 75+05 LT<br/>NEW 8" X 305' UNDERDRAIN<br/>W/FLUSHING BASIN AT 68+00 LT</p> <p>U24 STA 75+79 - 80+00 RT<br/>NEW 8" X 421' UNDERDRAIN<br/>W/FLUSHING BASIN AT 80+00 RT</p> <p>U25 STA 75+75 - 80+00 LT<br/>NEW 8" X 425' UNDERDRAIN<br/>W/FLUSHING BASIN AT 80+00 LT</p> | <p><b>8-INCH UNDERDRAIN CARRIER PIPE</b></p> <p>C12A STA 75+11 - 75+32 RT<br/>NEW 8" X 37' UD CARRIER PIPE</p> <p>C13 STA 75+11 - 75+32 LT<br/>NEW 8" X 38' UD CARRIER PIPE</p> <p>C14 STA 75+48 - 75+79 RT<br/>NEW 8" X 41' UD CARRIER PIPE</p> <p>C15 STA 75+49 - 75+75 LT<br/>NEW 8" X 38' UD CARRIER PIPE</p> |
|---|---|---|

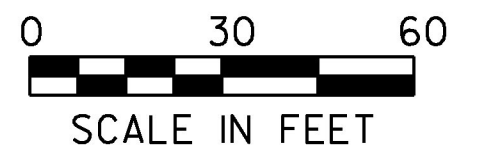

LINES SHOWN ON THIS PLAN AS EXISTING  
PROPERTY LINES P/L ARE BELIEVED TO  
BE ACCURATE BUT SHOULD NOT BE RELIED  
UPON FOR PURPOSES UNRELATED TO THE  
STATE OF VERMONT'S ACQUISITION OF LAND  
AND RIGHTS FOR THIS PROJECT.

PROJECT NAME: CHARLOTTE  
PROJECT NUMBER: F EGC 019-4(20)

FILE NAME: r78d062\_lay09.dgn  
PROJECT LEADER: K. UPMAL  
DESIGNED BY: B. KIPP  
ROW LAYOUT SHEET 9 OF 20

PLOT DATE: 15-MAR-2016  
DRAWN BY: E. PIERCE  
CHECKED BY: E. PIERCE  
SHEET 51 OF 499

THIS PROJECT SUBJECT TO STORMWATER  
PERMIT 3438-INDS

**FOR R.O.W.  
USE ONLY**