

# RIGHT - OF - WAY DETAIL SHEET

TABLE OF PROPERTY ACQUISITION

TABLE OF REVISIONS

PARCEL NO.	PROPERTY OWNER	SHEET NO.	BEGINNING STATION	ENDING STATION	TAKE	REMAINDER	RIGHT			RECORDING DATA					REMARKS
					AREA±	AREA±	TYPE	(T)/(P)	AREA ±	TITLE	DATE	TOWN / CITY	BOOK	PAGE	
40	THORNTON, MARY E.	30, 31	134+12.85 RT 134+31 RT 139+15.19 RT	139+16.10 RT  139+17.60 RT	0.57 A		ALL R. T. & I.			WD	05/07/15	CHARLOTTE	218	263-264	US RTE 7 HWY EASE.; 24,850 SF± GRAVEL DRIVE 14' MM 0235 IP
41	MAHONEY, ANDREW C. & GREEN, ANDREA E. HOYT, BRIAN A. & LINDA T.; LUNDE, KARYN D., TRUSTEE. KARYN D. LUNDE REVOCABLE TRUST	31, 32	139+15.19 RT 141+86 RT 143+76 RT 144+97 RT 144+99 RT	147+29.41 RT  146+11 RT 145+74 RT 145+72 RT	0.92 A		ALL R. T. & I.			WD	12/04/14	CHARLOTTE	216	67-69	US RTE 7 HWY EASE.; 39,900 SF± GRAVEL DRIVE 26' MM 0249 INCL. PDF SUBJECT TO STORMWATER PERMIT PLANT TREES
42	DELETED														
43	SIEDLECKI, JOHN HENRY & CONTRERAS, CARLA	32	147+27.68 RT 149+30 RT 149+40 RT 149+52 RT	150+07.37 RT 149+90 RT 149+99 RT 149+85 RT	0.32 A		ALL R. T. & I.			WD	11/07/14	CHARLOTTE	215	469-470	US RTE 7 HWY EASE.; 13,770 SF±  INCL. BF INCL. HEADWALL & STONE LINED DITCH AND UNDERDRAIN CARRIER PIPE
44	WHITE, ERIC J. & PENNY L.	15	12+54.38 RT 9+63 RT 12+59 RT 12+65 RT 13+24 RT 13+84.33 RT	13+87.53 RT  13+31 RT 13+15 RT 13+32 RT 13+99.30 RT	0.15 A		ALL R. T. & I.			WD	09/09/14	CHARLOTTE	215	16-17	US RTE 7 HWY EASE.; 6,540 SF± GRAVEL DRIVE 23' MM 0727 INCL. BF STONE LINED FENCE IP

REVISION NO.	SHEET NO.	DESCRIPTION	DATE

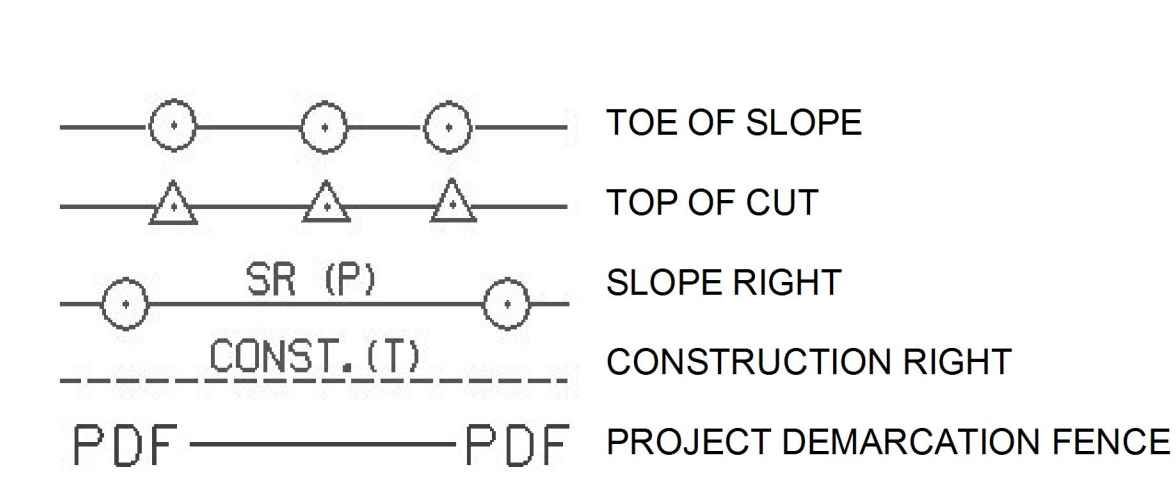
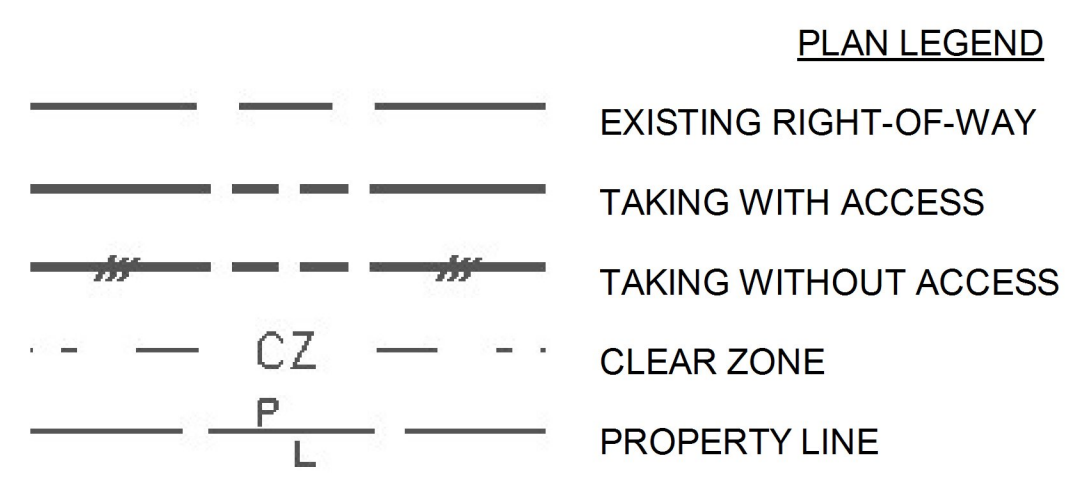

- EC -EROSION CONTROL
- (P) -PERMANENT
- (T) -TEMPORARY
- DR. -DRAINAGE RIGHT
- DIT. -DITCHING RIGHT
- CH. -CHANNEL RIGHT
- DRIVE -DRIVE RIGHT
- CUL. -CULVERT RIGHT
- BND -BOUND (PROPERTY MARKER)
- SR -SLOPE RIGHT
- UE -UTILITY EASEMENT

APPROVED: HARRY PETROVS DATE: 02-11-13  
CHIEF, PLANS & TITLES

PROJECT NAME: <b>CHARLOTTE</b>	PLOT DATE: 15-MAR-2016
PROJECT NUMBER: <b>FEGC 019-4(20)</b>	DRAWN BY: <b>M. TROTTIER</b>
FILE NAME: r78d062DetailSheet.xls	CHECKED BY: <b>E. PIERCE</b>
DESIGNED BY: <b>B. KIPP</b>	SHEET 40 OF 499
<b>R.O.W. DETAIL SHEET #9</b>	