

U.S. ROUTE 2
CABOT-DANVILLE
FO28 - 3(26)

SECTION 1

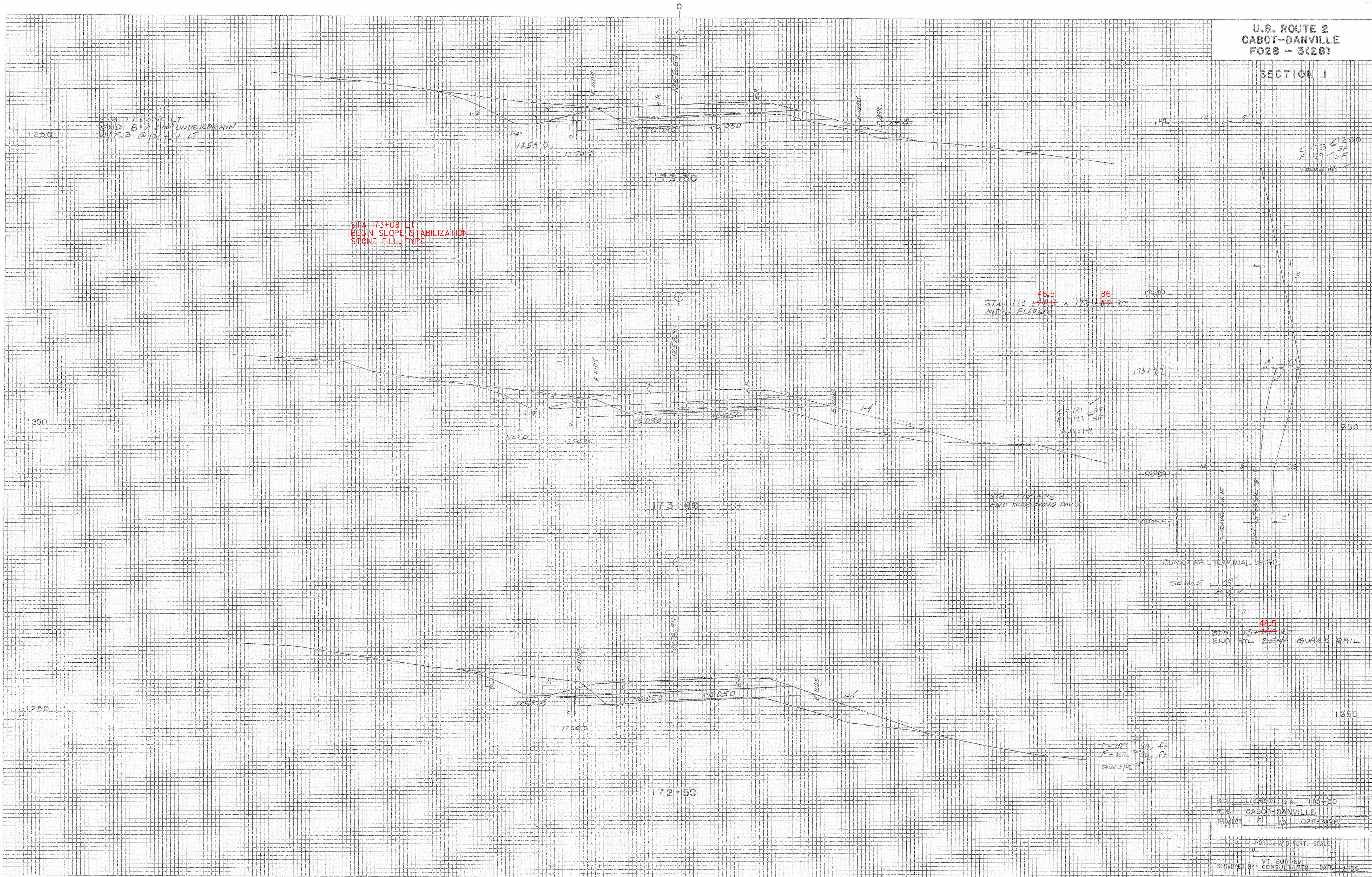

DATE: _____
BY: _____
SURVEYED: _____
DRAWN: _____
CHECKED: _____
PROJECT: _____
SHEET: _____

DATE: _____
BY: _____
SURVEYED: _____
DRAWN: _____
CHECKED: _____
PROJECT: _____
SHEET: _____

STA.	172+50	STA.	173+50
TOWN	CABOT-DANVILLE		
PROJECT	F. NO. 028-3(26)		
HORIZ. AND VERT. SCALE			
1" = 20'			
SURVEYED BY: V.I. SURVEY CONSULTANTS			
DATE: 4/96			

PLATE 3 CROSS SECTION 3 P. R. S. E. STANDARD
DETROIT CORPORATION

PROJECT NAME: CABOT-DANVILLE
PROJECT NUMBER: FECC F 028-3(26) C/1
FILE NAME: 78d058xs.dgn
PROJECT LEADER: K. ROBBE
DESIGNED BY: J. SHEA
MAINLINE CROSS SECTIONS 55
PLOT DATE: 06-OCT-2010
DRAWN BY: J. SHEA
CHECKED BY: S. MENARD
SHEET 187 OF 250