

**U.S. ROUTE 2
CABOT-DANVILLE
F028 - 3(26)**

SECTION 1

C = 120 SF
F = 110 SF
SHAD = 150

STA 165+50 RT
BEGIN SLOPE STABILIZATION
STONE FILL, TYPE II & GRUBBINGS

C = 164 SF
F = 148 SF
SHAD = 172

STA. 165+09 RT
END REMOVAL & DISPOSAL
OF EXIST. G.R.

C = 77 SF
F = 8 SF
SHAD = 123

STA.	165+00	STA.	166+00
TOWN	CABOT-DANVILLE		
PROJECT	F	NO.	028-3(26)
HORIZ. AND VERT. SCALE			
1" = 20'			
VT SURVEY			
SURVEYED BY: CONSULTANTS		DATE: 4/86	

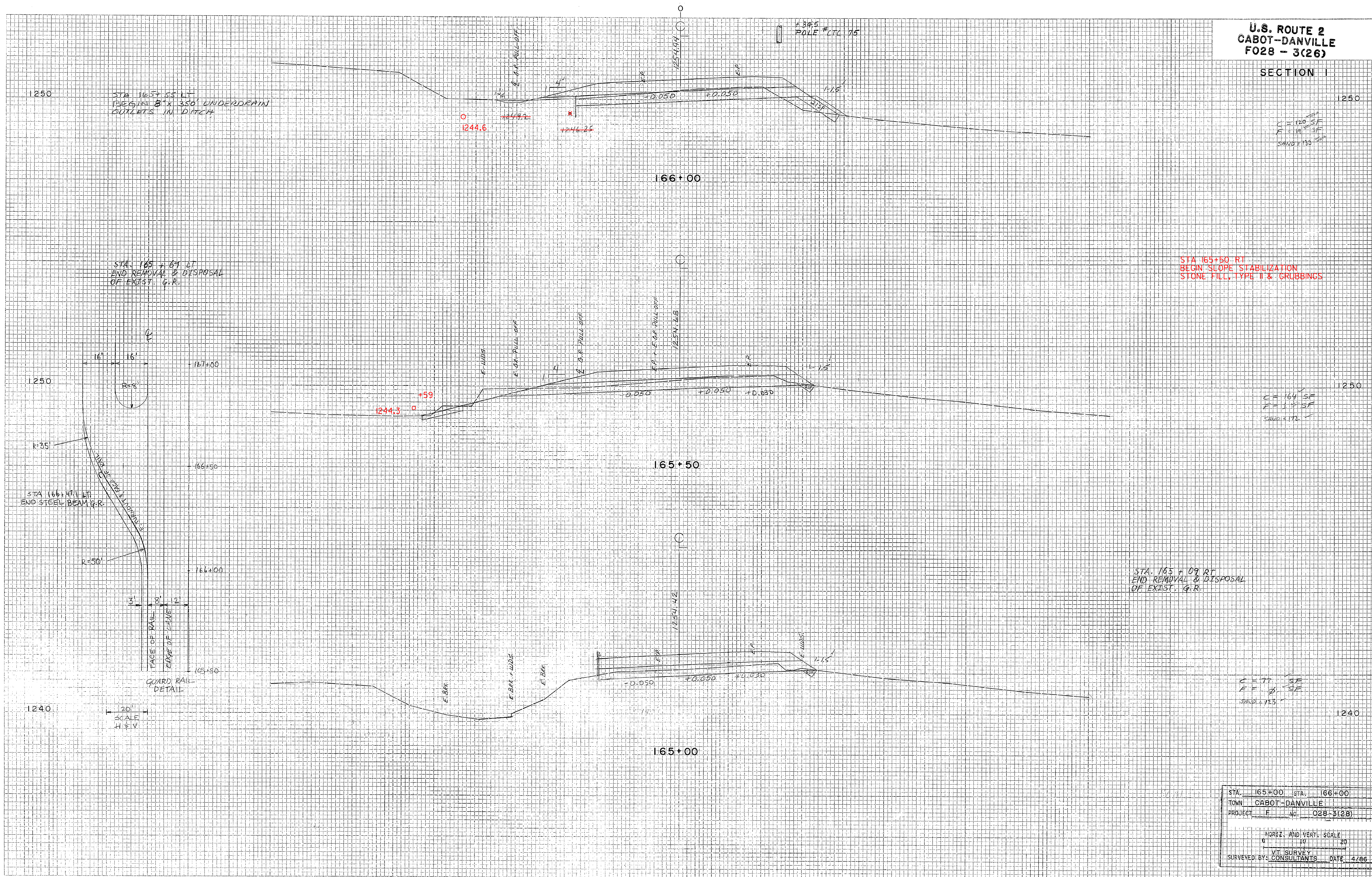

DATE	
BY	
SURVEYED	
NOTED	
AREA	
NO.	

DATE	
BY	
SURVEYED	
NOTED	
AREA	
NO.	

PLATE CROSS SECTION U. S. R. S. E. STANBARD
DRAWN BY CORPORATION

PROJECT NAME: CABOT-DANVILLE
PROJECT NUMBER: FECC F 028-3(26) C/1
FILE NAME: 78d058xs.dgn
PROJECT LEADER: K. ROBBE
DESIGNED BY: I. SHEA
MAINLINE CROSS SECTIONS 49
PLOT DATE: 06-OCT-2010
DRAWN BY: I. SHEA
CHECKED BY: S. MENARD
SHEET 181 OF 250