

U.S. ROUTE 2  
CABOT-DANVILLE  
F028 - 3(26)

SECTION 1

DATE	
BY	
SURVEYED	
NOTE BOOK	
NO.	

DATE	4/86
BY	
SURVEYED	
NOTE BOOK	
NO.	

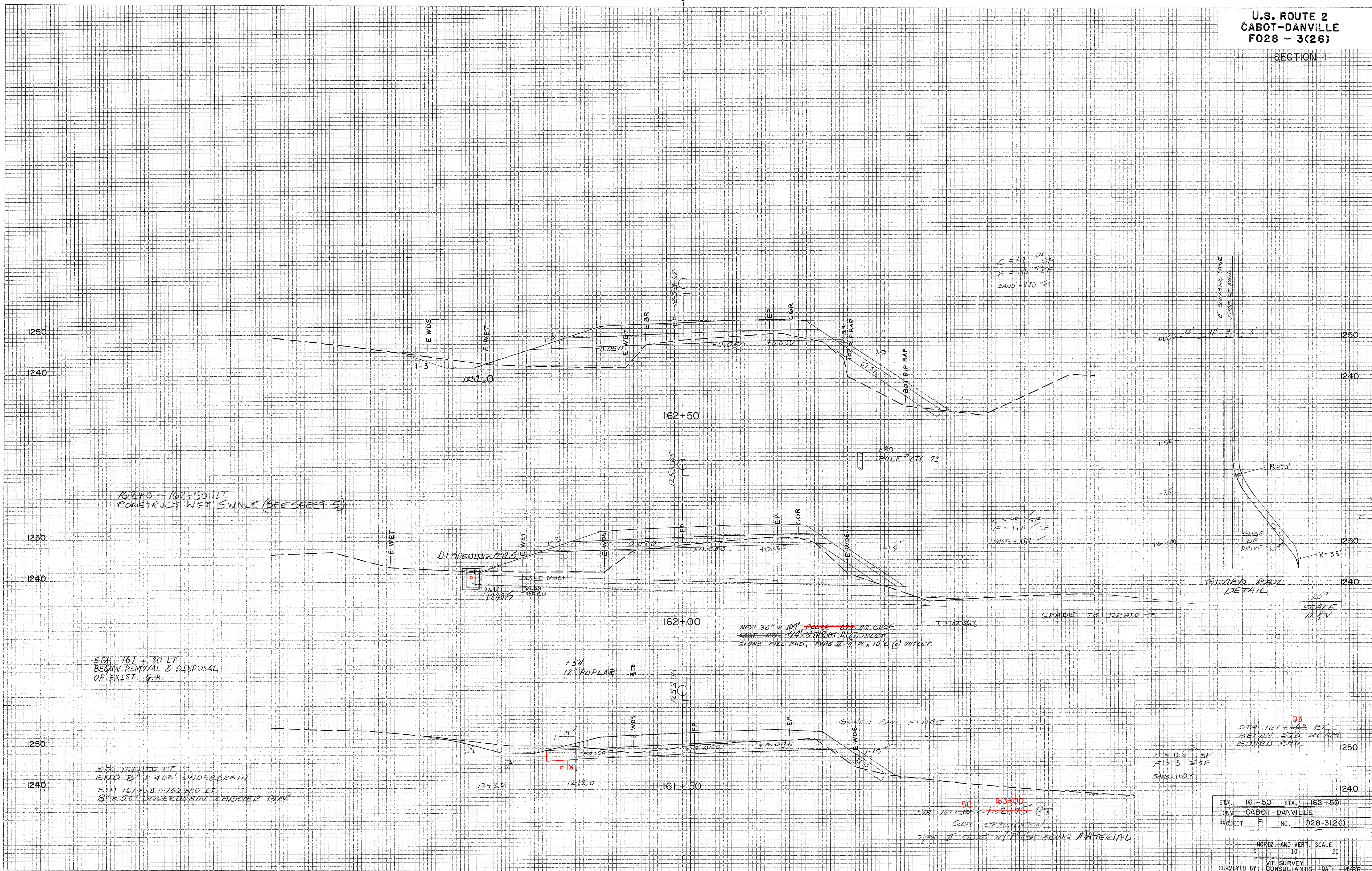

162+0 ~ 162+50 LT.  
CONSTRUCT WET SWALE (SEE SHEET 5)

STA. 161+80 LT.  
BEGIN REMOVAL & DISPOSAL  
OF EXIST. G.R.

STA. 161+50 LT.  
END 8" x 40" UNDERDRAIN  
STA. 161+50 ~ 162+00 LT.  
8" x 50" UNDERDRAIN CARRIER PIPE

NEW 30" x 104" POCCP 879 DR CREP  
SAND 1026 1/4" THROAT DI @ INLET  
STONE FILL PAD, TYPE II 4" x 10' L @ OUTLET

50 163+00  
SM 111.30 x 102.97 LT  
SLOPE 5% TO 1%  
TYPE II SILT WITH SPREADING MATERIAL

STA.	161+50	STA.	162+50
TOWN	CABOT-DANVILLE		
PROJECT	F No. 028-3(26)		
HORIZ. AND VERT. SCALE			
DI	10'	20'	
V.T. SURVEY			
SURVEYED BY: CONSULTANTS DATE: 4/86			

PLATE 3 CROSS SECTION C. P. R. S. C. STANDARD  
SHEETON CORPORATION

PROJECT NAME:	CABOT-DANVILLE	PLOT DATE:	06-OCT-2010
PROJECT NUMBER:	FEGC F 028-3(26) C/1	DRAWN BY:	I. SHEA
FILE NAME:	78d058xs.dgn	DESIGNED BY:	I. SHEA
PROJECT LEADER:	K. ROBBE	CHECKED BY:	S. MENARD
MAINLINE CROSS SECTIONS 46		SHEET	178 OF 250