

**U.S. ROUTE 2
CABOT-DANVILLE
F028 - 3(26)**

SECTION 1

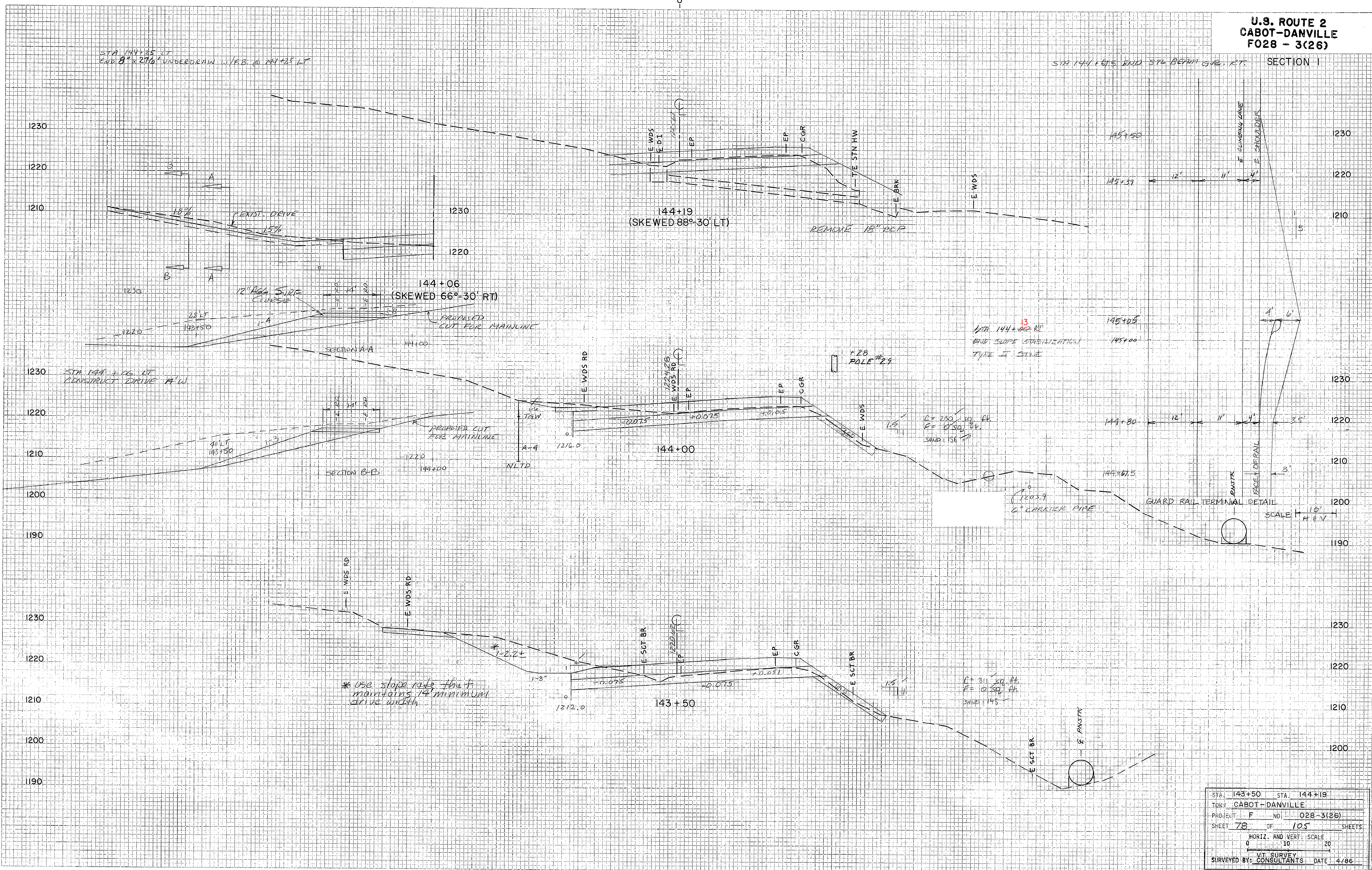

DATE	
BY	
REVISIONS	
NO.	DESCRIPTION
1	
2	
3	
4	
5	
6	
7	
8	
9	
10	
11	
12	
13	
14	
15	
16	
17	
18	
19	
20	
21	
22	
23	
24	
25	
26	
27	
28	
29	
30	
31	
32	
33	
34	
35	
36	
37	
38	
39	
40	
41	
42	
43	
44	
45	
46	
47	
48	
49	
50	
51	
52	
53	
54	
55	
56	
57	
58	
59	
60	
61	
62	
63	
64	
65	
66	
67	
68	
69	
70	
71	
72	
73	
74	
75	
76	
77	
78	
79	
80	
81	
82	
83	
84	
85	
86	
87	
88	
89	
90	
91	
92	
93	
94	
95	
96	
97	
98	
99	
100	

DATE	
BY	
REVISIONS	
NO.	DESCRIPTION
1	
2	
3	
4	
5	
6	
7	
8	
9	
10	
11	
12	
13	
14	
15	
16	
17	
18	
19	
20	
21	
22	
23	
24	
25	
26	
27	
28	
29	
30	
31	
32	
33	
34	
35	
36	
37	
38	
39	
40	
41	
42	
43	
44	
45	
46	
47	
48	
49	
50	
51	
52	
53	
54	
55	
56	
57	
58	
59	
60	
61	
62	
63	
64	
65	
66	
67	
68	
69	
70	
71	
72	
73	
74	
75	
76	
77	
78	
79	
80	
81	
82	
83	
84	
85	
86	
87	
88	
89	
90	
91	
92	
93	
94	
95	
96	
97	
98	
99	
100	

STA: 143+50	STA: 144+19
TOWN: CABOT-DANVILLE	
PROJECT: F	NO. 028-3(26)
SHEET: 78	OF 105 SHEETS
HORIZ. AND VERT. SCALE	
0 10 20	
V.T. SURVEY CONSULTANTS	
DATE: 4/86	

PLATE 2 CROSS SECTION 1 OF 10 P. R. & R. E. STANDARD
DIVERSION CORPORATION

PROJECT NAME:	CABOT-DANVILLE
PROJECT NUMBER:	FEGC F 028-3(26) C/1
FILE NAME:	78d058xs.dgn
PROJECT LEADER:	K. ROBBE
DESIGNED BY:	I. SHEA
MAINLINE CROSS SECTIONS 33	
PLOT DATE:	06-OCT-2010
DRAWN BY:	I. SHEA
CHECKED BY:	S. MENARD
SHEET	165 OF 250