

U.S. ROUTE 2  
CABOT-DANVILLE  
F028 - 3(26)

SECTION 1

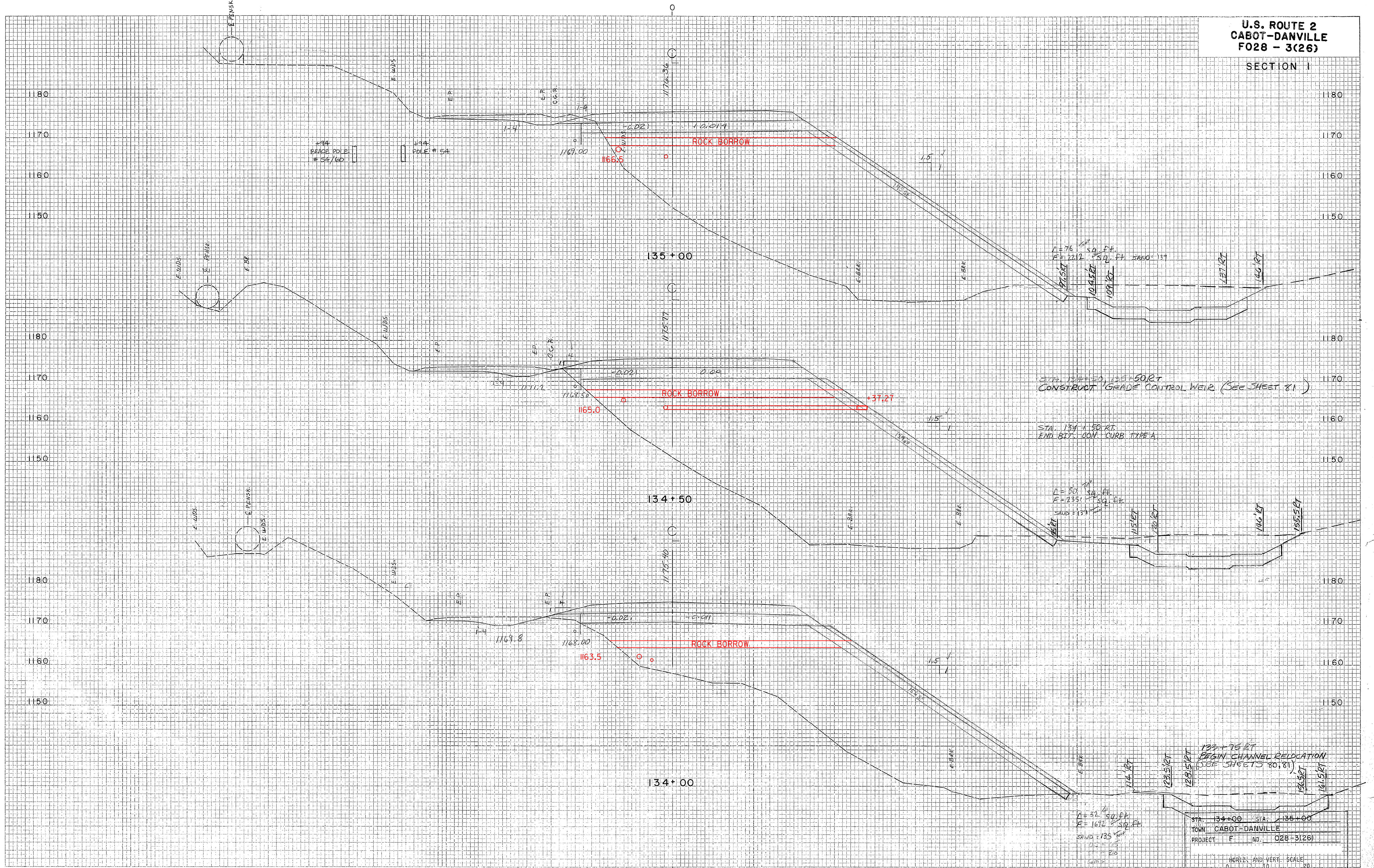

STA. 134+50 RT  
CONSTRUCT GRADE CONTROL WEIR (SEE SHEET 81)

STA. 134+50 RT  
END BIT. CON. CURB TYPE A

D = 30' SQ. FT.  
F = 235' SQ. FT.  
SLOPE = 13.9%

133+75 RT  
BEGIN CHANNEL RELOCATION  
(SEE SHEETS 80, 81)

STA. 134+00 STA. 136+00  
TOWN CABOT-DANVILLE  
PROJECT F (NO. 028-3(26))

HORIZ. AND VERT. SCALE  
1" = 20'  
SURVEYED BY: CONSULTANTS DATE 4/86

DATE	
BY	
SURVEYED	
NOTE BOOK	
NO.	

DATE	
BY	
SURVEYED	
NOTE BOOK	
NO.	

PLATE 3 CROSS SECTION OF R. & R. STANDARD  
CROSS SECTION

PROJECT NAME:	CABOT-DANVILLE
PROJECT NUMBER:	FEGC F 028-3(26) C/1
FILE NAME:	78d058xs.dgn
PROJECT LEADER:	K. ROBBE
DESIGNED BY:	I. SHEA
MAINLINE CROSS SECTIONS	26
PLOT DATE:	06-OCT-2010
DRAWN BY:	I. SHEA
CHECKED BY:	S. MENARD
SHEET	158 OF 250