

**U.S. ROUTE 2
CABOT-DANVILLE
FO28 - 3(26)**

SECTION 1

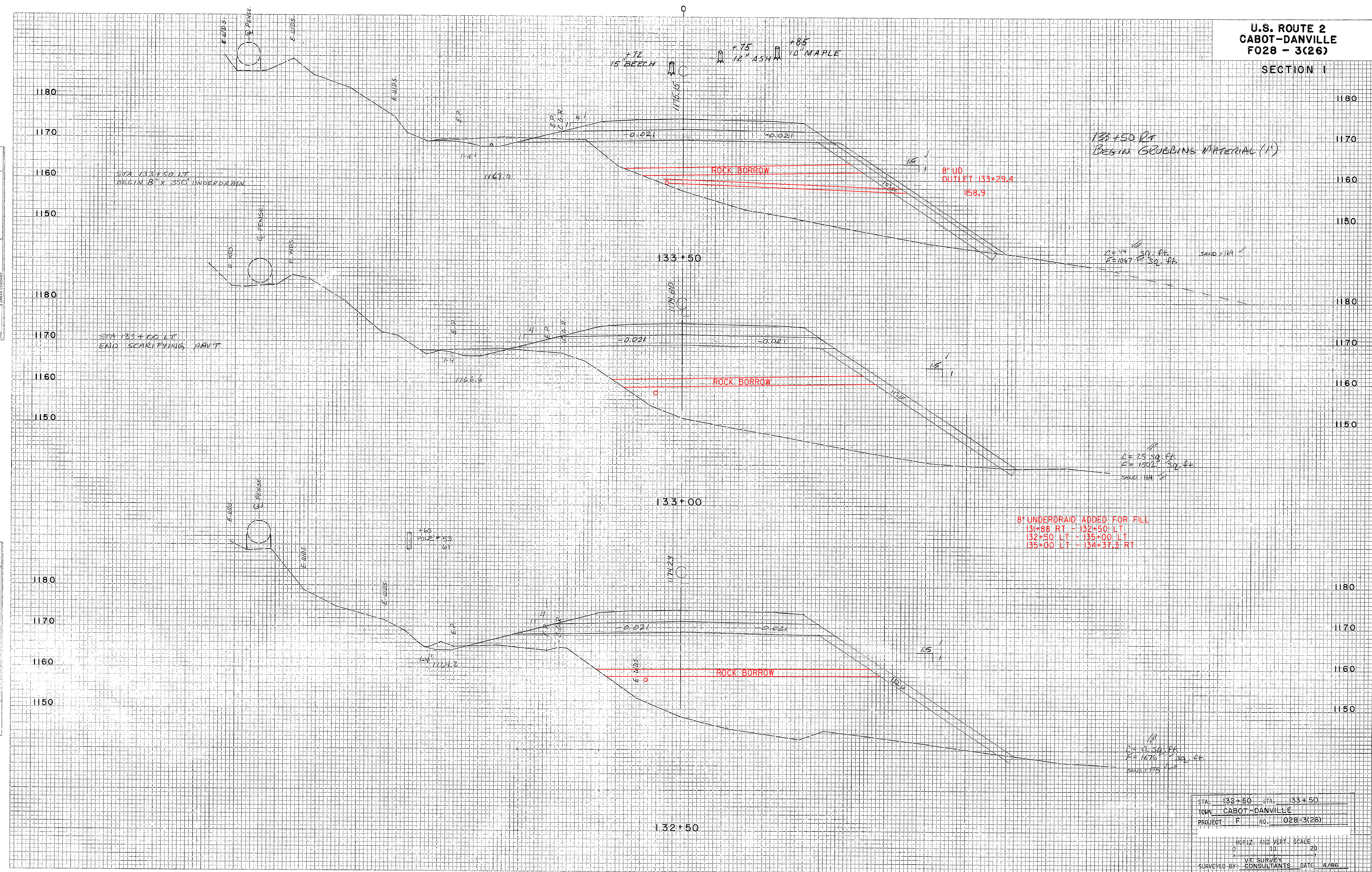

DATE: _____
BY: _____
SURVEYED: _____
DRAWN: _____
CHECKED: _____
NO. _____

DATE: _____
BY: _____
SURVEYED: _____
DRAWN: _____
CHECKED: _____
NO. _____

STA. 132+50	STA. 133+50
TOWN CABOT-DANVILLE	
PROJECT F NO. 028-3(26)	
HORIZ. AND VERT. SCALE 1" = 10'	
SURVEYED BY: _____ DATE: 4/86	

PLATE 3 GROSS SECTION O.P.R.A.R.E. STANDARD
DETROIT CORPORATION

PROJECT NAME: CABOT-DANVILLE
PROJECT NUMBER: FEGC F 028-3(26) C/1
FILE NAME: 78d058xs.dgn
PROJECT LEADER: K. ROBBE
DESIGNED BY: I. SHEA
MAINLINE CROSS SECTIONS 25
PLOT DATE: 06-OCT-2010
DRAWN BY: I. SHEA
CHECKED BY: S. MENARD
SHEET 157 OF 250