

U.S. ROUTE 2  
CABOT-DANVILLE  
F028 - 3(26)

SECTION 1

DATE: \_\_\_\_\_  
BY: \_\_\_\_\_  
SURVEYED: \_\_\_\_\_  
FINAL SURVEY NOTE BOOK TEMPLATE AREAS CHECKED NO. \_\_\_\_\_

DATE: 11/16/06  
BY: K. ROBB  
SURVEYED: \_\_\_\_\_  
ORIGINAL SURVEY NOTE BOOK TEMPLATE AREAS CHECKED NO. \_\_\_\_\_

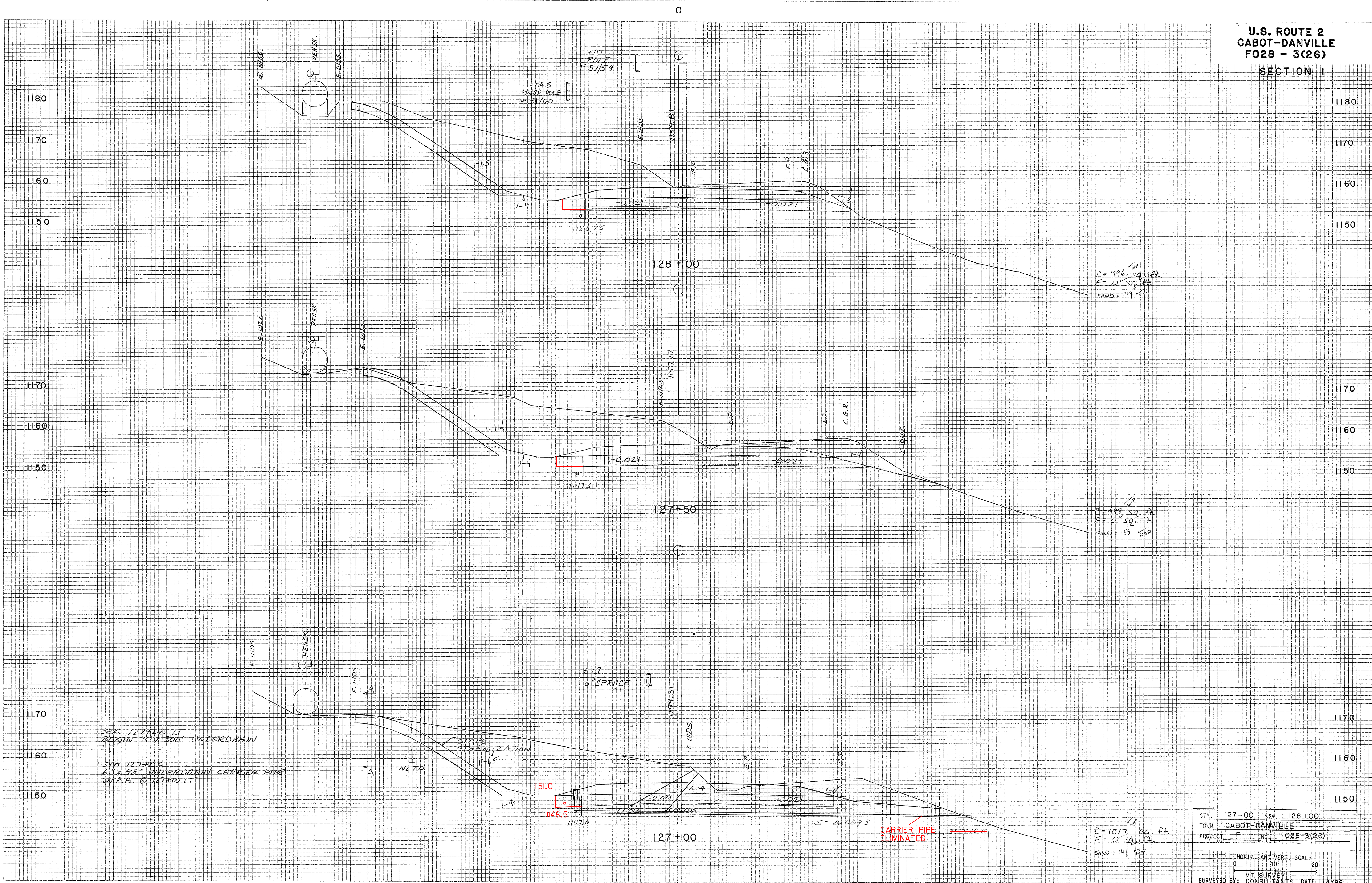

STA 127+00 LT.  
BEGIN 4" X 300' UNDERDRAIN

STA 127+00  
6" X 30' UNDERDRAIN CARRIER PIPE  
W/F.B. @ 127+00 LT.

STA.	127+00	S.P.	128+00
TOWN	CABOT-DANVILLE		
PROJECT	F	NO.	028-3(26)
HORIZ. AND VERT. SCALE			
0 10 20			
VIT. SURVEY			
SURVEYED BY: CONSULTANTS DATE 4/86			

PLATE 2 CROSS SECTION 2, P. 2, 6 P. 6 STANDARD  
DET. CORPORATION

PROJECT NAME: CABOT-DANVILLE  
PROJECT NUMBER: FECC F 028-3(26) C/1  
FILE NAME: 78d058xs.dgn  
PROJECT LEADER: K. ROBB  
DESIGNED BY: I. SHEA  
MAINLINE CROSS SECTIONS 21  
PLOT DATE: 06-OCT-2010  
DRAWN BY: I. SHEA  
CHECKED BY: S. MENARD  
SHEET 153 OF 250