

U.S. ROUTE 2  
CABOT-DANVILLE  
F028 - 3(26)

SECTION I

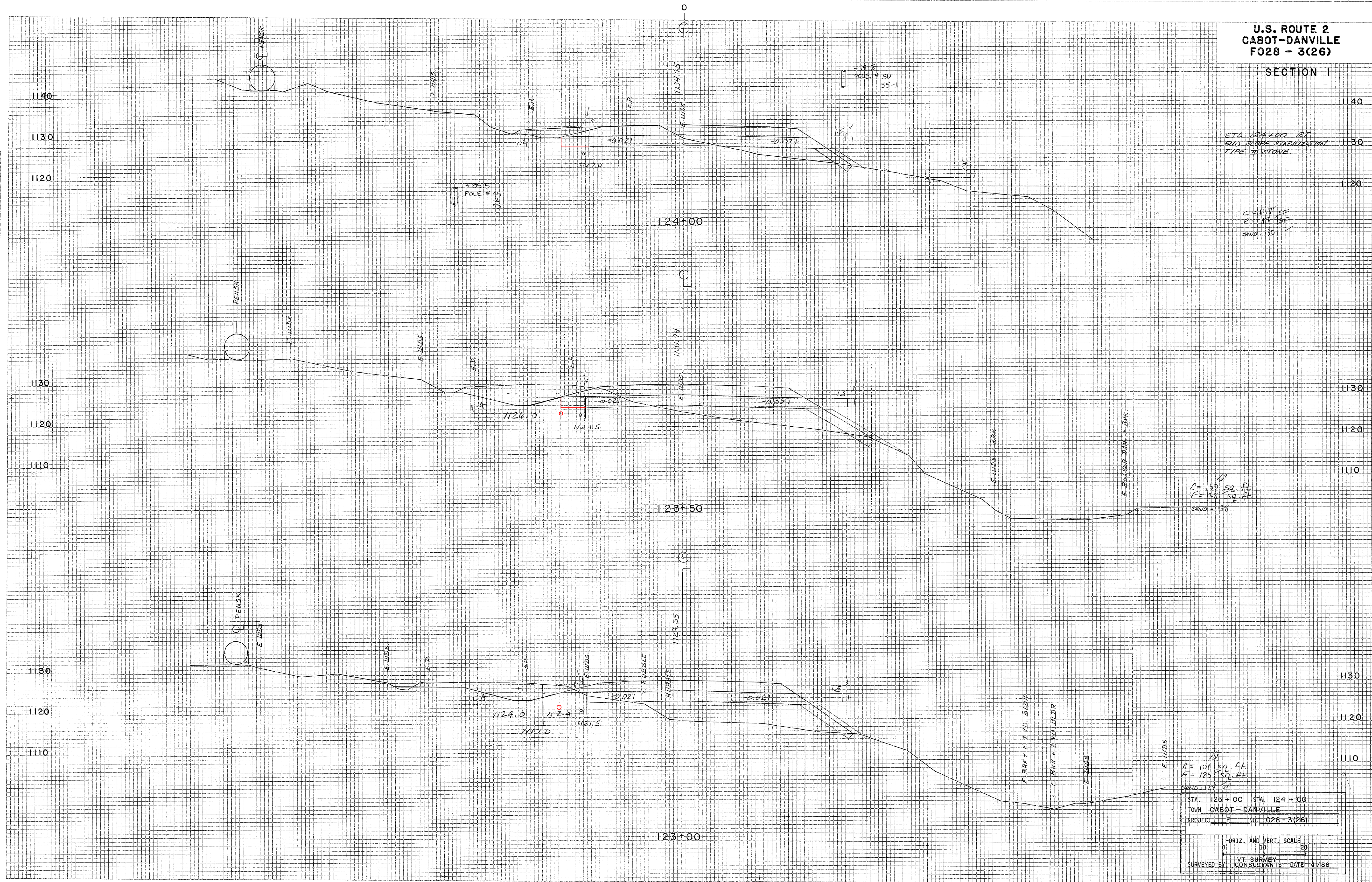

STA 124+00 RT  
END SLOPE STABILIZATION  
TYPE II STONE

C=147 SF  
F=147 SF  
SAND=130

R=50 SQ. FT.  
F=128 SQ. FT.  
SAND=136

R=101 SQ. FT.  
F=185 SQ. FT.  
SAND=126

STA. 123+00 STA. 124+00  
TOWN CABOT-DANVILLE  
PROJECT F NO. 028-3(26)

HORIZ. AND VERT. SCALE  
0 10 20  
VT SURVEY  
SURVEYED BY: CONSULTANTS DATE 4/86

FINAL SURVEY NOTE BOOK NO. \_\_\_\_\_

ORIGINAL SURVEY NOTE BOOK NO. 3502

PLATE 3 CROSS SECTION D.P.S. & R.E. STANDARD

PROJECT NAME: CABOT-DANVILLE  
PROJECT NUMBER: FECC F 028-3(26) C/1  
FILE NAME: 78d058xs.dgn  
PROJECT LEADER: K. ROBBE  
DESIGNED BY: I. SHEA  
MAINLINE CROSS SECTIONS 1B  
PLOT DATE: 06-OCT-2010  
DRAWN BY: I. SHEA  
CHECKED BY: S. MENARD  
SHEET 150 OF 250