

U.S. ROUTE 2
CABOT-DANVILLE
F028 - 3(26)

SECTION 1

DATE: _____
BY: _____
SURVEYED: _____
NOTE BOOK: _____
NO. _____

DATE: 4/16/86
BY: I. SHEA
SURVEYED: _____
NOTE BOOK: _____
NO. _____

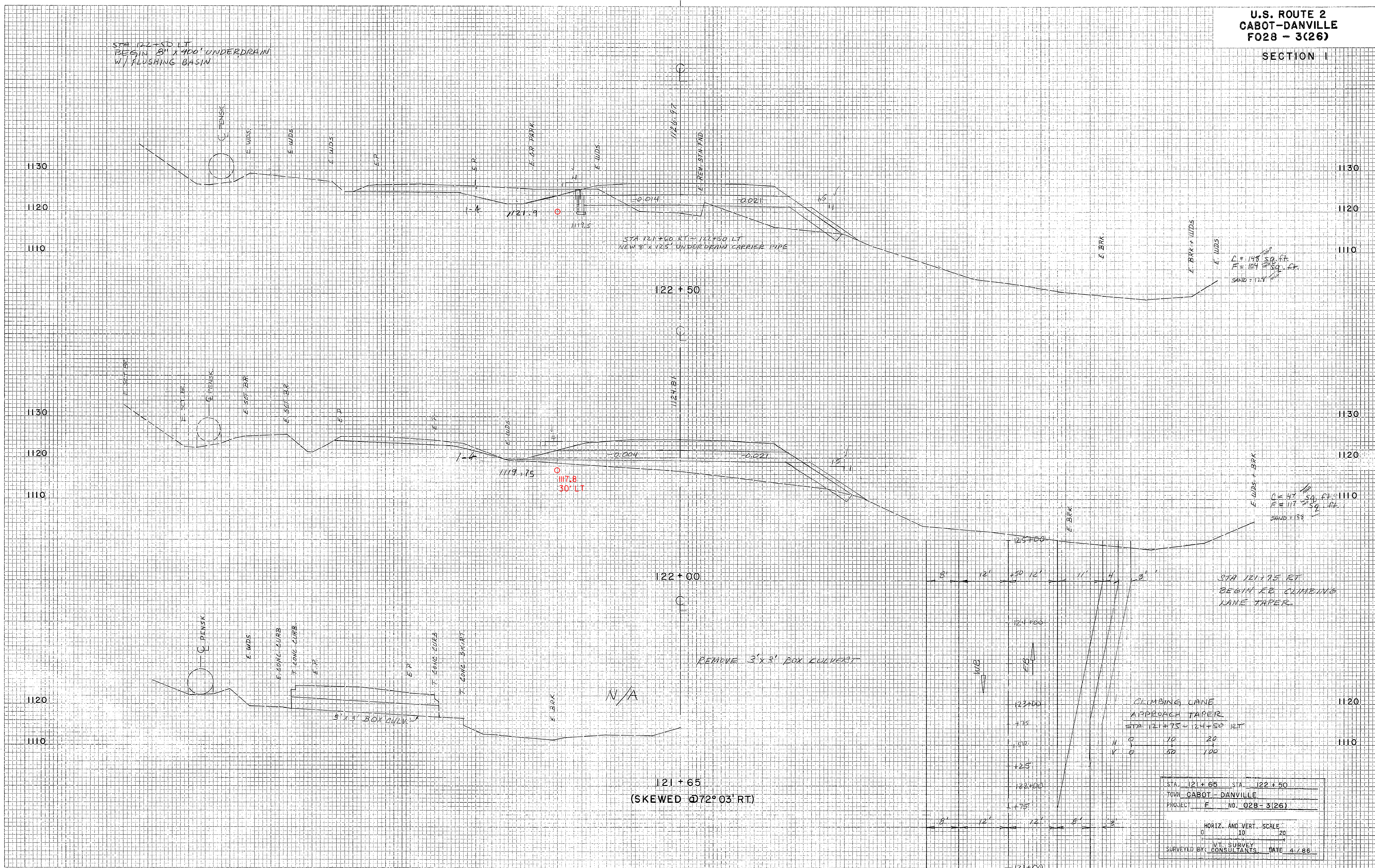

$C = 148$ SQ. FT.
 $F = 104$ SQ. FT.
SAND = 12.4

$C = 47$ SQ. FT.
 $F = 117$ SQ. FT.
SAND = 18

CLIMBING LANE
APPROACH TAPER
STA 121+75 = 121+50 RT

H	0	10	20
V	0	50	100

STA	121+65	STA	122+50
TOWN	CABOT-DANVILLE		
PROJECT	F NO. 028-3(26)		

HORIZ. AND VERT. SCALE
0 10 20
V.T. SURVEY
SURVEYED BY: I. SHEA
CONSULTANTS: DATE 4/86

PROJECT NAME: CABOT-DANVILLE
PROJECT NUMBER: FECC F 028-3(26) C/1
FILE NAME: 78d058xs.dgn
PROJECT LEADER: K. ROBBE
DESIGNED BY: I. SHEA
MAINLINE CROSS SECTIONS 16
PLOT DATE: 06-OCT-2010
DRAWN BY: I. SHEA
CHECKED BY: S. MENARD
SHEET 148 OF 250