

REINFORCED eARTH®

8614 Westwood Center Drive, Vienna, VA 22182 (703) 821-1175

PRECAST PANEL SHOP DRAWINGS

PANEL GENERAL NOTES

- REINFORCING BARS FOR PRECAST FACING PANELS SHALL BE STEEL ASTM A615 GRADE 60 (AASHTO M31) AND BE EPOXY COATED.
* #4 COPING DOWELS SHALL BE EPOXY COATED *
- REINFORCING BARS FOR PRECAST COPING UNITS SHALL BE STEEL ASTM A615 GRADE 60. (AASHTO M31) EPOXY COATED.
- TIE STRIPS SHALL BE ASTM A1011 (FORMERLY A-570) GRADE 50, 10 GAUGE THICKNESS, GALVANIZED AS PER ASTM A-123 OR A-153.
- ALL FRONT EDGES OF PANELS, EXCEPT THE BOTTOM EDGE OF THE BOTTOM PANEL COURSE, SHALL HAVE A 3/8" CHAMFER.
- TIE STRIPS SHALL BE PLACED WITHIN 1" OF THE DIMENSIONS SHOWN ON THE FABRICATION DRAWINGS.
- PANEL DESIGN THICKNESS IS 5 1/2" PLUS 1 1/2" ARCHITECTURAL FINISH. THE 28 DAY COMPRESSIVE STRENGTH OF CONCRETE SHALL BE 5000 psi AND BE IN ACCORDANCE WITH PROJECT SPECIAL PROVISIONS ITEM 900.670 AND VTAOT SPECIFICATIONS SECTION 540.
- DIMENSIONS SPECIFIED ON INDIVIDUAL FABRICATION DRAWINGS SUPERCEDE THOSE CALLED OUT ON THE STANDARD SECTIONS AND DETAILS.
- VERTICAL REINFORCING BARS SHALL BE PLACED 1 1/2" MIN. - 2" (TYP.) CLEAR FROM THE BACK FACE OF THE 5 1/2" PANEL.
- ALL REINFORCING BARS SHALL BE STOPPED 2" CLEAR FROM ANY EDGE OF PANEL UNLESS NOTED ON INDIVIDUAL FABRICATION DRAWING OR AS INDICATED IN NOTE #9.
- IN ALL SLOPED PANELS THE TWO (2) VERTICAL REINFORCING BARS ADJACENT TO A COMMON TIE STRIP SHALL BE OF THE SAME LENGTH.
- ALL INDIVIDUAL FABRICATION DRAWINGS ARE SHOWN BACK FACE.
- PRECAST FACING PANELS FOR R.E WALLS SHALL HAVE AN ASHLAR STONE FORM LINER FINISH.
SLIP JOINT COVERS SHALL HAVE A SMOOTH FORM FINISH.
PRECAST COPING AND HALF CONNECTOR UNITS SHALL HAVE A SMOOTH FORM FINISH.

PANEL GENERAL NOTES (CONT.)

- REINFORCING BARS IN A STANDARD "A" PANEL SHALL BE AS FOLLOWS:

PIECE MARK	PANEL REINFORCEMENT	
	HORIZONTAL BARS	VERTICAL BARS
XX-XX-R6	4-#4	6-#3

HORIZONTAL REINFORCEMENT IN THE OTHER PANEL TYPES IS PROPORTIONAL TO THEIR RELATIVE HEIGHT.

- KEY TO PIECE MARK:

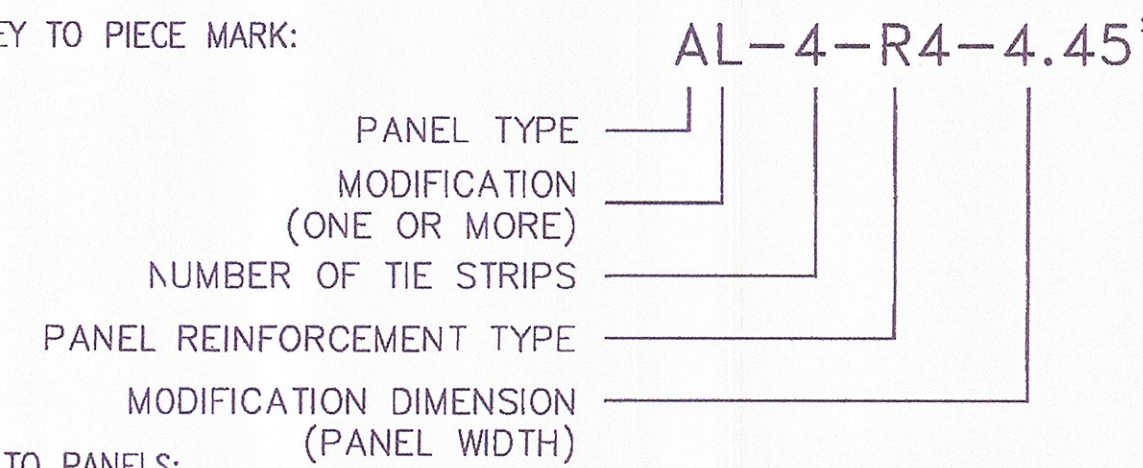

- KEY TO PANELS:

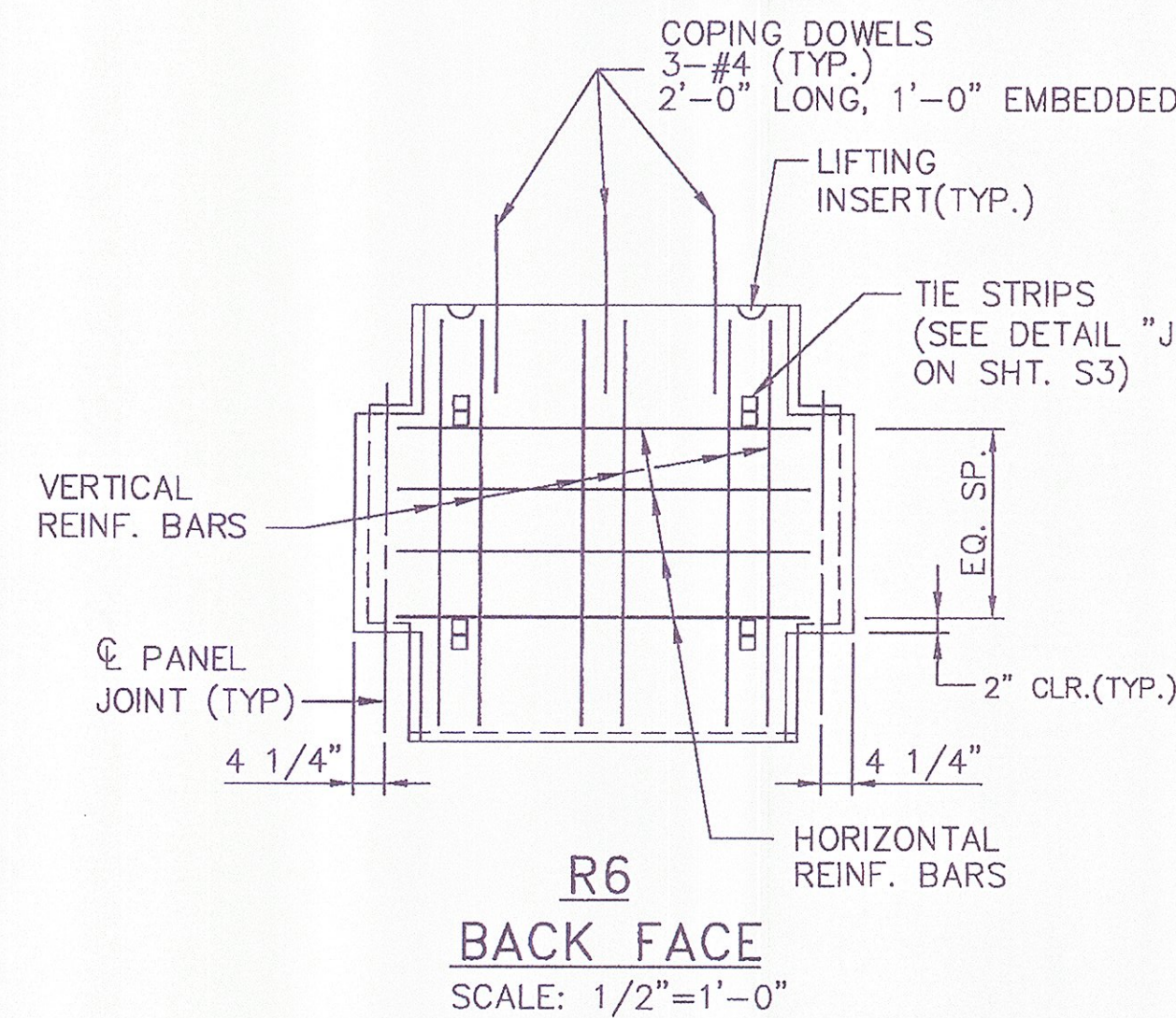

INDEX	
SHEET NO.	CONTENTS
S01	CASTING NOTES
S02	CRUCIFORM PANEL SECTIONS
S03	CRUCIFORM PANEL DETAILS
S04	STANDARD PANEL DRAWINGS
S05	STANDARD PANEL DRAWINGS
S06	PANEL CASTING DRAWINGS
S07	PANEL CASTING DRAWINGS
S08	PANEL CASTING DRAWINGS
S09	PANEL CASTING DRAWINGS AND PRECAST COPING "CPWI"
S10	SLIP JOINTS
S11	HFCW1
S12	HFCW2
S13	HFCW3

APPROVED Revisions and Resubmit Approved as Noted DISAPPROVED

CHECKING IS ONLY FOR GENERAL CONFORMANCE WITH THE DESIGN CONCEPT OF THE PROJECT AND GENERAL COMPLIANCE WITH THE INFORMATION GIVEN IN THE CONTRACT DOCUMENTS. ANY ACTION SHOWN IS SUBJECT TO THE REQUIREMENTS OF THE PLANS AND SPECIFICATIONS. CONTRACTOR IS RESPONSIBLE FOR DIMENSIONS WHICH SHALL BE CORRELATED AND CORRELATED AT THE JOB SITE. FABRICATION PROCESSES AND TECHNIQUES OF CONSTRUCTION, COORDINATION OF HIS WORK WITH THAT OF ALL OTHER TRADES AND THE SATISFACTORY PERFORMANCE OF HIS WORK.

GREEN INTERNATIONAL AFFILIATES, INC.
CONSULTING ENGINEERS

CHECKED BY: *KEA* DATE: 9/11
SIGNED BY: *Michael Wang* DATE: 9/11

CERTIFIED WITH RESPECT TO THE INTERNAL STABILITY OF REINFORCED EARTH STRUCTURES ONLY

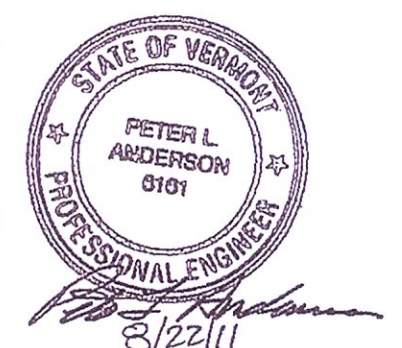

<p>This drawing contains information proprietary to The Reinforced Earth Company, and is being furnished for the use of <u>VTAOT</u> only in connection with this project, and the information contained herein is not to be transmitted to any other organization unless specifically authorized in writing by The Reinforced Earth Company. The Reinforced Earth Company is exclusive licensee in the United States under patents issued to Henri Vidal, and the furnishing of this drawing does not constitute an expressed or implied license under the Vidal patents.</p>	<p>The design contained on these drawings is based on information provided by the owner. On the basis of this information, The Reinforced Earth Company has designed, and is responsible for the internal stability of the structure only. External stability, including foundation (bearing capacity and settlement) and slope (global) stability, is the responsibility of the owner.</p>	<p>REINFORCED eARTH® 8614 Westwood Center Drive, Vienna, VA 22182 (703) 821-1175</p>	DESIGNED BY: KC	PROJECT ENGR: DTM	CHECKED BY: EEH/LY	REV.	DATE	DESCRIPTION	DRAWING COVERS	PROJECT NAME	U.S. ROUTE 2 OVER EXISTING STREAM	DATE	04/06/2011
			<p>"REINFORCED EARTH" is the registered trademark of The Reinforced Earth Company.</p>	<p>8/19/11</p>	<p>7/19/11</p>	<p>REVISE HALF CONNECTOR DETAILS</p>	<p>REVISIONS PER GIA COMMENTS</p>	<p>LOCATION</p>	<p>CABOT-DANVILLE, VERMONT</p>	<p>OWNER</p>	<p>VTAOT</p>	<p>CONTRACT NO.</p>	<p>RE-15053</p>

R:\15053\01.dwg