

**WINGWALL NO. 3 ELEVATION**

SCALE: 1/4" = 1'-0"

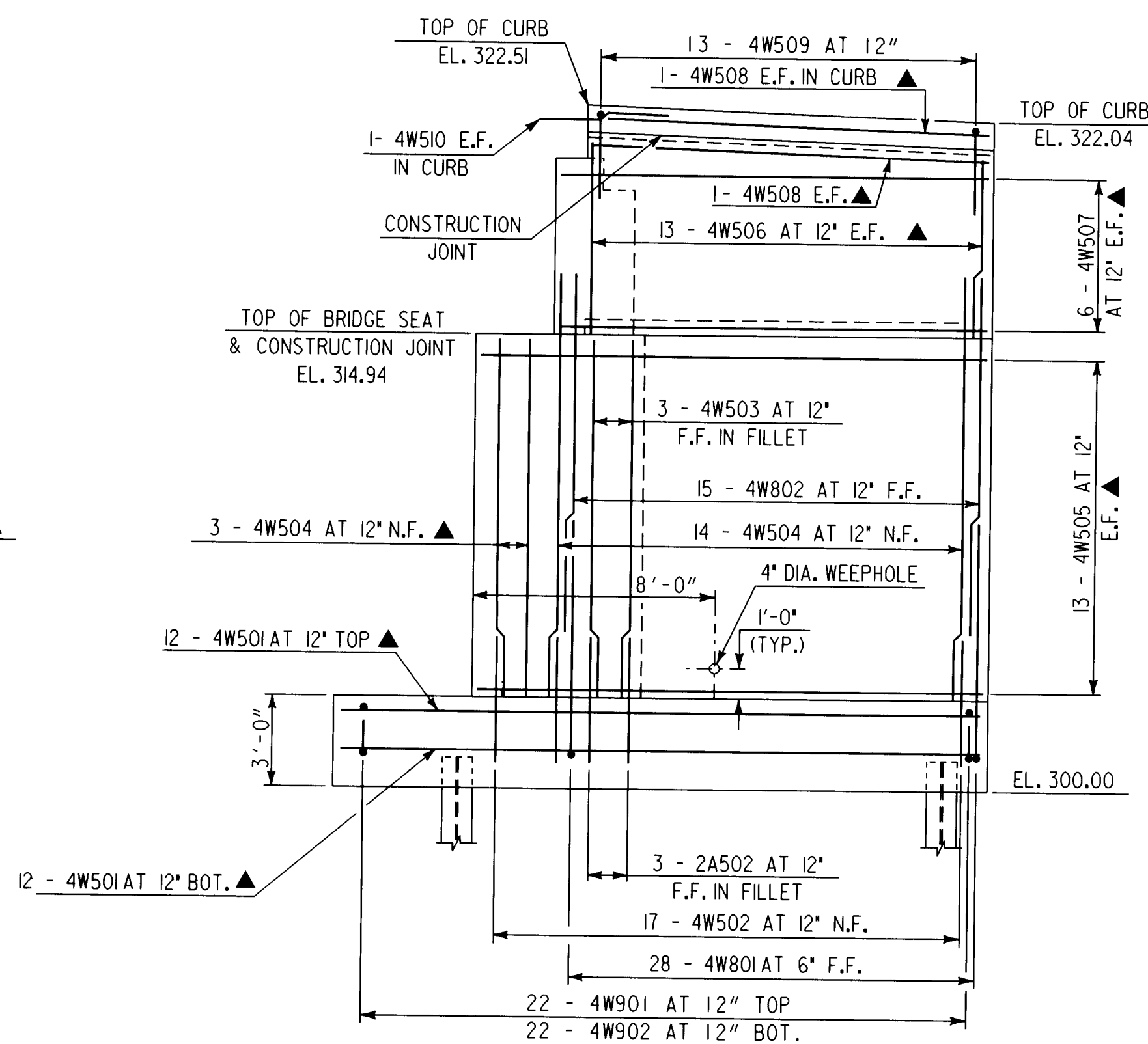

**WINGWALL NO. 4 ELEVATION**

SCALE: 1/4" = 1'-0"

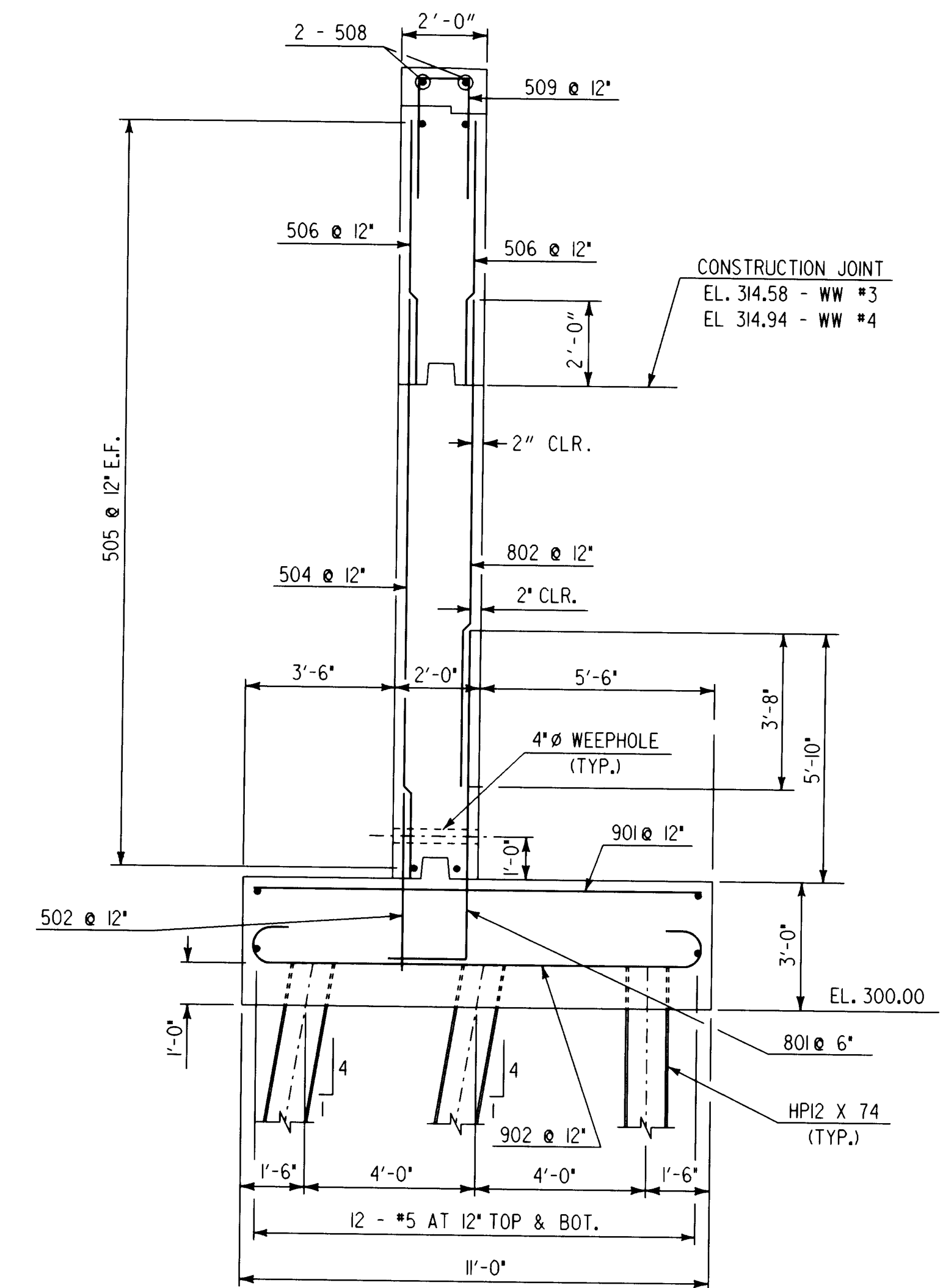

**WINGWALL NO. 3 & 4 TYPICAL SECTION**

SCALE: 3/8" = 1'-0"

**NOTE:**

- N.F. - NEAR FACE
- F.F. - FAR FACE
- E.F. - EACH FACE
- ▲ - CUT TO FIT IN FIELD

NOTE: REINFORCING COVER 3" CLEAR ON ALL FACES EXCEPT WHERE NOTED.

**STATE OF VERMONT  
AGENCY OF TRANSPORTATION**

Town Of	SPRINGFIELD	Bridge No.	44
Highway No.	U.S. ROUTE 5	Log Sta.	
		Surv. Sta.	
U.S. ROUTE 5 OVER BLACK RIVER			
WINGWALL NO. 3 & 4 DETAILS			
Designed By	S. BAKI	Drawn By	W. GAYNOR
Checked By	S. BAKI	Bridge Design Supervisor	P. PIERCE
Date	7/95	Date	5/96
PROJECT	SPRINGFIELD	PROJECT NO.	BRS-RS 0113 (8)
I.G.C. Info.	c:\usr\j9145622\sprwwall.dgn		
Bridge Sheet No.	BR23	Sheet	52 of 90