

NOTES:

- ALL HYDRIC SOILS WHICH ARE TO BE PLACED IN THE WETLAND CREATION AREAS (SEE SHEET 28 FOR DETAILS) ARE TO COME FROM THE EXCAVATION OF EXISTING WETLAND SOILS WHICH ARE WITHIN THE LIMITS OF PROPOSED EMBANKMENT (PAID AS ITEM 203.20) AS DIRECTED BY THE ENGINEER. FOLLOWING COMPLETION OF EXISTING WETLANDS SOILS REMOVAL, ALL REMAINING WETLAND SOILS WITHIN THE LIMITS OF THE PROPOSED EMBANKMENT ARE TO BE COVERED WITH ITEM 645(GEOTEXTILE FOR ROADED SUBGRADE SEPARATOR, PRIOR TO PLACEMENT OF EMBANKMENT.
- LOCATION OF STATE OF VERMONT GARAGE IS APPROXIMATE. CHAIN LINK FENCE TO BE CONSTRUCTED 35' FROM BUILDING, AND END AT BACK OF MAINTENANCE YARD.
- CONTRACTOR IS TO BE AWARE THAT RAILROAD RAILS WILL BE PRESENT UNDER THE EXISTING PAVEMENT NEAR STA 121+60 TO BE REMOVED WITH EXCAVATION.

U.S. ROUTE 5 CURVE DATA CURVE 3

Δ = 34°54'42.8" LT
D = 1138'33.0"
R = 492.3'
T = 154.75'
L = 299.87'
E = 23.61'
P = 0.00 FT/FT

U.S. ROUTE 5 CURVE DATA CURVE 4

Δ = 43°52'00.0" LT
D = 459'22.94"
R = 1148.28'
T = 462.38'
L = 879.14'
E = 89.60'

U.S. ROUTE 5 CURVE DATA CURVE 5

Δ = 56°18'36.0" LT
D = 5545'05.3"
R = 102.77'
T = 55.00'
L = 100.00'
E = 13.79'
P = N/C
ENTRANCE TANGENT S 78°33'41.3" E
EXIT TANGENT N 45°07'42.7" E

U.S. ROUTE 5/VT. ROUTE II CURVE DATA CURVE 6

Δ = 54°27'44.0" RT
D = 4908'34.7"
R = 165.59'
T = 60.00'
L = 10.82'
E = 14.53'
P = N/C
ENTRANCE TANGENT N 45°07'42.7" E
EXIT TANGENT S 80°24'33.3" E

CHAIN LINK FENCE TABLE

LOCATION	DESCRIPTION
SERVICE DRIVE	GATE FOR CHAIN LINK FENCE - 6 FEET
1170, 14' LT TO 1170, 14' RT	DOUBLE CANTILEVER SLIDE GATE
CHAIN LINK FENCE - 6 FEET	CHAIN LINK FENCE - 6 FEET
1170, 14' RT TO 1170, 80' LT	CHAIN LINK FENCE - 6 FEET
1170, 14' RT TO BACK OF STATE GARAGE LOT	CHAIN LINK FENCE - 6 FEET

DRIVEWAY TABLE

DRIVEWAY LOCATION	RADIUS	WIDTH	REMARKS
U.S. ROUTE 5 STA 120+90, LT.	50', 35"	25'	PAVED
SERVICE DRIVE STA 0+80, RT.	75', 10"	30'	PAVED

TEMPORARY SNOW FENCE TABLE

STATION	OFFSET	STATION	OFFSET	STATION	OFFSET	STATION	OFFSET
113+00	130' LT	116+50	120' LT	113+30	150' RT	115+90	65' RT
113+50	140' LT	117+00	140' LT	113+30	90' RT	116+50	77' RT
114+30	80' LT	117+50	128' LT	113+70	85' RT	116+50	72' RT
		117+90	135' LT	113+70	85' RT	116+75	120' RT
		117+55	205' LT				

TAKELINE STATIONING (PARCEL 2A)

STATIONING	N.	E.
118+87.2 RT.	12377.212	51058.163
118+88.8 RT.	12369.254	51074.308
119+42.5 RT.	12416.185	51166.649
119+51.5 RT.	12427.598	51166.889
119+51.8 RT.	12421.445	51130.513

STATE OF VERMONT AGENCY OF TRANSPORTATION

Town of **SPRINGFIELD** Bridge No. **44**

Highway No. **U.S. ROUTE 5** Log. Sta. **Surv. Sta.**

U.S. ROUTE 5 OVER BLACK RIVER

Designed By **JRM** Date **3/95** Drawn By **RR/CM** Bridge Design Supervisor

Checked By **RAL** Date **3/95** P. PERCE Date

PROJECT **SPRINGFIELD** PROJECT NO. **BRS-RS 0113 (8)**

U.G.C. Info. **/usr5/1845622/row501.dgn**

Bridge Sheet No. **24-MAY-1996** Sheet **12** of **90**

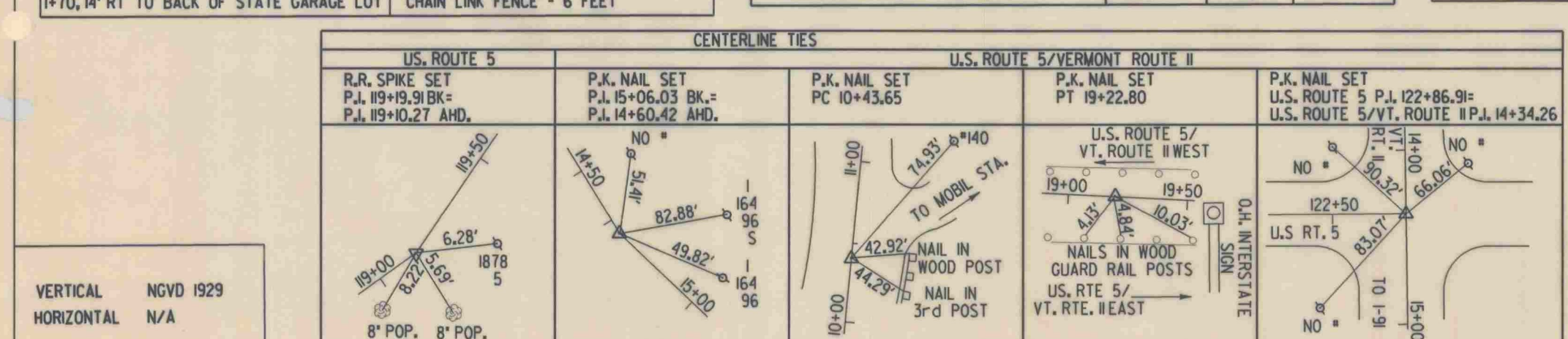

VERTICAL NGVD 1929
HORIZONTAL N/A

THIS SHEET FOR ROW USE ONLY

SCALE IN FEET

0 50 100

24-MAY-1996

Sheet 12 of 90

24-MAY-1996

Sheet 12 of 90

24-MAY-1996

24-MAY-1996