

TOTAL PAYLIMIT 607.30 NORTH = 393'-8"
 38 SP @ 10'-0" = 380'-0"

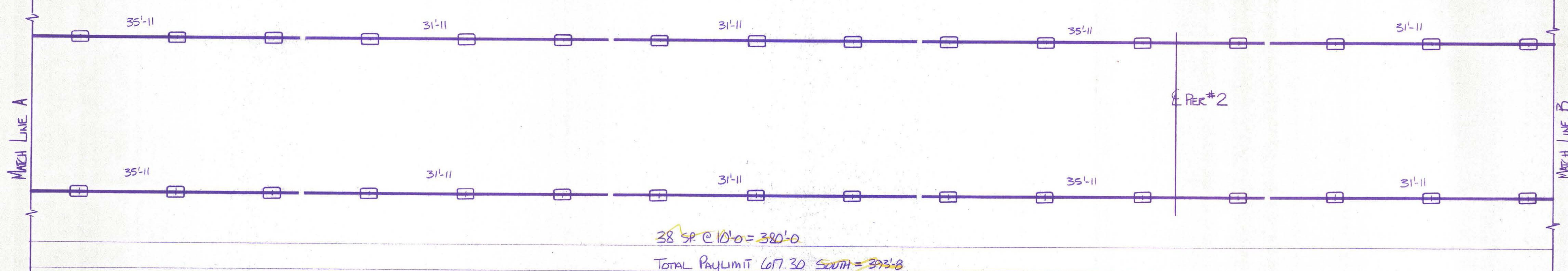

38 SP @ 10'-0" = 380'-0"
 TOTAL PAYLIMIT 607.30 SOUTH = 393'-8"

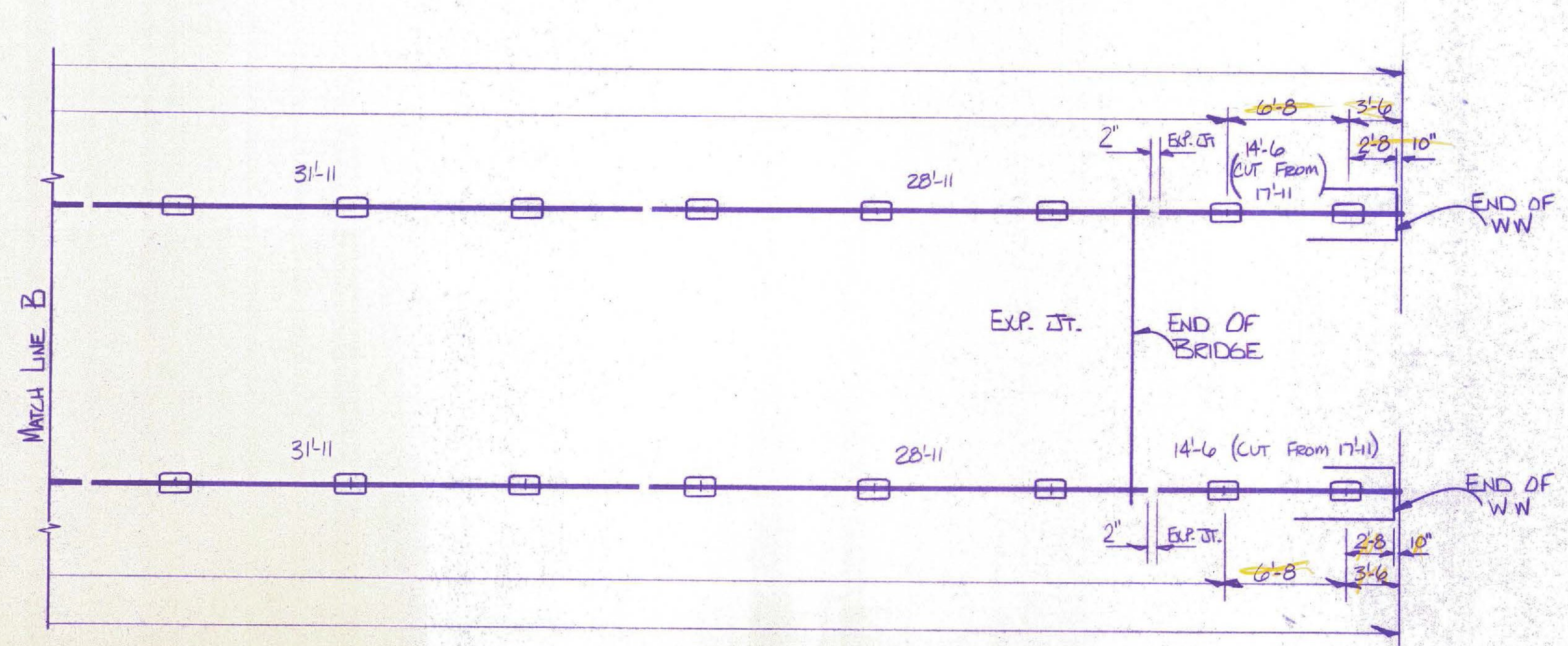

393'-8"
 393'-8"
 393'-8"
 393'-8"
 1574'-5"

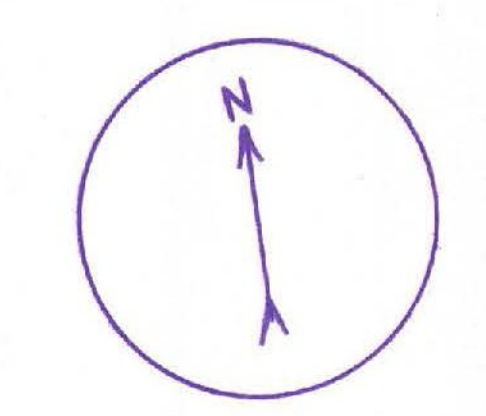

RECEIVED JUL 16 1985
 CK'D BY *AWA* OK'D BY *AWA*
 RESUBMIT APPROVED
 BY *W.S. M...* DATE - 7/18/85

FILE SET

PLAN VIEW
 WESTBOUND LANE OVER OTTER CREEK (SHOWN)
 EASTBOUND LANE OVER OTTER CREEK (TYPICAL)

UND = UNLESS NOTED OTHERWISE
 TOTAL PAYLIMIT 607.30 THIS PROJECT = 2615'-38"
 TOTAL PAYLIMIT 607.30 THIS SHEET = 1574'-8"

| | | | |
|--|-------------------------|--------------------------|--------------------------------------|
| DRAWN BY: MR | DATE: 7-10-85 | CHECKED BY: ML | SHEET NO. 3 OF 4 |
| 2-RAIL BOX BEAM BRIDGE RAIL LAYOUT US RTE 4 OVER OTTER CREEK (WB & EB) TOWNS OF RUTLAND & WEST RUTLAND RUTLAND COUNTY STATE OF VERMONT PROJECT # F-EGC-F-020-1 (10) | | | |
| GENERAL CONTRACTOR: MASKELL BROTHERS FENCE CO. | | | |
| ERECTOR: MASKELL BROTHERS FENCE CO. | | | |
| FABRICATOR: O.W. HUBBELL & SONS INC. | | | |
| | | | HUBBELL JOB NUMBER DS16227 |