

TEMPORARY 4" REFLECTORIZED WHITE LINES
 16+0 ~ 24+0, 12' LT.
 16+0 ~ 20+0, 12' RT.
 20+0; 12' RT. ~ T.H. 2 5+64 11' RT (RADIUS)
 T.H. 2 5+64 ~ 7+0, 11' RT.
 T.H. 2 5+64 ~ 7+0, 11' LT.
 T.H. 2 5+64, 11' LT. ~ 21+15, 12' RT. (RADIUS)
 21+15 ~ 24+0, 12' RT.

TEMPORARY 4" REFLECTORIZED YELLOW LINES
 16+0 ~ 20+30 $\frac{1}{2}$ (DBL.)
 20+80 ~ 24+0 $\frac{1}{2}$ (DBL.)
 T.H. 2 5+30 ~ 7+0 $\frac{1}{2}$ (DBL.)

DURABLE 24" STOP BARS
 T.H. 2 5+30 ~ 5+32, LT.

DURABLE LETTER IN WORD MARKING
 T.H. 2 5+36 ~ 5+44, 3'-10' LT.

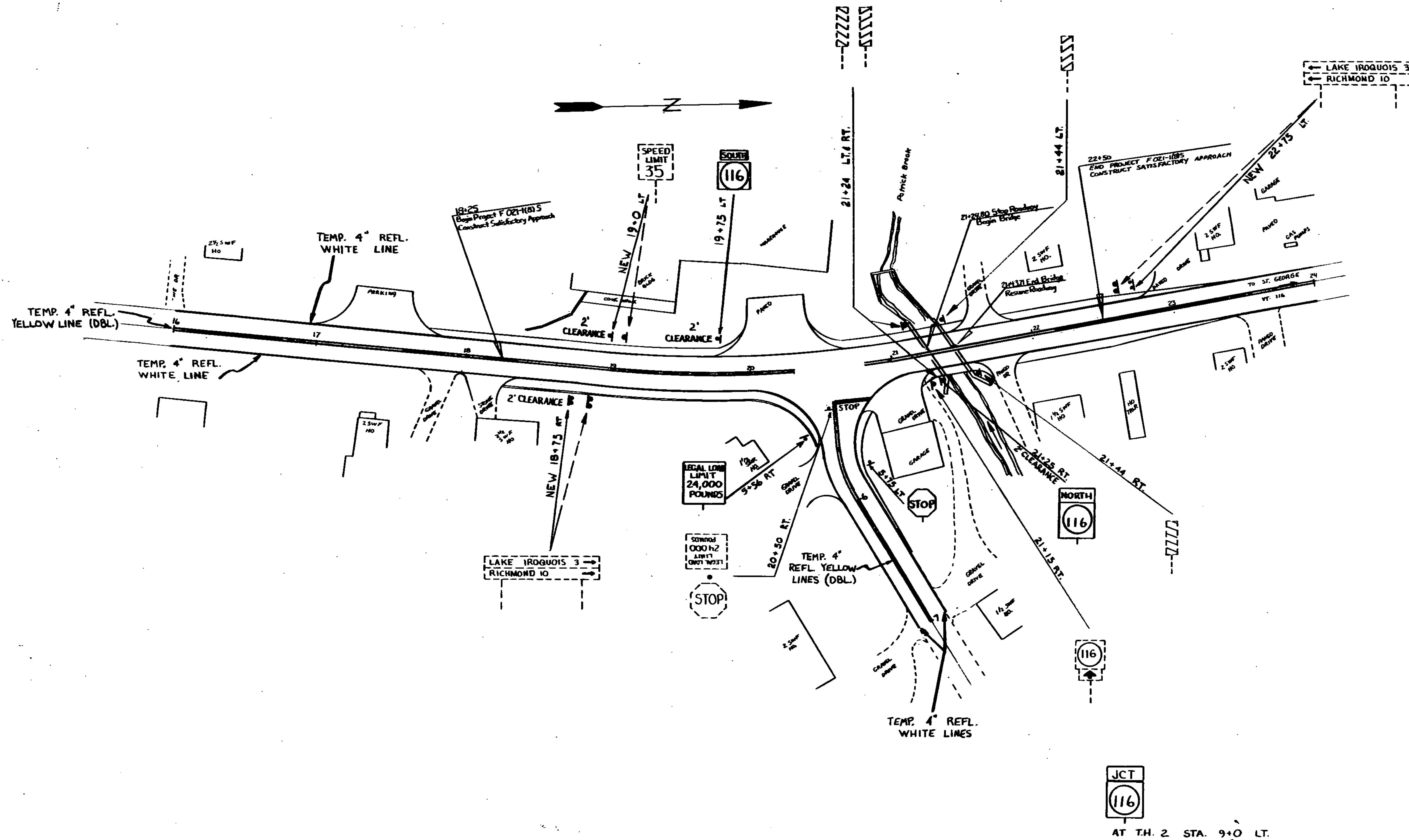

LEGEND

[---] EXISTING SIGNS TO BE REMOVED

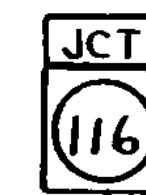

AT T.H. 2 STA. 9+0 LT.

DATUM	_____
VERTICAL	_____
HORIZONTAL	_____

SURVEYED BY	MOREAU	DATE	7/19/80
DRAWN BY	HODGE	DATE	10/19/80
TRACED BY	C.D.B.	DATE	12/84
HINESBURG			
PROJ. F	NO. 021-1(8) S		
SHEET 19 OF 76			