

NOTES

1. The existing superstructure, abutments and upstream wingwalls shall be removed under the item 'Removal of Structure'. Removal of Structure shall also include the removal of the downstream wingwalls to within 3' from new fascia at abutment 1 and within 7' of new fascia at abutment 2. As shown on this sheet.
2. The downstream retaining walls shall be retained beyond the point where removal of structure ends. New wingwalls 1 and 2 shall be attached to existing walls with drilled and grouted dowels. When joining new concrete to existing the existing J shall be coated with neat cement grout as specified in Section 501.12(b) and payment shall be subsidiary to Concrete, Class B.
3. Two-way traffic shall be maintained at all times, under the item 'Two-way Temporary Bridge'. The cost of all signs and barricades shall be included in the unit price bid for Two-way Temporary Bridge.
4. All existing elevations shall be verified in the field prior to commencement of construction.
5. Structure Excavation shall include all material within 1'-0" of the new structure, excluding the material to be removed under removal of structure.
6. See Sheet BR104 for additional notes.

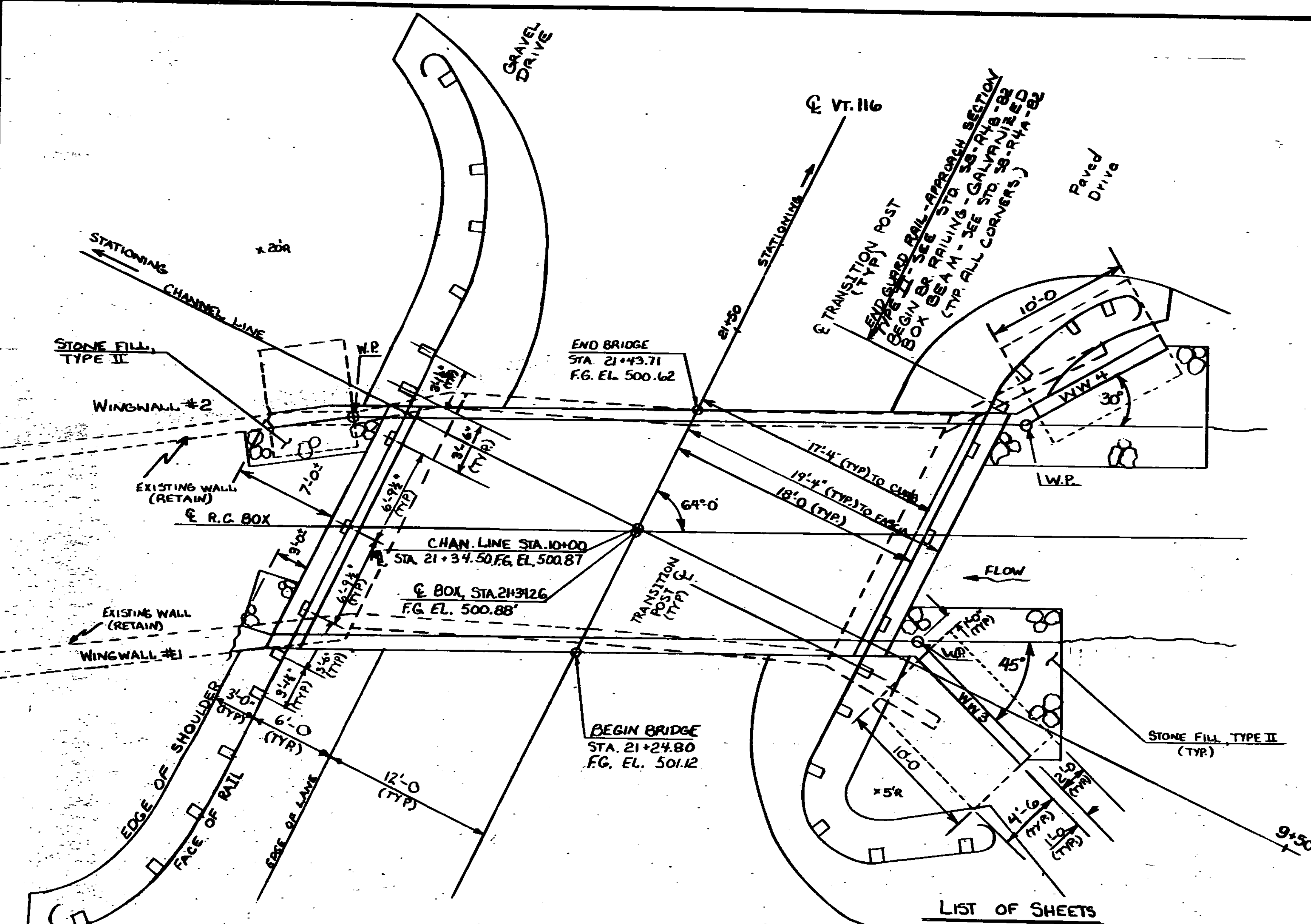

PLAN
SCALE: 1" = 5'-0"

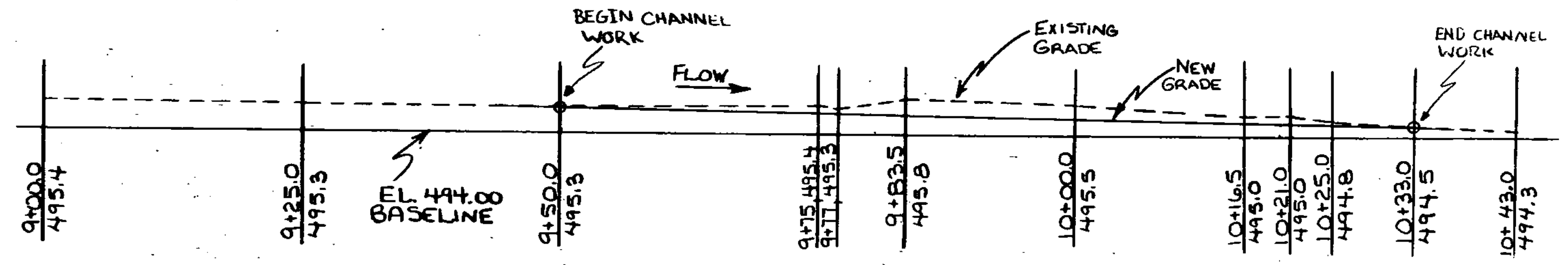

PROFILE CHANNEL LOW POINTS

VERT. SCALE: 1" = 5'
HORIZ. SCALE: 1" = 10'

HYDRAULIC DATA

DRAINAGE AREA = 7.2 Sq. Miles
 Q₂₅ = 125 cfs H.W. Elev. = 499.7
 Q₁₀ = 220 cfs H.W. Elev. = 500.1
 Q₂₅ = 310 cfs H.W. Elev. = 500.3
 Q₅₀ = 380 cfs H.W. Elev. = 500.4
 Q₁₀₀ = 450 cfs H.W. Elev. = 500.5
 Tailwater @ Q₅₀ = 6.4'
 Velocity @ Q₅₀ = 6.3 fps

LIST OF SHEETS

- BR101 PLAN AND ELEVATION
- BR102 BRIDGE QUANTITY SHEET
- BR103 REINFORCING DETAILS-BOX
- BR104 WINGWALL 1:2 DETAILS
- BR105 WINGWALL 3:4 DETAILS
- BR106 REINFORCING SCHEDULE
- BR107-BR111 CHANNEL SECTIONS
- SB-R4A-B2
- SB-R4B-B2
- SCB-D1-75
- SCB-D6-73

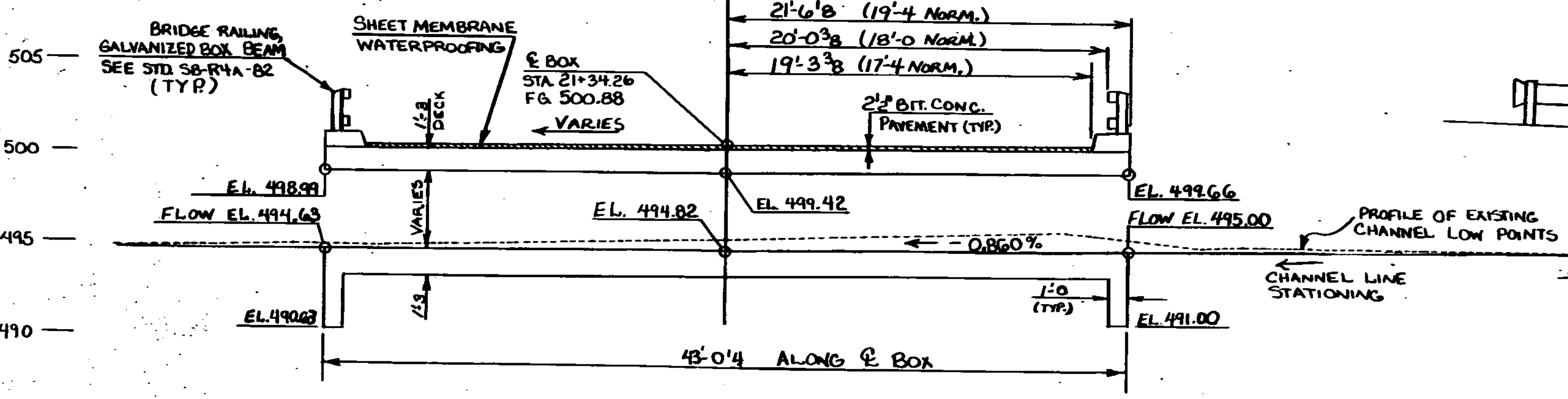
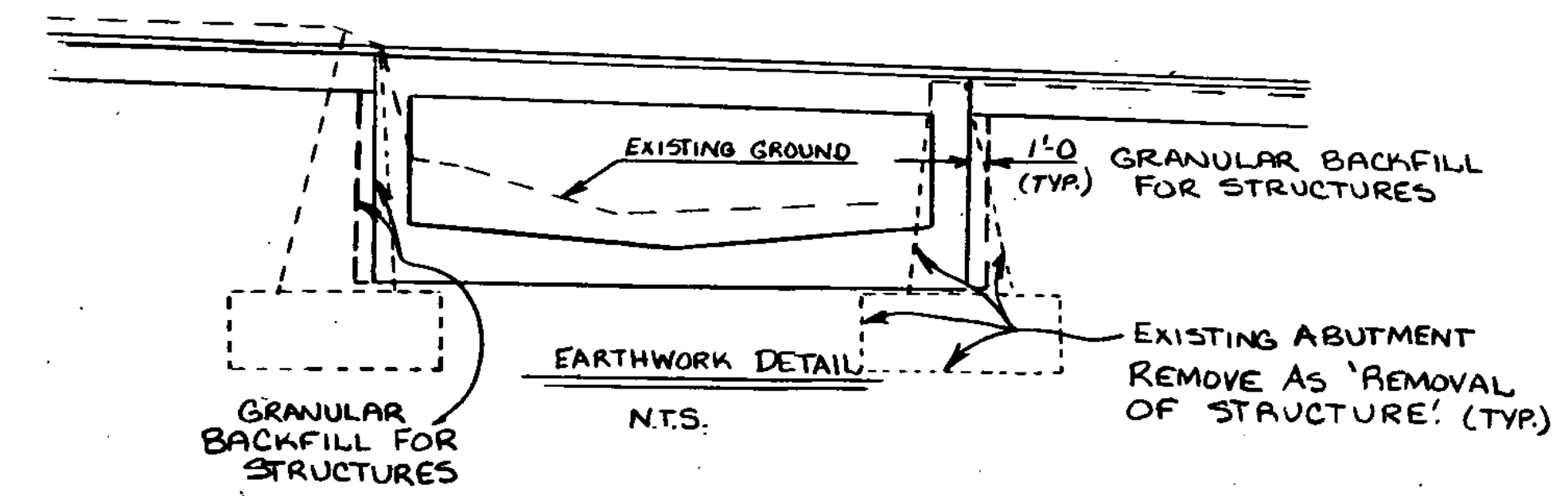

ELEVATION ALONG C BOX
SCALE: 1" = 5'-0"

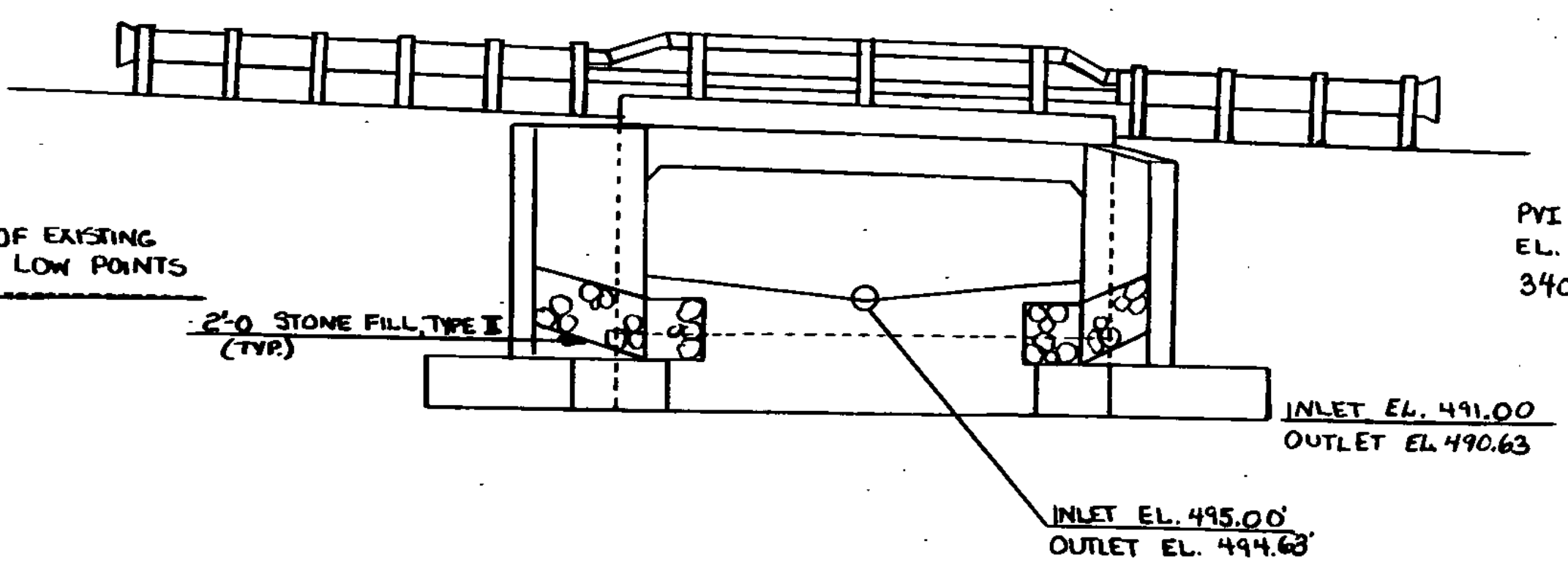

ELEVATION-INLET
SCALE: 1" = 5'-0"

STATE OF VERMONT
AGENCY OF TRANSPORTATION

TOWN OF HINESBURG	Bridge No. 27
HIGHWAY NO. Vt. 116	Log Sta. 21+24.80
Surv. Sta.	
VT. 116 OVER PATRICK BROOK	
PLAN, ELEVATION & TYPICAL SECTION	
Designed by M. EVANS	Drawn by M. EVANS
Checked by J.A. HOLLAR date 8-1-84	Bridge Design Supervisor E.L. DOLLEY date 10-24
PROJECT HINESBURG	PROJECT NO. F021-1(8)S
Bridge Sheet No. BR101	Sheet 13 of 76