

18+25 END APPROACH  
Begin Project F 021-1(8) S

Curve Data  
 $\Delta$  15° 00' Lt  
 D 7° 30'  
 R 763.94'  
 T 100.58'  
 L 200.00'  
 E 6.59'  
 Bk 0.059 P/P

BM #2  
S.I.T.  
24" M.  
ASSUMED  
ELEV. 500.00

22+50  
END PROJECT F 021-1(8) S  
BEGIN APPROACH

23+50  
END APPROACH

21+74.80 Stop Roadway  
Begin Bridge  
P.O.T. 21+34.50 =  
Chan. P.O.T. 10+00.00

21+43.71 End Bridge  
Resume Roadway

P.I. 23+50  
NO CURVE RUN  
 $\Delta$  1° 28' Lt.

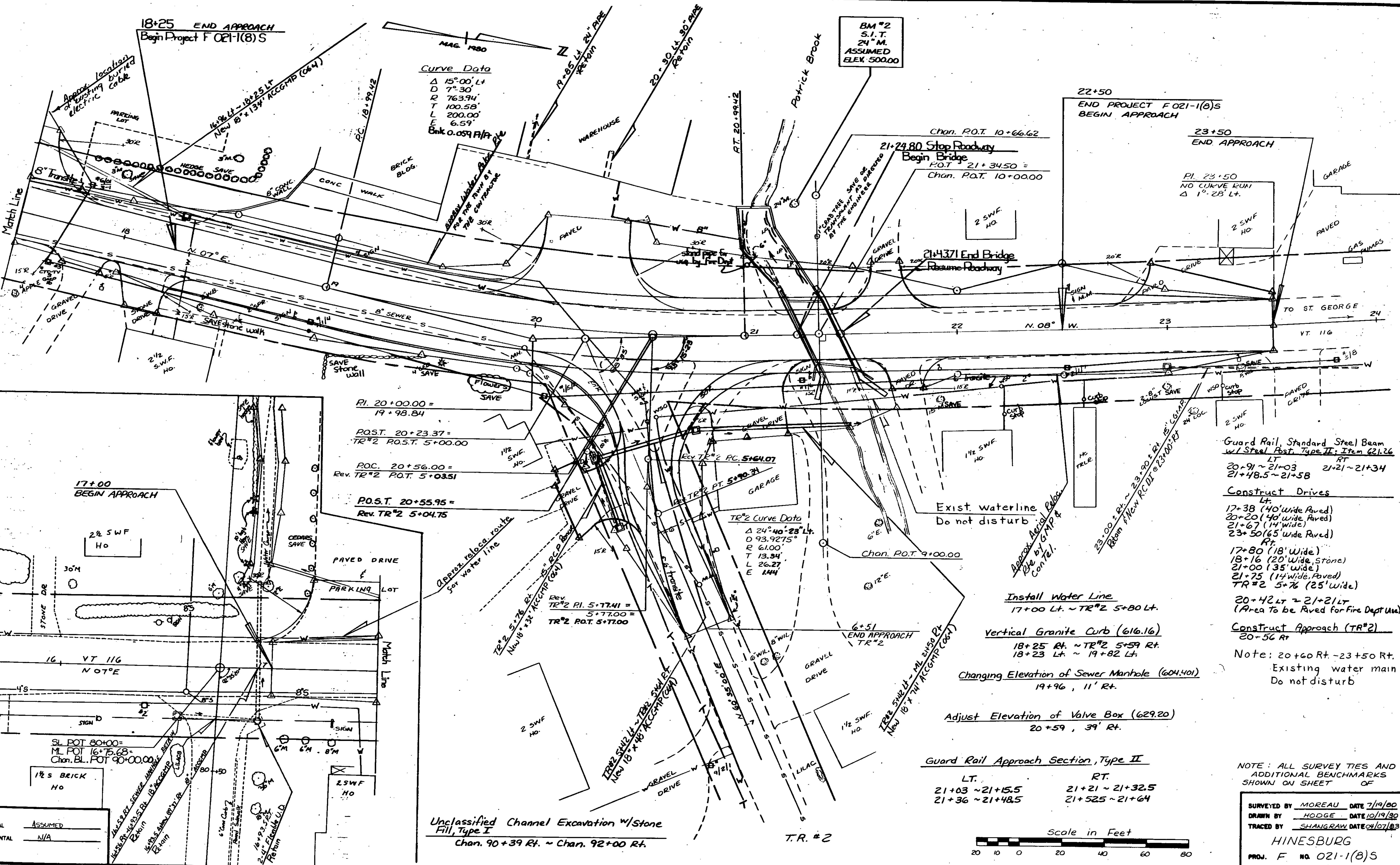

P.I. 20+00.00 =  
19+98.84  
 P.O.S.T. 20+23.37 =  
TR#2 P.O.S.T. 5+00.00  
 P.O.C. 20+56.00 =  
Rev. TR#2 P.O.T. 5+03.51  
 P.O.S.T. 20+55.95 =  
Rev. TR#2 5+04.75

TR#2 Curve Data  
 $\Delta$  24° 40' 23" Lt.  
 D 93.9275'  
 R 61.00'  
 T 13.34'  
 L 26.27'  
 E 1.44'

Rev. TR#2 P.I. 5+77.41 =  
5+77.00 =  
TR#2 P.O.T. 5+71.00

Chan. P.O.T. 9+00.00  
 Exist. waterline  
Do not disturb

Install Water Line  
17+00 Lt. ~ TR#2 5+80 Lt.

Vertical Granite Curb (616.16)  
18+25 Rt. ~ TR#2 5+59 Rt.  
18+23 Lt. ~ 19+82 Lt.

Changing Elevation of Sewer Manhole (604.401)  
19+96, 11' Rt.

Adjust Elevation of Valve Box (629.20)  
20+59, 39' Rt.

Guard Rail Approach Section, Type II

LT.	RT.
21+03 ~ 21+15.5	21+21 ~ 21+32.5
21+36 ~ 21+48.5	21+52.5 ~ 21+64

Guard Rail, Standard Steel Beam  
w/ Steel Post, Type II, Item 621.26  
 LT RT  
 20+91 ~ 21+03 21+21 ~ 21+34  
 21+48.5 ~ 21+58

Construct Drives  
 LT  
 17+38 (40' wide Paved)  
 20+20 (40' wide Paved)  
 21+67 (14' wide)  
 23+50 (65' wide Paved)  
 RT  
 17+80 (18' wide)  
 18+16 (20' wide, Stone)  
 21+00 (35' wide)  
 21+75 (14' wide, Paved)  
 TR#2 5+76 (25' wide)

20+42 Lt ~ 21+21 Lt  
(Area to be Paved for Fire Dept Use)

Construct Approach (TR#2)  
20-56 Rt

Note: 20+60 Rt. - 23+50 Rt.  
Existing water main  
Do not disturb

NOTE: ALL SURVEY TIES AND  
ADDITIONAL BENCHMARKS  
SHOWN ON SHEET OF

SURVEYED BY MOREAU DATE 7/19/80  
 DRAWN BY HODGE DATE 10/19/80  
 TRACED BY SHANGRAW DATE 04/07/83  
 HINESBURG  
 PROJ. F. NO. 021-1(8) S  
 SHEET 11 OF 76

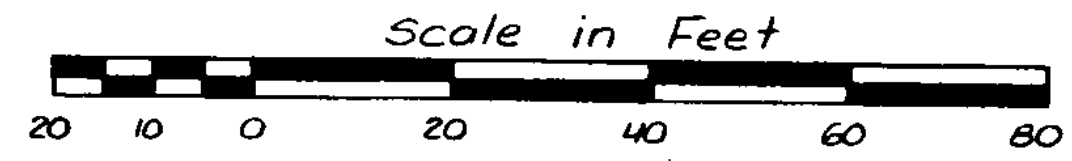

DATUM  
 VERTICAL ASSUMED  
 HORIZONTAL N/A

Unclassified Channel Excavation w/ Stone  
Fill, Type I  
 Chan. 90+39 Rt. ~ Chan. 92+00 Rt.