

A3 ~ 343 REQ'D

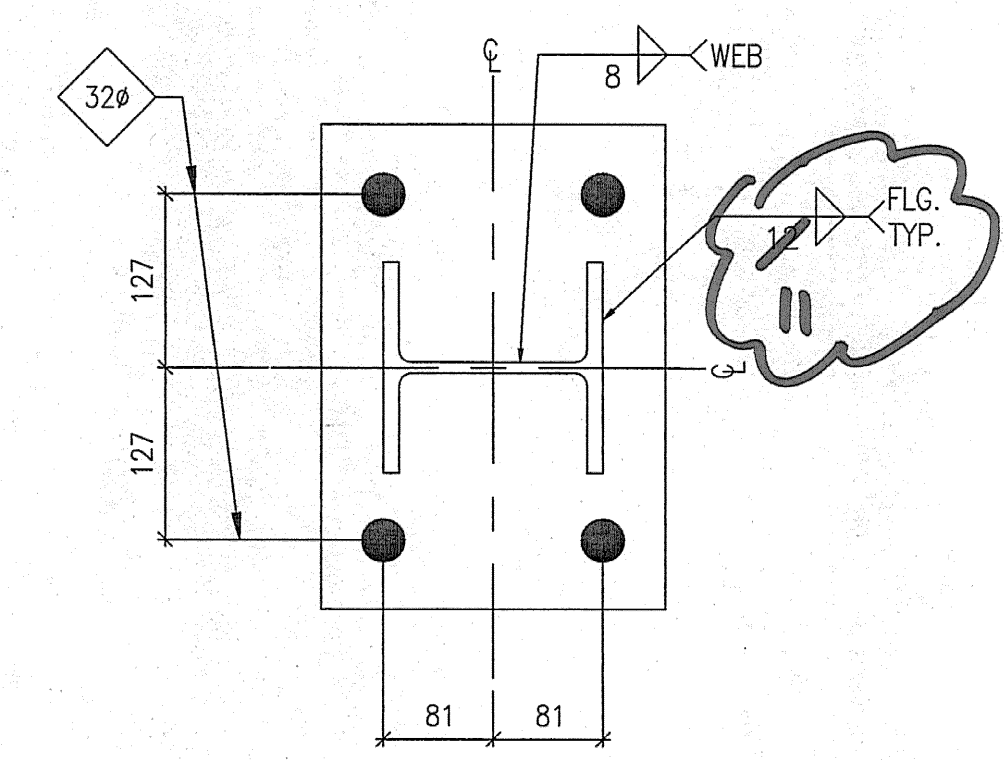

B3 ~ 342 REQ'D
C3 ~ ONE REQ'D (AS NOTED)

BILL OF MATERIAL				
MARK	QTY.	MATERIAL	LENGTH	GR. REMARKS
A3	343	W150 x 37	1120	GALV. HD.
pa2	343	PL 25 x 254	356	GALV. HD.
B3	342	W150 x 37	1120	GALV. HD.
pa2	342	PL 25 x 254	356	GALV. HD.
C3	ONE	W150 x 37	1120	GALV. HD.
pa2	ONE	PL 25 x 254	356	GALV. HD.
TOTAL WEIGHT:				

FOR APPROVAL

SHOP DRAWING REVIEW

REVIEWED AS REQUIRED BY THE CONSTRUCTION CONTRACT DOCUMENTS AND APPROVED, BUT ONLY FOR CONFORMANCE TO THE DESIGN CONCEPT OF THE WORK, AND SUBJECT TO FURTHER LIMITATIONS AND REQUIREMENTS CONTAINED IN THE CONSTRUCTION CONTRACT DOCUMENTS.

REJECTED REVISE AND RESUBMIT FURNISH AS CORRECTED

CORRECTIONS OR COMMENTS MADE ON THE SHOP DRAWINGS DURING THIS REVIEW DO NOT RELIEVE CONTRACTOR FROM COMPLIANCE WITH REQUIREMENTS OF THE DRAWINGS AND SPECIFICATIONS. THIS CHECK IS ONLY FOR REVIEW OF GENERAL CONFORMANCE WITH THE DESIGN CONCEPT OF THE PROJECT AND GENERAL COMPLIANCE WITH THE INFORMATION GIVEN IN THE CONTRACT DOCUMENTS. THE CONTRACTOR IS RESPONSIBLE FOR: CONFIRMING AND CORRELATING ALL QUANTITIES AND DIMENSIONS; SELECTING FABRICATION PROCESSES AND TECHNIQUES OF CONSTRUCTION; COORDINATING HIS WORK WITH THAT OF ALL OTHER TRADES; AND PERFORMING HIS WORK IN A SAFE AND SATISFACTORY MANNER.

VHB Versasse Hargren Brasletti, Inc.
Engineers, Planners, and Scientists
Six Bedford Farms, Milton Rd.
Bedford, NH 03110 603 644 0808

Job Number: 58911
Reviewed By: [Signature]
Date: 7-7-05

MAT'L : ASTM A709 GR 345	FIELD BOLTS
HOLES : 22φ (7/8") U.N.O.	GRADE: A325
WELD :	*
ELECTRODE : E70XX	
PREP : SEE GN-1	
PAINT : SEE GN-1	

REV.	DATE	BY	DESCRIPTION	CHK
1	11/01/05	JM	RE-ISSUED FOR APPROVAL	BH
0	08/06/04	JM	ISSUED FOR APPROVAL	BH

WORK NETC 4 RAIL-BRIDGE RAILING
VT. ROUTE 78 OVER MISSISQUOI BAY
ALBURG - SWANTON, VERMONT

DRAWING BRIDGE RAIL POSTS

SCALE: N.T.S.	CIANBRO CORPORATION PITTSFIELD MAINE	SHEET 03
DRAWN: JM		JOB 050004
CHECK: BH		

- NOTES:
- ALL PARTS TO BE GALVANIZED AFTER FABRICATION IN ACCORDANCE WITH AASHTO M 111M, EXCEPT THAT HARDWARE SHALL MEET THE REQUIREMENTS OF AASHTO M 232M.
 - REFERENCE ERECTION DRAWINGS E1 THRU E23.