

**METRIC** 1. ALL DIMENSIONS ARE IN MILLIMETERS UNLESS OTHERWISE NOTED.  
2. ALL WEIGHTS ARE IN KILOGRAMS.

FED. ROAD DIV. NO. STATE VT FED. AID PROJ. NO.

BILL OF MATERIAL									
NO.	MARK	DESCRIPTION	LENGTH	REMARKS	GRP.	ITEM	SHIP. WT. KG. EA.		
ONE	G80	GIRDER					22 350		
1	w1	PL 16 x 1750	23 812	(T)	3	4	5233.28		
1	w2	PL 16 x 1750	23 644	(T)	4	7	5489.10	10420.61	
1	t1	PL 22 x 450	26 189	(T)	4	20	2035.04	2035.28	
1	t2	PL 32 x 450	6 300	(T)	4	15	742.07	742.15	
1	t3	PL 65 x 450	8 600	(T)	4	3	4974.44	1974.67	
1	t4	PL 32 x 450	6 327	(T)	4	13	715.12	715.20	
1	b1	PL 22 x 450	26 195	(T)	4	20	2035.51	2035.74	
1	b2	PL 32 x 450	6 300	(T)	4	15	742.07	742.15	
1	b3	PL 65 x 450	8 600	(T)	4	3	4974.44	1974.67	
1	b4	PL 32 x 450	6 308	(T)	4	14	742.97	743.06	
2	x1a	PL 12 x 1600	400	(T)	6	1	60.28	120.58	
1	x1b	PL 14 x 450	790	(T)	6	6	39.06	39.07	
2	x1c	PL 16 x 200	790	(T)	6	5	49.84	39.69	
1	x1f	PL 10 x 450	392	FILL	6	7	13.85		
1	x1w	PL 14 x 450	790	(T)	6	6	39.06	39.07	
2	x1y	PL 16 x 200	790	(T)	6	5	49.84	39.69	
1	x1aa	PL 10 x 450	392	FILL	6	7	13.85		
1	x2c	PL 38 x 200	1750		7	1	104.39	104.41	
2	x2d	PL 38 x 200	1750		7	1	104.39	208.81	
1	x2g	PL 38 x 200	1750		7	1	104.39	104.41	
6	x2h	PL 12 x 180	1750		7	4	29.67	178.04	
2	x2m	PL 12 x 180	1750		7	4	29.67	59.35	
5	x2p	PL 14 x 180	310		7	3	-6.19	30.66	
2	x2ak	PL 12 x 180	1750		7	4	29.67	59.35	
1	x2ac	PL 6 x 115	301	*V1=79652	7	5	-1.83	63	
<b>TOTAL WEIGHT THIS SHEET:</b>							<b>22 346.37</b>	<b>kgs</b>	

\*SEE SHEET 90=112

22346.36 kg JMR 8-7-06

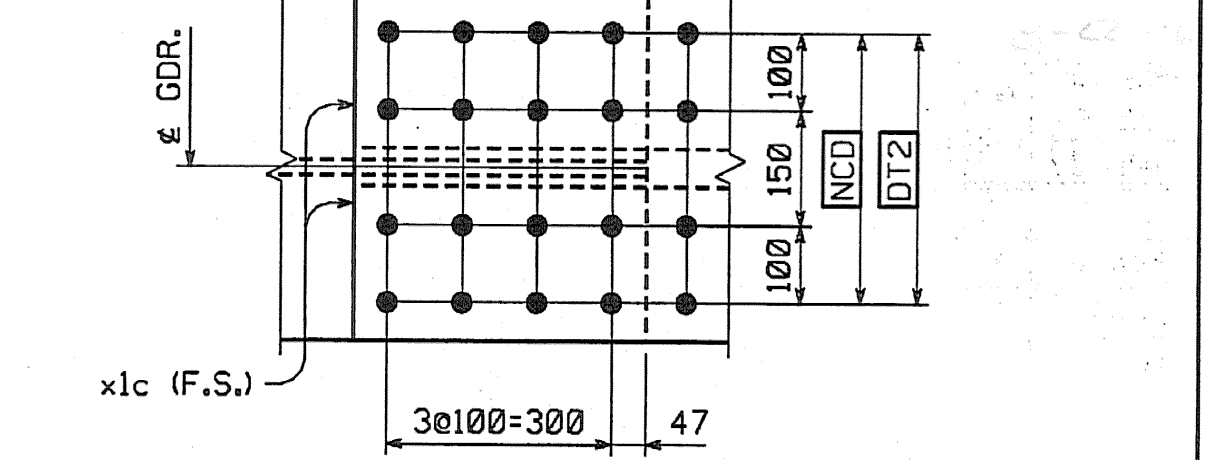

**SHOP NOTE**  
**Holes:** 1/16"  
**Bolts:** NONE  
**Paint:** NONE  
 FOR GENERAL SHOP NOTES SEE DWG. NO. 6001  
 FOR WEB CAMBER DIAGRAM SEE DWG. NO. 6001

**SHOP DRAWING REVIEW**  
 REVIEWED AS REQUIRED BY THE CONSTRUCTION CONTRACT DOCUMENTS AND APPROVED BY THE CONTRACTOR FOR CONFORMANCE TO THE DESIGN CONCEPT OF THE PROJECT AND SUBJECT TO THE REVISIONS AND REQUIREMENTS CONTAINED IN THE CONSTRUCTION CONTRACT DOCUMENTS.  
 CORRECTIONS OR COMMENTS MADE ON THE SHOP DRAWINGS DURING THIS REVIEW DO NOT RELIEVE THE CONTRACTOR FROM COMPLIANCE WITH REQUIREMENTS OF THE DRAWINGS AND THE SPECIFICATIONS. THIS CHECK IS ONLY FOR REVIEW OF GENERAL CONFORMANCE WITH THE SPECIFICATIONS OF THE PROJECT AND GENERAL CONFORMANCE WITH THE DRAWINGS AND THE SPECIFICATIONS. THE CONTRACTOR IS RESPONSIBLE FOR OBTAINING PERMITS AND FOR OBTAINING ALL NECESSARY APPROVALS AND FOR OBTAINING ALL NECESSARY APPROVALS AND FOR OBTAINING ALL NECESSARY APPROVALS.

NO.	REVISION	BY	DATE

**HIGH STEEL STRUCTURES, INC.**  
 1770 Hempstead Road  
 Lancaster, PA 17605-0008  
 Phone 717/299-5211  
 A Division of High Industries, Inc.

**GIRDER** G80  
 VT 78 OVER MISSISSQUOI BAY, BRIDGE NO. 2  
 VT 78 STA.10+970.425 TO STA.12+059.775  
 TOWNS OF ALBURG AND SWANTON  
 COUNTIES OF GRAND ISLE AND FRANKLIN  
 STATE OF VERMONT, AGENCY OF TRANSPORTATION

STATE CONTRACT OR REF. NO. BRF-036-1(1)  
 CONTRACTOR CIANBRO CORPORATION  
 IN CHARGE: GLIDDEN (IH) MADE BY: SSL CHK'D. BY: CS DATE: 8-23-04  
 CONTRACT NUMBER: VT-04057-2 DRAWING NUMBER: 60 OF 112

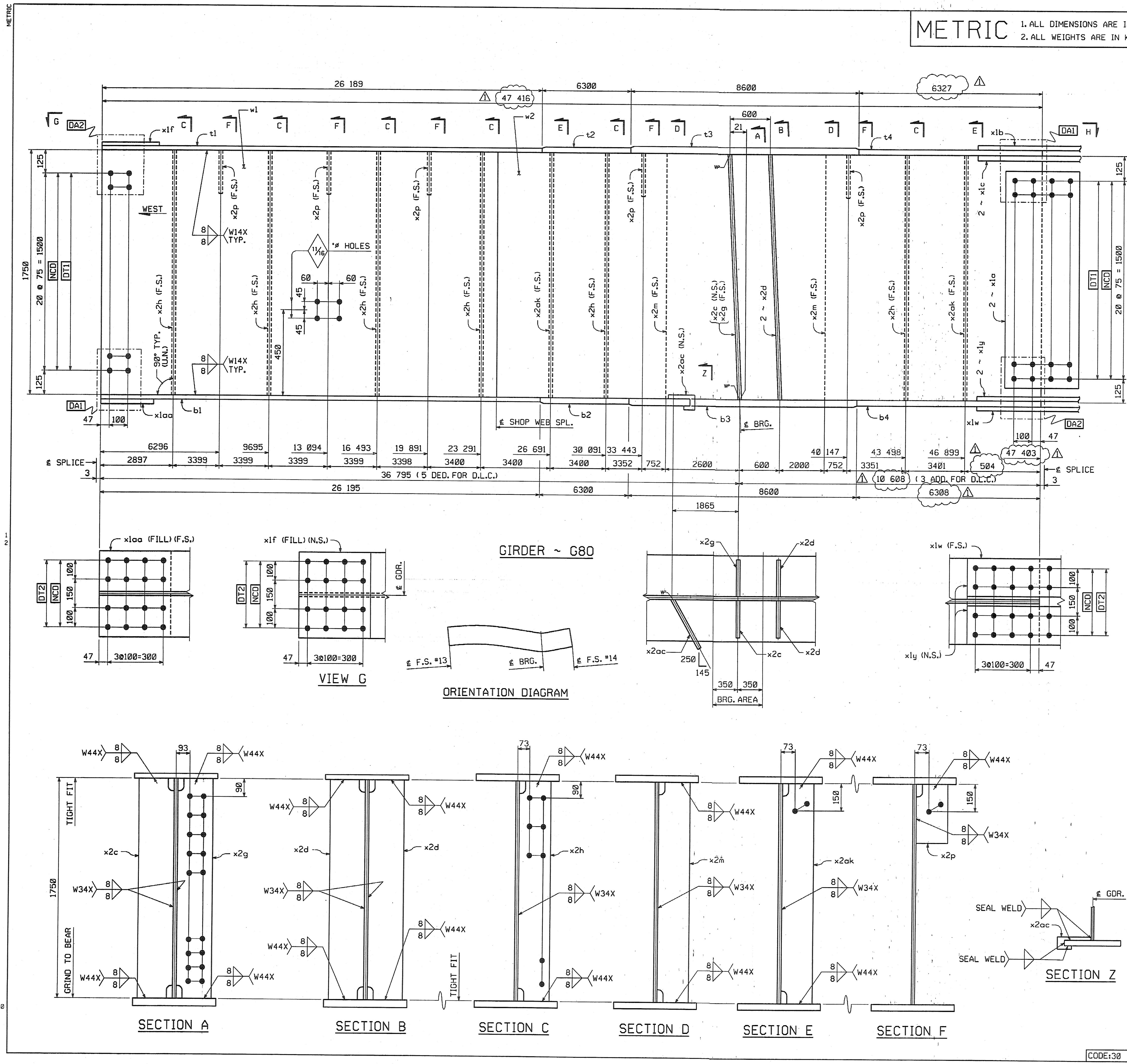

BY: dpanther  
 PLOTTED: 9/29/2004 10:56:00 PM

CODE:30