

METRIC

METRIC 1. ALL DIMENSIONS ARE IN MILLIMETERS UNLESS OTHERWISE NOTED.
 2. ALL WEIGHTS ARE IN KILOGRAMS.

FED. ROAD DIST. NO. STATE FED. AID PROJ. NO.
 VT

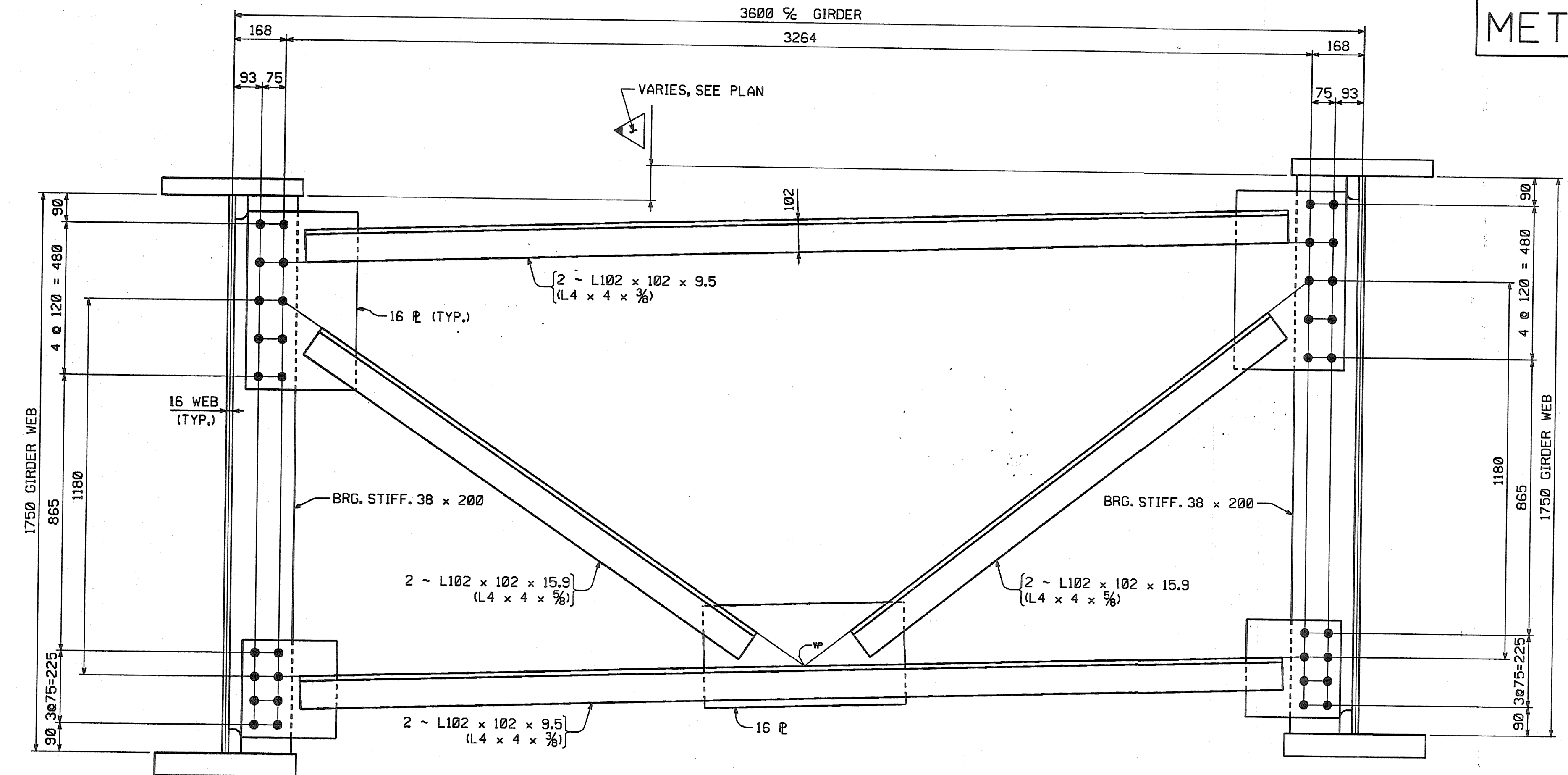

INTERMEDIATE PIER CROSSFRAME LAYOUT
 (BAY 1 & BAY 2 - LOOKING STATIONS AHEAD)
 (FOR PIERS 1 THRU 6, PIERS 8 THRU 14 & PIERS 16 THRU 22)

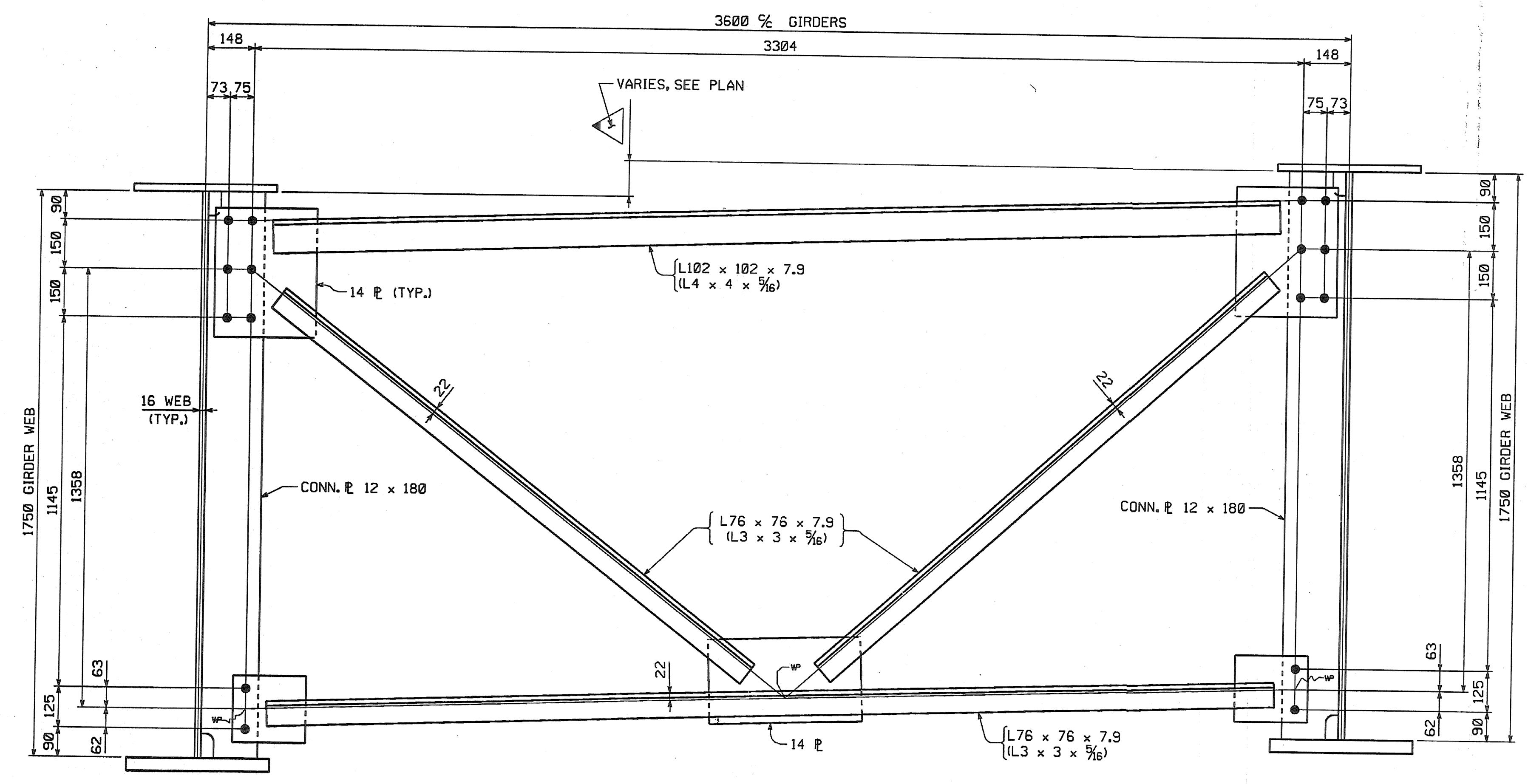

INTERMEDIATE CROSSFRAME LAYOUT
 (BAY 1 & BAY 2 - LOOKING STATIONS AHEAD)

****NOTE****
 THE PURPOSE OF THIS DRAWING IS TO COORDINATE GEOMETRIC CONTROL INFORMATION. THIS DRAWING IS SUBMITTED FOR INFORMATION ONLY AND IS NOT INTENDED FOR SHOP FABRICATION. THIS DRAWING IS FOR REFERENCE ONLY, APPROVAL IS NOT REQUIRED.

SHOP DRAWING REVIEW

REVIEWED AS REQUIRED BY THE CONSTRUCTION CONTRACT DOCUMENTS AND APPROVED, BUT ONLY FOR CONFORMANCE TO THE DESIGN CONCEPT OF THE WORK, AND SUBJECT TO FURTHER LIMITATIONS AND REQUIREMENTS CONTAINED IN THE CONSTRUCTION CONTRACT DOCUMENTS.

REJECTED REVISE AND RESUBMIT FURNISH AS CORRECTED

CORRECTIONS OR COMMENTS MADE ON THE SHOP DRAWINGS DURING THIS REVIEW DO NOT RELIEVE CONTRACTOR FROM COMPLIANCE WITH REQUIREMENTS OF THE DRAWINGS AND SPECIFICATIONS. THIS CHECK IS ONLY FOR REVIEW OF GENERAL CONFORMANCE WITH THE DESIGN CONCEPT OF THE PROJECT AND GENERAL COMPLIANCE WITH THE INFORMATION GIVEN IN THE CONTRACT DOCUMENTS. THE CONTRACTOR IS RESPONSIBLE FOR CONFIRMING AND CORRECTING ALL QUANTITIES AND DIMENSIONS; SELECTING FABRICATION PROCESSES AND TECHNIQUES OF CONSTRUCTION; COORDINATING HIS WORK WITH THAT OF ALL OTHER TRADES; AND PERFORMING HIS WORK IN A SAFE AND SATISFACTORY MANNER.

VHB Vanasse Hangen Brustlin, Inc.
 Engineers, Planners, and Scientists
 66 Bedford Farm, Milton Rd.
 Bedford, NH 03110 603 444 6888

Job Number: 503.11
 Reviewed By: JMA
 Date: 11/10/04

NOTES:
 FOR NOTES, SEE DRAWING WS1.
 WORK THIS DRAWING WITH DRAWINGS WS1 THRU WS12.
 ALL HOLES TO BE 1/16" FOR 1/8" H.S. BOLTS.

△			
△			
△			
NO.	REVISION	BY	DATE
HIGH STEEL STRUCTURES, INC. 1770 Hempstead Road Lancaster, PA 17605-0008 Phone 717/299-5211 A Division of HSB Industries, Inc.			
TYPICAL DETAILS ~ CROSSFRAME LAYOUTS VT 78 OVER MISSISSQUOI BAY, BRIDGE NO. 2 VT 78 STA. 10+970.425 TO STA. 12+059.775 TOWNS OF ALBURG AND SWANTON COUNTIES OF GRAND ISLE AND FRANKLIN STATE OF VERMONT, AGENCY OF TRANSPORTATION			
STATE CONTRACT OR REF. NO.	BRF-036-1(1)		
CONTRACTOR	CIAMBRO CORPORATION		
IN CHARGE:	GLIDDEN (IH)	MADE BY:	JSA
		CHK'D BY:	DAP
CONTRACT NUMBER:	VT-04057-1,2&3	DATE:	8-16-04
DRAWING NUMBER:	TD2 OF TD4		

By: dpanter
 PLOTTED: 8/23/2004 12:55:02 PM