

**ORIGINAL STRUCTURE:**  
BUILT: 1926  
PROJECT NO. FAP 65-A  
DESIGN LOADING: H-15

**WIDENING:**  
DESIGN LOADING: HS-20  
DESIGN STRESS IN STEEL: 18 KSI

- LIST OF SHEETS**
1. PLAN & DETAILS OF WIDENING
  2. SCB-D8-67 @ (1-24-62)
  3. SCB-D9-67 (1-24-62)

W#15,832 over Smith Brook

**STATE OF VERMONT**  
DEPARTMENT OF HIGHWAYS

TOWN OF JOHNSON  
ROUTE NO. VT. 15 LOG STA. 93+17  
SARGENT BRIDGE

PLAN & DETAILS OF WIDENING  
SCALE AS NOTED  
SECTION SUPERVISOR R.L. MERCHANT  
DRAWN BY SDB/68 CHECKED BY R. WATSON 10-68  
PROJECT NO. BMA 6808  
SHEET 1 OF 5

GRADE DAIL REQUIRED

LEFT	
4178 - 4170	Length 32 ft
4178 - 4160	112 "
RIGHT	
4100 - 4100	Length 40 ft
4170 - 4150	24 "
4100 - 4080	20 "
<b>TOTAL</b>	<b>236 ft</b>
<b>RIGHT</b>	<b>Length 150 ft</b>
<b>3100 - 4+80</b>	<b>TOTAL 386 ft</b>

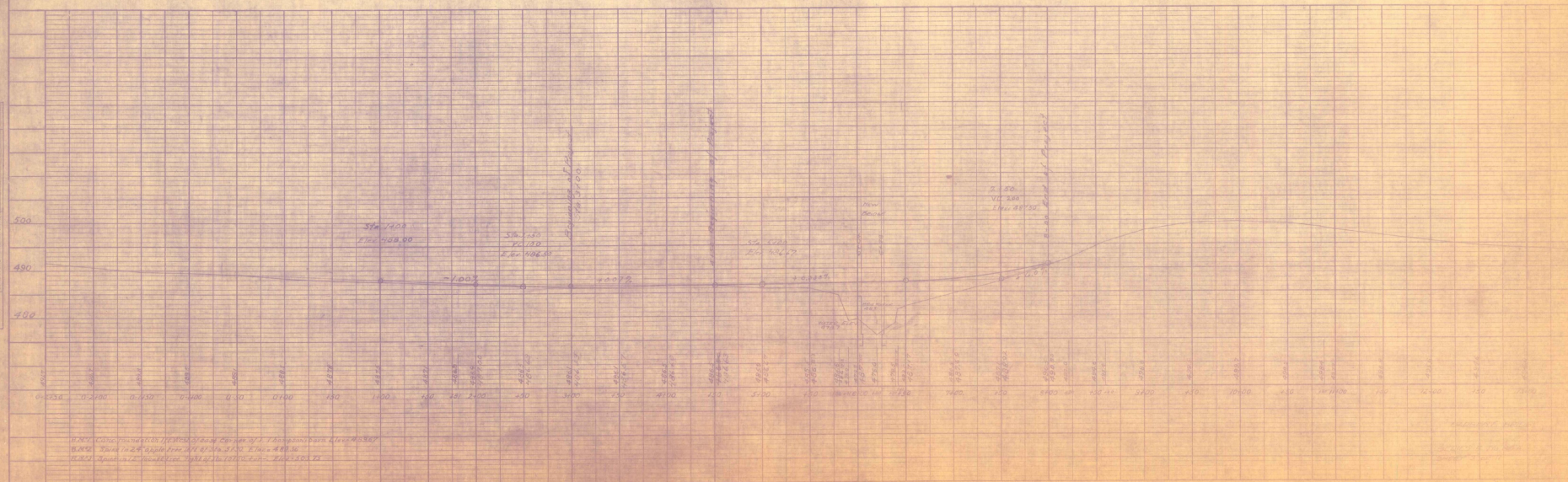
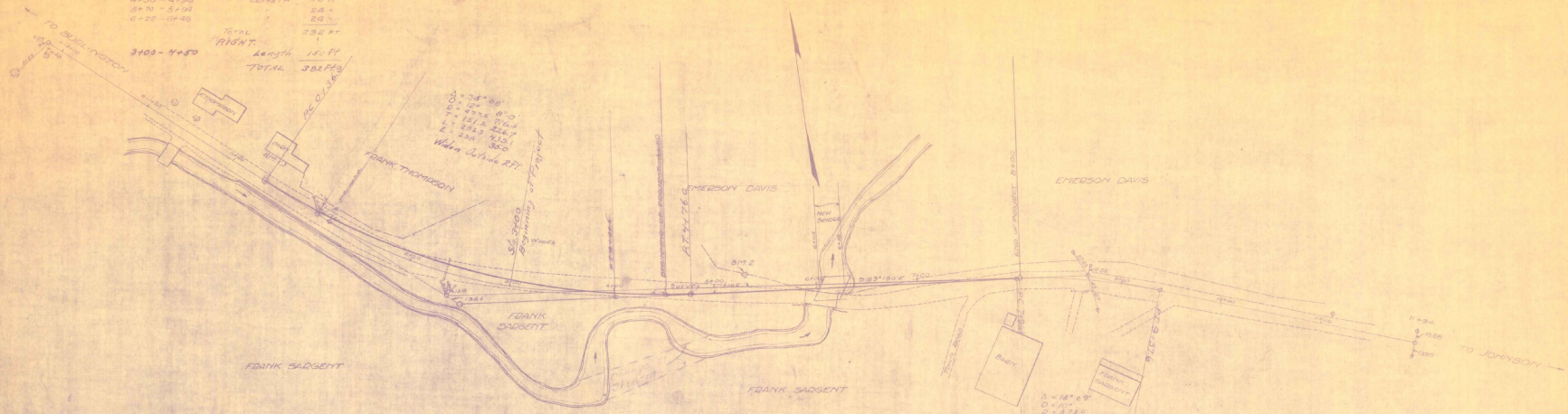

PLAN  
 DATE  
 DRAWN BY  
 CHECKED BY  
 NO.

PLAN  
 DATE  
 DRAWN BY  
 CHECKED BY  
 NO.

100' = 1" (Vertical)  
 100' = 1" (Horizontal)



809 1925 3 11

Note: Exact length and angle of abut. may be changed by Engr. in field.

Similar to Elev. E.B.

W

M

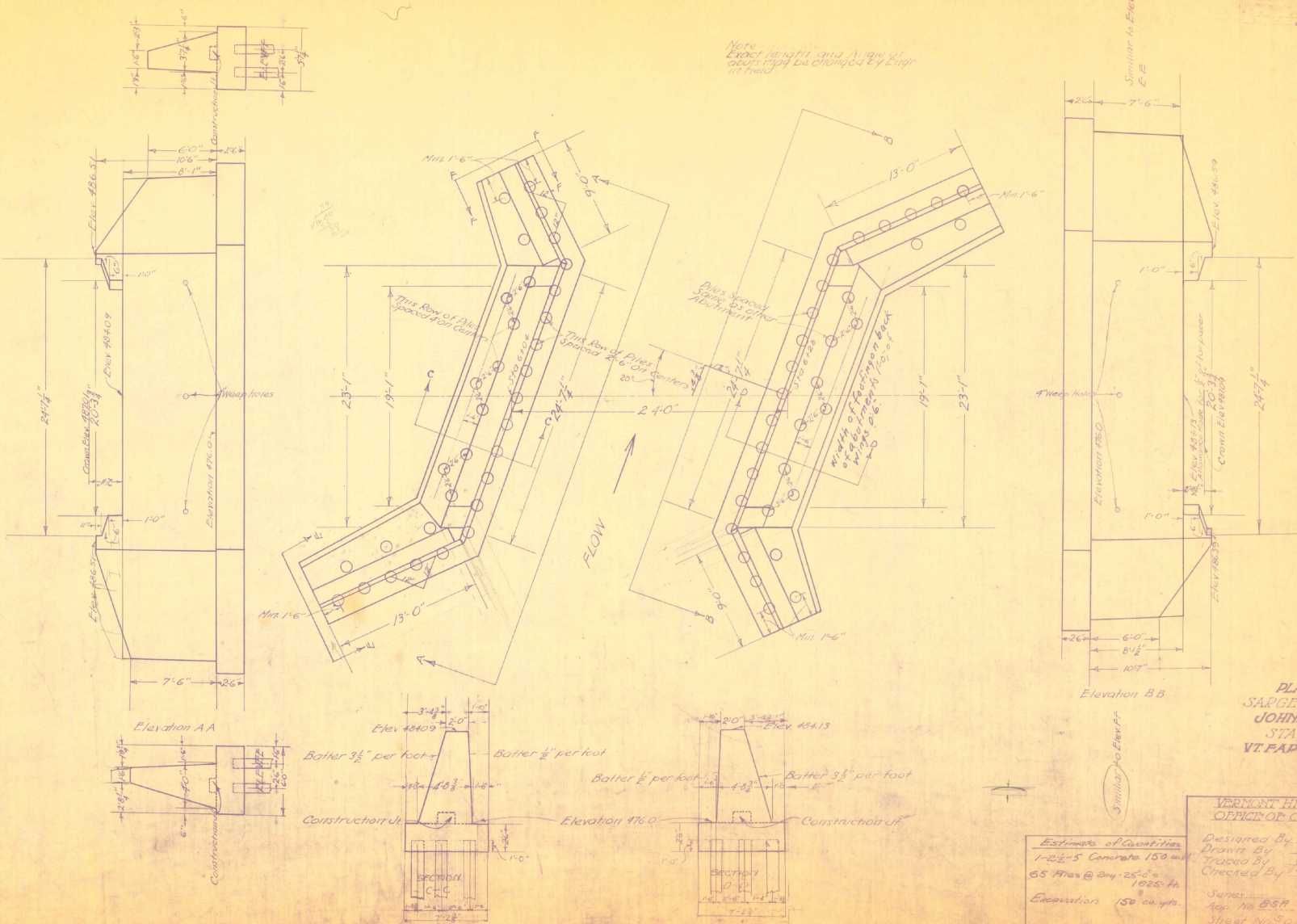

**PLAN OF SARGENT BRIDGE JOHNSON VT STA 6+16 VT. P.A.P. NO. 85A.**

VERMONT HIGHWAY DEPT. OFFICE OF CHIEF ENGR.

Designed By A.D.B.  
 Drawn By J.S.P.  
 Traced By J.S.P.  
 Checked By J.S.P.  
 Series 1925  
 App. No. 85A  
 Sheet No. 5 of 11 Sheets

Estimate of Quantities  
 1-2 1/2-5 Concrete 150 cu. yds.  
 65 Piles @ 24'-25' 1925 ft.  
 Excavation 150 cu. yds.

Bridge  
1969

Johnson  
BMA 6808

1969

M  
JOHNSON

M

BMA 6808

Vt #15, B32 over Smith Brook

Widening  
1969