

STATE OF VERMONT AGENCY OF TRANSPORTATION

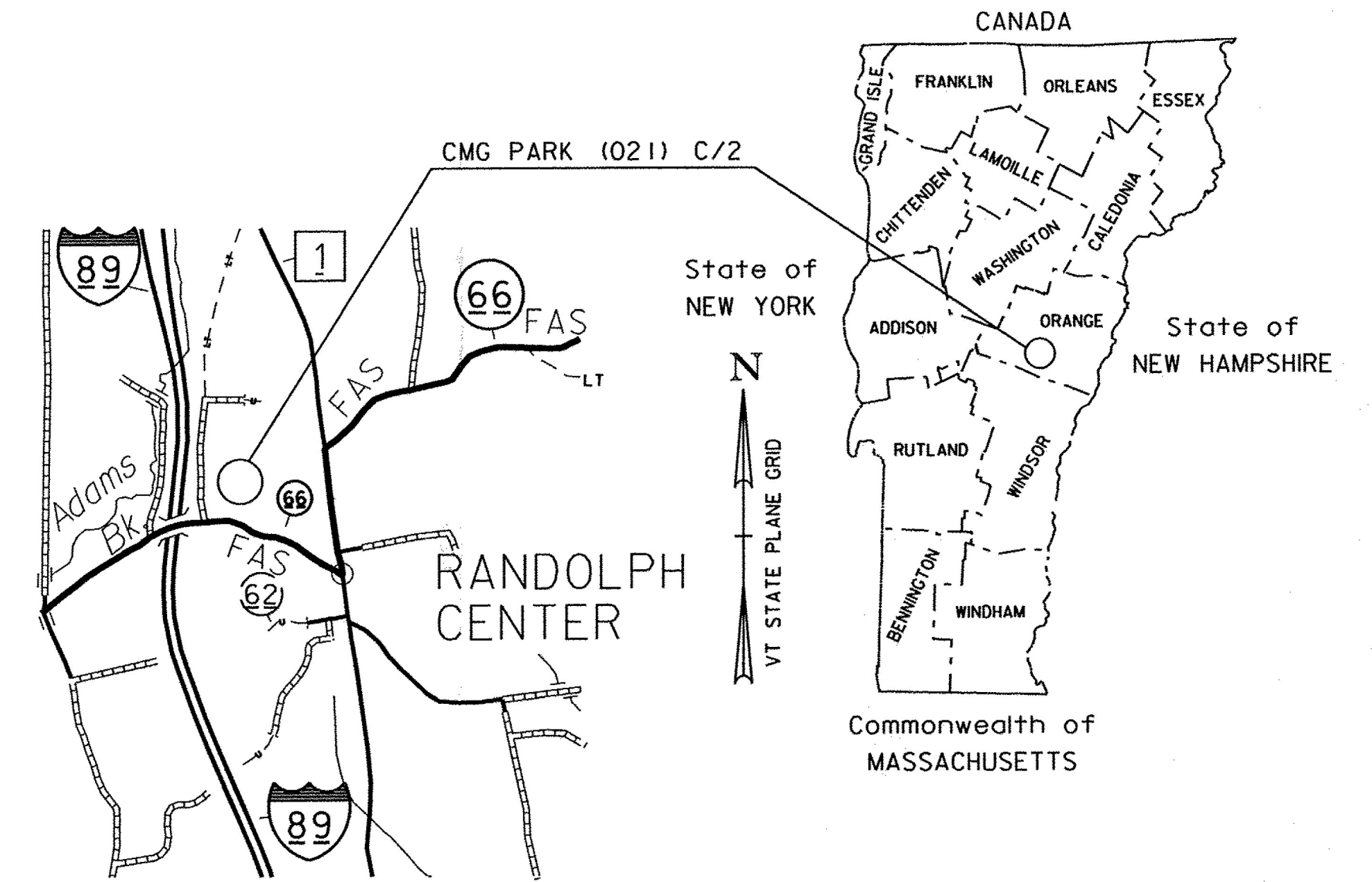

PROPOSED IMPROVEMENT PARK AND RIDE PROJECT

TOWN OF RANDOLPH
COUNTY OF ORANGE



Record Plans
 Contractor: J. HUTCHINS, INC.
 Resident Engineer: TOM CHASE
 Construction Began: AUGUST 29, 2017
 Construction Complete: SEPTEMBER 20, 2018
 Record Plans By: TOM CHASE & JESSE IVES

I hereby certify that all construction required by this set of drawings has been accomplished as indicated herein.

E-SIGNED by Thomas Chase
 on 2019-01-08 12:54:13 UTC
 Resident Engineer

Date: January 08, 2019

NOTE: Any further information concerning final quantities, amounts or other details relative to this project may be found at Central Files in the electronic archives.

- PROJECT LOCATION: LOCATED IN THE COUNTY OF ORANGE, TOWN OF RANDOLPH, ON THE EAST SIDE OF THE INTERSECTION OF VT ROUTE 66 AND BETTIS ROAD JUST EAST OF 1-89 EXIT 4.
- PROJECT DESCRIPTION: REMOVAL OF THE EXISTING POROUS CONCRETE PAVEMENT AND CHOKER COURSE, REMOVAL OF THE EXISTING ISLAND, AND CONSTRUCTION OF NEW OPEN-GRADED FRICTION COURSE IN THE PARKING STALLS AND STANDARD BITUMINOUS PAVEMENT IN THE PARKING LOT AISLES, PAVEMENT MARKINGS, SIGNS, CEDAR FENCING, AND OTHER HIGHWAY RELATED ITEMS.
- LENGTH OF PROJECT: 210.30 FT (0.039 MILES)

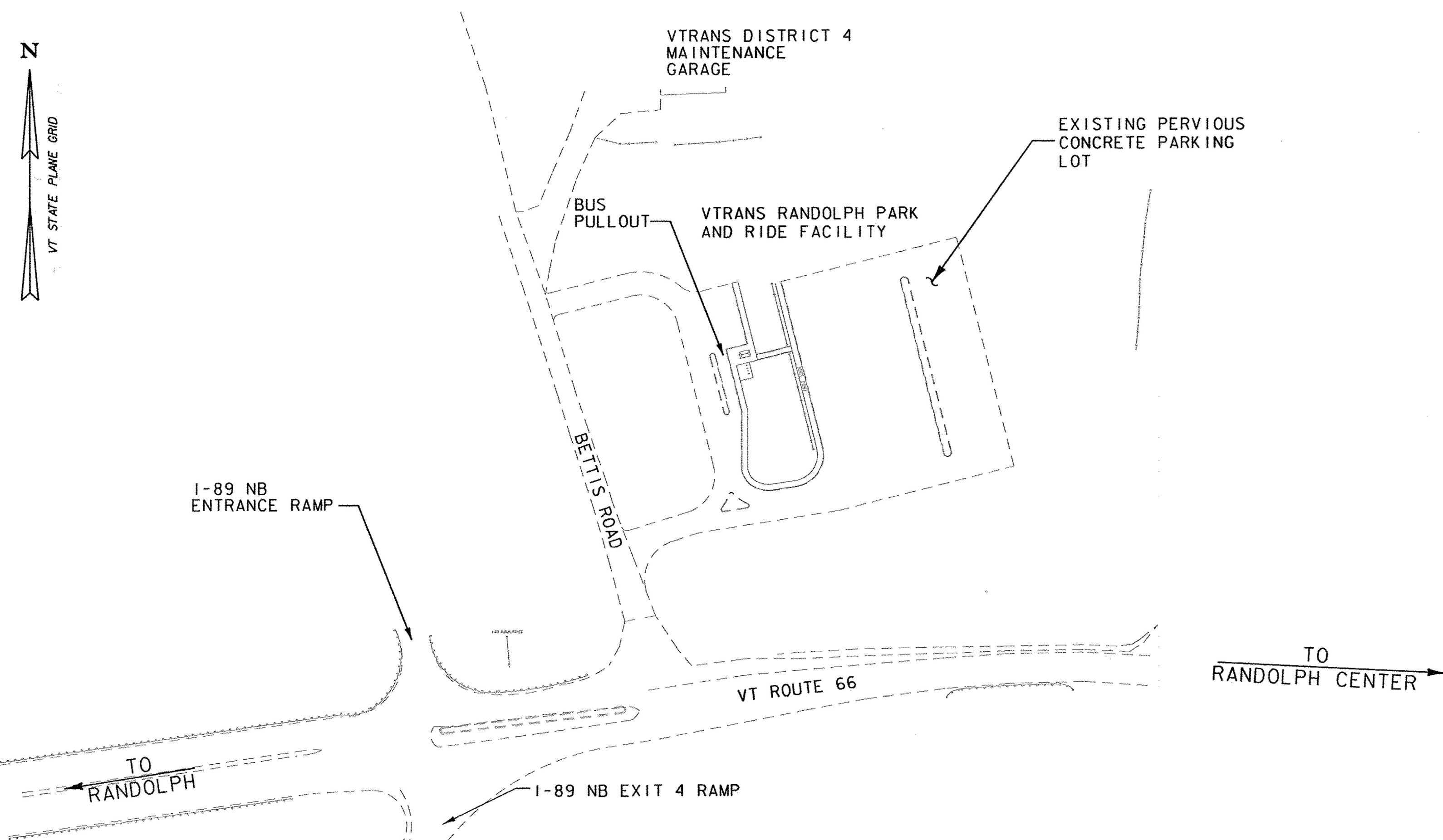

CONSTRUCTION IS TO BE CARRIED ON IN ACCORDANCE WITH THESE PLANS AND THE STANDARD SPECIFICATIONS FOR CONSTRUCTION DATED 2011, AS APPROVED BY THE FEDERAL HIGHWAY ADMINISTRATION ON JULY 20, 2011 FOR USE ON THIS PROJECT, INCLUDING ALL SUBSEQUENT REVISIONS AND SUCH REVISED SPECIFICATIONS AND SPECIAL PROVISIONS AS ARE INCORPORATED IN THESE PLANS.

QUALITY ASSURANCE PROGRAM : LEVEL I	
SURVEYED BY : VERMONT SURVEY AND ENGINEERING INC.	
SURVEYED DATE : 04/02	
DATUM	
VERTICAL	NAVD 88
HORIZONTAL	NAD 83 (1996) VT SPC (FEET)

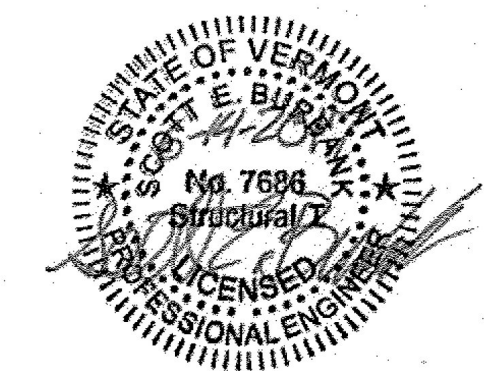

BUILT AS DESIGNED

DIRECTOR OF MUNICIPAL ASSISTANCE BUREAU	
APPROVED <i>Susan E. Dwin</i>	DATE 01/14/2019
PROJECT MANAGER : WAYNE DAVIS	
PROJECT NAME : RANDOLPH PARK AND RIDE LOT	
PROJECT NUMBER : CMG PARK (021) C/2	
SHEET 1 OF 1 SHEETS	



INDEX OF SHEETS

1. TITLE SHEET
2. INDEX OF SHEETS AND SIGN DETAILS SHEET
- 3-4. TYPICAL SECTIONS SHEETS
5. PROJECT NOTES
- 6-7. QUANTITY SHEETS
8. CONVENTIONAL SYMBOLOGY LEGEND
9. LAYOUT SHEET
10. UTILITY SHEET
11. EVI CHARGING STATION DETAILS
12. PAVEMENT MARKING & SIGNING PLAN
13. TRAFFIC SIGN SUMMARY SHEET
14. PHASED CONSTRUCTION SHEET
15. CONSTRUCTION APPROACH SIGNING SHEET

VAOT STANDARDS

D-20	HIGHWAY CROSSING FOR UNDERGROUND UTILITIES	03-03-2003
E-121	STANDARD SIGN PLACEMENT - CONVENTIONAL ROAD	08-08-1995
E-131	GUIDE SIGN DETAILS	08-08-1995
E-173	PULL BOXES AND JUNCTION BOXES	08-09-1995
E-175	POWER DROP STANSHIONS	06-08-2009
E-191	PAVEMENT MARKING DETAILS	02-01-1999
E-192	PAVEMENT MARKING DETAILS	10-12-2000
E-193	PAVEMENT MARKING DETAILS	08-18-1995
T-1	TRAFFIC CONTROL GENERAL NOTES	04-25-2016
T-2	TRAFFIC SIGN GENERAL NOTES	04-25-2016
T-10	CONVENTIONAL ROADS CONSTRUCTION APPROACH SIGNING	08-06-2012
T-28	CONSTRUCTION SIGN DETAILS	08-06-2012
T-30	CONSTRUCTION SIGN DETAILS	08-06-2012
T-35	CONSTRUCTION SONE LONGITUDINAL DROP-OFFS	08-06-2012
T-36	CONSTRCUTION ZONE LONGITUDINAL DROP-OFFS FOR PAVING	08-06-2012
T-45	SQUARE TUBE SIGN POST AND ANCHOR	01-02-2013
T-70	VERMONT REGULATORY SIGN DETAILS	04-25-2016

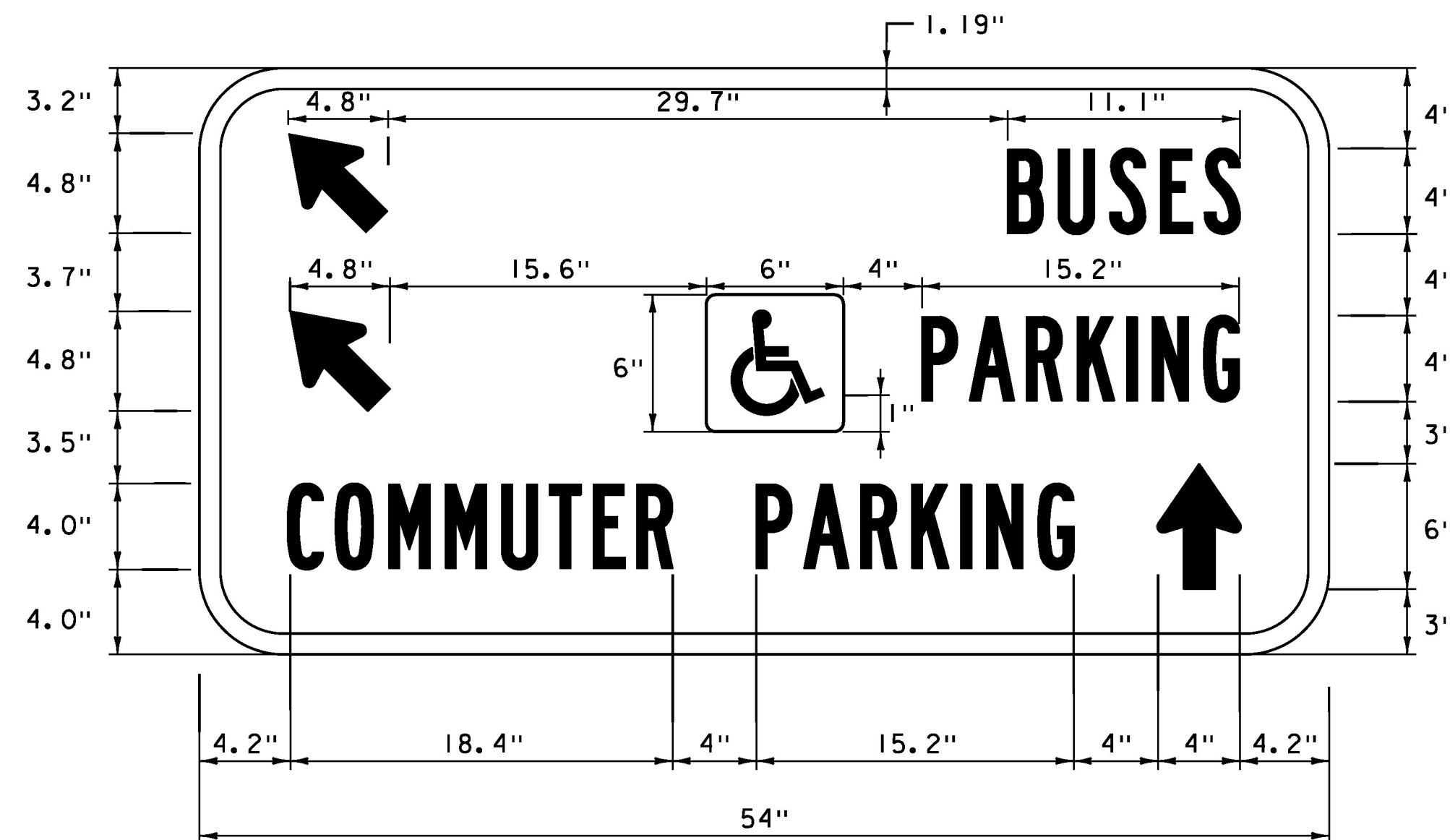

WHITE (RETROFLECTIVE) TEXT, ARROWS & BORDERS
 WHITE (RETROFLECTIVE) ACCESSIBILITY SYMBOL ON BLUE (RETROFLECTIVE) BACKGROUND
 BROWN (RETROFLECTIVE) BACKGROUND
 SEE VTRANS STRANDARD E-131 FOR MATERIALS

SIGNAGE DETAIL 1
 NOT TO SCALE



WHITE BORDER AND TEXT (RETROFLECTIVE)
 BLUE BACKGROUND (RETROFLECTIVE)
 SEE VAOT STANDARD T-2

SIGNAGE DETAIL 11
 NOT TO SCALE



PROJECT NAME:	RANDOLPH PARK AND RIDE LOT		
PROJECT NUMBER:	CMG PARK (021) C/2		
FILE NAME:	z17c060Index.dgn	PLOT DATE:	6/14/2017
PROJECT LEADER:	S.E. BURBANK	DRAWN BY:	J.D. KEENER
DESIGNED BY:	J.D. KEENER	CHECKED BY:	E.P. DETRICK
INDEX OF SHEETS AND SIGN DETAILS SHEET	SHEET	2	OF 15

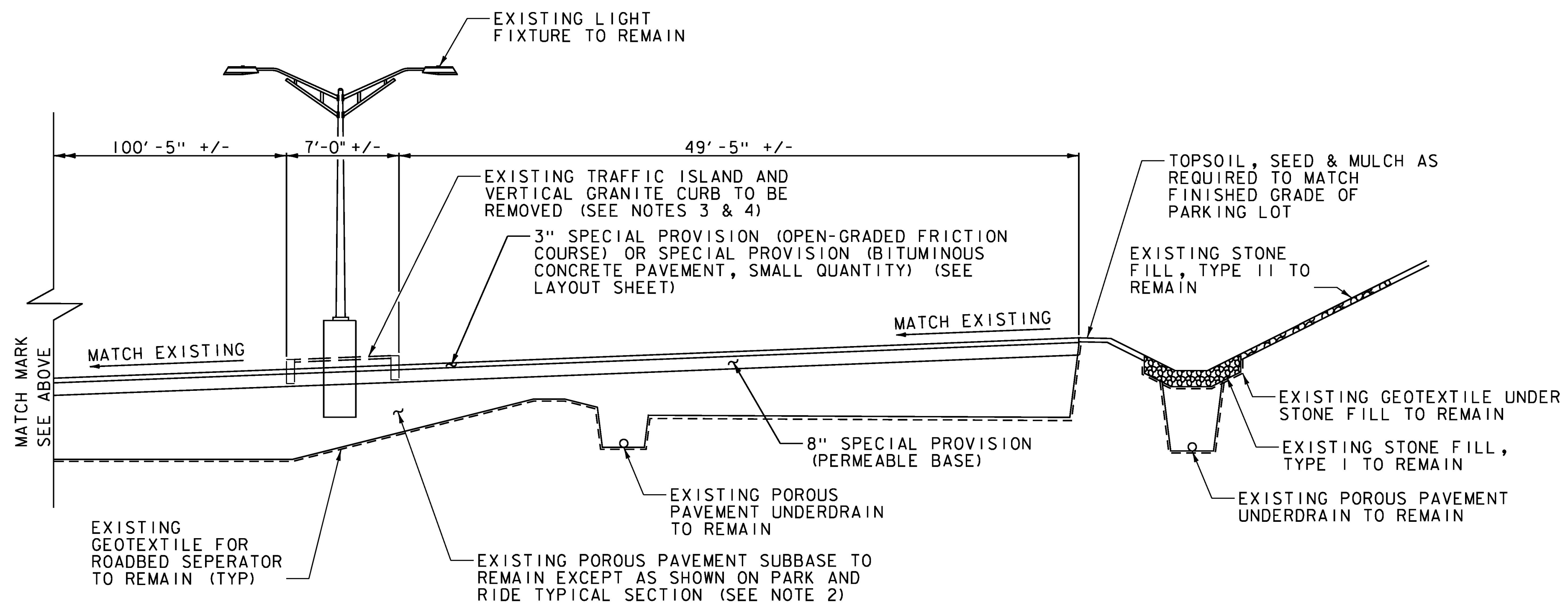
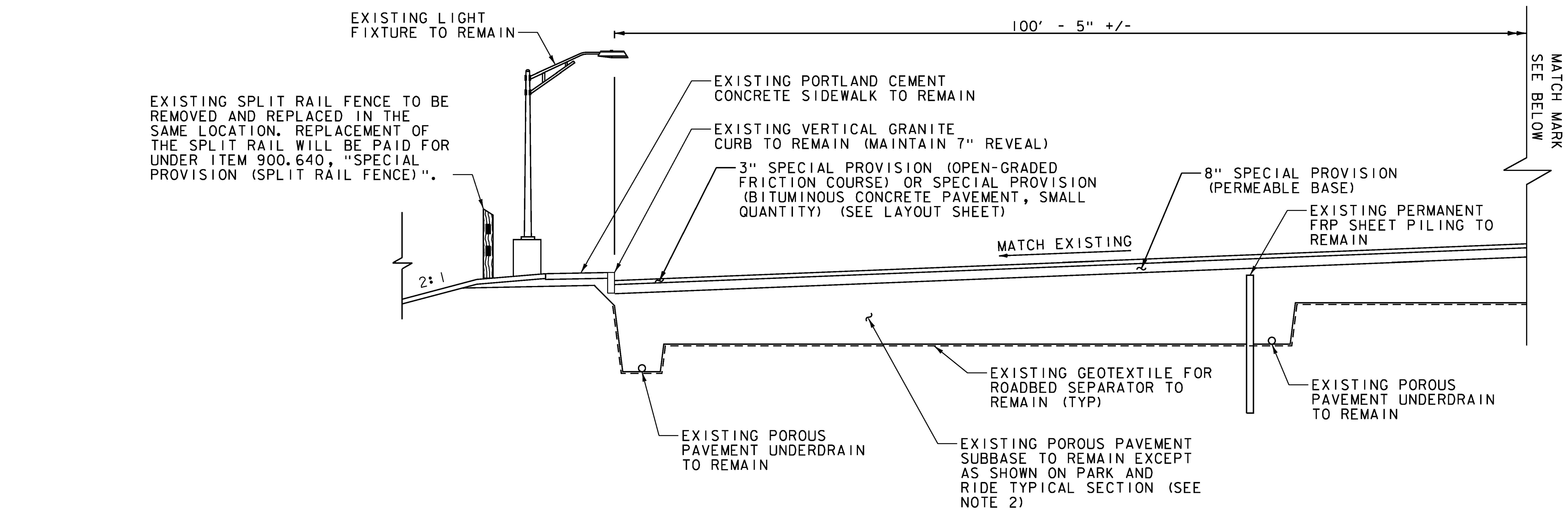

PARK AND RIDE SECTION LOT - LOOKING NORTH
NOT TO SCALE

NOTES:

1. SEE PROJECT NOTES SHEET FOR ADDITIONAL INFORMATION.
2. SEE PARK AND RIDE TYPICAL SECTION ON TYPICAL SECTIONS (SHEET 2 OF 2) FOR ADDITIONAL INFORMATION AND LIMITS ON THE REMOVAL OF THE EXISTING POROUS PAVEMENT SUBBASE.
3. GRANITE CURB TO BE SALVAGED AND DELIVERED TO THE DISTRICT GARAGE. COST FOR DELIVERY WILL BE INCIDENTAL TO ITEM 616.41 "REMOVAL OF EXISTING CURB".
4. REMOVAL OF ISLAND WILL BE PAID FOR UNDER ITEM 203.28 "EXCAVATION OF SURFACES AND PAVEMENTS".

PROJECT NAME:	RANDOLPH PARK AND RIDE LOT
PROJECT NUMBER:	CMG PARK (02) C/2
FILE NAME:	z17c060+yp.dgn
PROJECT LEADER:	S.E. BURBANK
DESIGNED BY:	J.D. KEENER
TYPICAL SECTIONS (SHEET 1 OF 2)	
PLOT DATE:	6/15/2017
DRAWN BY:	J.D. KEENER
CHECKED BY:	E.P. DETRICK
	SHEET 3 OF 15



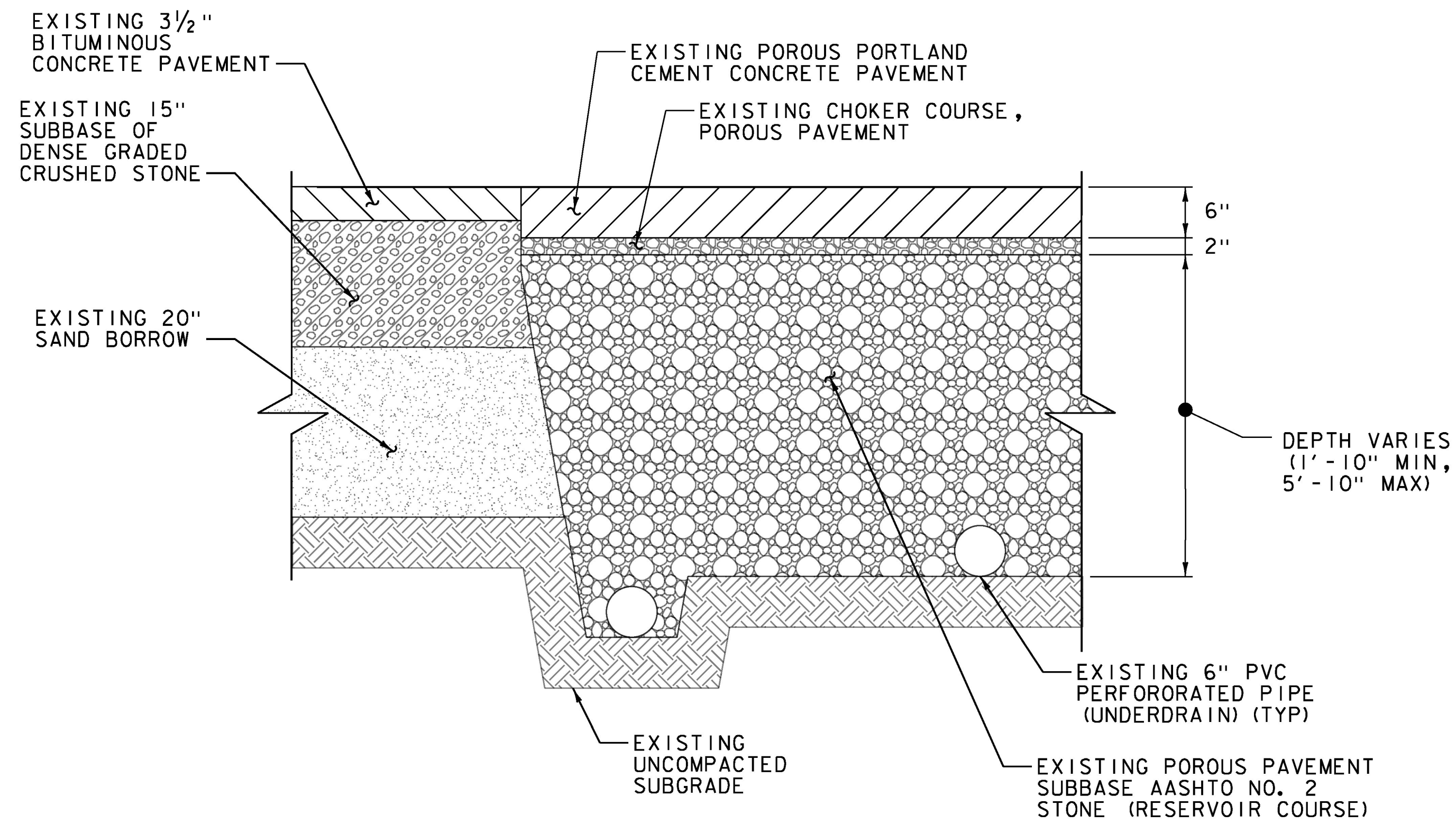

EXISTING PARK AND RIDE TYPICAL SECTION
NOT TO SCALE

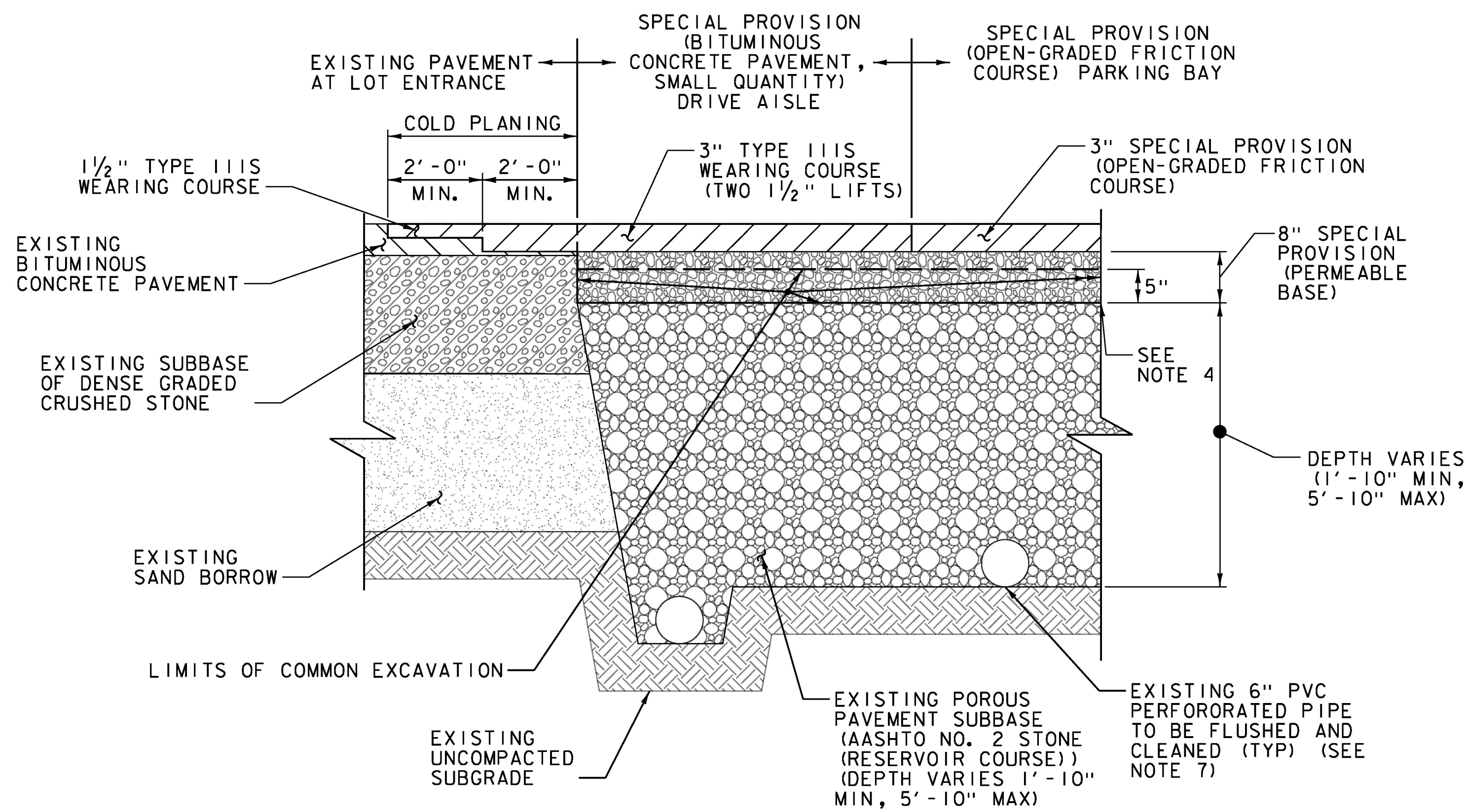

PARK AND RIDE TYPICAL SECTION
NOT TO SCALE

NOTES:

1. SEE PROJECT NOTES SHEET FOR ADDITIONAL INFORMATION.
2. EXISTING CHOKER COURSE SHALL BE REMOVED IN ITS ENTIRETY. REMOVAL OF THE EXISTING CHOKER COURSE SHALL BE PAID FOR UNDER ITEM 203.15, "COMMON EXCAVATION".
3. 3" OF THE EXISTING POROUS PAVEMENT SUBBASE SHALL BE REMOVED. REMOVAL OF THE EXISTING POROUS PAVEMENT SUBBASE WILL BE PAID FOR UNDER ITEM 203.15, "COMMON EXCAVATION".
4. THE EXISTING SUBBASE TO REMAIN SHALL BE FINE GRADED AND COMPACTED IN ACCORDANCE WITH SPECIAL PROVISION (FINE GRADING OF SUBBASE) PRIOR TO THE INSTALLATION OF THE SPECIAL PROVISION (PERMEABLE BASE).
5. CONTRACTOR SHALL KEEP EXISTING SUBBASE FREE OF DEBRIS AND/OR SEDIMENT DURING FINE GRADING, COMPACTION AND PLACEMENT OF PERMEABLE BASE.
6. FLUSHING AND CLEANING OF THE EXISTING UNDERDRAINS AND DRAINAGE STRUCTURES WILL BE PAID FOR UNDER ITEM 900.625, "SPECIAL PROVISION (FLUSHING AND CLEANING UNDERDRAINS AND DRAINAGE STRUCTURES)".

PROJECT NAME:	RANDOLPH PARK AND RIDE LOT
PROJECT NUMBER:	CMG PARK (02) C/2
FILE NAME: z17c060+yp.dgn	PLOT DATE: 6/15/2017
PROJECT LEADER: S.E. BURBANK	DRAWN BY: J.D. KEENER
DESIGNED BY: J.D. KEENER	CHECKED BY: E.P. DETRICK
TYPICAL SECTIONS (SHEET 2 OF 2)	SHEET 4 OF 15



PROJECT NOTES

GENERAL

1. ALL MATERIALS AND CONSTRUCTION SHALL CONFORM TO THE STATE OF VERMONT AGENCY OF TRANSPORTATION STANDARD SPECIFICATIONS FOR CONSTRUCTION, DATED 2011 AND ITS LATEST REVISIONS.
2. ALL DIMENSIONS ARE HORIZONTAL OR VERTICAL, AND ARE GIVEN AT 68 DEGREES FAHRENHEIT, UNLESS NOTED OTHERWISE.
3. EXISTING CONDITIONS ARE BASED ON AN APRIL 2002 SURVEY CONDUCTED BY VERMONT SURVEY AND ENGINEERING, INC. AND MERGED WITH A PROPOSED CONDITIONS PLAN FROM FEBRUARY 2009 DEVELOPED BY STANTEC.
4. THE FINISH GRADE OF THE OPEN GRADED FRICTION COURSE AND BITUMINOUS CONCRETE PAVEMENT SHALL MATCH THE EXISTING GRADE OF THE CURRENT PARK AND RIDE UPPER LOT. THE CONTRACTOR SHALL DETERMINE THE EXISTING GRADE OF THE PARK AND RIDE LOT ALONG WITH THE CURB REVEAL USING TOPOGRAPHICAL SURVEY, SPOT ELEVATIONS, ETC. TO THE SATISFACTION OF THE ENGINEER TO BE ABLE TO MATCH THE EXISTING GRADE OF THE PARK AND RIDE UPPER LOT. ALL COSTS FOR DETERMINING THE EXISTING GRADE OF THE PARK AND RIDE TO THE SATISFACTION OF THE ENGINEER WILL BE PAID FOR UNDER ALL CONTRACT ITEMS.
5. THE EXISTING TEMPORARY CONCRETE TRAFFIC BARRIER SHALL BE REMOVED AND DELIVERED TO THE DISTRICT GARAGE AT 100 BETTIS RD, RANDOLPH CENTER, VT 05061. THE CONTRACTOR SHALL CONTACT DISTRICT 4 GENERAL MANAGER TREVOR STAR AT (802) 296-5566 TO COORDINATE DELIVERY OF THE TEMPORARY CONCRETE TRAFFIC BARRIER. ALL COSTS ASSOCIATED WITH THE REMOVAL, COORDINATION, AND DELIVERY OF THE TEMPORARY TRAFFIC BARRIER WILL BE PAID FOR UNDER ITEM 621.95 "REMOVE AND RESET TEMPORARY TRAFFIC BARRIER".
6. THE EXISTING SPLIT RAIL FENCE ON THE WEST SIDE OF THE UPPER LOT OF THE PARK AND RIDE SHALL BE REMOVED AND REPLACED. REMOVAL OF THE EXISTING FENCE WILL BE PAID FOR UNDER ITEM 620.55, "REMOVAL OF EXISTING FENCE". REPLACEMENT OF THE EXISTING FENCE WILL BE PAID FOR UNDER ITEM 900.640, "SPECIAL PROVISION (SPLIT RAIL FENCE)".
7. TACK COAT: EMULSIFIED ASPHALT IS TO BE APPLIED AT A RATE OF 0.050 GAL/SY BETWEEN SUCCESSIVE COURSES OF PAVEMENT, AND 0.080 GAL/SY ON MILLED SURFACES AS DIRECTED BY THE ENGINEER. EMULSIFIED ASPHALT WILL BE PAID FOR UNDER ITEM 404.65, "EMULSIFIED ASPHALT".

UTILITIES

8. THE LOCATIONS, SIZES, AND TYPES OF EXISTING UTILITIES ARE SHOWN AS AN APPROXIMATE REPRESENTATION ONLY. THE LOCATIONS OF THE EXISTING UTILITIES HAS NOT BEEN VERIFIED. THE UTILITY INFORMATION SHOWN DOES NOT GUARANTEE THE ACTUAL EXISTENCE, SERVICEABILITY, OR OTHER DATA CONCERNING THE UTILITIES, NOR DOES IT GUARANTEE AGAINST THE POSSIBILITY THAT ADDITIONAL UTILITIES MAY BE PRESENT THAT ARE NOT SHOWN ON THE PLANS.
9. WHERE AN EXISTING UTILITY IS FOUND TO CONFLICT WITH THE PROPOSED WORK, OR EXISTING CONDITIONS DIFFER FROM THOSE SHOWN SUCH THAT THE WORK CANNOT BE COMPLETED AS INTENDED, THE LOCATION, ELEVATION, AND SIZE OF THE UTILITY SHALL BE ACCURATELY DETERMINED AND THE INFORMATION FURNISHED IN WRITING TO THE ENGINEER.

TRAFFIC CONTROL

10. THE PARK AND RIDE SHALL REMAIN OPEN DURING CONSTRUCTION. ACCESS SHALL BE MAINTAINED AT ALL TIMES TO THE LOWER PORTION OF THE EXISTING PARK AND RIDE, BUS SHELTER, BICYCLE RACK, AND THE SIDEWALK ON THE WESTERN SIDE OF THE UPPER LOT. THE PARK AND RIDE SHALL BE CONSTRUCTED IN PHASES TO MAINTAIN HALF OF THE UPPER PARK AND RIDE LOT AS SHOWN ON THE PHASED CONSTRUCTION SHEET.
11. THE TRAFFIC CONTROL PLAN FOR CONSTRUCTION OF THE PARK AND RIDE IS INCLUDED HEREIN ON THE CONSTRUCTION APPROACH SIGNING SHEET AND THE PHASED CONSTRUCTION SHEET. THE CONTRACTOR SHALL SUBMIT FOR APPROVAL ANY NECESSARY MODIFICATIONS OR SUPPLEMENTS TO THE TRAFFIC CONTROL PLAN TO ACCOMMODATE SITE SPECIFIC ISSUES AND/OR OPERATIONS FOR THE CONSTRUCTION OF THE PARK AND RIDE. THE PHASING OF THE PARK AND RIDE LOT SHALL BE IN ACCORDANCE WITH THE PHASED CONSTRUCTION SHEET. ALL COSTS ASSOCIATED WITH DEVELOPING, SUBMITTING, AND REVISING THE CONTRACTOR'S TRAFFIC CONTROL PLAN WILL BE INCLUDED IN ITEM 641.10, "TRAFFIC CONTROL".
12. IN THE EVENT OF AN EMERGENCY VEHICLE ENTERING OR EXITING THE CONSTRUCTION AREA, ALL WORK WILL BE IMMEDIATELY STOPPED AND A CLEAR TRAVEL LANE WILL BE PROVIDED TO THE EMERGENCY VEHICLE. WORK CREWS AND FLAGGERS WILL COMMUNICATE THROUGH RADIO AND ENSURE SAFE PASSAGE IS PROVIDED TO ALL EMERGENCY VEHICLES.
13. ALL COSTS ASSOCIATED WITH IMPLEMENTING TRAFFIC CONTROL, INCLUDING BUT NOT LIMITED TO THE INSTALLATION AND REMOVAL OF SIGNS AND SIGN POSTS, INSTALLATION AND MAINTENANCE OF THE DRUMS FOR THE FIRST PHASE OF CONSTRUCTION, REMOVAL AND RESETTING OF THE DRUMS FOR THE SECOND PHASE OF CONSTRUCTION WILL BE INCLUDED IN THE COST FOR ITEM 641.10, "TRAFFIC CONTROL".

14. PAYMENT FOR FLAGGERS WILL BE MADE UNDER ITEM 630.15, "FLAGGERS". PAYMENT FOR PORTABLE CHANGEABLE MESSAGE SIGN (PCMS) WILL BE MADE UNDER ITEM 641.15, "PORTABLE CHANGEABLE MESSAGE SIGN".

15. THE PCMS SHALL BE USED IN ACCORDANCE WITH SECTION 6F.60 OF THE MUTCD.

16. ALL SIGNS SHALL BE IN ACCORDANCE WITH THE 2009 EDITION OF THE "MANUAL ON UNIFORM TRAFFIC CONTROL DEVICES" (MUTCD), AND ITS LATEST REVISIONS AND THE 2004 EDITION OF THE "STANDARD HIGHWAY SIGNS AND MARKINGS" BOOK (SHSM), AND ITS 2012 SUPPLEMENT, PUBLISHED BY THE FEDERAL HIGHWAY ADMINISTRATION (FHWA).

EARTHWORK

17. SAW CUTTING OF THE EXISTING PAVEMENT AND POROUS CONCRETE SHALL BE INCIDENTAL TO ALL EXCAVATION ITEMS.
18. THE EXISTING PARKING LOT WAS ORIGINALLY CONSTRUCTED WITH POROUS CONCRETE, AND PORTIONS OF THE POROUS CONCRETE HAVE BEEN OVERLAID WITH BITUMINOUS CONCRETE PAVEMENT. REMOVAL OF THE EXISTING POROUS CONCRETE, OVERLAID BITUMINOUS CONCRETE PAVEMENT AND EXISTING BITUMINOUS CONCRETE PAVEMENT WILL BE PAID FOR UNDER ITEM 203.28, "EXCAVATION OF SURFACES AND PAVEMENTS".
19. THE CONTRACTOR SHALL REMOVE THE ENTIRE EXISTING CHOKER COURSE BELOW THE POROUS CONCRETE AND BITUMINOUS CONCRETE PAVEMENT. REMOVAL OF THE EXISTING CHOKER COURSE WILL BE PAID FOR UNDER ITEM 203.15, "COMMON EXCAVATION".
20. THE CONTRACTOR SHALL REMOVE THE EXISTING SUBBASE TO ALLOW FOR THE INSTALLATION OF 8" OF SPECIAL PROVISION (PERMEABLE BASE) AND 3" OF SPECIAL PROVISION (OPEN GRADED FRICTION COURSE) OR SPECIAL PROVISION (BITUMINOUS CONCRETE PAVEMENT, SMALL QUANTITY). REMOVAL OF THE EXISTING SUBBASE WILL BE PAID FOR UNDER ITEM 203.15, "COMMON EXCAVATION".
21. THE EXISTING SUBBASE SHALL BE FINE GRADED AND COMPACTED PRIOR TO THE PLACEMENT OF THE SPECIAL PROVISION (PERMEABLE BASE). PAYMENT FOR FINE GRADING AND COMPACTING THE EXISTING SUBBASE WILL BE PAID FOR UNDER ITEM 900.675, "SPECIAL PROVISION (FINE GRADING OF SUBBASE)". SEE SPECIAL PROVISION FOR ADDITIONAL INFORMATION.
22. THE EXISTING GRANITE CURB IN THE TRAFFIC ISLAND SHALL BE REMOVED AND DELIVERED TO THE DISTRICT GARAGE AT 100 BETTIS RD, RANDOLPH CENTER, VT 05061. THE CONTRACTOR SHALL CONTACT DISTRICT 4 GENERAL MANAGER TREVOR STAR AT (802) 296-5566 TO COORDINATE DELIVERY OF THE GRANITE CURB. ALL COSTS ASSOCIATED WITH THE REMOVAL, COORDINATION, AND DELIVERY OF THE GRANITE CURB WILL BE PAID FOR UNDER ITEM 616.41, "REMOVAL OF EXISTING CURB".

DRAINAGE

23. ALL MONITORING WELLS WITHIN THE EXISTING TRAFFIC ISLAND THAT IS TO BE REMOVED SHALL BE LOWERED TO MATCH THE FINISH GRADE. THE COST FOR LOWERING THE MONITORING WELLS WILL BE PAID FOR UNDER ITEM 900.620 "SPECIAL PROVISION (ADJUSTING ELEVATION OF MONITORING WELLS)". SEE SPECIAL PROVISION FOR ADDITIONAL INFORMATION.
24. ALL UNDERDRAINS AND DRAINAGE STRUCTURES SHALL BE FLUSHED AND CLEANED TO REMOVE EXISTING DEBRIS AND SEDIMENT. THE COST FOR FLUSHING AND CLEANING THE UNDERDRAINS AND DRAINAGE STRUCTURES WILL BE PAID FOR UNDER ITEM 900.625, "SPECIAL PROVISION (FLUSHING AND CLEANING UNDERDRAINS AND DRAINAGE STRUCTURES)". SEE SPECIAL PROVISIONS FOR ADDITIONAL INFORMATION.
25. THE FINISH GRADE FOR ALL EXISTING DROP INLETS (DI) AND STORMWATER MANHOLES SHALL MATCH THE FINISHED GRADE OF THE OPEN GRADED FRICTION COURSE AND THE BITUMINOUS CONCRETE PAVEMENT. IN THE EVENT IT IS NECESSARY TO MODIFY THE ELEVATION OF A DI OR STORMWATER MANHOLE ITEM 604.40, "CHANGING ELEVATION OF DROP INLETS, CATCH BASIN, OR MAHHOLES" HAS BEEN INCLUDED WITH AN ESTIMATED QUANTITY OF 4 EACH.



PROJECT NAME:	RANDOLPH PARK AND RIDE LOT
PROJECT NUMBER:	CMG PARK (021) C/2
FILE NAME:	z17c060pn.dgn
PROJECT LEADER:	S.E. BURBANK
DESIGNED BY:	J.D. KEENER
PROJECT NOTES	
PLOT DATE:	6/15/2017
DRAWN BY:	J.D. KEENER
CHECKED BY:	E.P. DETRICK
SHEET	5 OF 15

QUANTITY SHEET 1

SUMMARY OF ESTIMATED QUANTITIES										TOTALS		DESCRIPTIONS				DETAILED SUMMARY OF QUANTITIES			
								ROADWAY	EROSION CONTROL	FULL C.E.	GRAND TOTAL	FINAL	UNIT	ITEMS	ITEM NUMBER	ROUND	QUANTITIES	UNIT	ITEMS
								480			480		CY	COMMON EXCAVATION	203.15				
								620			620		CY	EXCAVATION OF SURFACES AND PAVEMENTS	203.28				
								6			6		CY	TRENCH EXCAVATION OF EARTH	204.20				
								1			1		CY	TRENCH EXCAVATION OF EARTH, EXPLORATORY (N.A.B.I.)	204.22				
								25			25		SY	COLD PLANING, BITUMINOUS PAVEMENT	210.10				
								30			30		CWT	EMULSIFIED ASPHALT	404.65				
								1			1		LU	PRICE ADJUSTMENT, ASPHALT CEMENT (N.A.B.I.)	406.50				
								4			4		EACH	CHANGING ELEVATION OF DROP INLETS, CATCH BASINS, OR MANHOLES	604.40				
								330			330		LF	REMOVAL OF EXISTING CURB	616.41				
								145			145		LF	REMOVAL OF EXISTING FENCE	620.55				
								265			265		LF	REMOVE AND RESET TEMPORARY TRAFFIC BARRIER	621.95				
								720			720		HR	FLAGGERS	630.15				
										1	1		LS	TESTING EQUIPMENT, BITUMINOUS	631.17				
								1			1		LS	MOBILIZATION/DEMOBILIZATION	635.11				
								1			1		LS	TRAFFIC CONTROL	641.10				
								2			2		EACH	PORTABLE CHANGEABLE MESSAGE SIGN	641.15				
								3525			3525		LF	DURABLE 4 INCH WHITE LINE	646.400				
								8			8		EACH	DURABLE LETTER OR SYMBOL	646.490				
								95			95		LF	TEMPORARY 4 INCH WHITE LINE, TEMPORARY PAVEMENT MARKING TAPE	646.6011				
								14			14		EACH	TEMPORARY LETTER OR SYMBOL, TEMPORARY PAVEMENT MARKING TAPE	646.6911				
								300			300		SF	REMOVAL OF EXISTING PAVEMENT MARKINGS	646.85				
									2		2		LB	SEED	651.15				
									10		10		LB	FERTILIZER	651.18				
									1		1		TON	AGRICULTURAL LIMESTONE	651.20				
									1		1		TON	HAY MULCH	651.25				
									5		5		CY	TOPSOIL	651.35				
									715		715		LF	PROJECT DEMARCATION FENCE	653.55				
								66			66		SF	TRAFFIC SIGNS, TYPE A	675.20				
								75			75		LF	SQUARE TUBE SIGN POST AND ANCHOR	675.341				
								2			2		EACH	ERECTING SALVAGED SIGNS	675.60				
								3			3		EACH	SETTING SALVAGED POSTS	675.61				
								14			14		LF	WIRED CONDUIT (2")(PVC)(SCH. 80)	678.23				
								6100			6100		LF	ELECTRICAL WIRING	678.24				
								1			1		EACH	PULL BOX, STANDARD	678.25				
								1			1		LU	PRICE ADJUSTMENT, FUEL (N.A.B.I.)	690.50				
								5			5		EACH	SPECIAL PROVISION (ADJUSTING ELEVATION OF MONITORING WELLS)	900.620				
								7			7		EACH	SPECIAL PROVISION (ELECTRIC VEHICLE OUTLET, LEVEL 1)	900.620				
								100			100		GAL	SPECIAL PROVISION (FLUSHING AND CLEANING UNDERDRAINS AND DRAINAGE STRUCTURES)	900.625				
								145			145		LF	SPECIAL PROVISION (SPLIT RAIL FENCE)	900.640				
								1			1		LS	SPECIAL PROVISION (ASPHALT FIELD PERMEAMETER KIT)	900.645				

PROJECT NAME: RANDOLPH PARK AND RIDE LOT
 PROJECT NUMBER: CMG PARK (021) C/2
 FILE NAME: z17c060qs.dgn PLOT DATE: 6/15/2017
 PROJECT LEADER: S.E. BURBANK DRAWN BY: M.F. SUFFEL
 DESIGNED BY: E.P. DETRICK CHECKED BY: J.D. KEENER
 QUANTITY SHEET (1 OF 2) SHEET 6 OF 15



GENERAL INFORMATION

SYMBOLGY LEGEND NOTE

THE SYMBOLGY ON THIS SHEET IS INTENDED TO COVER STANDARD CONVENTIONAL SYMBOLGY. THE SYMBOLGY IS USED FOR EXISTING & PROPOSED FEATURES WITH HEAVIER LINEWEIGHT, IN COMBINATION WITH PROJECT ANNOTATION, AS NOTED ON PROJECT PLAN SHEETS. THIS LEGEND SHEET COVERS THE BASICS. SYMBOLGY ON PLANS MAY VARY, PLAN ANNOTATIONS AND NOTES SHOULD BE USED TO CLARIFY AS NEEDED.

R.O.W. ABBREVIATIONS (CODES) & SYMBOLS

POINT CODE	DESCRIPTION
CH	CHANNEL EASEMENT
CONST	CONSTRUCTION EASEMENT
CUL	CULVERT EASEMENT
D&C	DISCONNECT & CONNECT
DIT	DITCH EASEMENT
DR	DRAINAGE EASEMENT
DRIVE	DRIVEWAY EASEMENT
EC	EROSION CONTROL
HWY	HIGHWAY EASEMENT
I&M	INSTALL & MAINTAIN EASEMENT
LAND	LANDSCAPE EASEMENT
R&RES	REMOVE & RESET
R&REP	REMOVE & REPLACE
SR	SLOPE RIGHT
UE	UTILITY EASEMENT
(P)	PERMANENT EASEMENT
(T)	TEMPORARY EASEMENT
■	BNDNS BOUND SET
▣	BNDNS BOUND TO BE SET
●	IPNS IRON PIN SET
⊙	IPNS IRON PIN TO BE SET
⊠	CALC EXISTING ROW POINT
○	PROW PROPOSED ROW POINT
[LENGTH]	LENGTH CARRIED ON NEXT SHEET

COMMON TOPOGRAPHIC POINT SYMBOLS

POINT CODE	DESCRIPTION
⊠	APL BOUND APPARENT LOCATION
□	BM BENCHMARK
▣	BND BOUND
▣	CB CATCH BASIN
⊕	COMB COMBINATION POLE
▣	DITHR DROP INLET THROATED DNC
⊕	EL ELECTRIC POWER POLE
○	FPOLE FLAGPOLE
○	GASFIL GAS FILLER
○	GP GUIDE POST
×	GSO GAS SHUT OFF
○	GUY GUY POLE
○	GUYW GUY WIRE
×	GV GATE VALVE
⊕	H TREE HARDWOOD
△	HCTRL CONTROL HORIZONTAL
△	HVCTRL CONTROL HORIZ. & VERTICAL
◇	HYD HYDRANT
●	IP IRON PIN
●	IPIPE IRON PIPE
⊕	LI LIGHT - STREET OR YARD
⊕	MB MAILBOX
○	MH MANHOLE (MH)
●	MM MILE MARKER
●	PM PARKING METER
▣	PMK PROJECT MARKER
●	POST POST STONE/WOOD
⊕	RRSIG RAILROAD SIGNAL
⊕	RRSL RAILROAD SWITCH LEVER
⊕	S TREE SOFTWOOD
⊕	SAT SATELLITE DISH
⊕	SHRUB SHRUB
⊕	SIGN SIGN
⊕	STUMP STUMP
○	TEL TELEPHONE POLE
○	TIE TIE
⊕	TSIGN SIGN W/DOUBLE POST
⊕	VCTRL CONTROL VERTICAL
○	WELL WELL
×	WSO WATER SHUT OFF

THESE ARE COMMON VAOT SURVEY POINT SYMBOLS FOR EXISTING FEATURES, ALSO USED FOR PROPOSED FEATURES WITH HEAVIER LINEWEIGHT, IN COMBINATION WITH PROPOSED ANNOTATION.

PROPOSED GEOMETRY CODES

CODE	DESCRIPTION
PC	POINT OF CURVATURE
PI	POINT OF INTERSECTION
CC	CENTER OF CURVE
PT	POINT OF TANGENCY
PCC	POINT OF COMPOUND CURVE
PRC	POINT OF REVERSE CURVE
POB	POINT OF BEGINNING
POE	POINT OF ENDING
STA	STATION PREFIX
AH	AHEAD STATION SUFFIX
BK	BACK STATION SUFFIX
D	CURVE DEGREE OF (100FT)
R	CURVE RADUIS OF
T	CURVE TANGENT LENGTH
L	CURVE LENGTH OF
E	CURVE EXTERNAL DISTANCE

UTILITY SYMBOLGY

UNDERGROUND UTILITIES	
— UGU —	UTILITY (GENERIC-UNKNOWN)
— UT —	TELEPHONE
— UE —	ELECTRIC
— UC —	CABLE (TV)
— UEC —	ELECTRIC+CABLE
— UET —	ELECTRIC+TELEPHONE
— UCT —	CABLE+TELEPHONE
— UECT —	ELECTRIC+CABLE+TELEP.
— G —	GAS LINE
— W —	WATER LINE
— S —	SANITARY SEWER (SEPTIC)

ABOVE GROUND UTILITIES (AERIAL)	
— AGU —	UTILITY (GENERIC-UNKNOWN)
— T —	TELEPHONE
— E —	ELECTRIC
— C —	CABLE (TV)
— EC —	ELECTRIC+CABLE
— ET —	ELECTRIC+TELEPHONE
— AER E&T —	ELECTRIC+TELEPHONE
— CT —	CABLE+TELEPHONE
— ECT —	ELECTRIC+CABLE+TELEP.
— — —	UTILITY POLE GUY WIRE

PROJECT CONSTRUCTION SYMBOLGY	
— — — CZ — — —	CLEAR ZONE
— — — — —	PLAN LAYOUT MATCHLINE

PROJECT CONSTRUCTION FEATURES	
▲ — — — — —	TOP OF CUT SLOPE
● — — — — —	TOE OF FILL SLOPE
⊕ ⊕ ⊕ ⊕ ⊕	STONE FILL
— — — — —	BOTTOM OF DITCH
— — — — —	CULVERT PROPOSED
— — — — —	STRUCTURE SUBSURFACE
PDF — — — — — PDF	PROJECT DEMARCATION FENCE
BF — — — — — BF	BARRIER FENCE
XXXXXXXXXXXXXXXXXXXX	TREE PROTECTION ZONE (TPZ)
//// //// //// ////	STRIPING LINE REMOVAL
~~~~ ~~~~ ~~~~ ~~~~	SHEET PILES

CONVENTIONAL BOUNDARY SYMBOLGY	
— — — — —	TOWN BOUNDARY LINE
— — — — —	COUNTY BOUNDARY LINE
— — — — —	STATE BOUNDARY LINE
— — — — —	PROPOSED STATE R.O.W. (LIMITED ACCESS)
— — — — —	PROPOSED STATE R.O.W.
— — — — —	STATE ROW (LIMITED ACCESS)
— — — — —	STATE ROW
— — — — —	TOWN ROW
— — — — —	PERMANENT EASEMENT LINE (P)
— — — — —	TEMPORARY EASEMENT LINE (T)
— — — — —	SURVEY LINE
— — — — —	PROPERTY LINE (P/L)
— — — — —	SLOPE RIGHTS
6f — — — — — 6f	6F PROPERTY BOUNDARY
4f — — — — — 4f	4F PROPERTY BOUNDARY
HAZ — — — — — HAZ	HAZARDOUS WASTE

**EPSC LAYOUT PLAN SYMBOLGY**

EPSC MEASURES	
ONNOONNOONNO	FILTER CURTAIN
— — — — —	SILT FENCE
— — — — —	SILT FENCE WOVEN WIRE
— — — — —	CHECK DAM
— — — — —	DISTURBED AREAS REQUIRING RE-VEGETATION
— — — — —	EROSION MATTING

ENVIRONMENTAL RESOURCES	
— — — — —	WETLAND BOUNDARY
— — — — —	RIPARIAN BUFFER ZONE
— — — — —	WETLAND BUFFER ZONE
— — — — —	SOIL TYPE BOUNDARY
— — — — —	THREATENED & ENDANGERED SPECIES
HAZ — — — — — HAZ	HAZARDOUS WASTE AREA
AG — — — — —	AGRICULTURAL LAND
HABITAT — — — — —	FISH & WILDLIFE HABITAT
FLOOD PLAIN — — — — —	FLOOD PLAIN
OHW — — — — —	ORDINARY HIGH WATER (OHW)
— — — — —	STORM WATER
— — — — —	USDA FOREST SERVICE LANDS
— — — — —	WILDLIFE HABITAT SUIT/CONN

ARCHEOLOGICAL & HISTORIC	
— — — — —	ARCHEOLOGICAL BOUNDARY
— — — — —	HISTORIC DISTRICT BOUNDARY
— — — — —	HISTORIC AREA
(H)	HISTORIC STRUCTURE

CONVENTIONAL TOPOGRAPHIC SYMBOLGY	
— — — — —	EXISTING FEATURES
— — — — —	ROAD EDGE PAVEMENT
— — — — —	ROAD EDGE GRAVEL
— — — — —	DRIVEWAY EDGE
— — — — —	DITCH
— — — — —	FOUNDATION
— — — — —	FENCE (EXISTING)
— — — — —	FENCE WOOD POST
— — — — —	FENCE STEEL POST
— — — — —	GARDEN
— — — — —	ROAD GUARDRAIL
— — — — —	RAILROAD TRACKS
— — — — —	CULVERT (EXISTING)
— — — — —	STONE WALL
— — — — —	WALL
— — — — —	WOOD LINE
— — — — —	BRUSH LINE
— — — — —	HEDGE
— — — — —	BODY OF WATER EDGE
— — — — —	LEDGE EXPOSED

PROJECT NAME: RANDOLPH PARK AND RIDE LOT  
 PROJECT NUMBER: CMG PARK (02) C/2  
 FILE NAME: z17c060LegendSheet.dgn PLOT DATE: 6/14/2017  
 PROJECT LEADER: S.E. BURBANK DRAWN BY: VTRANS  
 DESIGNED BY: VTRANS CHECKED BY: J.D. KEENER  
 CONVENTIONAL SYMBOLGY LEGEND SHEET 8 OF 15



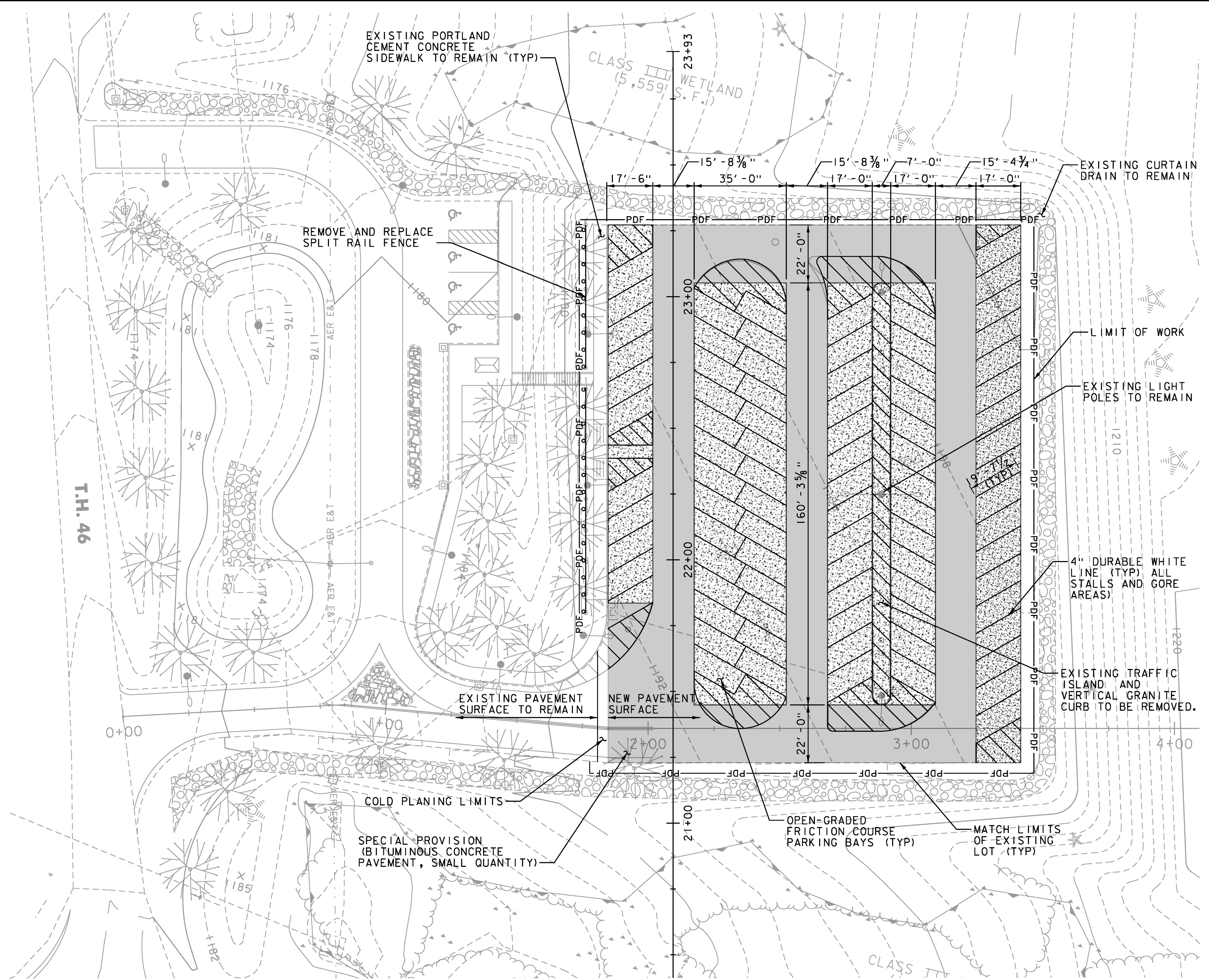
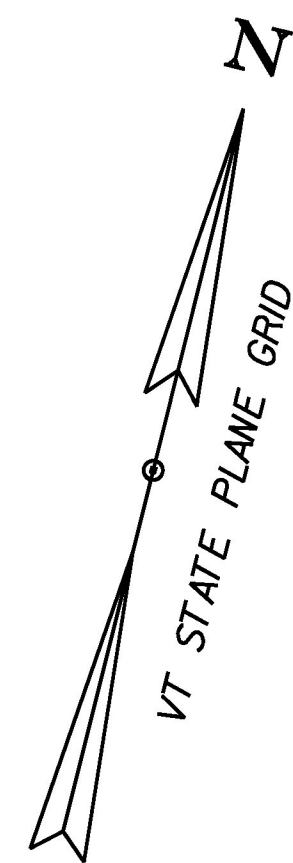

**LEGEND**

- = SPECIAL PROVISION (BITUMINOUS CONCRETE PAVEMENT SMALL QUANTITY)
- = SPECIAL PROVISION (OPEN-GRADED FRICTION COURSE)

**NOTE:**

1. SPECIAL PROVISION (BITUMINOUS CONCRETE PAVEMENT, SMALL QUANTITY) SHALL BE PLACED PRIOR TO THE PLACEMENT OF SPECIAL PROVISION (OPEN GRADED FRICTION COURSE).



PROJECT NAME:	RANDOLPH PARK AND RIDE LOT
PROJECT NUMBER:	CMG PARK (021) C/2
FILE NAME:	z17c060bdr.dgn
PROJECT LEADER:	S.E. BURBANK
DESIGNED BY:	J.D. KEENER
LAYOUT SHEET	
PLOT DATE:	6/14/2017
DRAWN BY:	J.D. KEENER
CHECKED BY:	E.P. DETRICK
SHEET	9 OF 15



**PULL BOX, STANDARD**  
 STA. 22+92, 52' LT

**WIRED CONDUIT (2") (PVC) (SCH 80)**  
 STA. 23+04, 55' RT TO 22+92, 52' RT

**SPECIAL PROVISION (ELECTRIC VEHICLE OUTLET, LEVEL 1)**

STA. 21+48, 36' LT (2)  
 STA. 22+25, 36' LT (2)  
 STA. 22+88, 66' RT (1)  
 STA. 23+02, 79' LT (2)

**SPECIAL PROVISION (ELECTRIC VEHICLE OUTLET, LEVEL 1)**

STA. 23+04, 55' LT TO 22+92, 52' LT  
 STA. 22+92, 59' LT TO 22+92, 52' LT  
 STA. 22+92, 52' LT TO 22+86, 32' LT  
 STA. 22+86, 32' LT TO 22+28, 33' LT  
 STA. 22+28, 33' LT TO 21+71, 34' LT  
 STA. 21+71, 34' LT TO 21+48, 79' RT  
 STA. 21+48, 79' LT TO 22+25, 79' RT  
 STA. 22+25, 79' RT TO 23+02, 79' RT

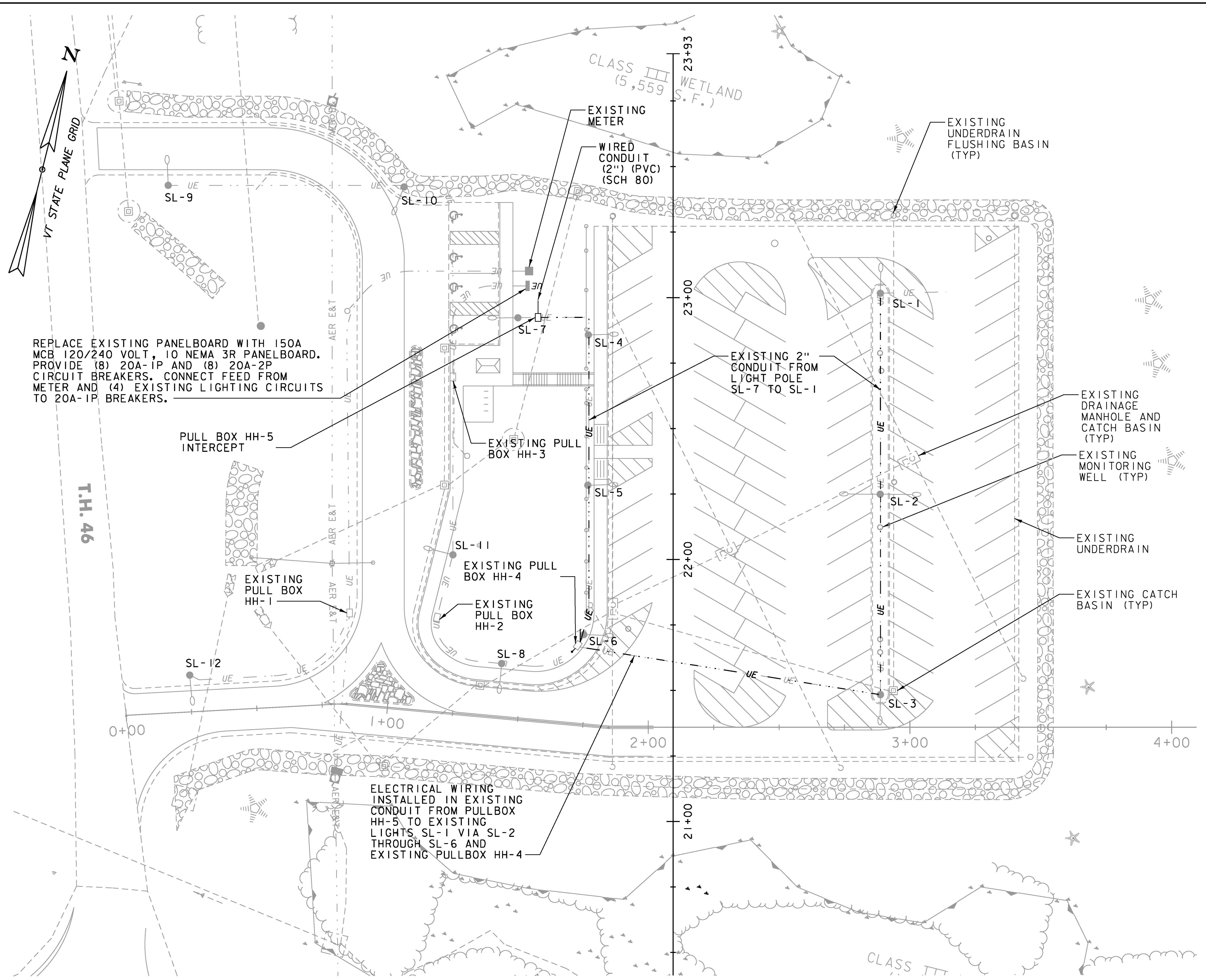

REPLACE EXISTING PANELBOARD WITH 150A MCB 120/240 VOLT, 10 NEMA 3R PANELBOARD. PROVIDE (8) 20A-1P AND (8) 20A-2P CIRCUIT BREAKERS. CONNECT FEED FROM METER AND (4) EXISTING LIGHTING CIRCUITS TO 20A-1P BREAKERS.

ELECTRICAL WIRING INSTALLED IN EXISTING CONDUIT FROM PULLBOX HH-5 TO EXISTING LIGHTS SL-1 VIA SL-2 THROUGH SL-6 AND EXISTING PULLBOX HH-4

**NOTES:**

1. ALL COSTS ASSOCIATED WITH INSTALLING WIRES THROUGH THE EXISTING CONDUIT AND CONNECTING THE WIRES TO THE PANELBOARD, BREAKERS, AND EVI RECEPTACLES WILL BE INCLUDED IN THE COST FOR ITEM 678.24, "ELECTRICAL WIRING".
2. ALL COSTS ASSOCIATED WITH INSTALLING THE WIRED ELECTRICAL CONDUIT WILL BE INCLUDED IN THE COST FOR ITEM 678.23, "WIRED CONDUIT (2") (PVC) (SCH 80)".
3. ALL COSTS ASSOCIATED WITH THE INSTALLATION OF THE NEW PANEL BOARD AND BREAKER INCLUDING REMOVING THE EXISTING PANELBOARD AND BREAKERS WILL BE PAID FOR UNDER ITEM 679.55 "POWER DROP STANCHION, STREET LIGHTING".
4. SEE EVI CHARGING STATION DETAILS SHEET FOR ADDITIONAL INFORMATION.
5. WATERPROOF DUPLEX RECEPTACLES WILL BE PAID FOR UNDER ITEM 900.620, (ELECTRIC VEHICLE OUTLET, LEVEL 1).

SCALE IN FEET  
 20 0 20



PROJECT NAME:	RANDOLPH PARK AND RIDE LOT
PROJECT NUMBER:	CMG PARK (021) C/2
FILE NAME:	z17c060u+111+tes.dgn
PROJECT LEADER:	S.E. BURBANK
DESIGNED BY:	J.D. KEENER
UTILITY SHEET	
PLOT DATE:	6/14/2017
DRAWN BY:	M.F. SUFFEL
CHECKED BY:	E.P. DETRICK
SHEET	10 OF 15

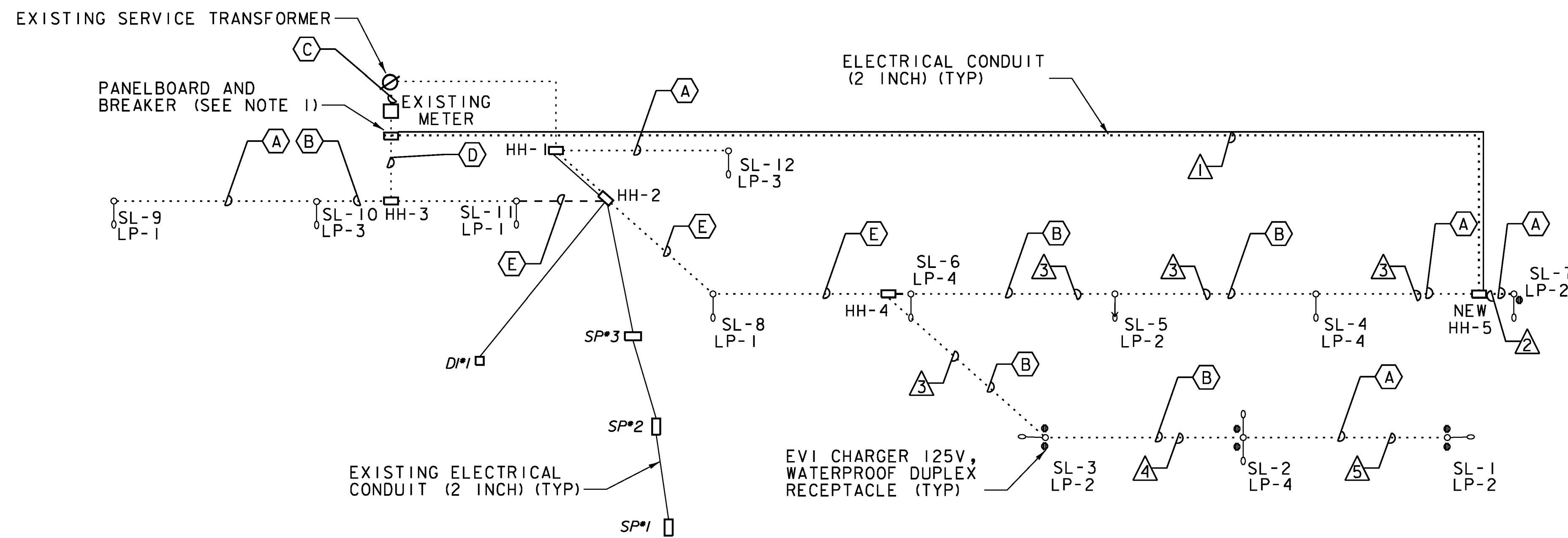

**ONE-LINE DIAGRAM  
SITE LIGHTING ALTERNATES**

NOT TO SCALE

**EXISTING CIRCUIT SCHEDULE**

- (A) (2) #6 WIRE, (1) #6G WIRE, 2" ELECTRICAL CONDUIT
- (B) (3) #6 WIRE, (1) #6G WIRE, 2" ELECTRICAL CONDUIT
- (C) (3) #10 WIRE, (1) #6G WIRE, 3" ELECTRICAL CONDUIT
- (D) (8) #6 WIRE, (1) #6G WIRE, 2" ELECTRICAL CONDUIT
- (E) (6) #6 WIRE, (1) #6G WIRE, 2" ELECTRICAL CONDUIT

**CIRCUIT SCHEDULE**

- △ (2) #6 WIRE AND (1) #6G WIRE  
STA. 23+04, 55' LT TO 22+92, 52' LT
- △ (3) #6 WIRE AND (1) #6G WIRE  
STA. 22+92, 59' LT TO 22+92, 52' LT
- △ (18) #6 WIRE AND (1) #6G WIRE  
STA. 22+92, 52' LT TO 22+86, 32' LT  
STA. 22+86, 32' LT TO 22+28, 33' LT  
STA. 22+28, 33' LT TO 21+71, 34' RT  
STA. 21+71, 34' LT TO 21+48, 79' RT
- △ (12) #6 WIRE AND (1) #6G WIRE  
STA. 21+48, 79' LT TO 22+25, 79' RT
- △ (6) #6 WIRE AND (1) #6G WIRE  
STA. 22+25, 79' RT TO 23+02, 79' RT

TENSION BAND FOR ROUND POLE FOR ATTACHING PORTABLE CHARGER RACK ABOVE OUTLET

WEATHERPROOF DUPLEX RECEPTACLE MOUNTED TO POLE COVER TO BE TAYMAC #20550C OR EQUIVALENT

PROVIDE 3/4" ELECTRICAL NIPPLE CONDUCTOR INTO LIGHT POLE. RUN WIRING IN POLE TO 2" CONDUITS. TYPICAL EACH RECEPTACLE

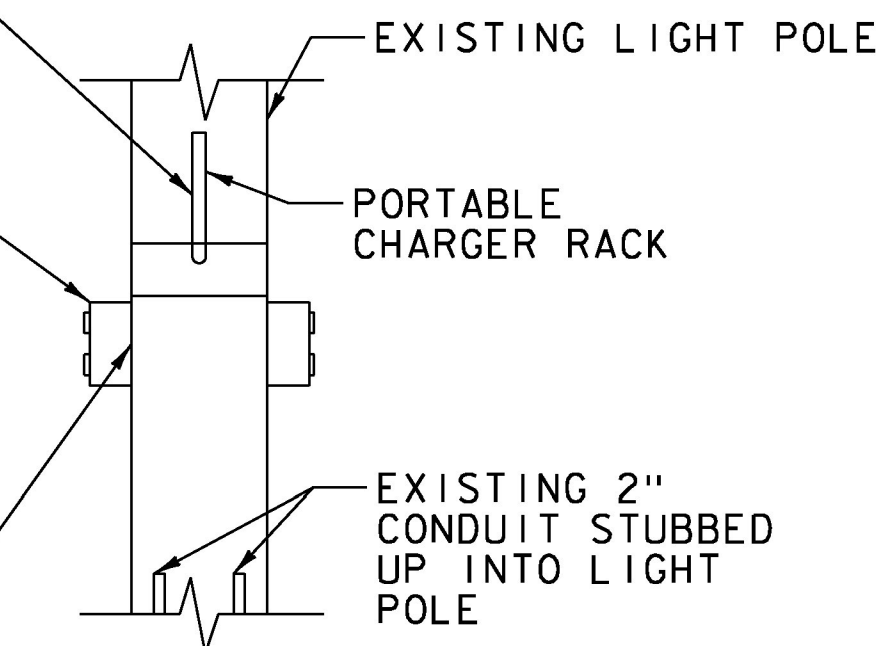

**ELEVATION "A"**

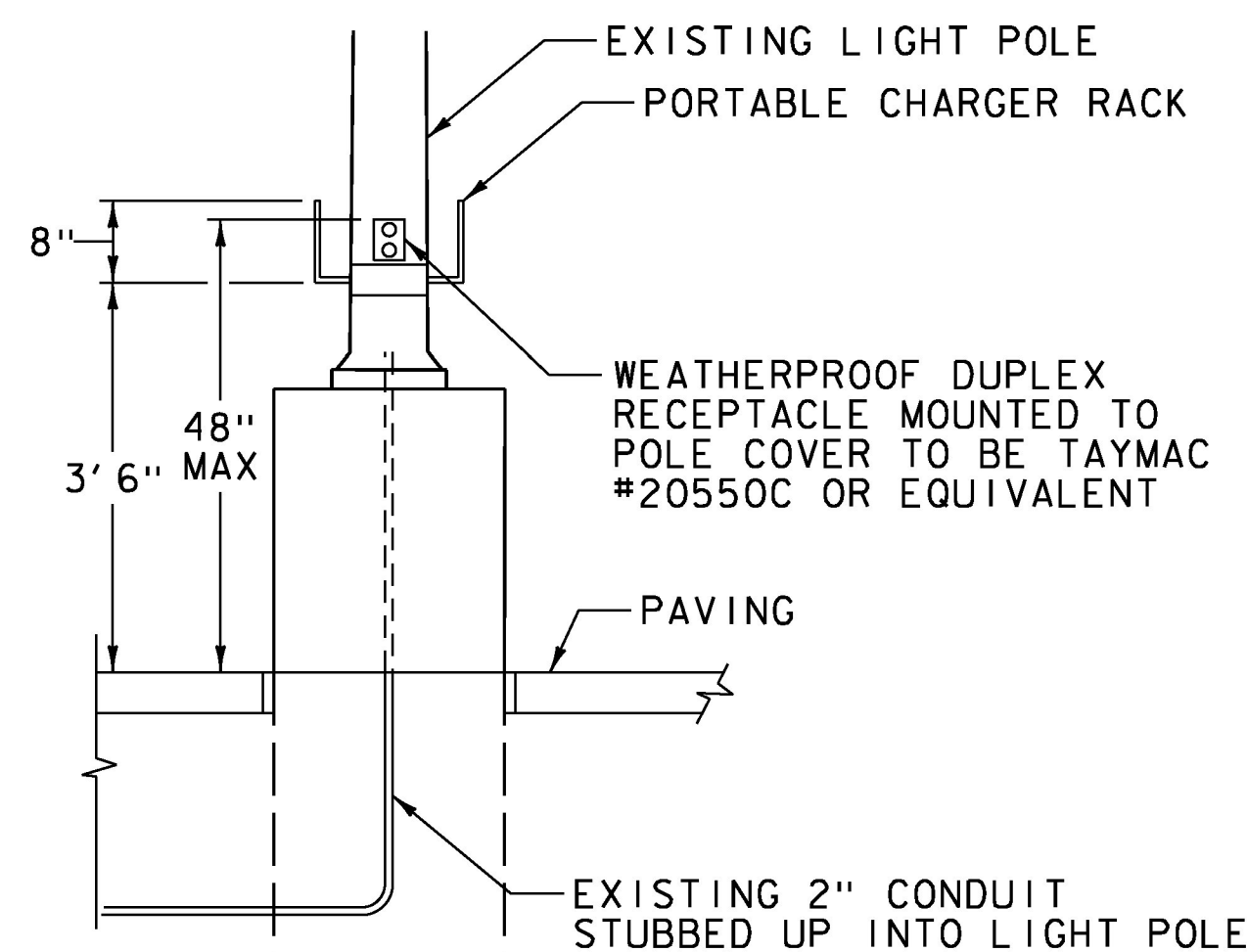

**ELEVATION**

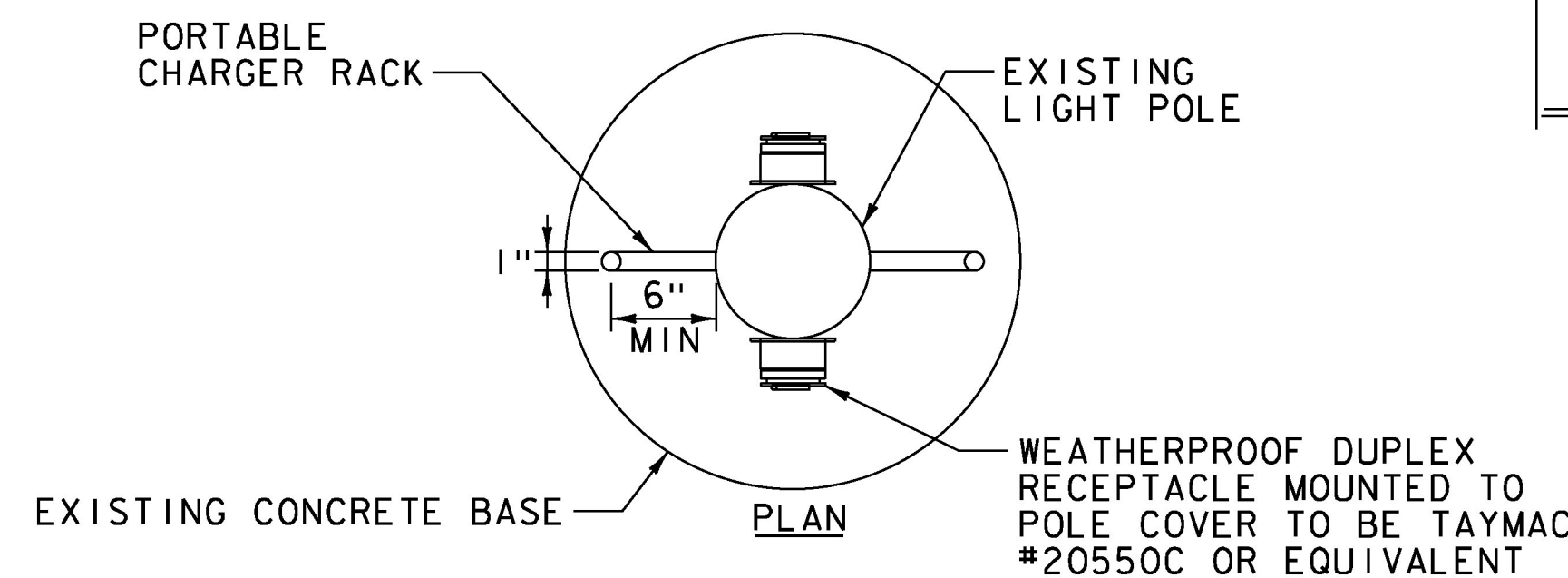

**SPECIAL PROVISION (ELECTRIC VEHICLE OUTLET, LEVEL 1)**

NOT TO SCALE

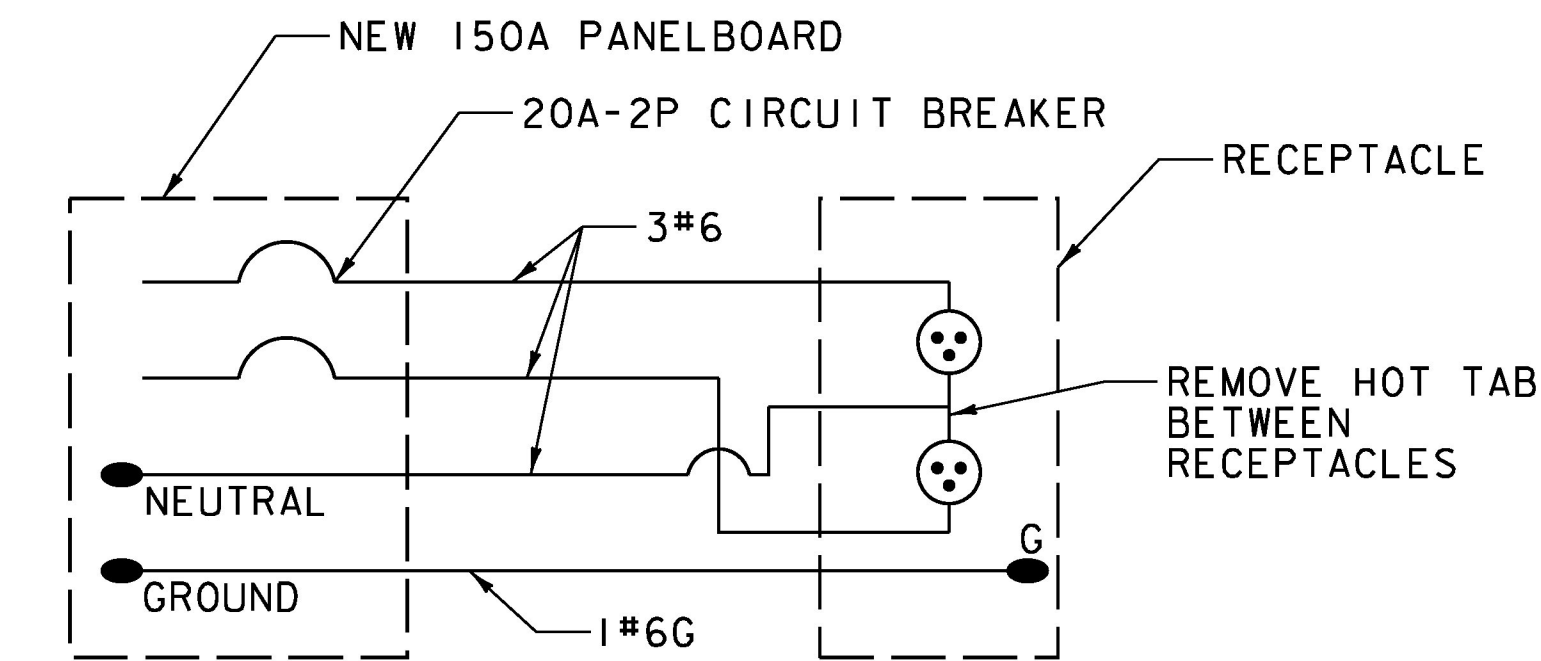

**TYPICAL EVI CHARGER WIRING DETAIL**

NOT TO SCALE

**NOTES:**

1. NEW PANEL BOARD AND BREAKER WILL BE PAID FOR UNDER ITEM 679.55 "POWER DROP STANCHION, STREET LIGHTING"
2. RUN NEW CONDUCTORS VIA EXISTING CONDUIT.

PROJECT NAME: RANDOLPH PARK AND RIDE LOT  
PROJECT NUMBER: CMG PARK (021) C/2

FILE NAME: z17c060det.dgn PLOT DATE: 6/14/2017  
PROJECT LEADER: S.E. BURBANK DRAWN BY: M.F. SUFFEL  
DESIGNED BY: M.F. SUFFEL CHECKED BY: S.E. BURBANK  
EVICHARGING STATION DETAILS SHEET II OF 15



646.400 DURABLE 4" WHITE LINE  
STA. 1+84.8 TO STA. 3+41.61

646.490 DURABLE LETTER OR SYMBOL  
STA. 2+04, LT. -  
STA. 2+04, LT. -  
STA. 2+35, LT. -  
STA. 2+35, LT. -  
STA. 2+35, RT. -  
STA. 2+92, LT. -  
STA. 2+92, LT. -  
STA. 2+92, RT. -

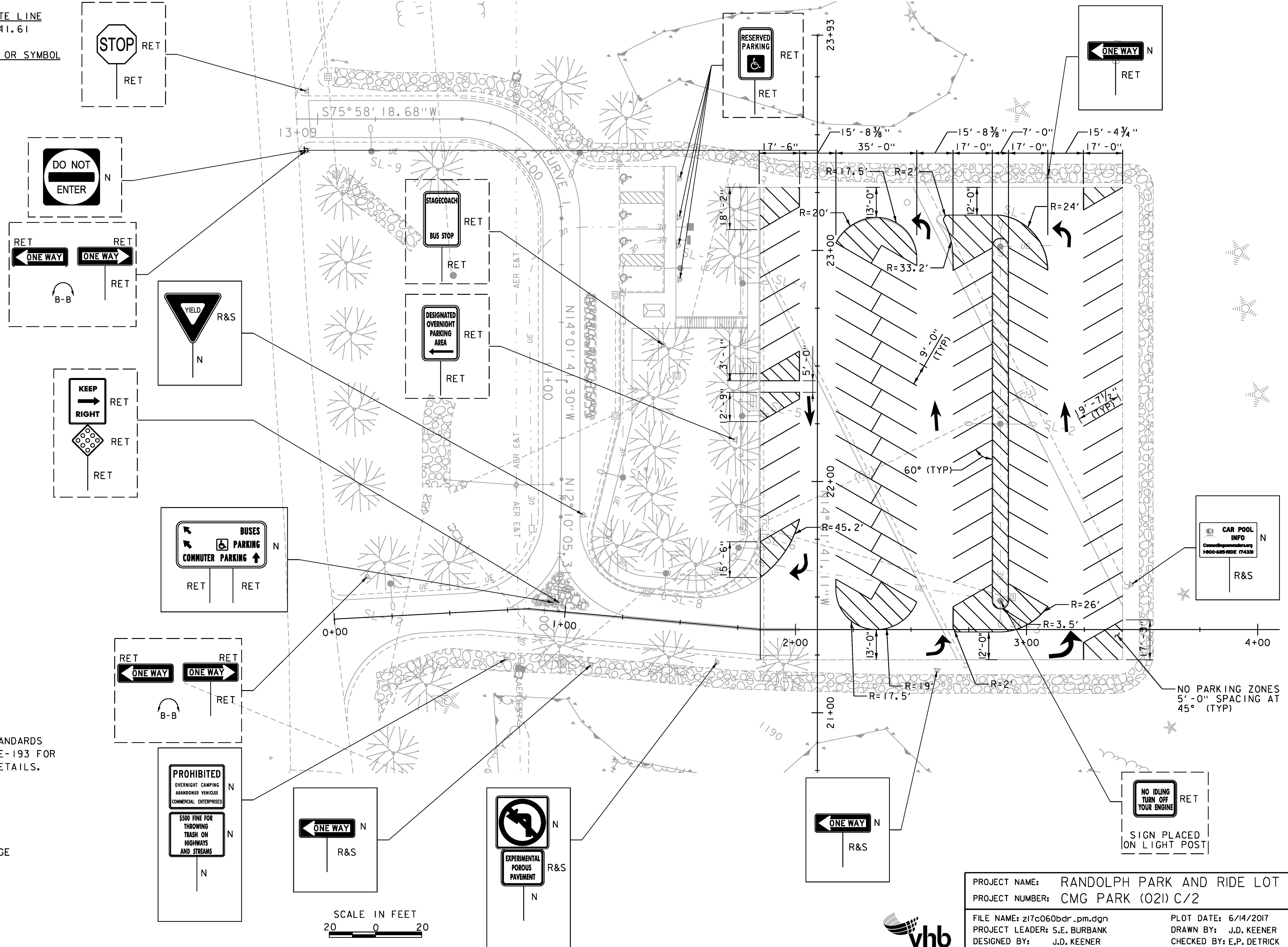
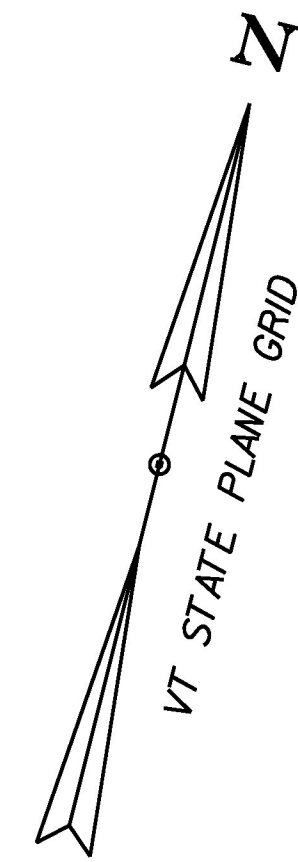

**NOTES:**

- REFER TO VTRANS STANDARDS E-191, E-192, AND E-193 FOR PAVEMENT MARKING DETAILS.

**SIGN LEGEND:**

N = NEW  
RET = RETAIN  
R&S = REMOVE AND SALVAGE

B-B = BACK TO BACK

SCALE IN FEET  
20 0 20

PROJECT NAME:	RANDOLPH PARK AND RIDE LOT
PROJECT NUMBER:	CMG PARK (021) C/2
FILE NAME:	z17c060bdr_pm.dgn
PROJECT LEADER:	S.E. BURBANK
DESIGNED BY:	J.D. KEENER
PAVEMENT MARKING & SIGNING PLAN	
PLOT DATE:	6/14/2017
DRAWN BY:	J.D. KEENER
CHECKED BY:	E.P. DETRICK
SHEET	12 OF 15





**REMOVAL OF EXISTING PAVEMENT MARKINGS (PHASE I)**

STA. 21+35, 61' RT TO STA. 23+15, 78' RT

**TEMPORARY 4 INCH WHITE LINE, TEMPORARY PAVEMENT MARKING TAPE (PHASE I)**

STA. 21+45, 79' RT TO STA. 21+46, 99' RT  
STA. 22+92, 99' RT TO STA. 23+05, 79' RT

**TEMPORARY LETTER OR SYMBOL, TEMPORARY PAVEMENT MARKING TAPE (PHASE I)**

STA. 21+26, 67' RT  
STA. 21+29, 104' RT  
STA. 21+39, 64' RT  
STA. 22+30, 66' RT  
STA. 22+28, 106' RT  
STA. 23+15, 67' RT  
STA. 23+16, 100' RT

**TEMPORARY 4 INCH WHITE LINE, TEMPORARY PAVEMENT MARKING TAPE (PHASE II)**

STA. 21+49, 11' LT TO STA. 21+51, 26' LT  
STA. 23+02, 6' LT TO STA. 23+03, 26' LT

**TEMPORARY LETTER OR SYMBOL, TEMPORARY PAVEMENT MARKING TAPE (PHASE II)**

STA. 21+41, 36' LT  
STA. 21+42, 4' RT  
STA. 21+56, 39' LT  
STA. 22+27, 4' RT  
STA. 22+30, 33' LT  
STA. 23+09, 2' RT  
STA. 23+14, 31' LT

**NOTES:**

1. BOTH CONSTRUCTION PHASES WILL REQUIRE FLAGGERS DURING CONSTRUCTION HOURS FOR ALTERNATING ONE-WAY TRAFFIC AT THE ENTRANCE/EXIT OF THE PARK AND RIDE.
2. TEMPORARY 4 INCH WHITE LINE AND TEMPORARY LETTER OR SYMBOL SHALL BE PAVEMENT MARKING TAPE, TYPE II.
3. ALL PAVEMENT MARKINGS WILL BE PERMANENT UNLESS NOTED OTHERWISE.

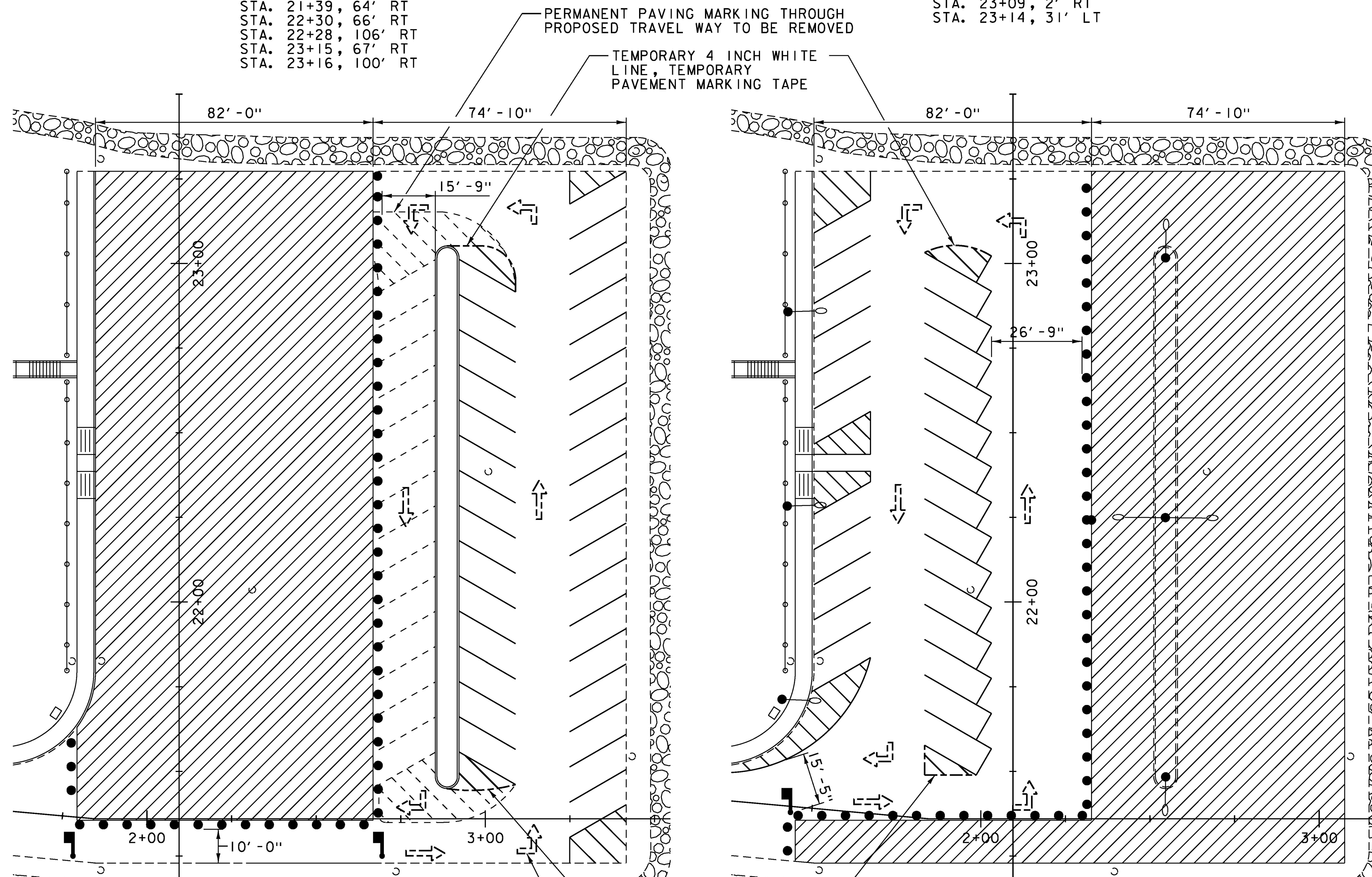
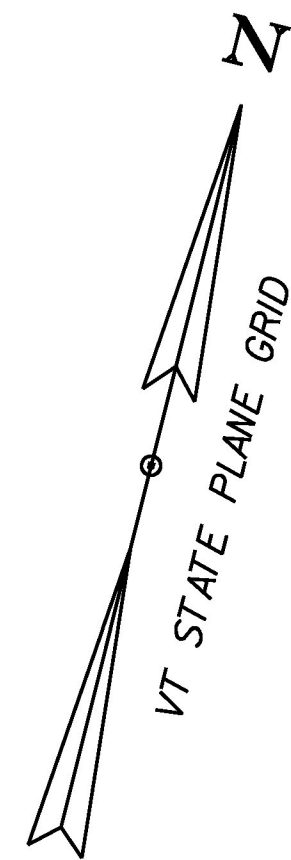

CONSTRUCTION PHASE I

CONSTRUCTION PHASE II

**LEGEND**

= PHASED CONSTRUCTION AREA

= DRUM

= FLAGGER



PROJECT NAME:	RANDOLPH PARK AND RIDE LOT
PROJECT NUMBER:	CMG PARK (02I) C/2
FILE NAME:	z17c060bdr_phased.dgn
PROJECT LEADER:	S.E. BURBANK
DESIGNED BY:	M.F. SUFFEL
PHASED CONSTRUCTION SHEET	
PLOT DATE:	6/14/2017
DRAWN BY:	M.F. SUFFEL
CHECKED BY:	E.P. DETRICK
SHEET	14 OF 15



- NOTES:**
- SEE PROJECT NOTES SHEET FOR TRAFFIC CONTROL NOTES
  - THE PCMS SHALL DISPLAY MESSAGE 1 FOR 7 DAYS PRIOR TO THE START OF CONSTRUCTION.
  - THE PCMS SHALL DISPLAY MESSAGE 2 DURING CONSTRUCTION.
  - YIELD SIGN SHALL BE COVERED WHEN FLAGGERS ARE BEING USED FOR TRAFFIC CONTROL.
  - FLAGGER AHEAD SIGN SHALL BE COVERED WHEN FLAGGERS ARE NOT IN USE. ONE LANE ROAD AHEAD SIGN SHALL BE VISIBLE WHEN NO FLAGGERS ARE PRESENT.
  - ONE LANE ROAD AHEAD SIGN SHALL BE COVERED WHEN FLAGGERS ARE BEING USED.

MESSAGE 1 FOR PORTABLE CHANGEABLE MESSAGE SIGNS (PCMS)

MESSAGE 1	MESSAGE 2
P AND R	STARTS
CONST	MMMM DD (DATE) **

** - MONTH SHALL BE SPELLED OUT - JUNE 10 NOT 6/10

MESSAGE 2 FOR PORTABLE CHANGEABLE MESSAGE SIGNS (PCMS)

MESSAGE 1	MESSAGE 2
P AND R	DURING
OPEN	CONST

IDENTIFICATION NUMBER	SIZE OF SIGN		TEXT	NUMBER OF SIGNS REQ'D	AREA (SQ FT)	TOTAL AREA (SQ FT)	REMARKS
	WIDTH (IN)	HEIGHT (IN)					
G20-2	36	18	END ROAD WORK	4	4.5	18.00	MOUNT ON TWO POSTS
VC-869	48	48	SIDE ROAD WORK AHEAD	2	16.0	32.00	MOUNT ON TWO POSTS
VC-869	48	48	SIDE ROAD WORK LEFT	2	16.0	32.00	MOUNT ON TWO POSTS
VC-869	48	48	SIDE ROAD WORK RIGHT	1	16.0	16.00	MOUNT ON TWO POSTS
W20-1	48	48	ROAD WORK AHEAD	2	16.0	32.00	MOUNT ON TWO POSTS
W20-1	48	48	ROAD WORK 500 FT	2	16.0	32.00	MOUNT ON TWO POSTS
R1-2	36	36	YIELD	2	3.89	7.75	MOUNT ON ONE POST
W20-7a	48	48	FLAGGER AHEAD	2	16.0	32.00	MOUNT ON ONE POST

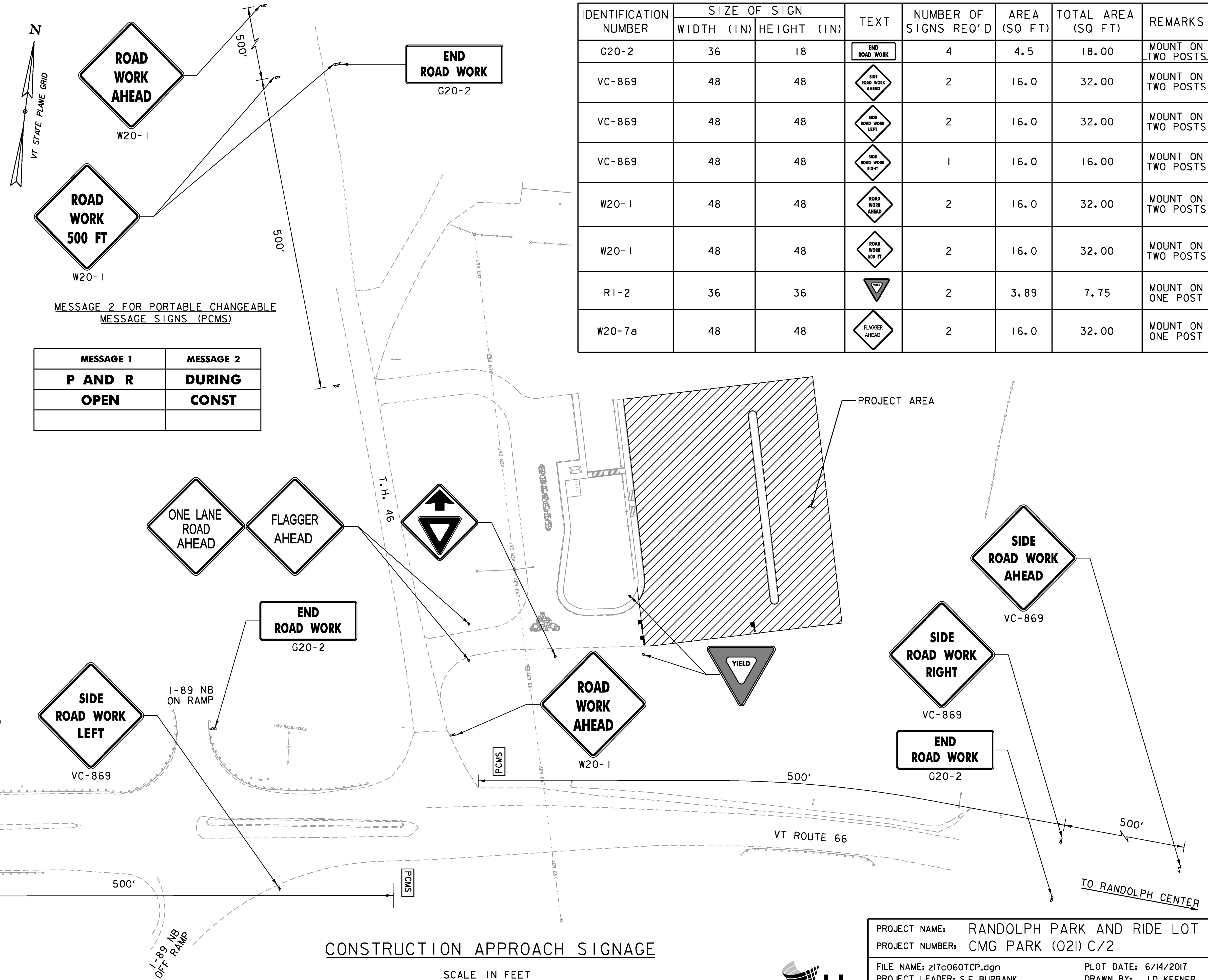

CONSTRUCTION APPROACH SIGNAGE

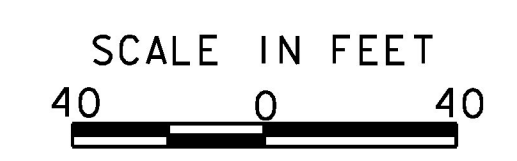

PROJECT NAME:	RANDOLPH PARK AND RIDE LOT
PROJECT NUMBER:	CMG PARK (021) C/2
FILE NAME:	z17c060TCP.dgn
PROJECT LEADER:	S.E. BURBANK
DESIGNED BY:	J.D. KEENER
CONSTRUCTION APPROACH SIGNING SHEET	
PLOT DATE:	6/14/2017
DRAWN BY:	J.D. KEENER
CHECKED BY:	E.P. DETRICK
	SHEET 15 OF 15