

PULL BOX, STANDARD
 STA. 22+92, 52' LT

WIRED CONDUIT (2") (PVC) (SCH 80)
 STA. 23+04, 55' RT TO 22+92, 52' RT

SPECIAL PROVISION (ELECTRIC VEHICLE OUTLET, LEVEL 1)

STA. 21+48, 36' LT (2)
 STA. 22+25, 36' LT (2)
 STA. 22+88, 66' RT (1)
 STA. 23+02, 79' LT (2)

SPECIAL PROVISION (ELECTRIC VEHICLE OUTLET, LEVEL 1)

STA. 23+04, 55' LT TO 22+92, 52' LT
 STA. 22+92, 59' LT TO 22+92, 52' LT
 STA. 22+92, 52' LT TO 22+86, 32' LT
 STA. 22+86, 32' LT TO 22+28, 33' LT
 STA. 22+28, 33' LT TO 21+71, 34' LT
 STA. 21+71, 34' LT TO 21+48, 79' RT
 STA. 21+48, 79' LT TO 22+25, 79' RT
 STA. 22+25, 79' RT TO 23+02, 79' RT

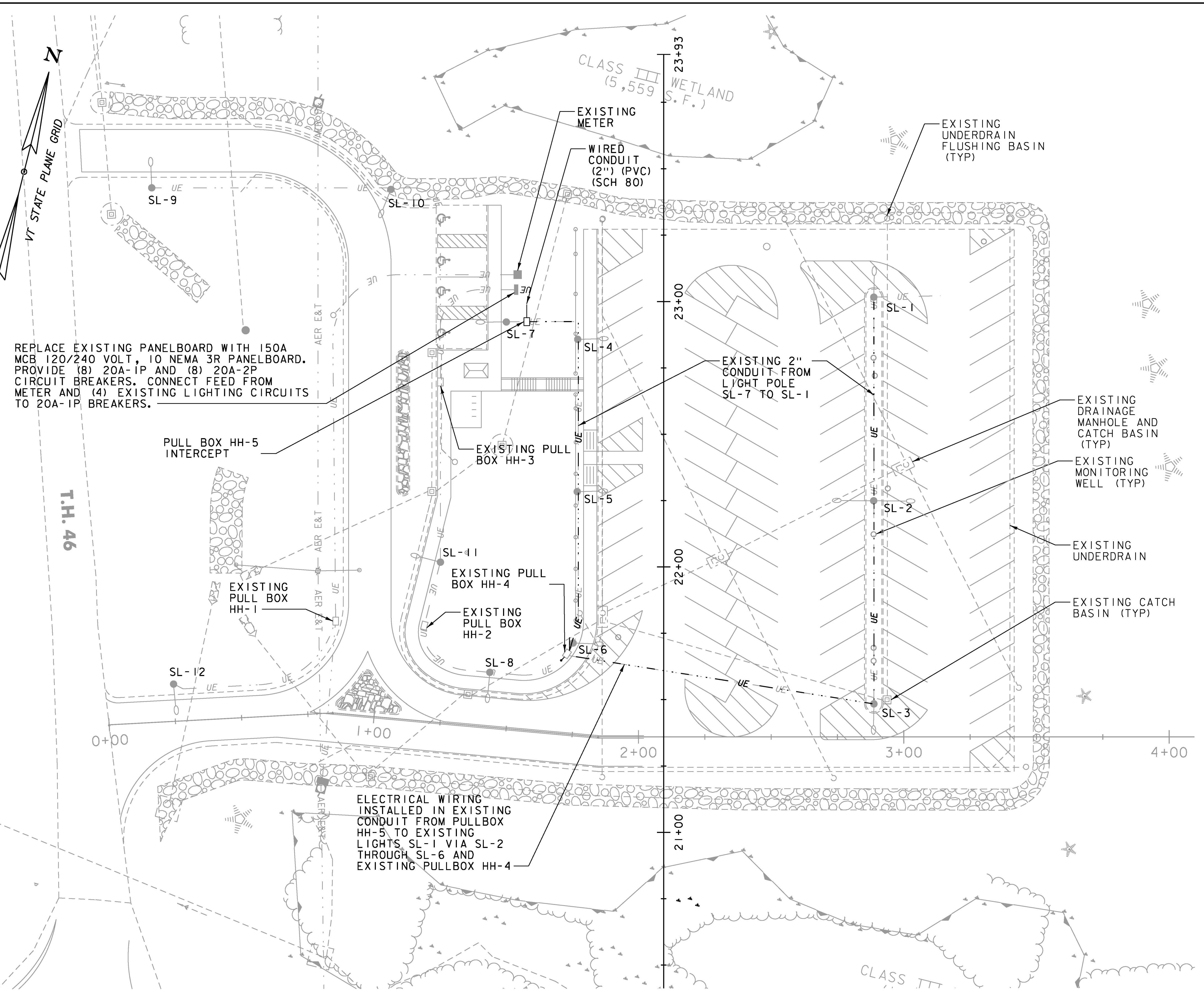

REPLACE EXISTING PANELBOARD WITH 150A MCB 120/240 VOLT, 10 NEMA 3R PANELBOARD. PROVIDE (8) 20A-1P AND (8) 20A-2P CIRCUIT BREAKERS. CONNECT FEED FROM METER AND (4) EXISTING LIGHTING CIRCUITS TO 20A-1P BREAKERS.

NOTES:

1. ALL COSTS ASSOCIATED WITH INSTALLING WIRES THROUGH THE EXISTING CONDUIT AND CONNECTING THE WIRES TO THE PANELBOARD, BREAKERS, AND EVI RECEPTACLES WILL BE INCLUDED IN THE COST FOR ITEM 678.24, "ELECTRICAL WIRING".
2. ALL COSTS ASSOCIATED WITH INSTALLING THE WIRED ELECTRICAL CONDUIT WILL BE INCLUDED IN THE COST FOR ITEM 678.23, "WIRED CONDUIT (2") (PVC) (SCH 80)".
3. ALL COSTS ASSOCIATED WITH THE INSTALLATION OF THE NEW PANEL BOARD AND BREAKER INCLUDING REMOVING THE EXISTING PANELBOARD AND BREAKERS WILL BE PAID FOR UNDER ITEM 679.55 "POWER DROP STANCHION, STREET LIGHTING".
4. SEE EVI CHARGING STATION DETAILS SHEET FOR ADDITIONAL INFORMATION.
5. WATERPROOF DUPLEX RECEPTACLES WILL BE PAID FOR UNDER ITEM 900.620, (ELECTRIC VEHICLE OUTLET, LEVEL 1).

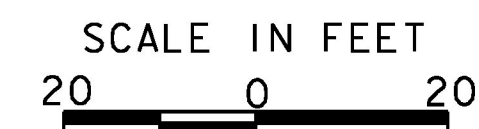

PROJECT NAME:	RANDOLPH PARK AND RIDE LOT
PROJECT NUMBER:	CMG PARK (021) C/2
FILE NAME:	z17c060u+111+tes.dgn
PROJECT LEADER:	S.E. BURBANK
DESIGNED BY:	J.D. KEENER
UTILITY SHEET	
PLOT DATE:	6/14/2017
DRAWN BY:	M.F. SUFFEL
CHECKED BY:	E.P. DETRICK
SHEET	10 OF 15

