

# STATE OF VERMONT AGENCY OF TRANSPORTATION

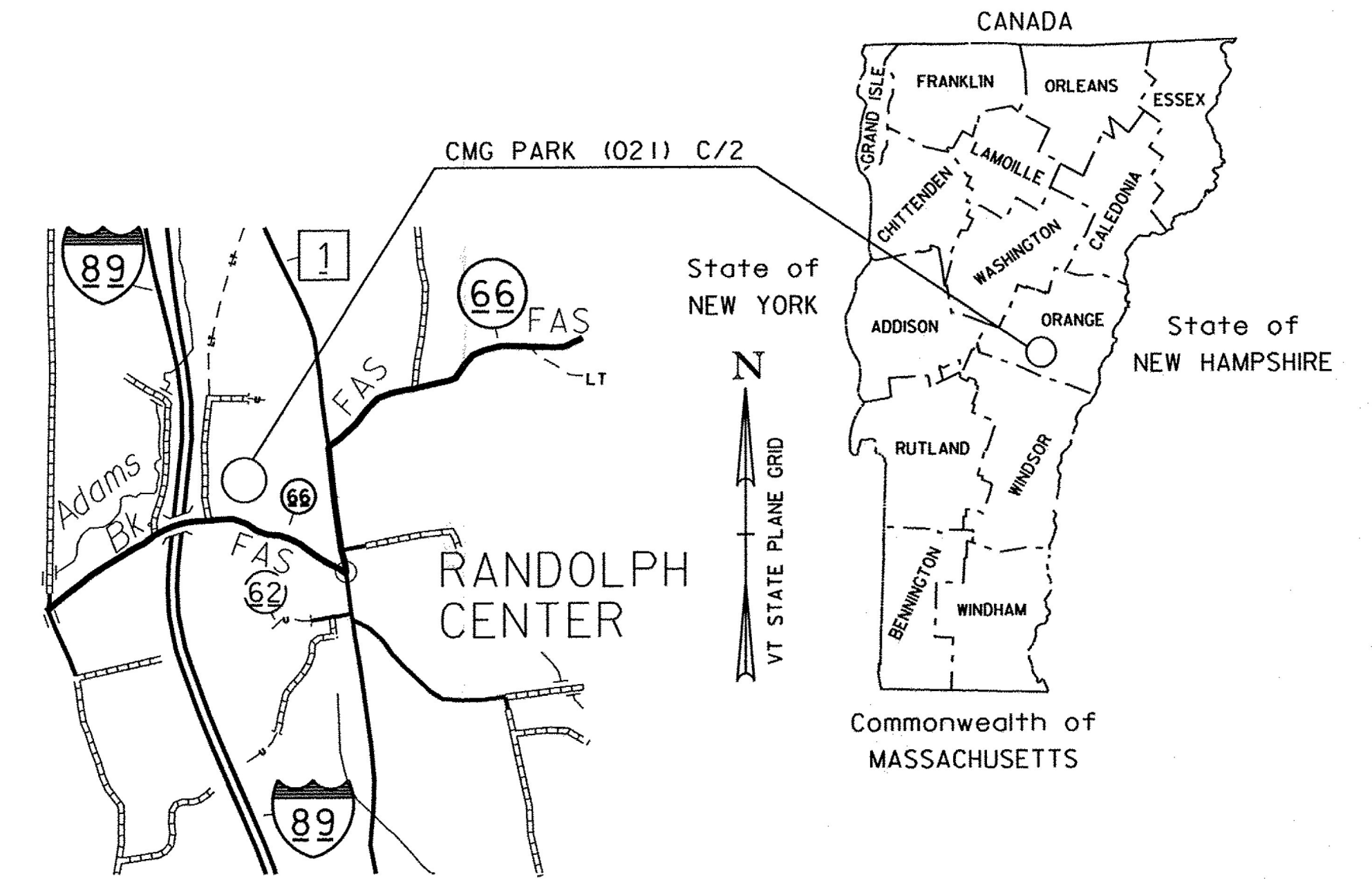

## PROPOSED IMPROVEMENT PARK AND RIDE PROJECT

TOWN OF RANDOLPH  
COUNTY OF ORANGE



**Record Plans**  
 Contractor: J. HUTCHINS, INC.  
 Resident Engineer: TOM CHASE  
 Construction Began: AUGUST 29, 2017  
 Construction Complete: SEPTEMBER 20, 2018  
 Record Plans By: TOM CHASE & JESSE IVES

I hereby certify that all construction required by this set of drawings has been accomplished as indicated herein.

E-SIGNED by Thomas Chase  
 on 2019-01-08 12:54:13 UTC  
 Resident Engineer

Date: January 08, 2019

NOTE: Any further information concerning final quantities, amounts or other details relative to this project may be found at Central Files in the electronic archives.

- PROJECT LOCATION: LOCATED IN THE COUNTY OF ORANGE, TOWN OF RANDOLPH, ON THE EAST SIDE OF THE INTERSECTION OF VT ROUTE 66 AND BETTIS ROAD JUST EAST OF 1-89 EXIT 4.
- PROJECT DESCRIPTION: REMOVAL OF THE EXISTING POROUS CONCRETE PAVEMENT AND CHOKER COURSE, REMOVAL OF THE EXISTING ISLAND, AND CONSTRUCTION OF NEW OPEN-GRADED FRICTION COURSE IN THE PARKING STALLS AND STANDARD BITUMINOUS PAVEMENT IN THE PARKING LOT AISLES, PAVEMENT MARKINGS, SIGNS, CEDAR FENCING, AND OTHER HIGHWAY RELATED ITEMS.
- LENGTH OF PROJECT: 210.30 FT (0.039 MILES)

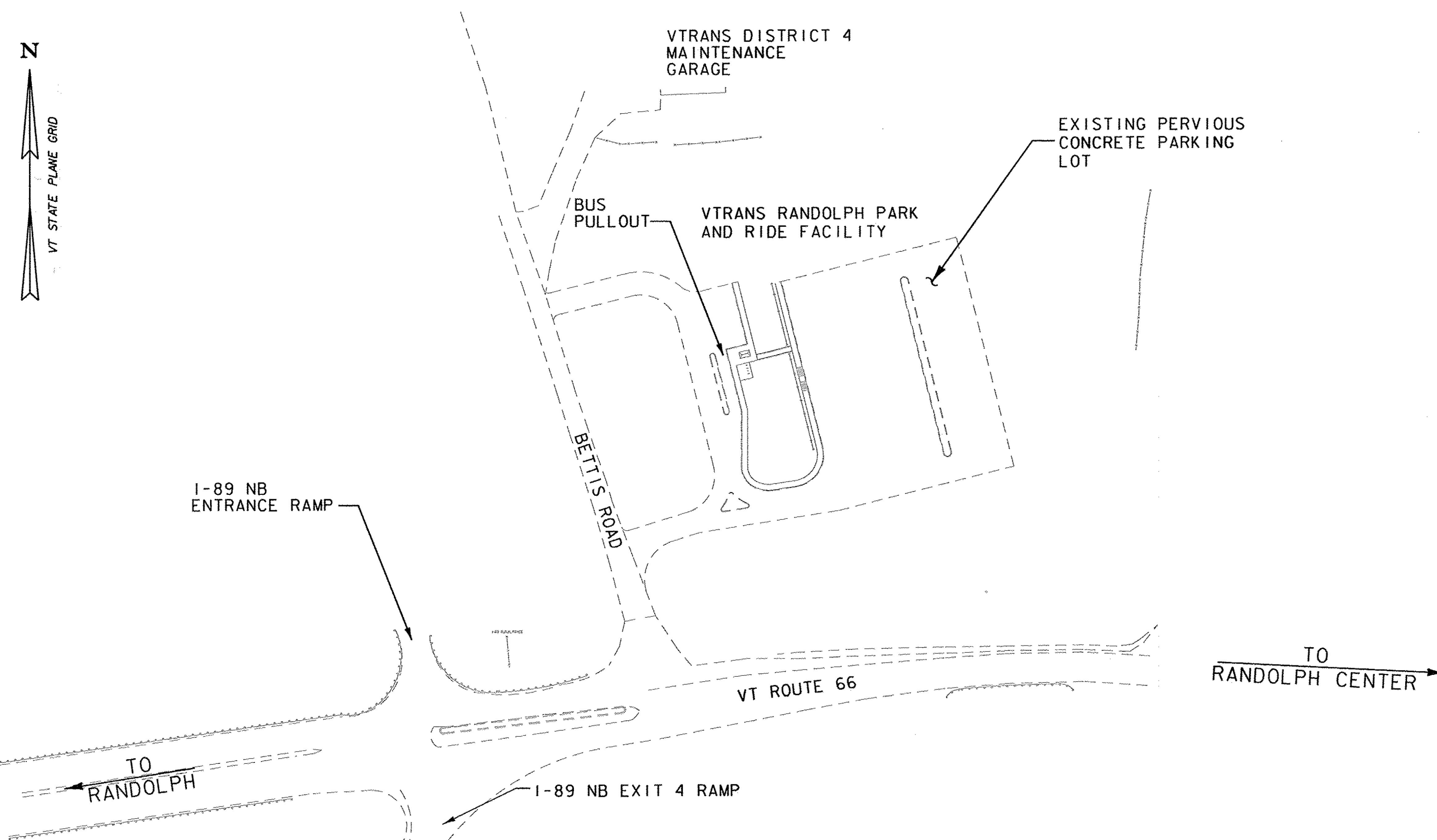

CONSTRUCTION IS TO BE CARRIED ON IN ACCORDANCE WITH THESE PLANS AND THE STANDARD SPECIFICATIONS FOR CONSTRUCTION DATED 2011, AS APPROVED BY THE FEDERAL HIGHWAY ADMINISTRATION ON JULY 20, 2011 FOR USE ON THIS PROJECT, INCLUDING ALL SUBSEQUENT REVISIONS AND SUCH REVISED SPECIFICATIONS AND SPECIAL PROVISIONS AS ARE INCORPORATED IN THESE PLANS.

QUALITY ASSURANCE PROGRAM : LEVEL I	
SURVEYED BY : VERMONT SURVEY AND ENGINEERING INC.	
SURVEYED DATE : 04/02	
DATUM	
VERTICAL	NAVD 88
HORIZONTAL	NAD 83 (1996) VT SPC (FEET)

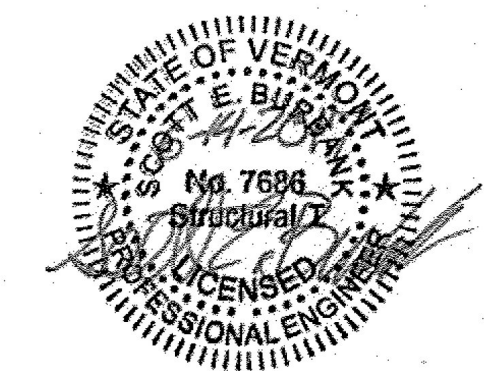

**BUILT AS DESIGNED**

DIRECTOR OF MUNICIPAL ASSISTANCE BUREAU	
APPROVED <i>Susan E. Dwin</i>	DATE 01/14/2019
PROJECT MANAGER : WAYNE DAVIS	
PROJECT NAME : RANDOLPH PARK AND RIDE LOT	
PROJECT NUMBER : CMG PARK (021) C/2	
SHEET 1 OF 1 SHEETS	

