

THINNING AND TRIMMING FOR SIGNS

STA. 55+04, RT
(SEE SHEET 158)

STONE FILL, TYPE I

SLOPE STABILIZATION WITH STONE LINED DITCH
STA. 54+00 TO 54+63, RT
STA. 54+90 TO 56+53, RT
STA. 56+80 TO 59+00, RT
(SEE SHEET 158)

RELOCATE MAILBOX, SINGLE SUPPORT

STA. 56+56, RT

DURABLE 4 INCH WHITE LINE, (OPTION CCBID ITEMS)

TEMPORARY 4 INCH WHITE LINE, PAINT
(ALL LINES WILL INCLUDE EDGE LINE BREAKS
AND RADII FOR SIDE ROADS)
STA. 54+00 TO 59+00, SOLID LT & RT

DURABLE 4 INCH YELLOW LINE, (OPTION DD BID ITEMS)

TEMPORARY 4 INCH YELLOW LINE, PAINT
(ALL LINES WILL INCLUDE C BREAKS FOR SIDE ROADS)
STA. 54+00 TO 59+00, SOLID LT & RT
STA. 55+08, DOUBLE SOLID RT (JOHNSON RD. TH-12)

DURABLE 24 INCH STOP BAR, (OPTION EE BID ITEMS)

TEMPORARY 24 INCH STOP BAR, PAINT
STA. 55+08, RT (JOHNSON RD. TH-12)

DURABLE LETTER OR SYMBOL, (OPTION FF BID ITEMS)

TEMPORARY LETTER OR SYMBOL, PAINT
STA. 55+08, RT "STOP" (JOHNSON RD. TH-12)

GRUBBING MATERIAL (6")

SLOPE STABILIZATION WITH STONE LINED DITCH
STA. 54+00 TO 54+63, RT
STA. 54+90 TO 56+53, RT
STA. 56+80 TO 59+00, RT
(SEE SHEET 158)

REMOVING SIGNS

AS SHOWN - 2

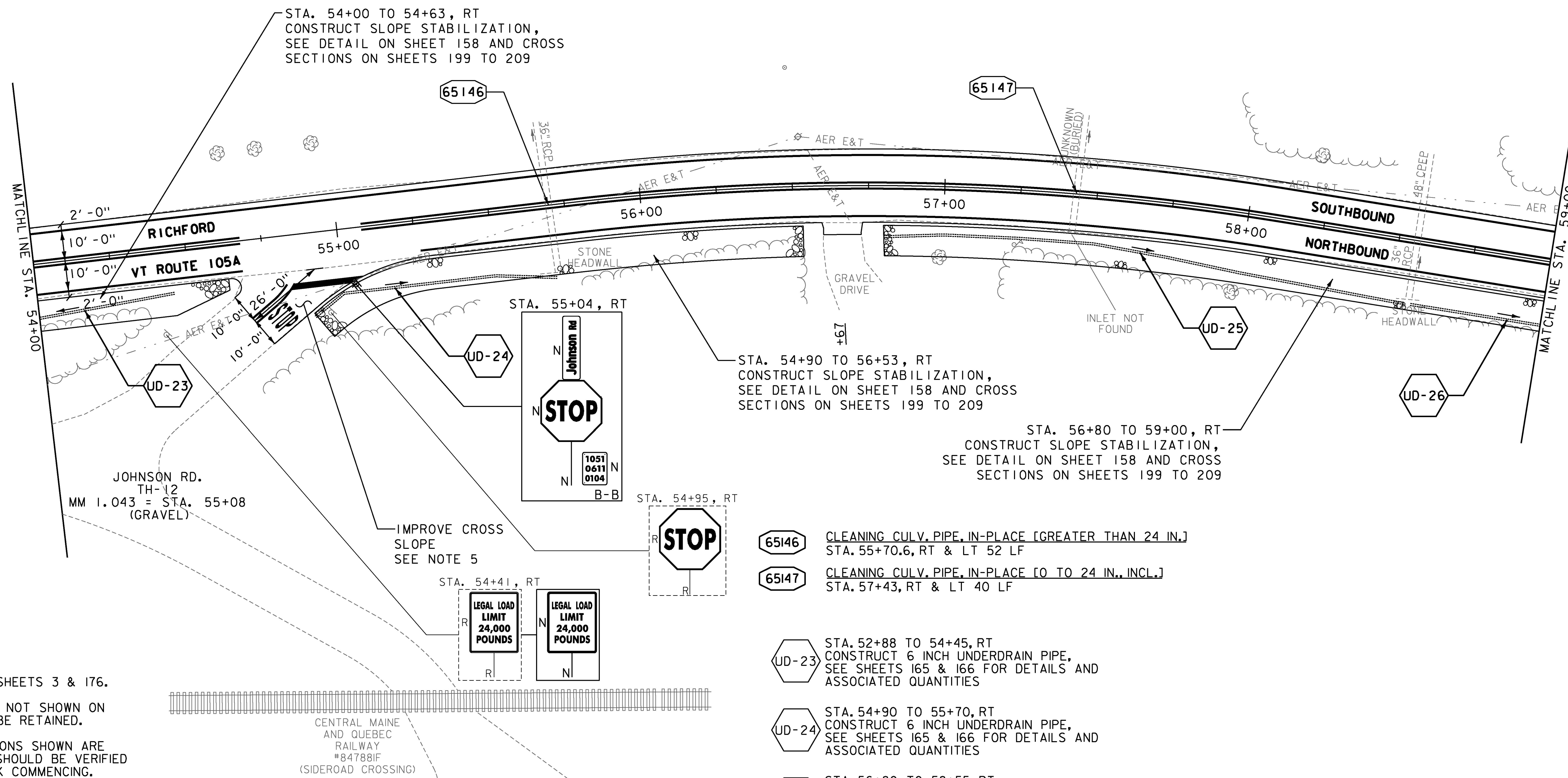
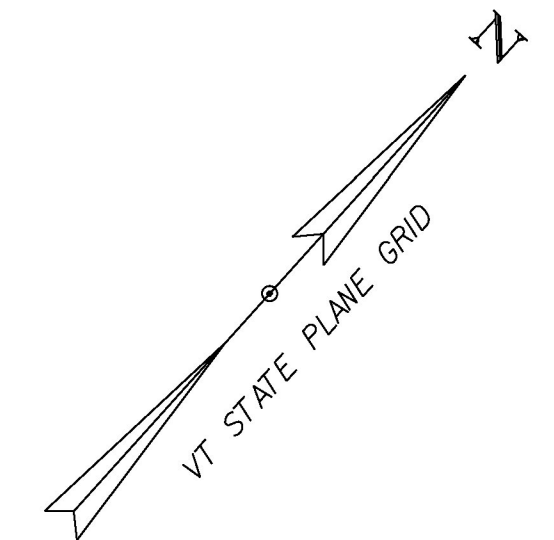

NOTES:

- FOR LEGENDS SEE SHEETS 3 & 176.
- ALL EXISTING SIGNS NOT SHOWN ON THE PLANS SHALL BE RETAINED.
- ALL UTILITY LOCATIONS SHOWN ARE APPROXIMATE AND SHOULD BE VERIFIED PRIOR TO ANY WORK COMMENCING.
- SEE SHEET 174 FOR CULVERT INFORMATION.
- RE-SHAPE THE EXISTING CROSS SLOPE ON JOHNSON ROAD IN THE AREA THAT IS TO BE PAVED, TO IMPROVE ROADWAY DRAINAGE INCLUDE ANY DITCHING DEEMED NECESSARY BY THE ENGINEER. WORK TO BE PAID USING RENTAL ITEMS.

- 65146 CLEANING CULV. PIPE, IN-PLACE [GREATER THAN 24 IN.] STA. 55+70.6, RT & LT 52 LF
- 65147 CLEANING CULV. PIPE, IN-PLACE [0 TO 24 IN., INCL.] STA. 57+43, RT & LT 40 LF

- UD-23 STA. 52+88 TO 54+45, RT CONSTRUCT 6 INCH UNDERDRAIN PIPE, SEE SHEETS 165 & 166 FOR DETAILS AND ASSOCIATED QUANTITIES
- UD-24 STA. 54+90 TO 55+70, RT CONSTRUCT 6 INCH UNDERDRAIN PIPE, SEE SHEETS 165 & 166 FOR DETAILS AND ASSOCIATED QUANTITIES
- UD-25 STA. 56+80 TO 58+55, RT CONSTRUCT 6 INCH UNDERDRAIN PIPE, SEE SHEETS 165 & 166 FOR DETAILS AND ASSOCIATED QUANTITIES
- UD-26 STA. 58+57 TO 60+24, RT CONSTRUCT 6 INCH UNDERDRAIN PIPE, SEE SHEETS 165 & 166 FOR DETAILS AND ASSOCIATED QUANTITIES



PROJECT NAME:	RICHFORD	PLOT DATE:	4/2/2018
PROJECT NUMBER:	STP 2916(I)	DRAWN BY:	G. BURGMEIER
FILE NAME:	z10c234bdr.dgn	DESIGNED BY:	G. BURGMEIER
PROJECT LEADER:	G. EDWARDS	CHECKED BY:	J. LITTLE
PLAN SHEET 12		SHEET	188 OF 222

