

STEEL BEAM GUARDRAIL, GALVANIZED  
STA. 9+56.0 TO 9+93.5, LT

REMOVE AND RESET GUARDRAIL  
STA. 9+93.5 TO 10+00.0, LT

DURABLE 4 INCH WHITE LINE, (OPTION CC BID ITEMS)  
TEMPORARY 4 INCH WHITE LINE, PAINT  
(ALL LINES WILL INCLUDE EDGE LINE BREAKS  
AND RADII FOR SIDE ROADS)  
STA. 4+00 TO 10+00, SOLID LT & RT

DURABLE 4 INCH YELLOW LINE, (OPTION DD BID ITEMS)  
TEMPORARY 4 INCH YELLOW LINE, PAINT  
(ALL LINES WILL INCLUDE  $\frac{1}{2}$  BREAKS FOR SIDE ROADS)  
STA. 4+00 TO 10+00, SOLID LT & RT

DURABLE LETTER OR SYMBOL, (OPTION FF BID ITEMS)  
TEMPORARY LETTER OR SYMBOL, PAINT  
STA. 7+80, LT "AHEAD"  
STA. 8+20, LT "STOP"

REMOVING SIGNS  
AS SHOWN - 18

ANCHOR FOR STEEL BEAM RAIL  
STA. 9+56.0, LT

REMOVAL AND DISPOSAL OF GUARDRAIL  
STA. 9+56 TO 9+93.5, RT

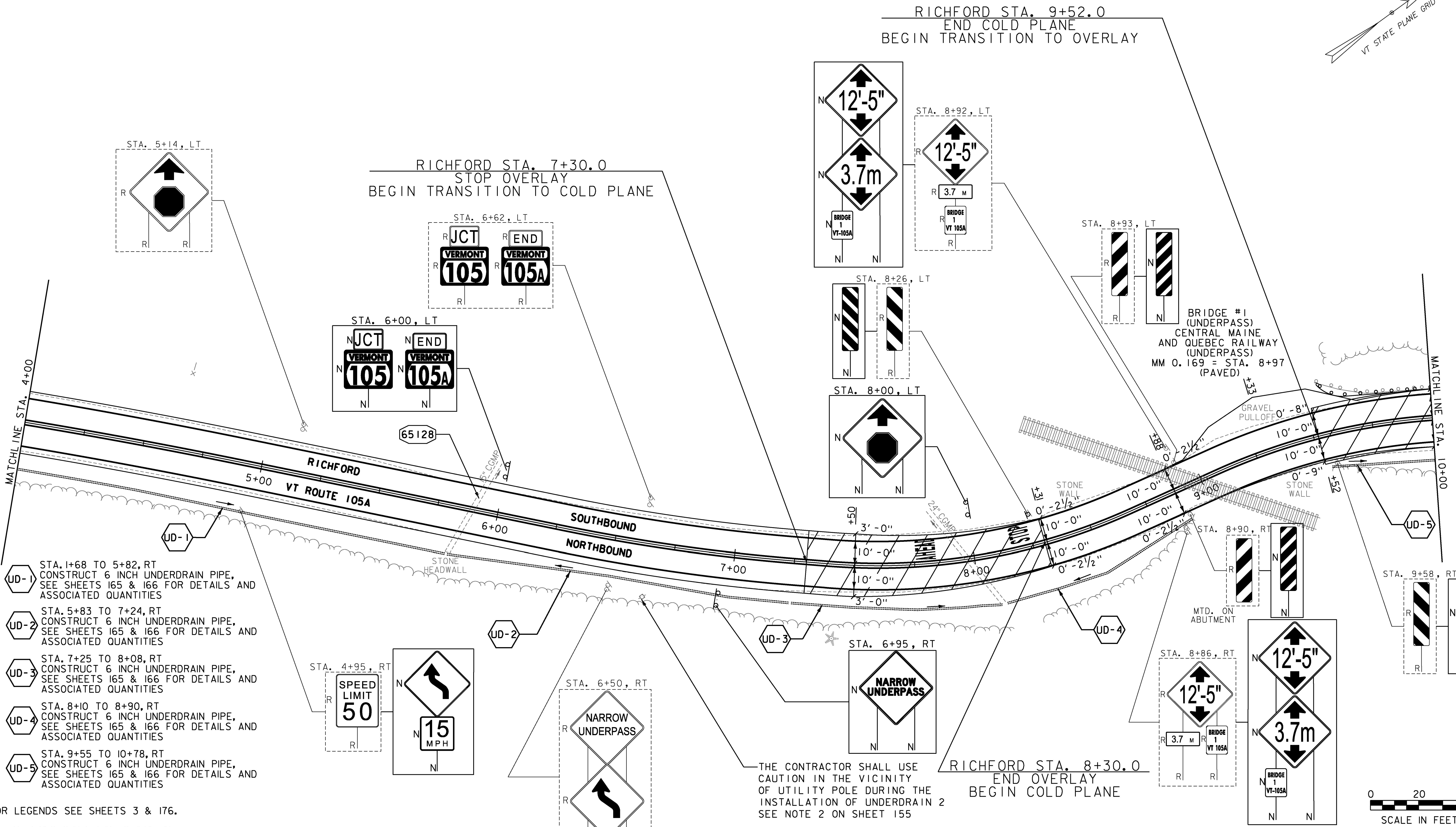
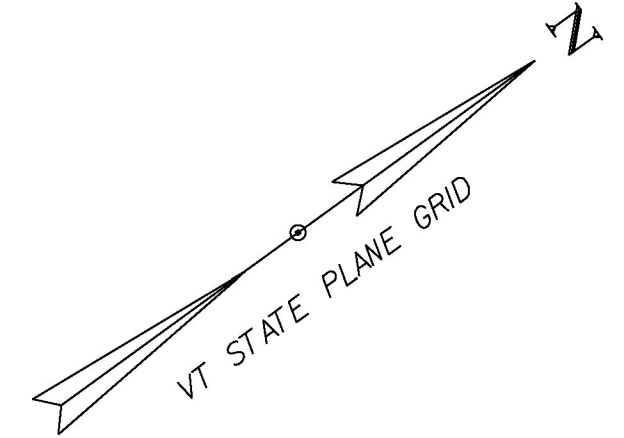

- UD-1 STA. 1+68 TO 5+82, RT  
CONSTRUCT 6 INCH UNDERDRAIN PIPE,  
SEE SHEETS 165 & 166 FOR DETAILS AND  
ASSOCIATED QUANTITIES
- UD-2 STA. 5+83 TO 7+24, RT  
CONSTRUCT 6 INCH UNDERDRAIN PIPE,  
SEE SHEETS 165 & 166 FOR DETAILS AND  
ASSOCIATED QUANTITIES
- UD-3 STA. 7+25 TO 8+08, RT  
CONSTRUCT 6 INCH UNDERDRAIN PIPE,  
SEE SHEETS 165 & 166 FOR DETAILS AND  
ASSOCIATED QUANTITIES
- UD-4 STA. 8+10 TO 8+90, RT  
CONSTRUCT 6 INCH UNDERDRAIN PIPE,  
SEE SHEETS 165 & 166 FOR DETAILS AND  
ASSOCIATED QUANTITIES
- UD-5 STA. 9+55 TO 10+78, RT  
CONSTRUCT 6 INCH UNDERDRAIN PIPE,  
SEE SHEETS 165 & 166 FOR DETAILS AND  
ASSOCIATED QUANTITIES

- NOTES:**
1. FOR LEGENDS SEE SHEETS 3 & 176.
  2. ALL EXISTING SIGNS NOT SHOWN ON THE PLANS SHALL BE RETAINED.
  3. ALL UTILITY LOCATIONS SHOWN ARE APPROXIMATE AND SHOULD BE VERIFIED PRIOR TO ANY WORK COMMENCING.
  4. SEE SHEET 157 FOR PULL-OFF DETAIL.
  5. SEE SHEET 174 FOR CULVERT INFORMATION.

65128 CLEANING CULV. PIPE, IN-PLACE [0 TO 24 IN., INCL.]  
STA. 5+82, RT - 5+96, LT 45 LF

THE CONTRACTOR SHALL USE CAUTION IN THE VICINITY OF UTILITY POLE DURING THE INSTALLATION OF UNDERDRAIN 2  
SEE NOTE 2 ON SHEET 155

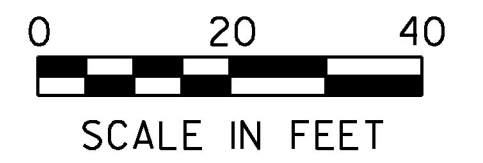

PROJECT NAME:	RICHFORD	PLOT DATE:	4/2/2018
PROJECT NUMBER:	STP 2916(I)	DRAWN BY:	G. BURGMEIER
FILE NAME:	z10c234bdr.dgn	DESIGNED BY:	G. BURGMEIER
PROJECT LEADER:	G. EDWARDS	CHECKED BY:	J. LITTLE
DESIGNED BY:	G. BURGMEIER	PLAN SHEET 2	SHEET 178 OF 222

