

THINNING AND TRIMMING FOR SIGNS

STA. 3+52, RT
(SEE SHEET 158)

RELOCATE MAILBOX, SINGLE SUPPORT
STA. 2+97, RT

REMOVE AND RESET GUARDRAIL
STA. 0+13.0 TO 2+42.0, LT

DURABLE 4 INCH WHITE LINE, (OPTION CC BID ITEMS)
TEMPORARY 4 INCH WHITE LINE, PAINT
(ALL LINES WILL INCLUDE EDGE LINE BREAKS
AND RADII FOR SIDE ROADS)
STA. 0+15.84 TO 4+00, SOLID LT & RT

DURABLE 4 INCH YELLOW LINE, (OPTION DD BID ITEMS)
TEMPORARY 4 INCH YELLOW LINE, PAINT
(ALL LINES WILL INCLUDE C BREAKS FOR SIDE ROADS)
STA. 0+15.84 TO 4+00, SOLID LT & RT

DURABLE 24 INCH STOP BAR, (OPTION EE BID ITEMS)
TEMPORARY 24 INCH STOP BAR, PAINT
STA. 0+18, LT

DURABLE LETTER OR SYMBOL, (OPTION FF BID ITEMS)
TEMPORARY LETTER OR SYMBOL, PAINT
STA. 0+28, LT "STOP"

REMOVING SIGNS
AS SHOWN - 2I

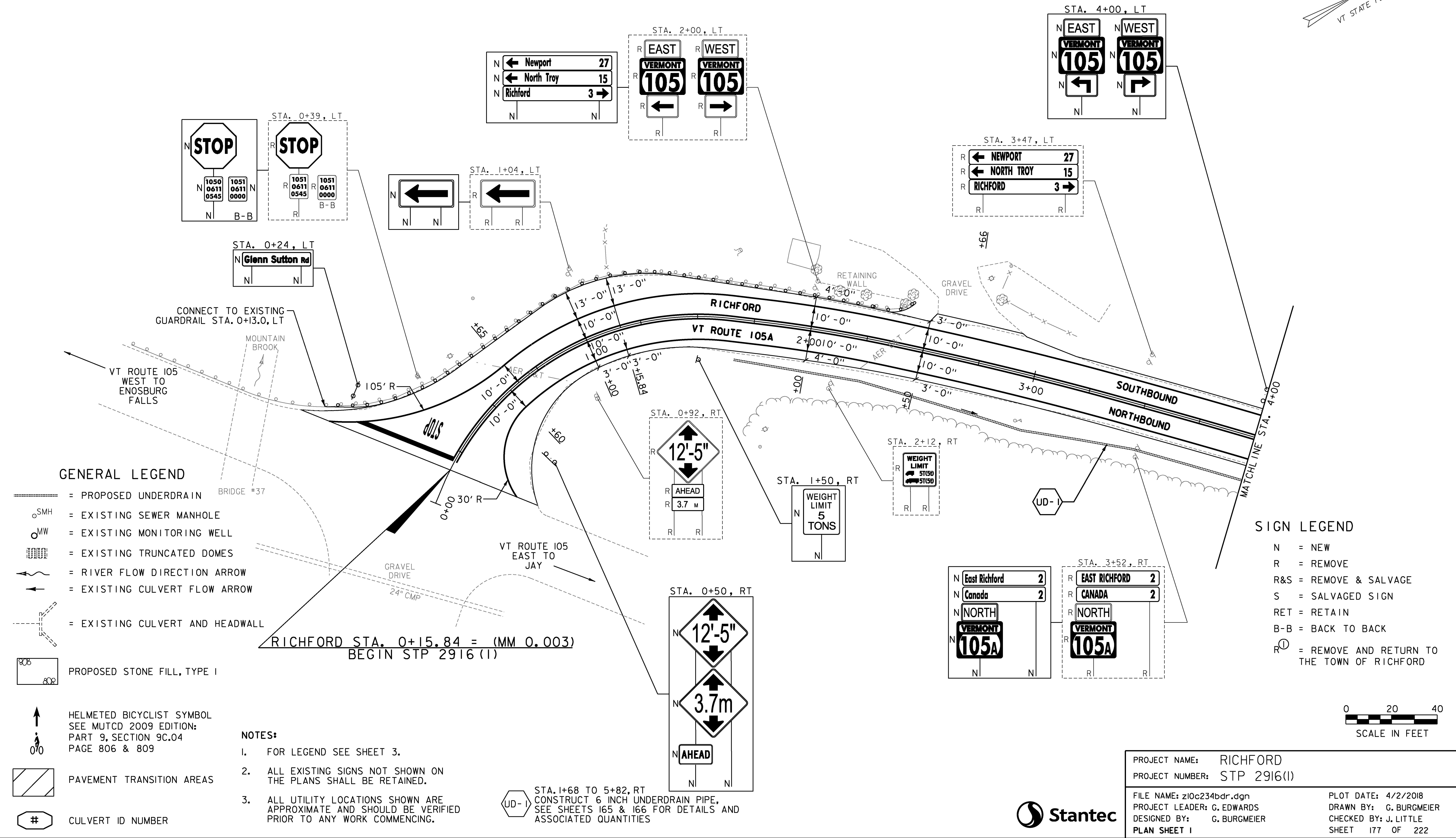
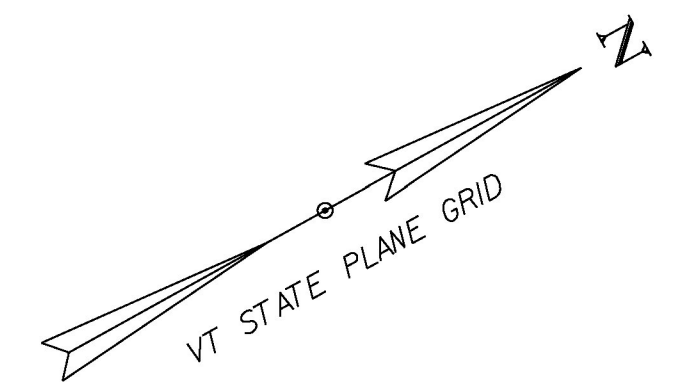

PROJECT NAME:	RICHFORD	PLOT DATE:	4/2/2018
PROJECT NUMBER:	STP 2916(I)	DRAWN BY:	G. BURGMEIER
FILE NAME:	z10c234bdr.dgn	CHECKED BY:	J. LITTLE
DESIGNED BY:	G. BURGMEIER	PLAN SHEET I	SHEET 177 OF 222