

ADJUST ELEVATION OF VALVE BOX  
(NO FEDERAL/STATE PARTICIPATION)  
STA. R 76+86, LT

DURABLE 4 INCH WHITE LINE, (OPTION CC BID ITEMS)  
TEMPORARY 4 INCH WHITE LINE, PAINT  
(ALL LINES WILL INCLUDE EDGE LINE BREAKS  
AND RADII FOR SIDE ROADS)  
STA. R 73+00 TO R 78+00, SOLID LT & RT

DURABLE 4 INCH YELLOW LINE, (OPTION DD BID ITEMS)  
TEMPORARY 4 INCH YELLOW LINE, PAINT  
(ALL LINES WILL INCLUDE  $\phi$  BREAKS FOR SIDE ROADS)  
STA. R 73+00 TO R 78+00, SOLID LT & RT

REMOVING SIGNS  
AS SHOWN - 3

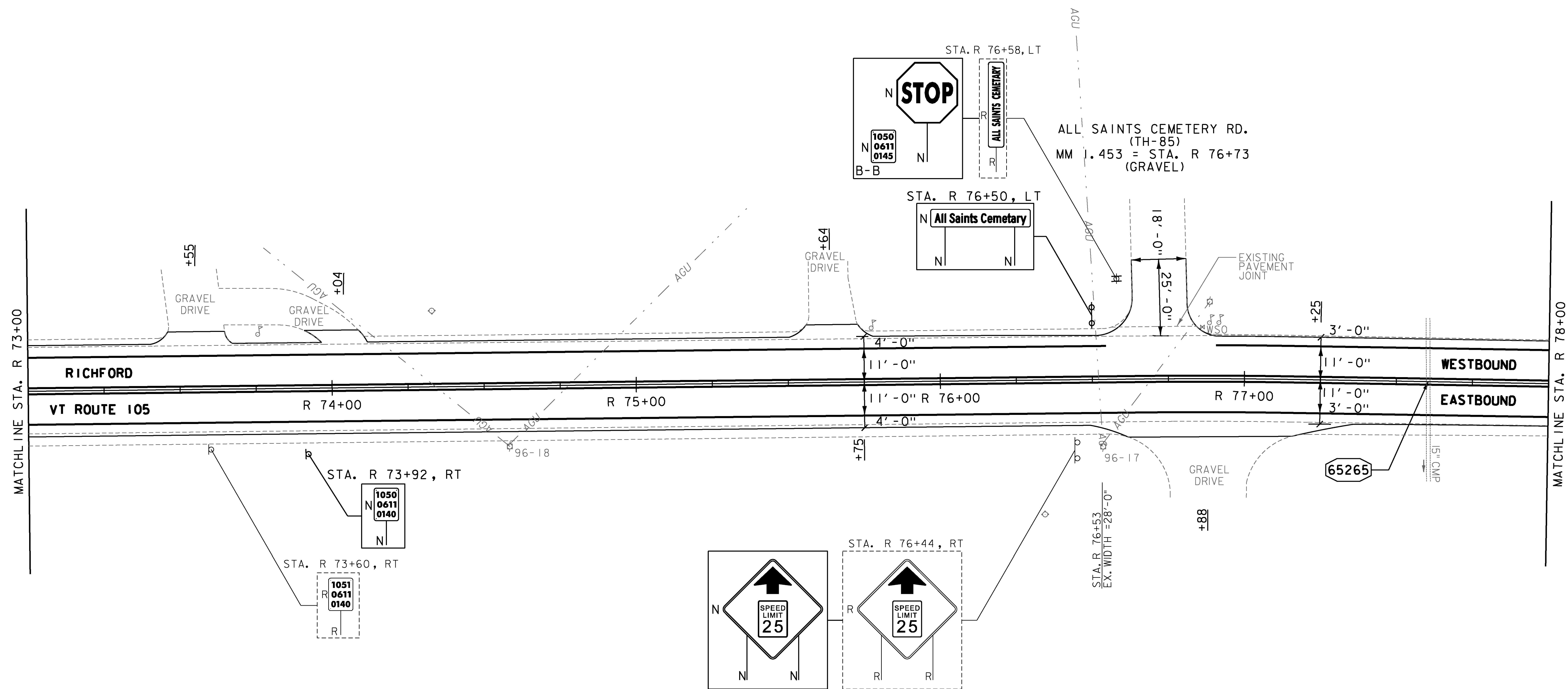
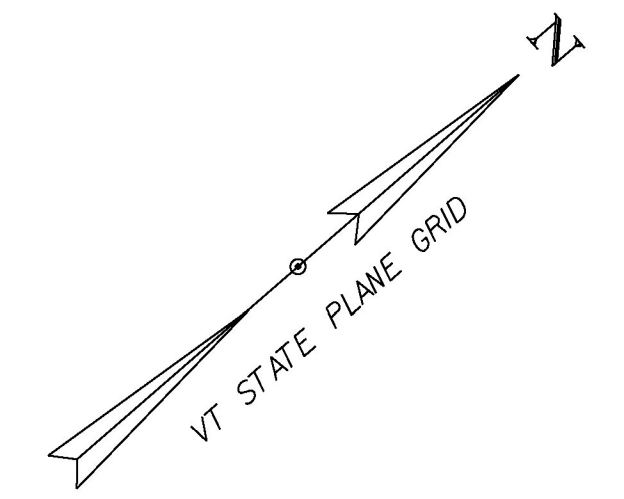

**NOTES:**

1. FOR LEGENDS, SEE SHEETS 3 & 3I.
2. ALL EXISTING SIGNS NOT SHOWN ON THE PLANS SHALL BE RETAINED.
3. ALL UTILITY LOCATIONS SHOWN ARE APPROXIMATE AND SHOULD BE VERIFIED PRIOR TO ANY WORK COMMENCING.
4. SEE SHEET 29 FOR CULVERT INFORMATION.

**65265** CLEANING CULV. PIPE, IN-PLACE [0 TO 24 IN., INCL.]  
STA. R 77+60, 53 LF



PROJECT NAME:	ENOSBURGH-RICHFORD
PROJECT NUMBER:	STP 2969(I)
FILE NAME:	z16vi04bdr.dgn
PROJECT LEADER:	G. EDWARDS
DESIGNED BY:	G. BURGMEIER
PLAN SHEET 94	
PLOT DATE:	4/2/2018
DRAWN BY:	G. BURGMEIER
CHECKED BY:	J. LITTLE
SHEET	124 OF 222

