

MILLED RUMBLE STRIPS (CENTERLINE)
STA. R 63+00 TO R 63+18, CL

DURABLE 4 INCH WHITE LINE, (OPTION CC BID ITEMS)
TEMPORARY 4 INCH WHITE LINE, PAINT
(ALL LINES WILL INCLUDE EDGE LINE BREAKS
AND RADII FOR SIDE ROADS)
STA. R 63+00 TO R 68+00, SOLID LT & RT
STA. R 67+34, SOLID RT (EDGE LINES, ELEMENTARY
SCHOOL RD. TH-43)

DURABLE 24 INCH STOP BAR, (OPTION FF BID ITEMS)
TEMPORARY 24 INCH STOP BAR, PAINT
STA. R 67+34, RT (ELEMENTARY SCHOOL RD. TH-43)

DURABLE LETTER OR SYMBOL, (OPTION GG BID ITEMS)
TEMPORARY LETTER OR SYMBOL, PAINT
STA. R 67+34, RT "STOP" (ELEMENTARY SCHOOL RD. TH-43)

REMOVING SIGNS
AS SHOWN - 9

DURABLE 4 INCH YELLOW LINE, (OPTION DD BID ITEMS)
TEMPORARY 4 INCH YELLOW LINE, PAINT
(ALL LINES WILL INCLUDE C BREAKS FOR SIDE ROADS)
STA. R 63+00 TO R 68+00, SOLID LT & RT
STA. R 67+34, DOUBLE SOLID RT (ELEMENTARY SCHOOL RD. TH-43)

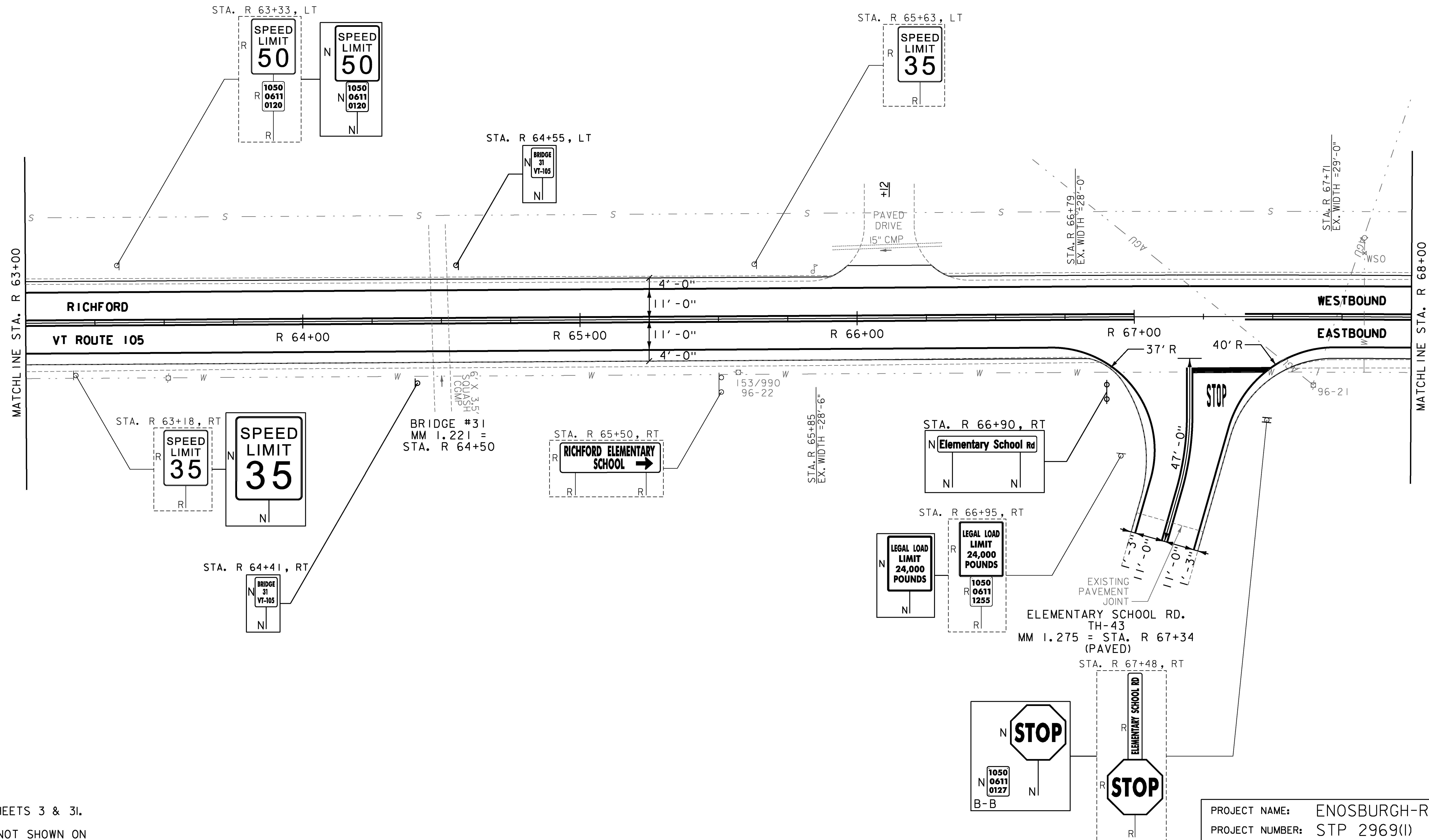
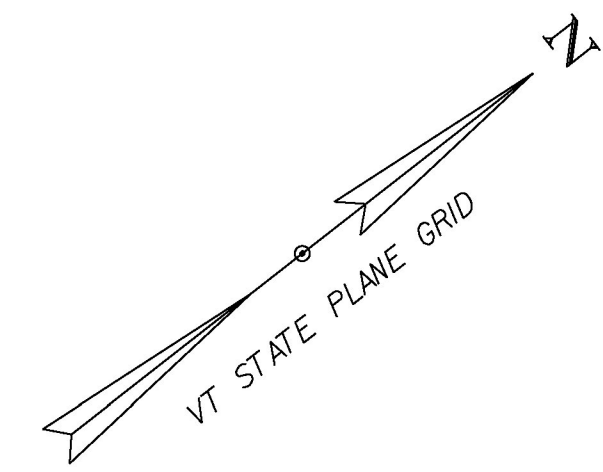

NOTES:

- FOR LEGENDS, SEE SHEETS 3 & 3I.
- ALL EXISTING SIGNS NOT SHOWN ON THE PLANS SHALL BE RETAINED.
- ALL UTILITY LOCATIONS SHOWN ARE APPROXIMATE AND SHOULD BE VERIFIED PRIOR TO ANY WORK COMMENCING.



PROJECT NAME:	ENOSBURGH-RICHFORD
PROJECT NUMBER:	STP 2969(I)
FILE NAME:	z16vi04bdr.dgn
PROJECT LEADER:	G. EDWARDS
DESIGNED BY:	G. BURGMEIER
PLAN SHEET 92	
PLOT DATE:	4/2/2018
DRAWN BY:	G. BURGMEIER
CHECKED BY:	J. LITTLE
SHEET	122 OF 222