

STONE FILL, TYPE I
 SLOPE EROSION PREVENTION WITH GUARDRAIL:
 STA. E 250+35 TO E 251+98, RT
 STA. E 250+71 TO E 253+08, LT
 (SEE SHEET 19)

DURABLE 4 INCH WHITE LINE, (OPTION CC BID ITEMS)
 TEMPORARY 4 INCH WHITE LINE, PAINT
 (ALL LINES WILL INCLUDE EDGE LINE BREAKS
 AND RADII FOR SIDE ROADS)
 STA. E 249+00 TO E 254+00, SOLID LT & RT

DURABLE 4 INCH YELLOW LINE, (OPTION DD BID ITEMS)
 (ALL LINES WILL INCLUDE C BREAKS FOR SIDE ROADS)
 STA. E 249+00 TO E 254+00, SOLID LT & RT
 STA. E 250+12 TO E 250+15, RT (RAIL TRAIL CENTERLINE)
 STA. E 250+13 TO E 250+16, LT (RAIL TRAIL CENTERLINE)

DURABLE 12 INCH WHITE LINE, (OPTION EE BID ITEMS)
 STA. E 250+08 TO E 250+13, LT (RAIL TRAIL STOP BAR)
 STA. E 250+15 TO E 250+18, RT (RAIL TRAIL STOP BAR)

TEMPORARY 4 INCH YELLOW LINE,
 (ALL LINES WILL INCLUDE C BREAKS FOR SIDE ROADS)
 STA. E 249+00 TO E 254+00, SOLID LT & RT

REMOVING SIGNS
 AS SHOWN - 9

ERECTING SALVAGED SIGNS
 AS SHOWN - 2

STEEL BEAM GUARDRAIL, GALVANIZED
 STA. E 250+35.0 TO E 251+97.5, RT
 STA. E 250+70.5 TO E 253+08.0, LT

ANCHOR FOR STEEL BEAM RAIL
 STA. E 250+35.0, RT
 STA. E 250+70.5, LT
 STA. E 251+97.5, RT
 STA. E 253+08.0, LT

REMOVAL AND DISPOSAL OF GUARDRAIL
 STA. E 250+31.0 TO E 251+93.0, RT
 STA. E 250+70.5 TO E 253+08.0, LT

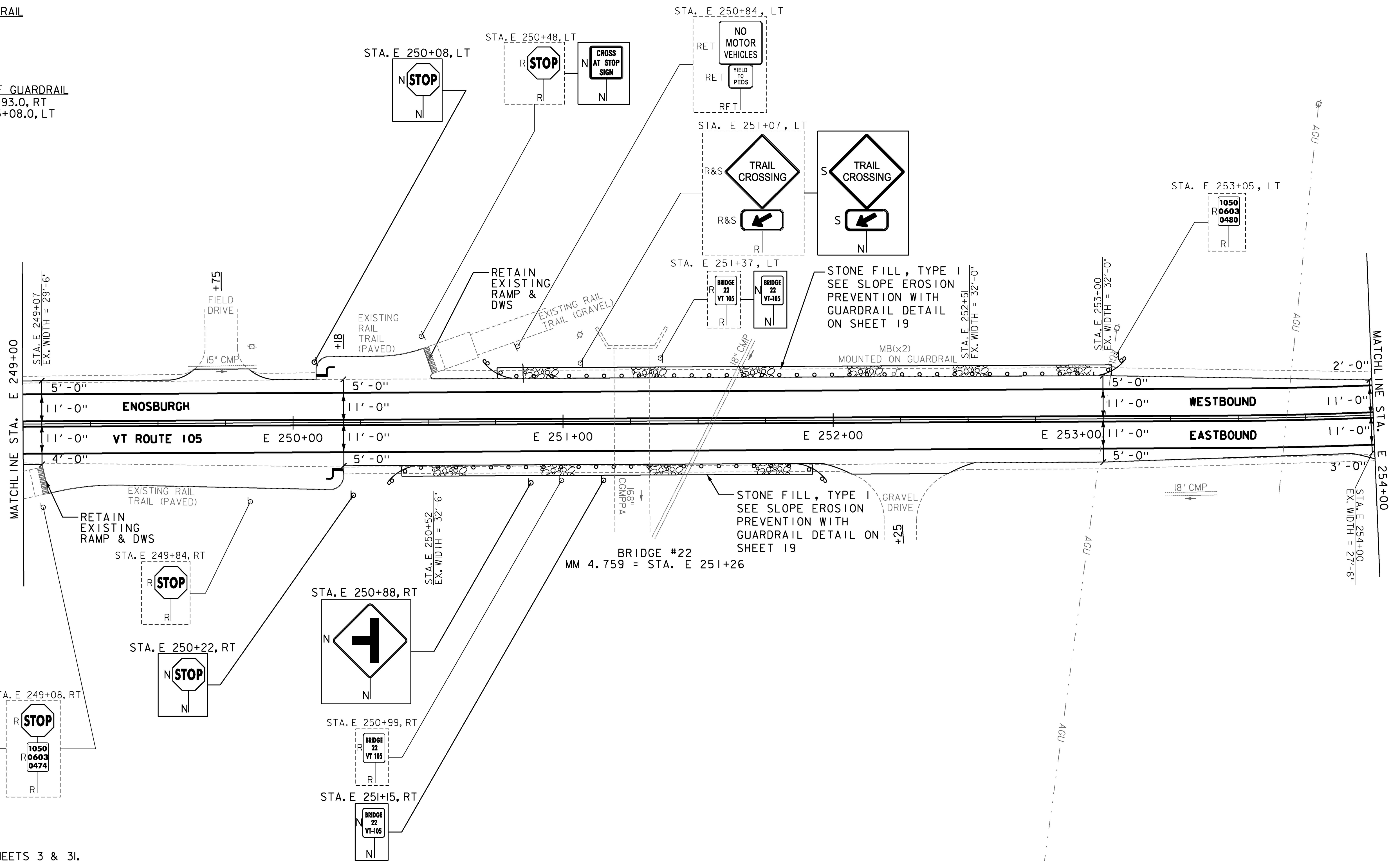

- NOTES:
- FOR LEGENDS, SEE SHEETS 3 & 31.
 - ALL EXISTING SIGNS NOT SHOWN ON THE PLANS SHALL BE RETAINED.
 - ALL UTILITY LOCATIONS SHOWN ARE APPROXIMATE AND SHOULD BE VERIFIED PRIOR TO ANY WORK COMMENCING.
 - SEE SHEETS 11 & 21 FOR RAIL TRAIL PAVEMENT MARKING & PAVEMENT HANDWORK DETAILS.

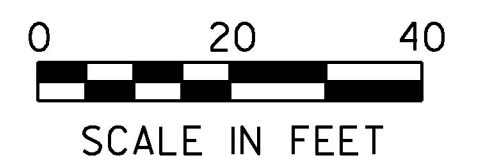

PROJECT NAME:	ENOSBURGH-RICHFORD
PROJECT NUMBER:	STP 2969(I)
FILE NAME:	z16vi04bdr.dgn
PROJECT LEADER:	G. EDWARDS
DESIGNED BY:	G. BURGMEIER
PLAN SHEET 35	
PLOT DATE:	4/2/2018
DRAWN BY:	G. BURGMEIER
CHECKED BY:	J. LITTLE
SHEET	65 OF 222

