

MILLED RUMBLE STRIPS (CENTERLINE)  
STA. E 234+00 TO E 239+00, CL

STONE FILL, TYPE J  
SLOPE EROSION PREVENTION WITH GUARDRAIL:  
STA. E 234+35 TO E 236+85, RT  
(SEE SHEET 19)

STEEL BEAM GUARDRAIL, GALVANIZED  
STA. E 234+35.0 TO E 234+47.5, RT  
STA. E 236+72.5 TO E 236+85.0, RT

ANCHOR FOR STEEL BEAM RAIL  
STA. E 234+35.0, RT  
STA. E 236+85.0, RT

REMOVAL AND DISPOSAL OF GUARDRAIL  
STA. E 234+35 TO E 236+85, RT

ALTERNATES ZA1 & ZA2 BID ITEMS  
S.P. (GREGORY MINI SPACER G.R.)(GMS)  
S.P. (NON-BLOCKED MIDWEST G.R. SYSTEM)(MGS)  
STA. E 234+47.5 TO E 236+72.5, RT

DURABLE 4 INCH WHITE LINE, (OPTION CC BID ITEMS)  
TEMPORARY 4 INCH WHITE LINE, PAINT  
(ALL LINES WILL INCLUDE EDGE LINE BREAKS  
AND RADII FOR SIDE ROADS)  
STA. E 234+00 TO E 239+00, SOLID LT & RT

DURABLE 4 INCH YELLOW LINE, (OPTION DD BID ITEMS)  
TEMPORARY 4 INCH YELLOW LINE, PAINT  
(ALL LINES WILL INCLUDE  $\phi$  BREAKS FOR SIDE ROADS)  
STA. E 234+00 TO E 239+00, SOLID LT & RT

REMOVING SIGNS  
AS SHOWN - 1

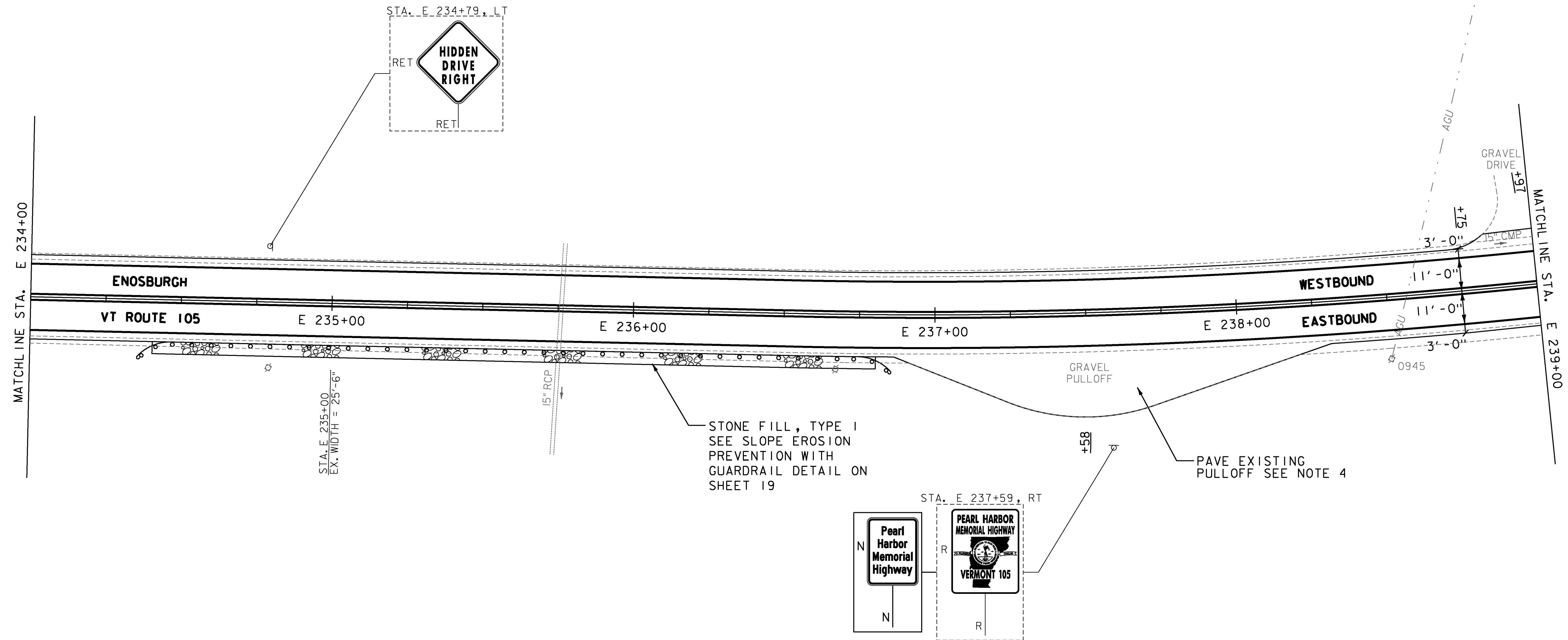

NOTES:

1. FOR LEGENDS, SEE SHEETS 3 & 31.
2. ALL EXISTING SIGNS NOT SHOWN ON THE PLANS SHALL BE RETAINED.
3. ALL UTILITY LOCATIONS SHOWN ARE APPROXIMATE AND SHOULD BE VERIFIED PRIOR TO ANY WORK COMMENCING.
4. SEE SHEET 9 FOR PULL-OFF DETAIL.

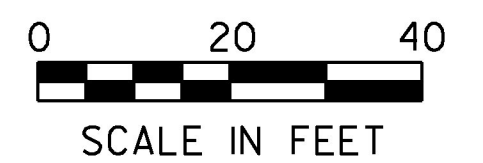

PROJECT NAME:	ENOSBURGH-RICHFORD
PROJECT NUMBER:	STP 2969(I)
FILE NAME:	z16vi04bdr.dgn
PROJECT LEADER:	G. EDWARDS
DESIGNED BY:	G. BURGMEIER
PLAN SHEET 32	
PLOT DATE:	4/2/2018
DRAWN BY:	G. BURGMEIER
CHECKED BY:	J. LITTLE
SHEET 62	OF 222

