

STONE FILL, TYPE I  
SLOPE EROSION PREVENTION WITH GUARDRAIL:  
STA. E 199+00 TO E 202+78, RT  
(SEE SHEET 19)

STEEL BEAM GUARDRAIL, GALVANIZED  
STA. E 202+65.5 TO E 202+78.0, RT

ANCHOR FOR STEEL BEAM RAIL  
STA. E 201+38.0, RT  
STA. E 201+78.0, RT  
STA. E 202+78.0, RT

REMOVAL AND DISPOSAL OF GUARDRAIL  
STA. E 199+00.0 TO E 201+78.0, RT

ALTERNATES ZA1 & ZA2 BID ITEMS  
S.P. (GREGORY MINI SPACER G.R.)(GMS) W/8 FEET POSTS  
S.P. (NON-BLOCKED MIDWEST G.R. SYSTEM)(MGS) W/8 FEET POSTS  
STA. E 199+00.0 TO E 202+65.5, RT

DURABLE 4 INCH WHITE LINE, (OPTION CC BID ITEMS)  
(ALL LINES WILL INCLUDE EDGE LINE BREAKS  
AND RADII FOR SIDE ROADS)  
STA. E 199+00 TO E 204+00, SOLID LT & RT  
STA. E 200+35 TO E 200+59, LT (BUFFER & DIAGONALS)  
STA. E 201+86 TO E 202+78, RT (BUFFER & DIAGONALS)

DURABLE 4 INCH YELLOW LINE, (OPTION DD BID ITEMS)  
(ALL LINES WILL INCLUDE C BREAKS FOR SIDE ROADS)  
STA. E 199+00 TO E 204+00, SOLID LT & RT  
STA. E 200+58 TO E 200+62, LT (RAIL TRAIL CENTERLINE)  
STA. E 201+83 TO E 201+87, RT (RAIL TRAIL CENTERLINE)

DURABLE 12 INCH WHITE LINE, (OPTION EE BID ITEMS)  
STA. E 200+59 TO E 200+63, LT (RAIL TRAIL STOP BAR)  
STA. E 201+83 TO E 201+86, RT (RAIL TRAIL STOP BAR)

DURABLE LETTER OR SYMBOL, (OPTION GG BID ITEMS)  
STA. E 200+70, RT BIKE LANE SYMBOL  
STA. E 200+82, RT BIKE LANE ARROW  
STA. E 201+68, LT BIKE LANE ARROW  
STA. E 201+80, LT BIKE LANE SYMBOL

TEMPORARY 4 INCH WHITE LINE, PAINT  
(ALL LINES WILL INCLUDE EDGE LINE BREAKS  
AND RADII FOR SIDE ROADS)  
STA. E 199+00 TO E 204+00, SOLID LT & RT

TEMPORARY 4 INCH YELLOW LINE,  
(ALL LINES WILL INCLUDE C BREAKS FOR SIDE ROADS)  
STA. E 199+00 TO E 204+00, SOLID LT & RT

REMOVING SIGNS  
AS SHOWN - 5

ERECTING SALVAGED SIGNS  
AS SHOWN - 2

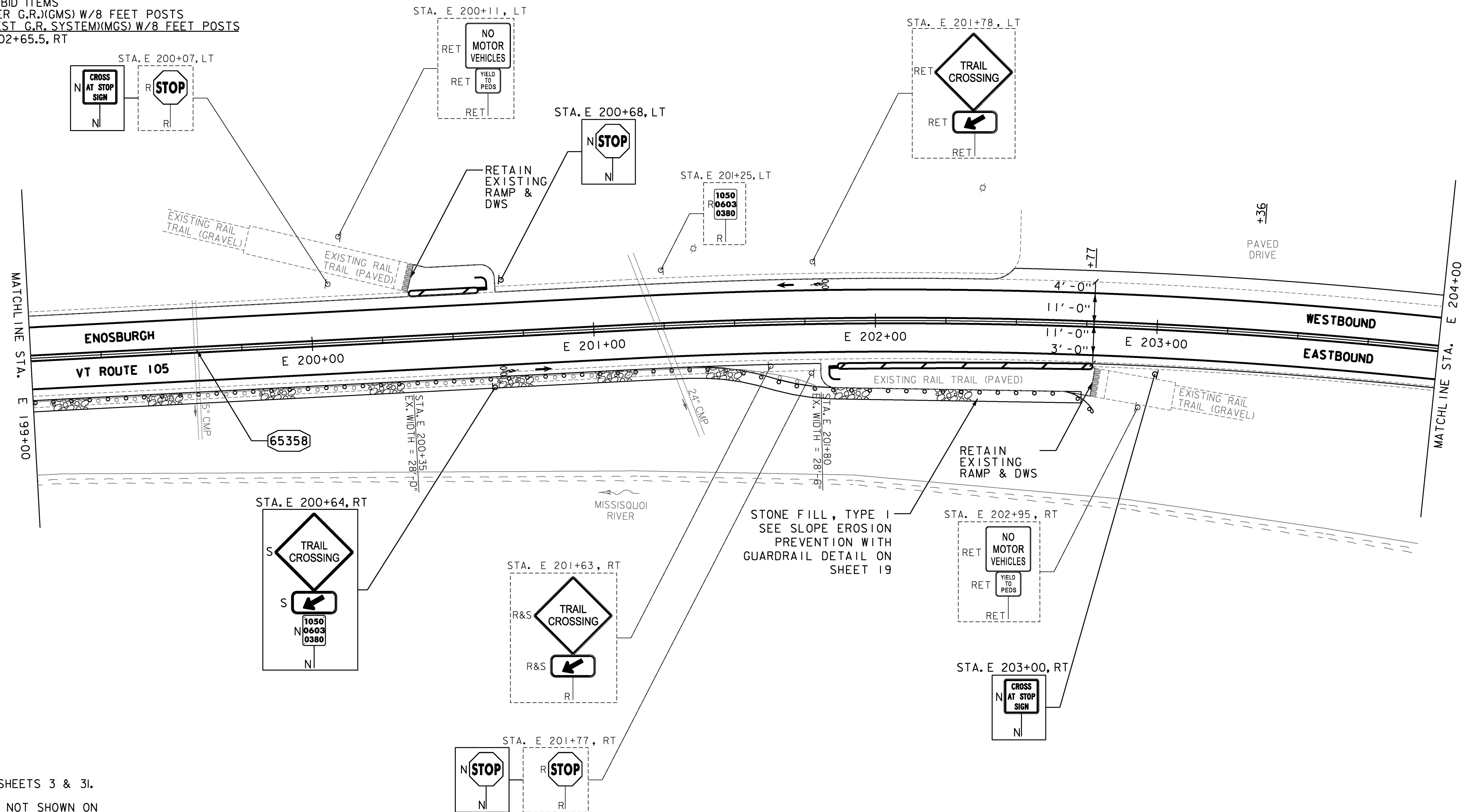
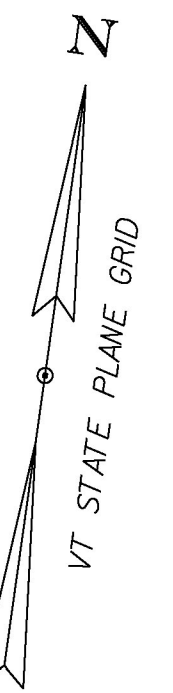

- NOTES:
- FOR LEGENDS, SEE SHEETS 3 & 3I.
  - ALL EXISTING SIGNS NOT SHOWN ON THE PLANS SHALL BE RETAINED.
  - ALL UTILITY LOCATIONS SHOWN ARE APPROXIMATE AND SHOULD BE VERIFIED PRIOR TO ANY WORK COMMENCING.
  - SEE SHEETS 11 & 21 FOR RAIL TRAIL PAVEMENT MARKING & PAVEMENT HANDWORK DETAILS.
  - SEE SHEET 29 FOR CULVERT INFORMATION.

**65358** CLEANING CULV. PIPE, IN-PLACE (0 TO 24 IN., INCL.)  
STA. E 199+59, 50 LF

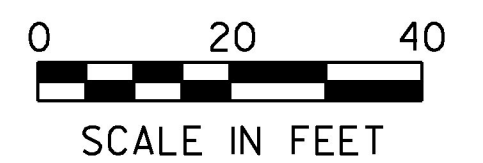

PROJECT NAME:	ENOSBURGH-RICHFORD
PROJECT NUMBER:	STP 2969(I)
FILE NAME:	z16vi04bdr.dgn
PROJECT LEADER:	G. EDWARDS
DESIGNED BY:	G. BURGMEIER
PLAN SHEET 25	
PLOT DATE:	4/2/2018
DRAWN BY:	G. BURGMEIER
CHECKED BY:	J. LITTLE
SHEET	55 OF 222

