

REFERENCE BILL OF MATERIAL FOR 007062-003 PLUGBOARD KIT
SEE FIGURE 5

DIN	DESCRIPTION	QUANTITY
1	B1 PLUGBOARD	1
2	RELAY POSTS, 1/4-28 THREADS	2
3	MOUNTING SCREWS, 14-28 THREADS X 1 1/4"	2
4	THIN WASHERS	2
5	SPLIT WASHERS, 1/4" COPPER COLOR	2
6	HEX NUT, 1/4-28 THREADS, SS	2
7	HEX NUTS, 1/4-28 THREADS, NYLON	2
8	THIN WASHERS	2
9	RELAY NUTS, AAR KNURLED	2
10	SUPER FLAT NUTS, AAR	2
11	E-POST, AAR	1
12	CROWN NUTS, AAR	2
13	FLAT HEX NUT, AAR	1
14	1/4" FLAT WASHERS, AAR	4 (ONLY USE 3)
15	SLOTTED NUT, 3-E, AAR	1
16	3E-CLIP, SOLDER TYPE	1
17	3-E WASHER, PLASTIC	1
18	1/4" FLAT WASHER	2

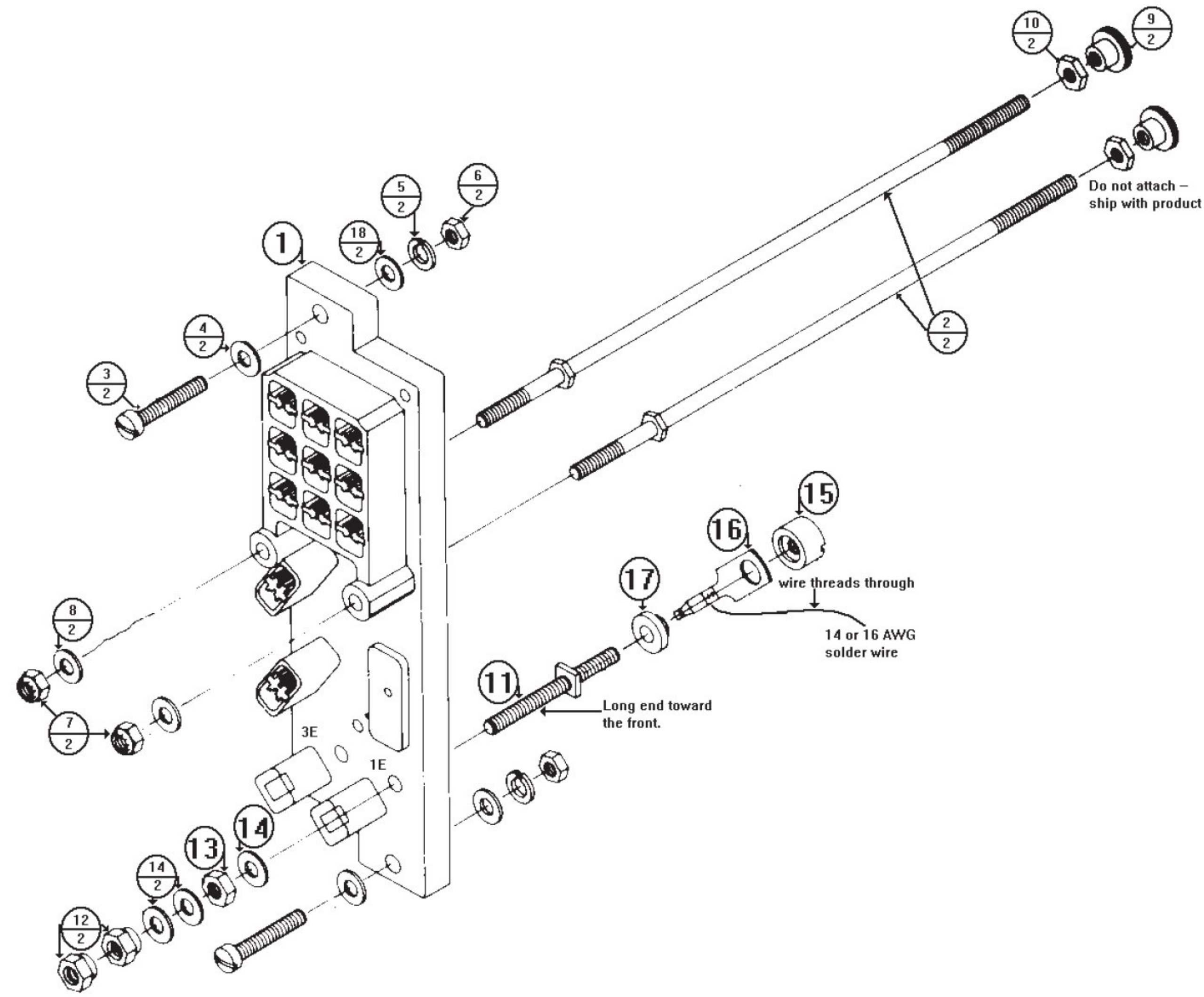

➔ **FIGURE 5: B1 RELAY PLUGBOARD ASSEMBLY**

REV
LKO



GE Transportation Systems
Global Signaling

Argo and Dillingham Rds, Grain Valley, MO 64029

Title RLY GRS TYPE B VITAL PLUG-IN

Drawing No.
007062-XXX

Sheet
4 of 4