

**RETAINING WALL ELEVATION  
STA 144+80, LT - 145+83, LT**

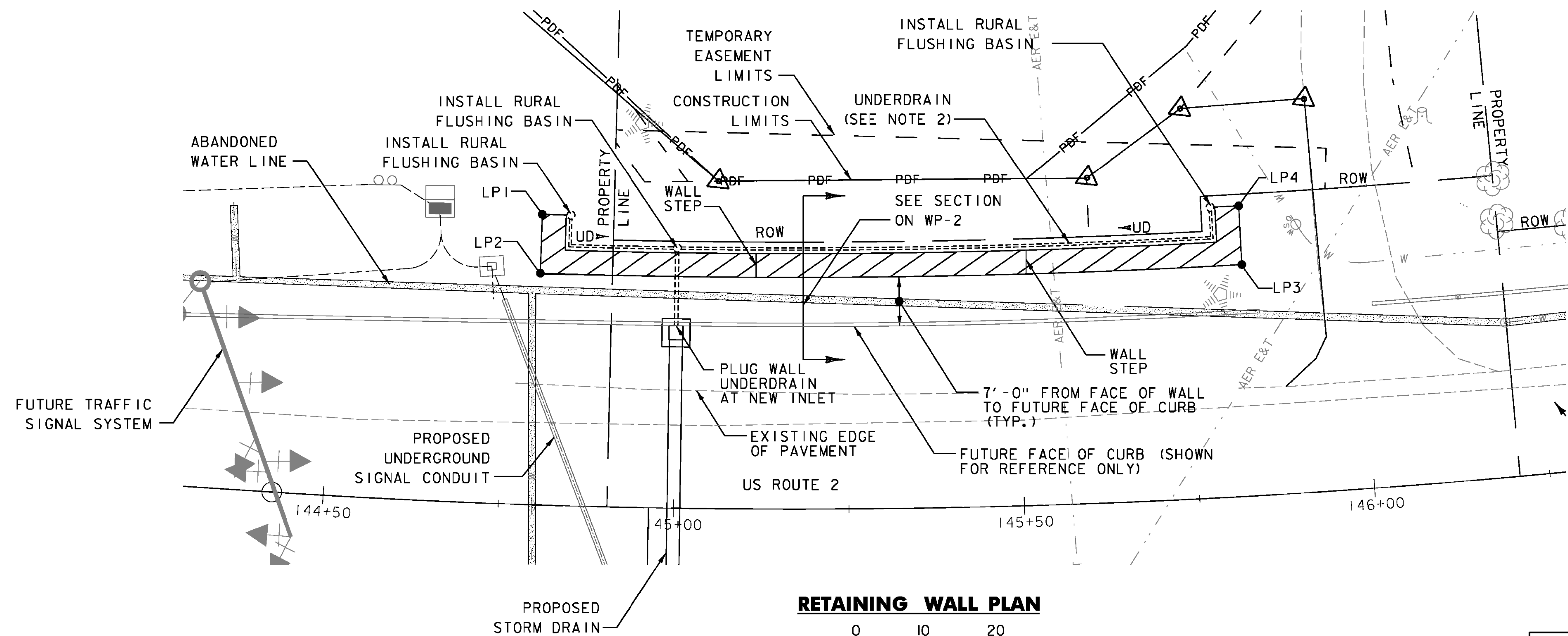

**RETAINING WALL PLAN**

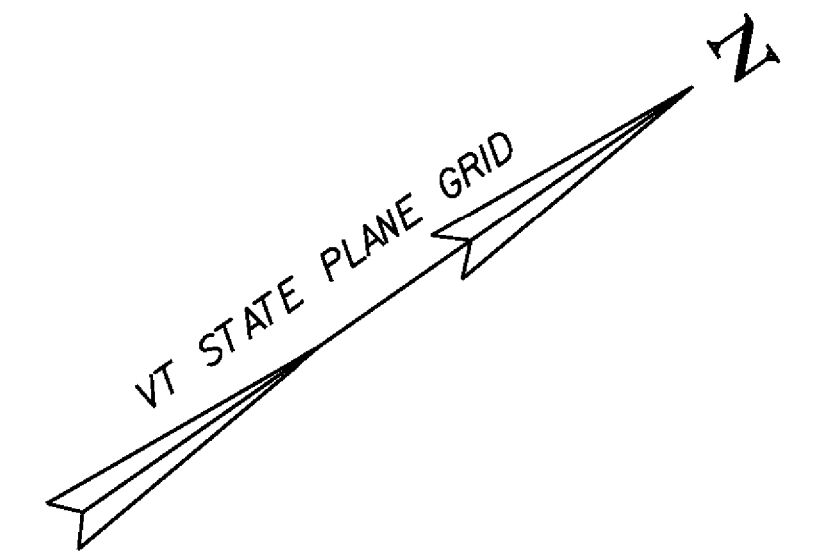
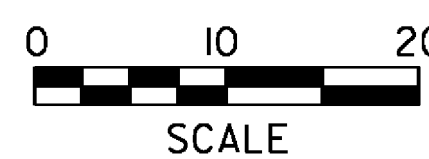

**NOTES:**

1. ACTUAL BOTTOM OF WALL ELEVATION AND STEPPING LOCATIONS TO BE DETERMINED BY THE WALL MANUFACTURER.
2. UNDERDRAIN LOCATION AND DEPTH TO BE SPECIFIED BY THE WALL MANUFACTURER. PAYMENT SHALL BE INCIDENTAL TO 900.675 SPECIAL PROVISION (PRECAST CONCRETE GRAVITY RETAINING WALL WITH PEDESTRIAN RAILING)

RETAINING WALL LAYOUT TABLE		
LAYOUT POINT	US 2 STATION	US 2 OFFSET (FT)
1	144+80	41.4
2	144+80	33.0
3	145+83	33.0
4	145+83	41.4

144+81.5 →  
145+84.7 →  
33.3 →

PROJECT NAME: EAST MONTPELIER  
 PROJECT NUMBER: BF EWP2(I)  
 FILE NAME: ...XX\_Retaining\_Wall - ER.dgn PLOT DATE: 5/26/2016  
 PROJECT LEADER: T. KNIGHT DRAWN BY: J. SOTER  
 DESIGNED BY: K. RICHARDSON CHECKED BY: T. KNIGHT  
 WALL PLAN & PROFILE WP 1 SHEET 19 OF 42

