

STATE OF VERMONT
AGENCY OF TRANSPORTATION

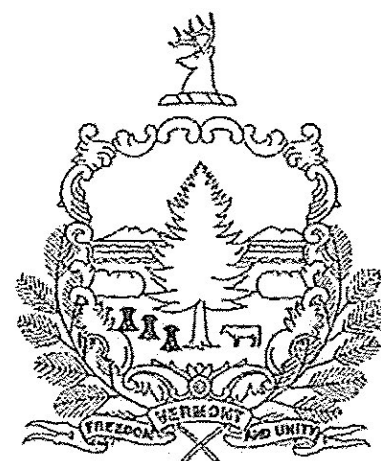

PROPOSED IMPROVEMENT
TOWN OF EAST MONTPELIER
COUNTY OF WASHINGTON
US ROUTE 2
(PRINCIPAL ARTERIAL)

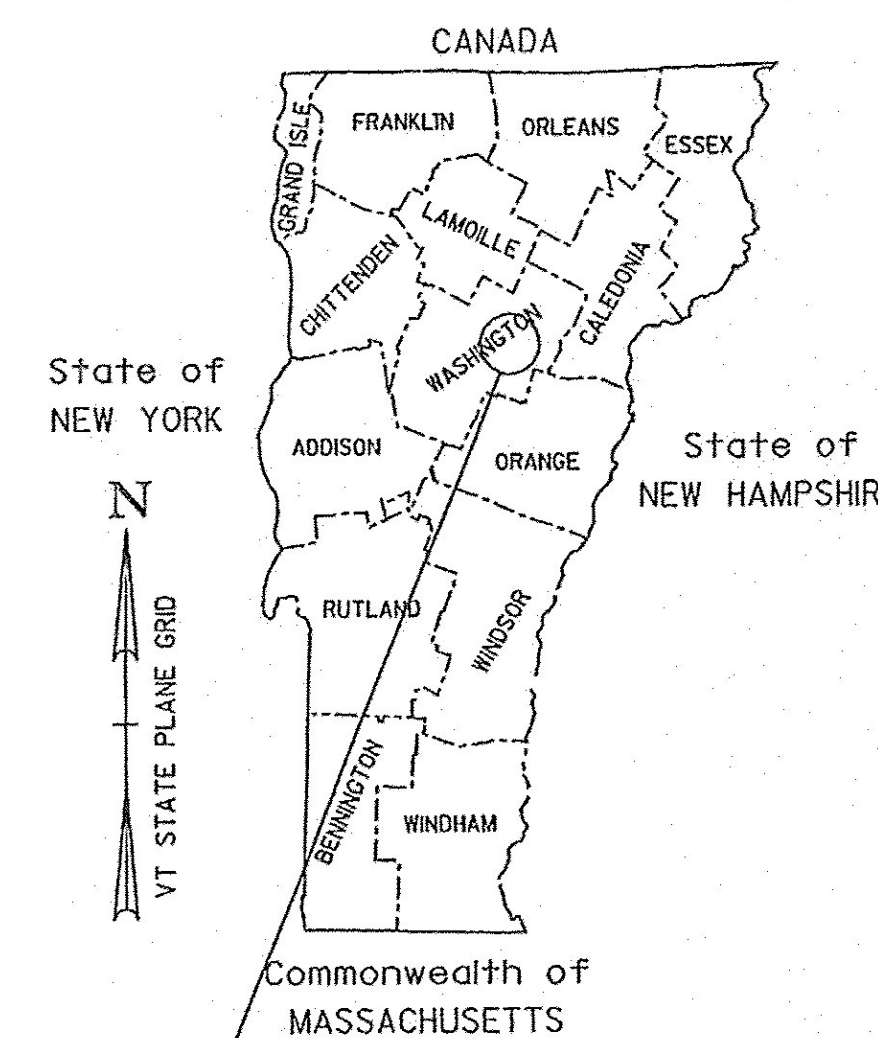
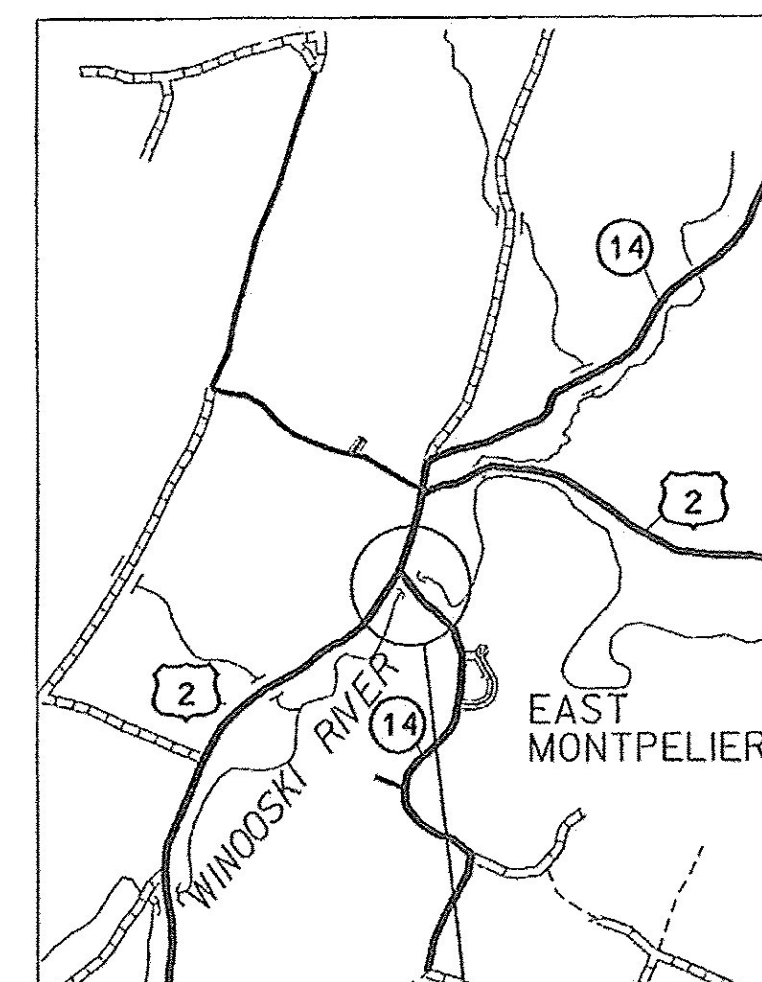

PROJECT
EAST MONTPELIER BR# 037-1 (7)
LOCATION MAP NOT TO SCALE

RECORD PLANS	
CONTRACTOR:	ENGINEERS CONSTR., INC. - SO. BURLINGTON, VT
RESIDENT ENGINEER:	CHRIS BARKER
CONSTRUCTION BEGAN:	SEPTEMBER 19, 2016
CONSTRUCTION COMPLETE:	MAY 5, 2017
RECORD PLANS BY:	CHRIS BARKER & AARON WEAVER
I HEREBY CERTIFY THAT ALL THE CONSTRUCTION REQUIRED BY THIS SET OF DRAWINGS HAS BEEN ACCOMPLISHED AS INDICATED HEREIN.	
BY:	RESIDENT ENGINEER
DATE:	05/20/18
NOTE: Any further information concerning final quantities, amounts or other details relative to this project may be found at Central Files in the electronic archives.	

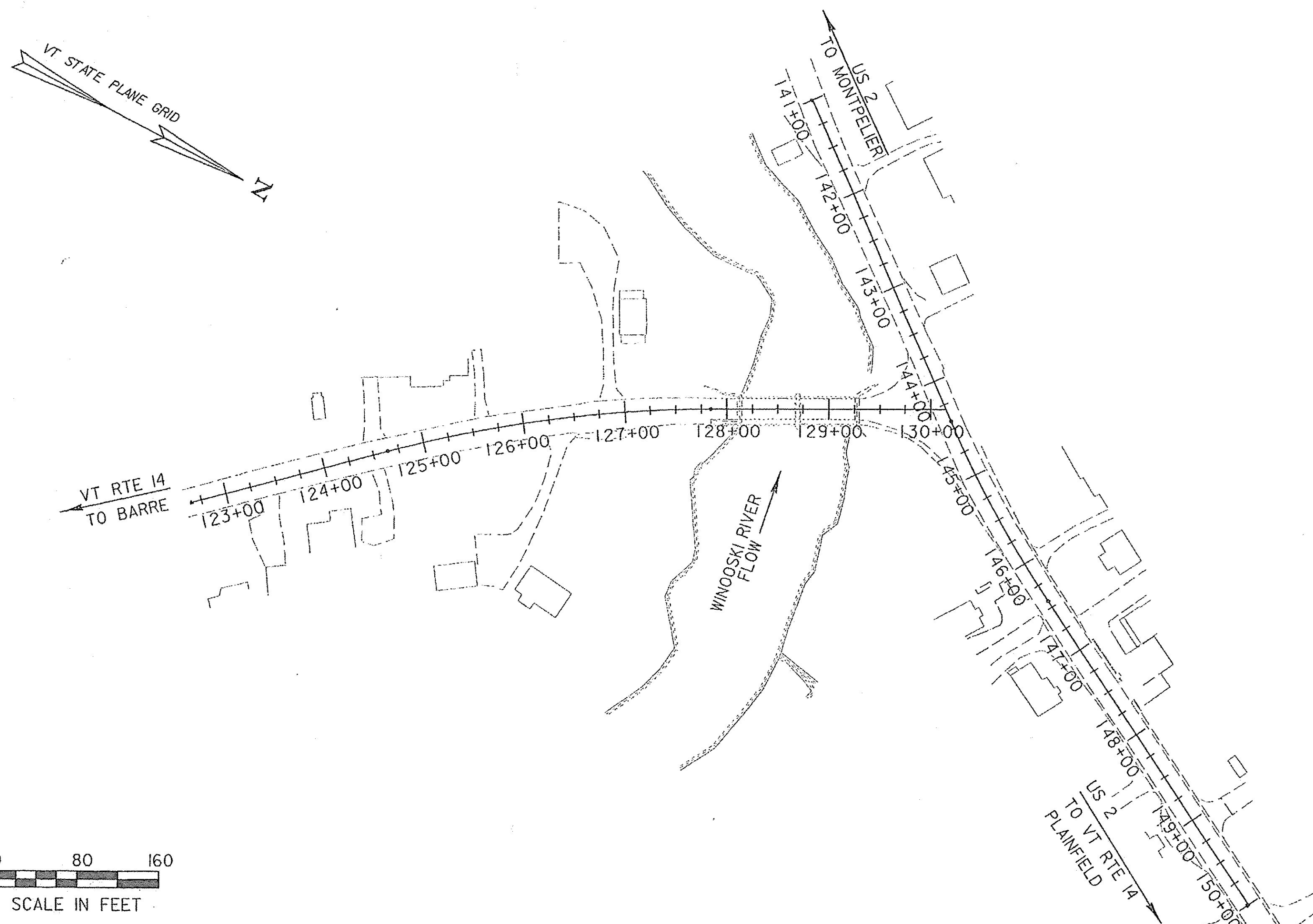

PROJECT LOCATION : LOCATED IN THE COUNTY OF WASHINGTON, TOWN OF EAST MONTPELIER, ON US ROUTE 2, NEAR THE INTERSECTION WITH VERMONT ROUTE 14 SOUTH.

PROJECT DESCRIPTION : CONSTRUCTION OF NEW DRAINAGE, RETAINING WALL AND CONDUIT FOR UNDERGROUND UTILITIES.

LENGTH OF STRUCTURE: 0 FEET
LENGTH OF ROADWAY: 584.0 FEET
LENGTH OF PROJECT: 584.0 FEET

CONSTRUCTION IS TO BE CARRIED ON IN ACCORDANCE WITH THESE PLANS AND THE STANDARD SPECIFICATIONS FOR CONSTRUCTION DATED 2011, AS APPROVED BY THE FEDERAL HIGHWAY ADMINISTRATION ON JULY 20, 2011 FOR USE ON THIS PROJECT, INCLUDING ALL SUBSEQUENT REVISIONS AND SUCH REVISED SPECIFICATIONS AND SPECIAL PROVISIONS AS ARE INCORPORATED IN THESE PLANS.

QUALITY ASSURANCE PROGRAM : LEVEL I
SURVEYED BY : R. GILMAN
SURVEYED DATE : OCTOBER 1999
DATUM
VERTICAL DATUM NAVD 88
HORIZONTAL ASSUMED

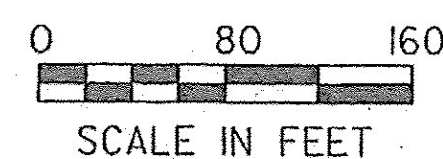

Stantec
Stantec Consulting Services Inc.
55 Green Mountain Drive
South Burlington VT U.S.A. 05403
Phone: (802) 864-0223
Fax: (802) 864-0165
www.stantec.com

5/12/2016

DEPARTMENT OF TRANSPORTATION FEDERAL HIGHWAY ADMINISTRATOR	APPROVED DATE 06/14/16
DIRECTOR OF PROJECT DELIVERY	APPROVED DATE 5/12/2016
PROJECT MANAGER : MARK SARGENT	
PROJECT NAME : EAST MONTPELIER	
PROJECT NUMBER : BF EWP2 (1)	
SHEET 1 OF 42 SHEETS	