

G.

**CARMINATI,  
SUSAN G.  
& TED L.**

**N/F  
WELCH, KELLY J.**

BUXTON SILT LOAM  
15%-25% SLOPES  
K= 0.32

**N/F  
SANTARCANGELO, SUZANNE;  
MERRIMAN, PETER E.**

SALMON VERY FINE SANDY LOAM  
8%-15% SLOPES  
K= 0.32

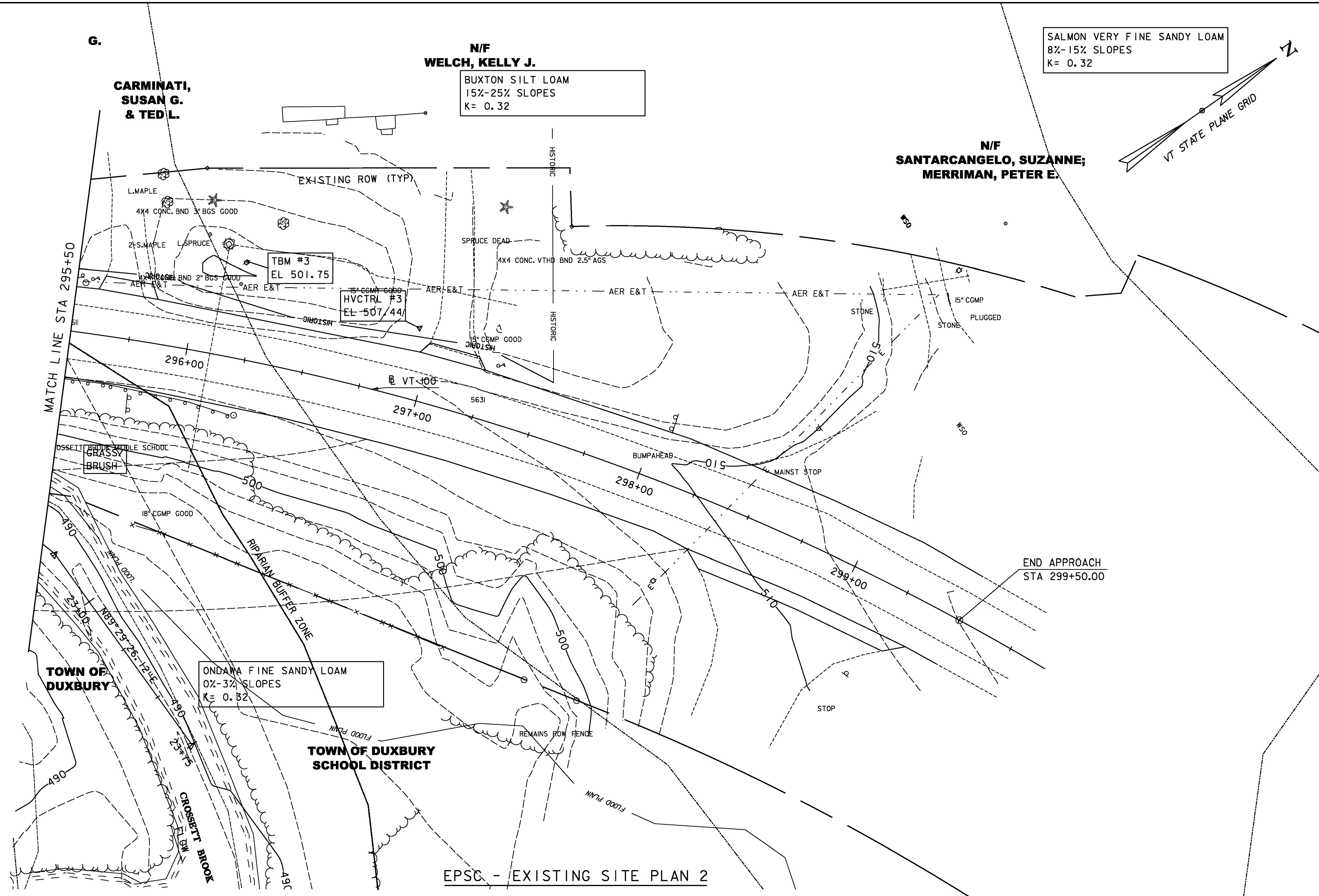
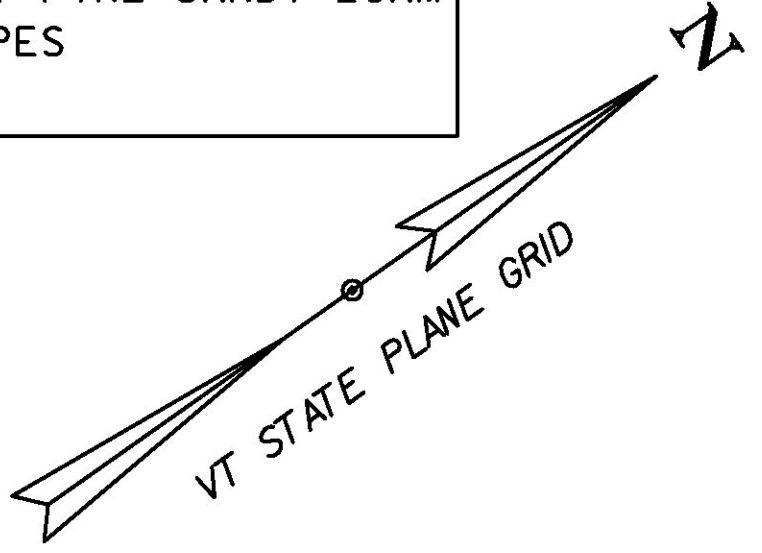

MATCH LINE STA 295+50

END APPROACH  
STA 299+50.00

**TOWN OF  
DUXBURY**

**TOWN OF DUXBURY  
SCHOOL DISTRICT**

EPSC - EXISTING SITE PLAN 2

SCALE 1" = 20' - 0"  
20 0 20

**TYLIN INTERNATIONAL**

PROJECT NAME: DUXBURY	PLOT DATE: 5/23/2016
PROJECT NUMBER: BF 013-4(47)	DRAWN BY: S. MORGAN
FILE NAME: z16b001e.r0.dgn	CHECKED BY: J. OLUND
DESIGNED BY: B. TOOTHAKER	SHEET 59 OF 69
EPSC EXISTING SITE PLAN 2	