

REMOVING SIGNS

STA 293+41 LT (2 SIGNS)
 STA 295+14 LT (2 SIGNS)

4 INCH YELLOW LINE (4" YL)

STA 290+65.00 - 298+55.00 (790' EA) (DOUBLE CENTERLINE)

4 INCH WHITE LINE (4" WL)

STA 291+25.00, LT - 298+69.05, LT (767')
 STA 291+25.00, RT - 298+55.16, RT (736')

SPECIAL PROVISION (RELOCATE FLASHING BEACON, GROUND MOUNTED)

STA 292+75.00, RT

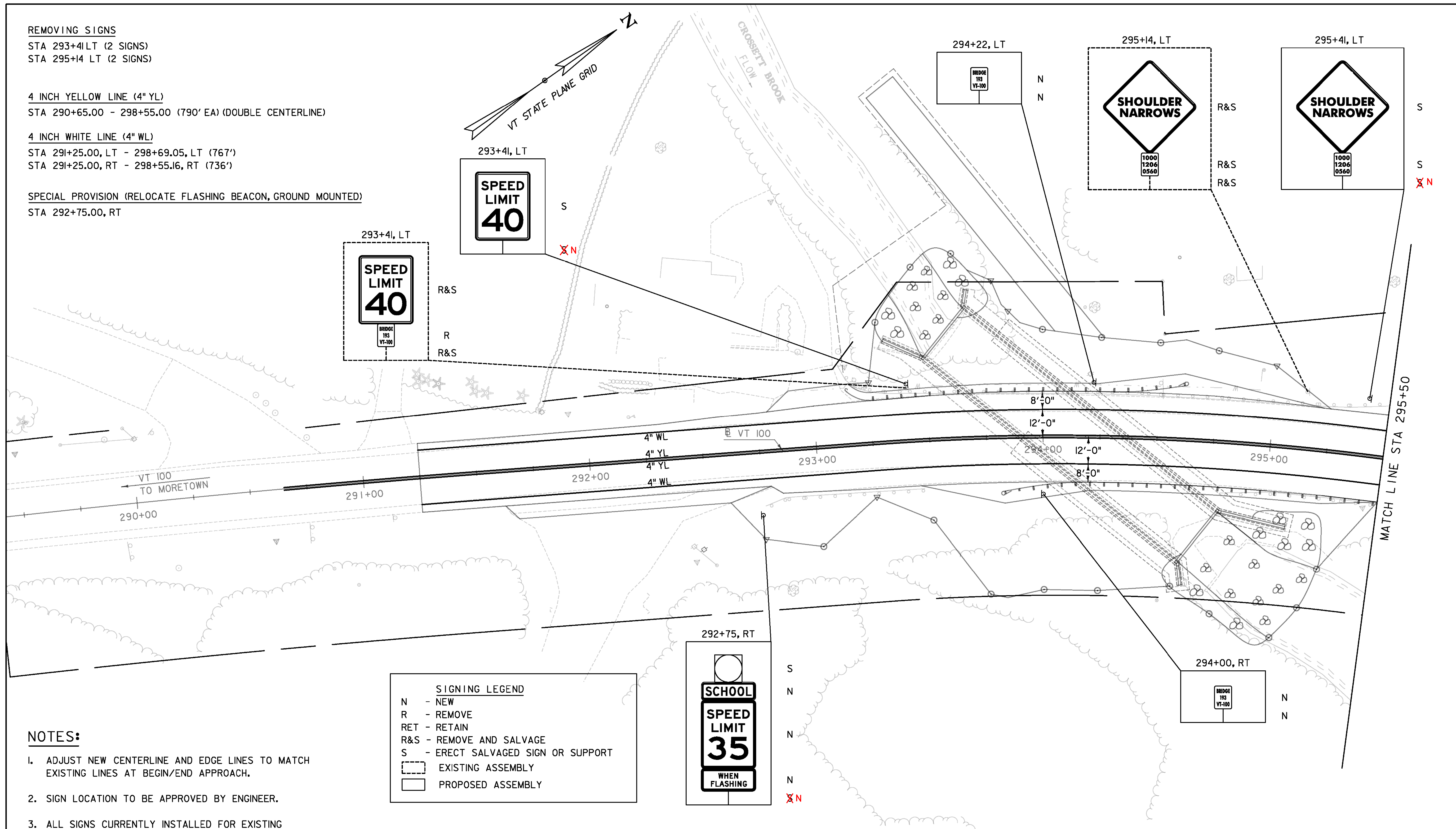
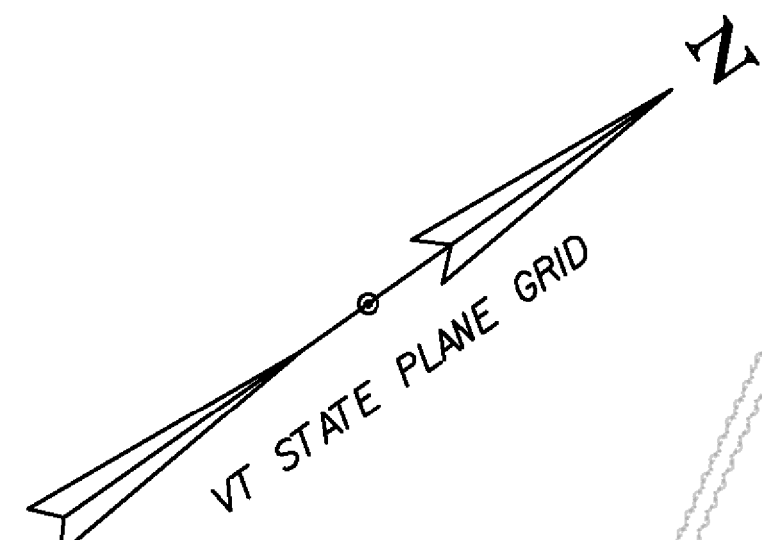

SIGNING LEGEND	
N	- NEW
R	- REMOVE
RET	- RETAIN
R&S	- REMOVE AND SALVAGE
S	- ERECT SALVAGED SIGN OR SUPPORT
	EXISTING ASSEMBLY
	PROPOSED ASSEMBLY



NOTES:

- ADJUST NEW CENTERLINE AND EDGE LINES TO MATCH EXISTING LINES AT BEGIN/END APPROACH.
- SIGN LOCATION TO BE APPROVED BY ENGINEER.
- ALL SIGNS CURRENTLY INSTALLED FOR EXISTING TEMPORARY BRIDGE SHALL BE REMOVED BY THE CONTRACTOR ONCE TRAFFIC IS SHIFTED TO THE TEMPORARY ROADWAY. PAYMENT WILL BE MADE UNDER ITEM 900.645, "SPECIAL PROVISION (REMOVAL OF TEMPORARY BRIDGE)."

TRAFFIC SIGNS AND LINES LAYOUT I

SCALE 1" = 20' - 0"
 20 0 20

TYL INTERNATIONAL

PROJECT NAME: DUXBURY	PLOT DATE: 5/23/2016
PROJECT NUMBER: BF 013-4(47)	DRAWN BY: B. TOOTHAKER
FILE NAME: z16b001ts.dgn	CHECKED BY: K. DUCHARME
PROJECT LEADER: J. OLUND	TRAFFIC SIGNS AND LINES LAYOUT SHEET I SHEET 33 OF 69
DESIGNED BY: B. TOOTHAKER	