

REMOVAL OF EXISTING PAVEMENT MARKINGS
 STA 291+41.5 - STA. 293+24.0, RT
 STA 291+41.5 - STA. 293+24.0, LT
 STA 291+41.5 - STA. 293+24.0, CL
 NOTE: SEE VT 100 LAYOUT SHEETS FOR STATIONING

TEMPORARY 4 INCH WHITE LINE
 STA 50+90.47 - STA. 54+40.00, RT
 STA 50+90.47 - STA. 54+40.00, LT

TEMPORARY 4 INCH YELLOW LINE
 STA 50+90.47 - STA. 55+01.22, CL
 NOTE: DYL NOT SHOWN FOR CLARITY

REMOVING SIGNS
 STA 292+74.57, RT (3 SIGNS)

NOTES:
 1. SEE CONSTRUCTION APPROACH SIGNING SHEET FOR ADDITIONAL SIGNS AND NOTES.
 2. USE GROOVED PAVEMENT SIGN STRUCTURES DURING CONSTRUCTION AS DIRECTED BY THE ENGINEER.
 3. TEMPORARILY RELOCATE MAILBOXES AS NOTED ON THE PLANS DURING ROAD CLOSURE. LOCATIONS SHOWN ON THE PLANS ARE APPROXIMATE AND MAY BE MODIFIED WITH APPROVAL OF THE ENGINEER.

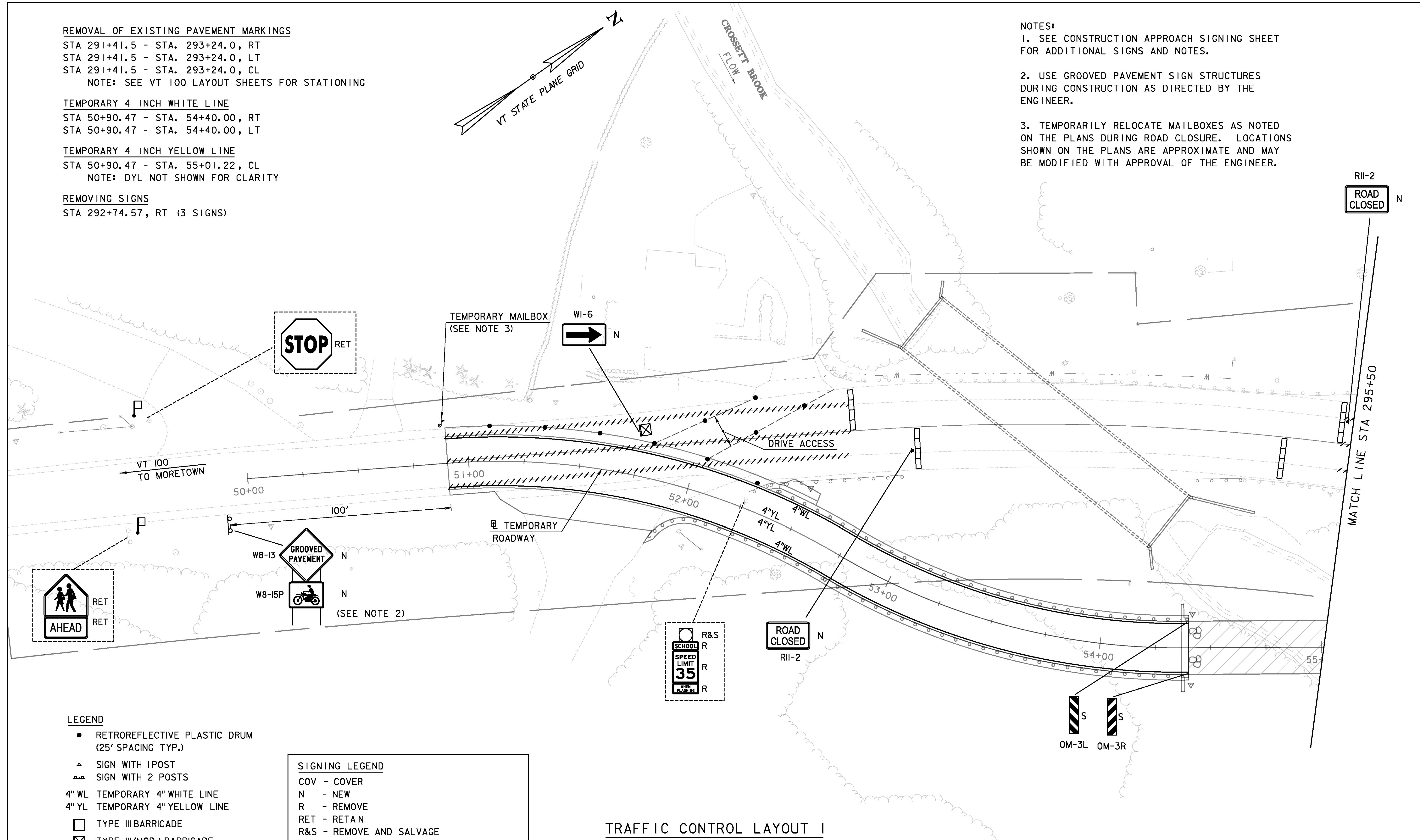

- LEGEND**
- RETROREFLECTIVE PLASTIC DRUM (25' SPACING TYP.)
 - ▲ SIGN WITH 1 POST
 - ▲▲ SIGN WITH 2 POSTS
 - 4" WL TEMPORARY 4" WHITE LINE
 - 4" YL TEMPORARY 4" YELLOW LINE
 - TYPE III BARRICADE
 - ⊠ TYPE III (MOD.) BARRICADE
 - //// PAVEMENT MARKING REMOVAL
 - TEMPORARY TRAFFIC BARRIER
 - ▨ TEMPORARY BRIDGE
 - P FLAGGER STATION

- SIGNING LEGEND**
- COV - COVER
 - N - NEW
 - R - REMOVE
 - RET - RETAIN
 - R&S - REMOVE AND SALVAGE
 - S - ERECT SALVAGED SIGN OR SUPPORT
 - ▭ EXISTING ASSEMBLY

TRAFFIC CONTROL LAYOUT I

SCALE 1" = 20'-0"
 20 0 20

TYLIN INTERNATIONAL	PROJECT NAME: DUXBURY	PLOT DATE: 5/23/2016
	PROJECT NUMBER: BF 013-4(47)	DRAWN BY: B. TOOTHAKER
	FILE NAME: z16b001+clayout.dgn	CHECKED BY: K. DUCHARME
	PROJECT LEADER: J. OLUND	SHEET 29 OF 69
	DESIGNED BY: B. TOOTHAKER	
	TRAFFIC CONTROL LAYOUT I	