

WOVEN WIRE FENCE WITH STEEL POSTS  
 STA 295+88.25 - STA 297+07.97, RT

REMOVAL OF EXISTING FENCE  
 STA 295+88.25 - STA 297+07.97, RT

ANCHOR FOR STEEL BEAM RAIL  
 STA 296+50.00, RT

CONSTRUCT DRIVES

STA 295+59.37 - STA 295+84.46, LT  
 6' PAVED APRON  
 STA 296+96.26 - STA 297+24.64, LT  
 5' PAVED APRON  
 STA 298+30.77 - STA 299+34.87, RT  
 6' PAVED APRON

CURVE (2)  
 DELTA = 53°27'02"  
 D = 5°15'00"  
 R = 1091.35'  
 T = 549.50'  
 L = 1018.11'  
 E = 130.53'  
 PT STA 303+43.66

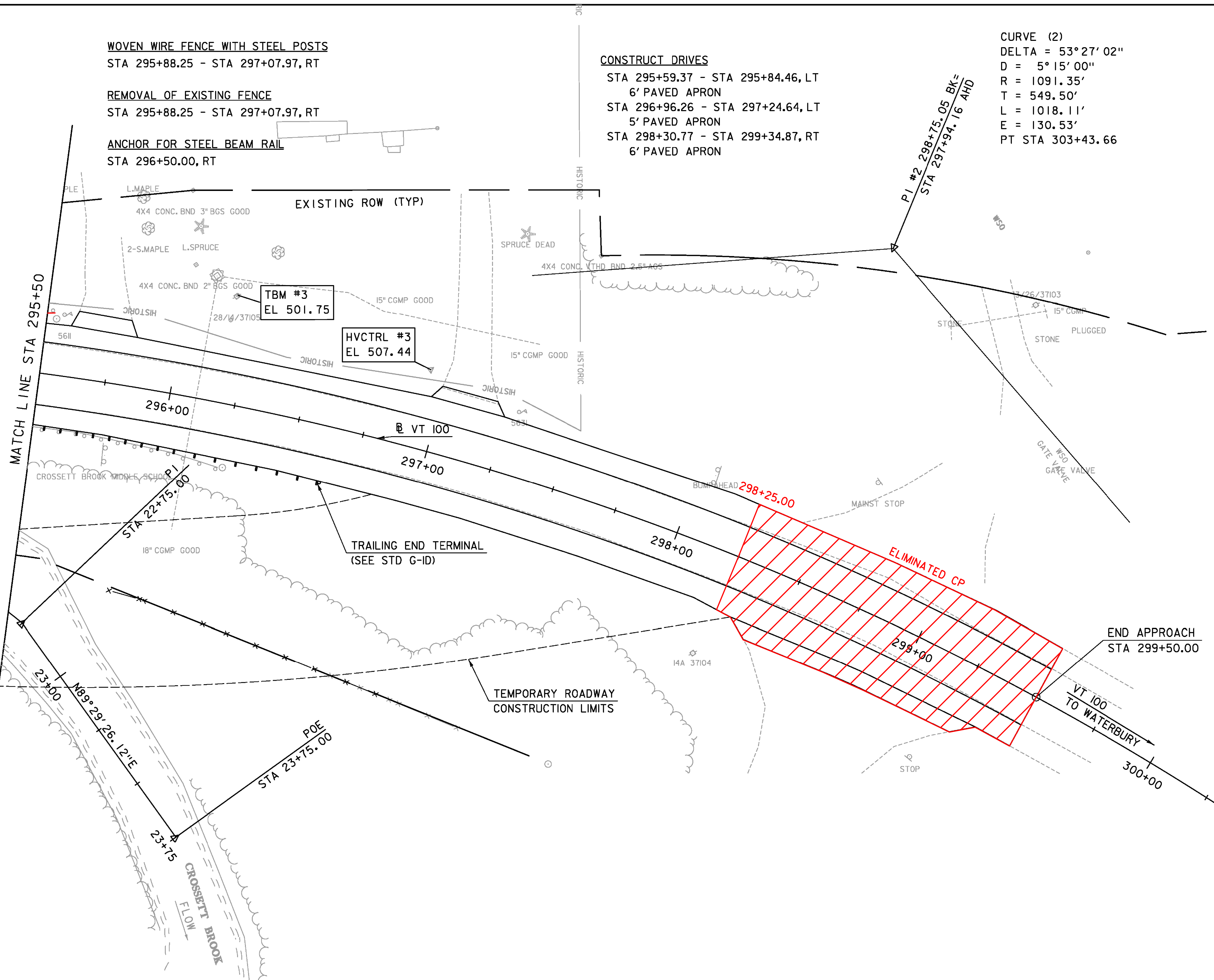
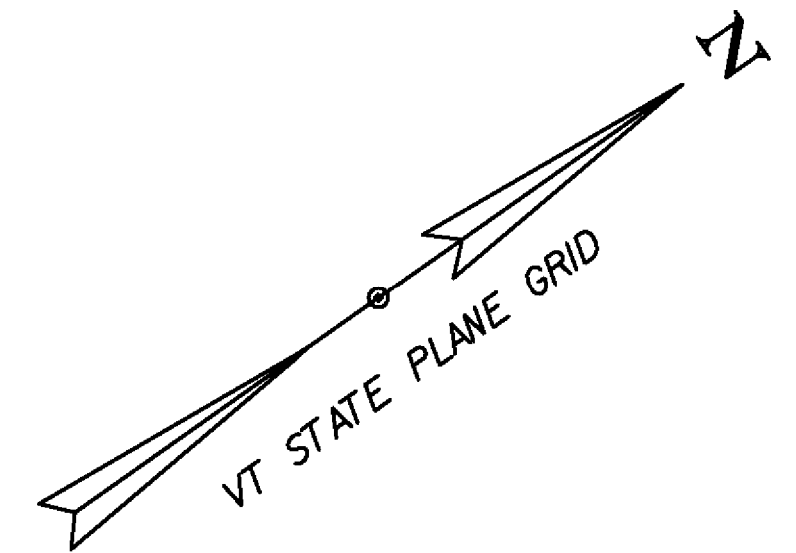

LAYOUT 2

SCALE 1" = 20'-0"  
 20 0 20

TYLINTERNATIONAL

PROJECT NAME: DUXBURY	PLOT DATE: 5/23/2016
PROJECT NUMBER: BF 013-4(47)	DRAWN BY: S. MORGAN
FILE NAME: z16b00lbr.dgn	CHECKED BY: J. OLUND
PROJECT LEADER: J. OLUND	SHEET 12 OF 69
DESIGNED BY: J. HOWE	
LAYOUT SHEET 2	