

NOTE: SEE TRAFFIC CONTROL NOTES FOR ADDITIONAL INFORMATION ON THE CONSTRUCTION PHASING

621.57 ENERGY ABSORPTION BARRIER, SAND FILLED PLASTIC BARREL TEST LEVEL 3 (TL-3)

TEMPORARY PORTABLE LIGHTING UNIT

TRAFFIC SAFETY BARRELS (TYP.) DURING PHASE III

LIMIT OF WORK MATCH EXISTING STA 101+67.50

BEGIN PROJECT STPG SGNL (47) STA 14+50.00

PHASE I - VT 100 TYPICAL SECTION - PAVING OPERATIONS

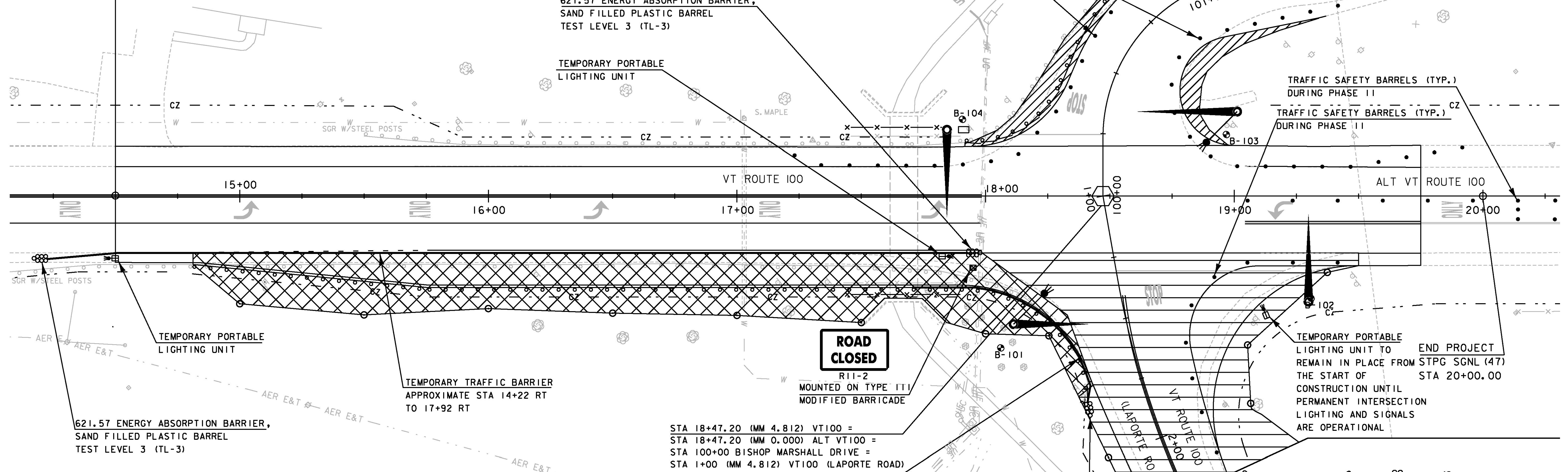

TEMPORARY PORTABLE LIGHTING UNIT

621.57 ENERGY ABSORPTION BARRIER, SAND FILLED PLASTIC BARREL TEST LEVEL 3 (TL-3)

TEMPORARY TRAFFIC BARRIER APPROXIMATE STA 14+22 RT TO 17+92 RT

**ROAD CLOSED**  
R11-2 MOUNTED ON TYPE III MODIFIED BARRICADE

STA 18+47.20 (MM 4.812) VT100 =  
STA 18+47.20 (MM 0.000) ALT VT100 =  
STA 100+00 BISHOP MARSHALL DRIVE =  
STA 1+00 (MM 4.812) VT100 (LAPORTE ROAD)

TEMPORARY PORTABLE LIGHTING UNIT TO REMAIN IN PLACE FROM STPG SGNL (47) THE START OF CONSTRUCTION UNTIL PERMANENT INTERSECTION LIGHTING AND SIGNALS ARE OPERATIONAL

END PROJECT STA 20+00.00

**LEGEND**

- ☒ PHASE I WORK LIMITS
- ▨ PHASE II WORK LIMITS
- ▩ PHASE III WORK LIMITS
- ☛ TEMPORARY PORTABLE LIGHTING UNIT
- TEMPORARY TRAFFIC BARRIER
- ⊞ ENERGY ABSORPTION BARRIER
- TRAFFIC SAFETY BARREL

TEMPORARY TRAFFIC BARRIER APPROXIMATE STA 17+70 RT TO STA 18+41 RT (SETUP, RELOCATING, AND REMOVAL OF THIS BARRIER WILL BE CONSIDERED INCIDENTAL TO ITEM 621.90, TEMPORARY TRAFFIC BARRIER AND WILL NOT BE CONSIDERED FOR PAYMENT UNDER OTHER ITEMS)

621.57 ENERGY ABSORPTION BARRIER, SAND FILLED PLASTIC BARREL TEST LEVEL 3 (TL-3)

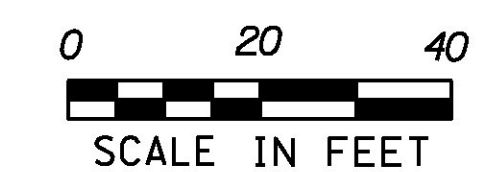

PROJECT NAME: MORRISTOWN	PLOT DATE: 5/13/2016
PROJECT NUMBER: STPG SGNL(47)	DRAWN BY: R. LUCHINI
FILE NAME: z15t047bdr_dtr.dgn	CHECKED BY: B. COLBURN
PROJECT LEADER: J. SANTACRUCE	SHEET 56 OF 58
DESIGNED BY: R. LUCHINI	
TRAFFIC CONTROL LAYOUT SHEET 1	

