

CHAIN-LINK FENCE, 4 FT (VINYL COATED)
 STA 17+42 TO STA 17+90, RT
 STA 17+42 TO STA 17+83, LT

SPECIAL PROVISION (STAMPED CONCRETE ISLAND 8')
 STA 1+38.8 TO STA 2+15.6, LT

EXCAVATION OF SURFACES AND PAVEMENTS
 STA 100+19.7 TO STA 101+26.3, LT
 STA 100+20.4 TO STA 101+45.4, RT

REMOVE AND RESET GUARD RAIL
 STA 14+81.25 TO STA 18+39.44, RT
 STA 100+21.4 TO STA 100+90.0, RT

TRANSPLANTING GROUNDCOVER
 STA 1+48, LT TO STA 2+25, LT

8 INCH UNDERDRAIN PIPE
 STA 16+89.42, 44.61 RT TO
 STA 17+00.15, 47.88 RT

TRANSPLANTING SHRUBS
 STA 17+83, RT TO STA 18+14, RT

DELINEATOR
 STA 16+23, RT

TRANSPLANTING TREES
 STA 17+24, RT

LIMIT OF WORK
 MATCH EXISTING
 STA 101+67.50

VERTICAL GRANITE CURB, MOUNTABLE								
CURB ID	TYPE	STATION	OFFSET	LOCATION	STATION	OFFSET	LOCATION	LENGTH
SPLITTER ISLAND CURBING								
G-1	VERTICAL	2+17.36	19.23	LT	1+69.54	22.39	LT	22.53
G-2	VERTICAL	1+69.54	22.39	LT	1+39.66	56.88	LT	49.83
G-3	VERTICAL	1+39.66	56.88	LT	1+50.08	96.07	LT	38.86

**END R.O.W. PROJECT
 MORRISTOWN STPG SGNL (47)
 STA. BMD 101+68, 22.14' RT**

**N/F
 SARGENT, GREGORY L.
 & MARILYN DELACRUZ**

**BEGIN R.O.W. PROJECT
 MORRISTOWN STPG SGNL (47)
 STA. BMD 100+41, 32.99' LT**

**BISHOP JOHN A.
 MARSHALL
 SCHOOL, INC.**

BEGIN PROJECT
 STPG SGNL (47)
 STA 14+50.00

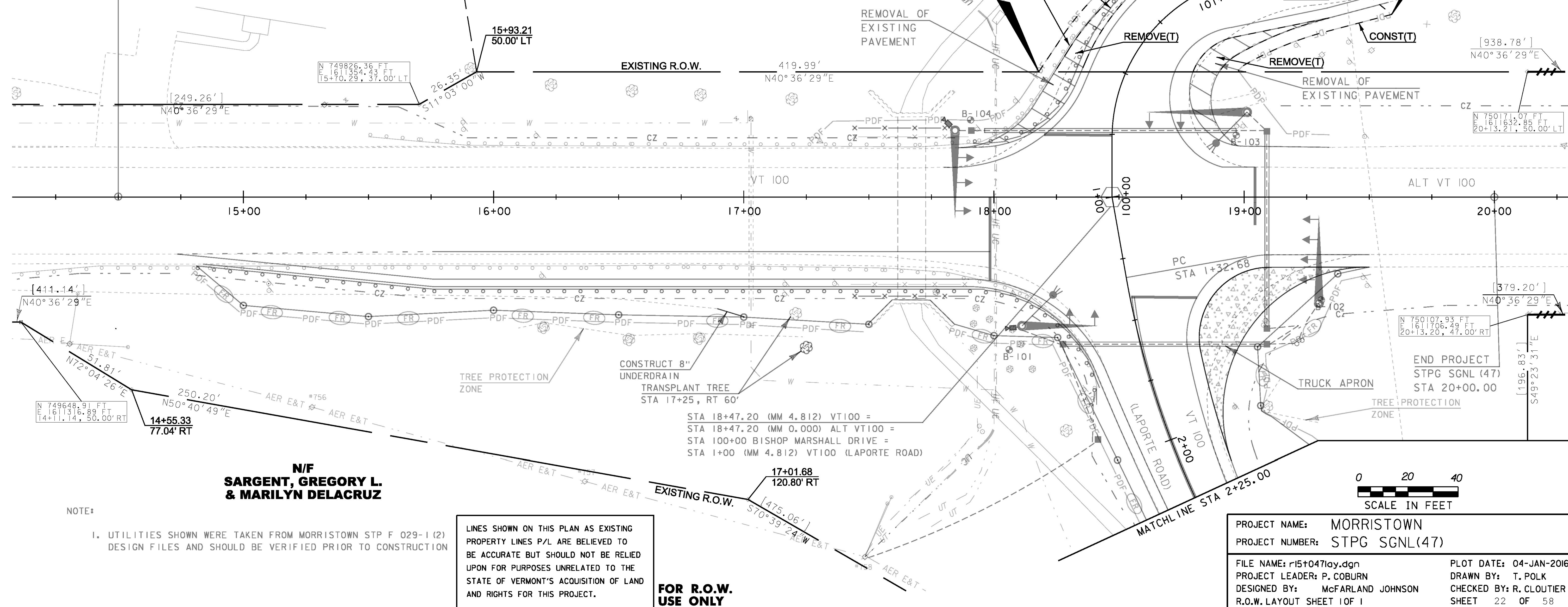

**N/F
 SARGENT, GREGORY L.
 & MARILYN DELACRUZ**

NOTE:

1. UTILITIES SHOWN WERE TAKEN FROM MORRISTOWN STP F 029-1 (2) DESIGN FILES AND SHOULD BE VERIFIED PRIOR TO CONSTRUCTION

LINES SHOWN ON THIS PLAN AS EXISTING PROPERTY LINES P/L ARE BELIEVED TO BE ACCURATE BUT SHOULD NOT BE RELIED UPON FOR PURPOSES UNRELATED TO THE STATE OF VERMONT'S ACQUISITION OF LAND AND RIGHTS FOR THIS PROJECT.

**FOR R.O.W.
 USE ONLY**



PROJECT NAME:	MORRISTOWN	PLOT DATE:	04-JAN-2016
PROJECT NUMBER:	STPG SGNL(47)	DRAWN BY:	T. POLK
FILE NAME:	r15+047lay.dgn	CHECKED BY:	R. CLOUTIER
PROJECT LEADER:	P. COBURN	SHEET	22 OF 58
DESIGNED BY:	McFARLAND JOHNSON		
R.O.W. LAYOUT SHEET 1 OF 1			