

SEED
AS NEEDED
FERTILIZER
AS NEEDED

AGRICULTURAL LIMESTONE
AS NEEDED

TOPSOIL
AS NEEDED

TEMPORARY EROSION MATTING
AS NEEDED

24 INCH STOP BAR, WATERBORNE PAINT

STA. 265+24.97, RT (22.5 LF)
STA. 265+56.75, LT (25.5 LF)
STA. 266+18.31, LT (23.5 LF)

CROSSWALK MARKING, WATERBORNE PAINT
STA. 265+35.83, RT - STA. 265+34.51, LT (61.5 LF)
STA. 265+39.44, LT - STA. 264+04.39, LT (68.0 LF)

TRAFFIC SIGNS, TYPE A

STA. 265+93.66, RT (MA-13A)(LEFT TURN YIELD ON FLASHING)

TRAFFIC CONTROL SIGNAL SYSTEM, INTERSECTION(VT ROUTE 15 & PRICE CHOPPER)
STA. 265+73.00

CONSTRUCT MAST ARM POLES

STA. 265+25.00, LT (MAP-13)
STA. 265+93.27, RT (MAP-14)

CONSTRUCT CONTROLLER CABINET (GROUND MOUNTED)

STA. 265+18.21, LT

CONSTRUCT PEDESTRIAN PEDESTAL POLE

STA. 265+27.18, LT (PP-21)
STA. 265+37.13, RT (PP-22)
STA. 266+09.48, LT (PP-23)

CONSTRUCT PEDESTRIAN SIGNAL HEADS

STA. 265+27.18, LT
STA. 265+27.18, LT
STA. 265+37.13, RT
STA. 266+09.48, LT

CONSTRUCT POWER STANCHION

STA. 264+60.34, LT

CONSTRUCT LED BLANK OUT SIGN

STA. 265+37.13, RT (PP-22)
STA. 265+25.00, LT (MA-13A)

WIRED CONDUIT (2")(SCH 80)
SEE CONDUIT SCHEDULE, TRAFFIC SIGNAL LAYOUT SHEET 13B

ELECTRICAL CONDUIT (2")(SCH 80)
SEE CONDUIT SCHEDULE, TRAFFIC SIGNAL LAYOUT SHEET 13B

TEMPORARY TRAFFIC SIGNAL
STA. 265+70.00

BRACKET ARM
STA. 265+93.27, RT (15')(SL-7)

LUMINAIRE
STA. 265+93.27, RT (SL-7)

STREET LIGHT CONTROL DEVICE
STA. 264+60.34, LT

REMOVAL OF EXISTING TRAFFIC CONTROL SIGNAL SYSTEM (VT ROUTE 15 & PRICE CHOPPER)
SEE NOTES 2 & 3, THIS SHEET

REMOVE EXISTING STRAIN POLES

STA. 265+30.37, LT
STA. 266+02.29, RT

REMOVE EXISTING SPAN WIRE

STA. 265+30.37, LT - STA. 266+02.29, RT

REMOVE AND SALVAGE SIGNAL CABINET & EQUIPMENT

STA. 265+30.37, LT

SPECIAL PROVISION (HORIZONTAL DIRECTIONAL DRILLING)(12" CASING PIPE)

STA. 265+13.60, LT - STA. 265+41.81, RT (54') (74 LF)

* STA. 265+41.81, RT - STA. 265+82.91, RT (29') (40 LF)

STA. 265+30.64, LT - STA. 266+10.91, LT (63') (74 LF)

SPECIAL PROVISION (JUNCTION BOX, HEAVY DUTY)

STA. 265+13.60, LT (JB-30)

STA. 265+41.81, RT (JB-31)

STA. 265+82.91, RT (JB-32)

STA. 265+30.64, LT (JB-33)

STA. 266+10.91, LT (JB-34)

SPECIAL PROVISION (LUMINAIRE, LED RETROFIT)

STA. 264+59.60, LT

PROPOSED SIGNAL FACE ARRANGEMENTS

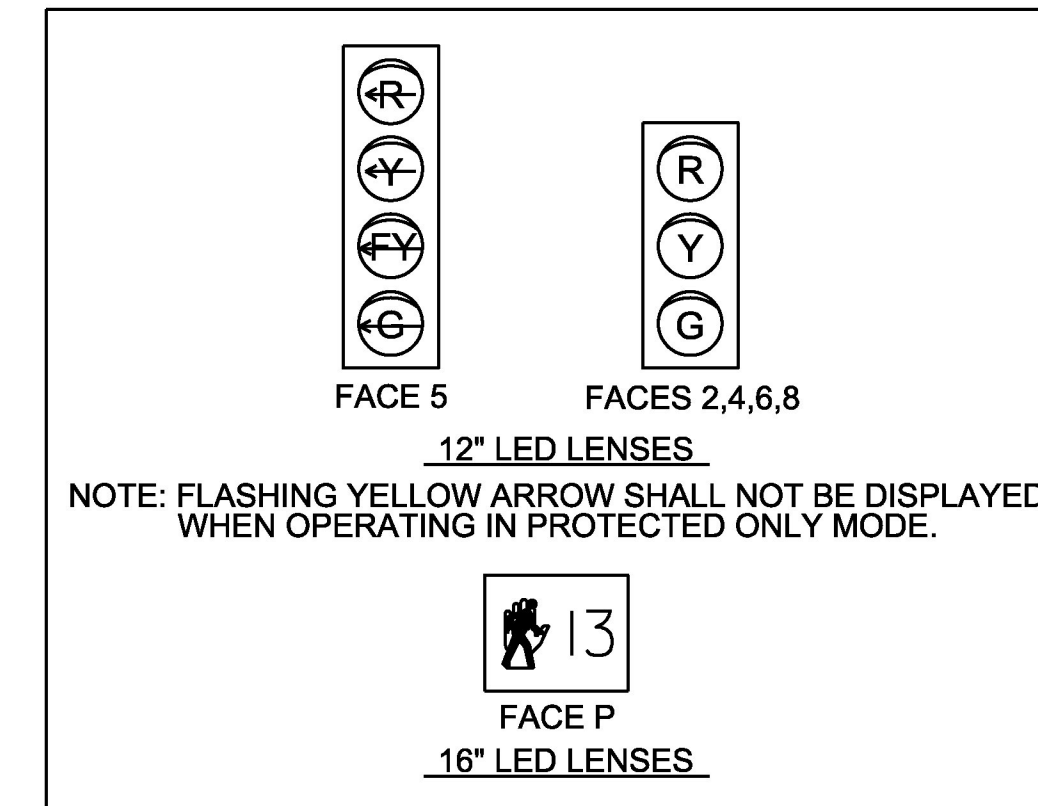

PHASING DIAGRAM

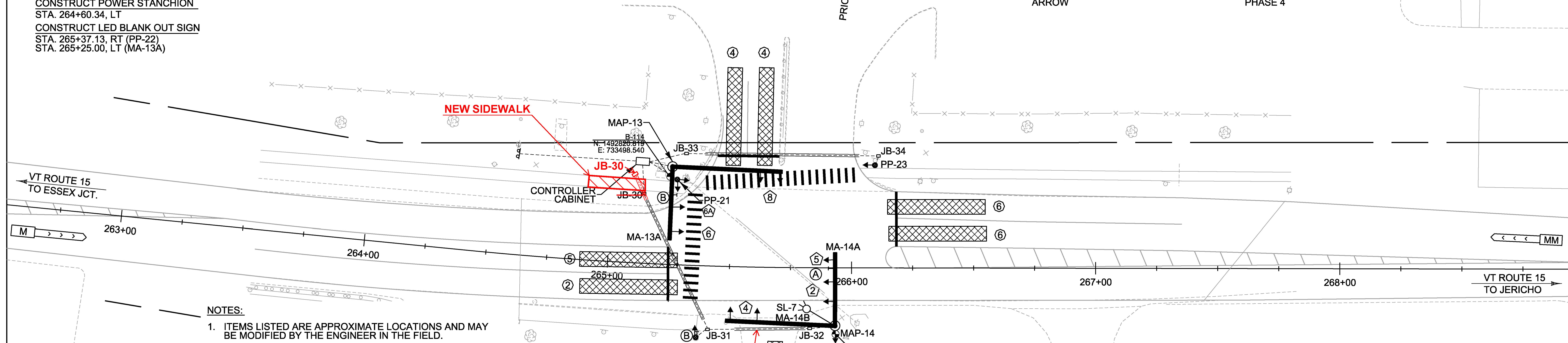
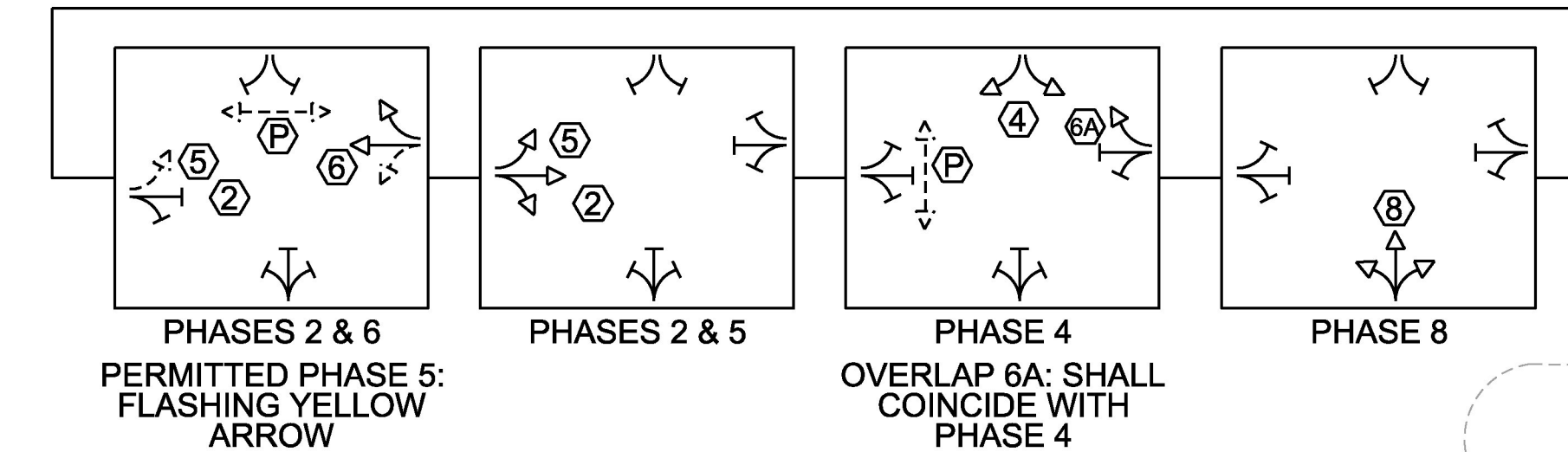

NOTES:

- ITEMS LISTED ARE APPROXIMATE LOCATIONS AND MAY BE MODIFIED BY THE ENGINEER IN THE FIELD.
- THE REMOVAL OF ALL EXISTING TRAFFIC SIGNAL EQUIPMENT THAT SHALL NOT BE REINSTALLED SHALL BE SALVAGED TO THE AGENCY OF TRANSPORTATION DISTRICT 5 SIGNAL TECHNICIAN, (802) 343-2188. WORK REQUIRED TO PERFORM THIS ACTIVITY SHALL BE PAID FOR UNDER CONTRACT ITEM 678.45 REMOVAL OF EXISTING TRAFFIC SIGNAL SYSTEM.
- REMOVAL OF EXISTING TRAFFIC SIGNAL SYSTEM SHALL NOT OCCUR UNTIL THE PROPOSED SYSTEM IS CONSTRUCTED AND OPERATIONAL. PAYMENT FOR THE REMOVAL OF THE EXISTING TRAFFIC SIGNAL SHALL BE PAID FOR UNDER CONTRACT ITEM 678.45 REMOVAL OF EXISTING TRAFFIC CONTROL SIGNAL SYSTEM.
- FOR A LIST OF MAJOR EQUIPMENT, CONDUIT SCHEDULE, AND CONTROLLER DATA, SEE TRAFFIC SIGNAL LAYOUT SHEET 13B.
- A TEMPORARY TRAFFIC SIGNAL MAY BE REQUIRED AT THIS LOCATION. THE CONTRACTOR SHALL BE RESPONSIBLE FOR THE DESIGN OF THE SPAN WIRE FOR LOADING AND THE PLACEMENT OF THE SIGNAL WITHIN THE EXISTING RIGHT OF WAY. THIS SIGNAL SHALL BE PAID FOR UNDER CONTRACT ITEM 678.40 - TEMPORARY TRAFFIC SIGNAL SYSTEM.
- EXISTING FOUNDATIONS SHALL HAVE THE TOP TWO FEET REMOVED AND FILLED IN. CONDUIT SHALL BE ABANDONED IN PLACE AND CAPPED. PAYMENT SHALL BE INCIDENTAL TO PAY ITEM 678.45 REMOVAL OF EXISTING TRAFFIC CONTROL SIGNAL SYSTEM OR PAY ITEM 679.24 REMOVE STREET LIGHT ASSEMBLY.

* OPEN CUT
@ STA. 265+41.81 RT TO 265+82.91 RT
ITEM 625.10 (9000)

SEE MAST ARM SECTION SHEET FOR TRAFFIC SIGNAL CLEARANCES.

TRAFFIC SIGNAL LEGEND	
□ JB	JUNCTION BOX
□ DJB	DOUBLE JUNCTION BOX
● PP	PEDESTRIAN PEDESTAL POST
→ ②	SIGNAL HEAD WITH PHASE NO.
→ ②	PEDESTRIAN SIGNAL HEAD WITH PED PHASE
---	WIRED CONDUIT
---	WIRED CONDUIT IN ELECTRICAL CONDUIT SLEEVE
→ A	MAST ARM-MOUNTED SIGN
⊗	STOP BAR DETECTION AREA
⊗	ADVANCE DETECTION AREA

SIGN DETAIL

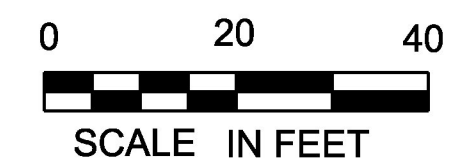
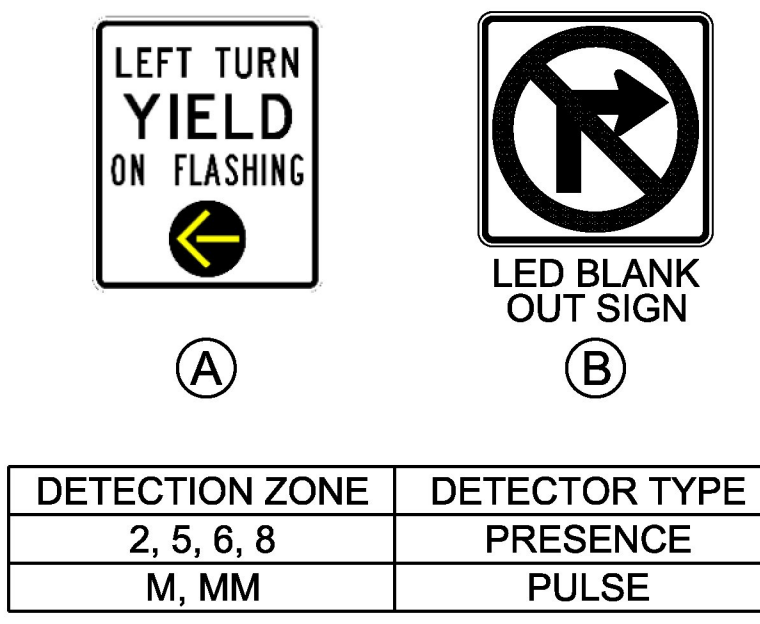

MS 557: VT ROUTE 15 & PRICE CHOPPER

PROJECT NAME:	WILLISTON-ESSEX	PLOT DATE:	3/21/2017
PROJECT NUMBER:	STPG SGNL(46)	DRAWN BY:	K. RECORD
FILE NAME:	t15i017sig.dgn	CHECKED BY:	M. LACROIX
DESIGNED BY:	K. RECORD	TRAFFIC SIGNAL LAYOUT SHEET 13A	SHEET 43 OF 66