

STONE FILL TYPE 11
 STA. 1+00 - STA. 1+15 RT
 STA. 1+00 - STA. 1+15 LT
 STA. 1+75 - STA. 1+90 RT
 STA. 1+75 - STA. 1+90 LT

CURVE (1)
 DELTA = 50° 47' 39"
 91.49D = 114° 35' 30"
 540460.87R = 50.00'
 1481029.77T = 23.74'
 L = 44.33'
 E = 5.35'
 0

CURVE (2)
 DELTA = 42° 18' 35"
 186.34D = 229° 10' 59"
 540439.99R = 25.00'
 1481125.53T = 9.67'
 L = 18.46'
 E = 1.81'
 0

CURVE (6)
 DELTA = 15° 24' 37"
 D = 3° 16' 27"
 R = 1750.00'
 T = 236.77'
 L = 470.68'
 E = 15.94'

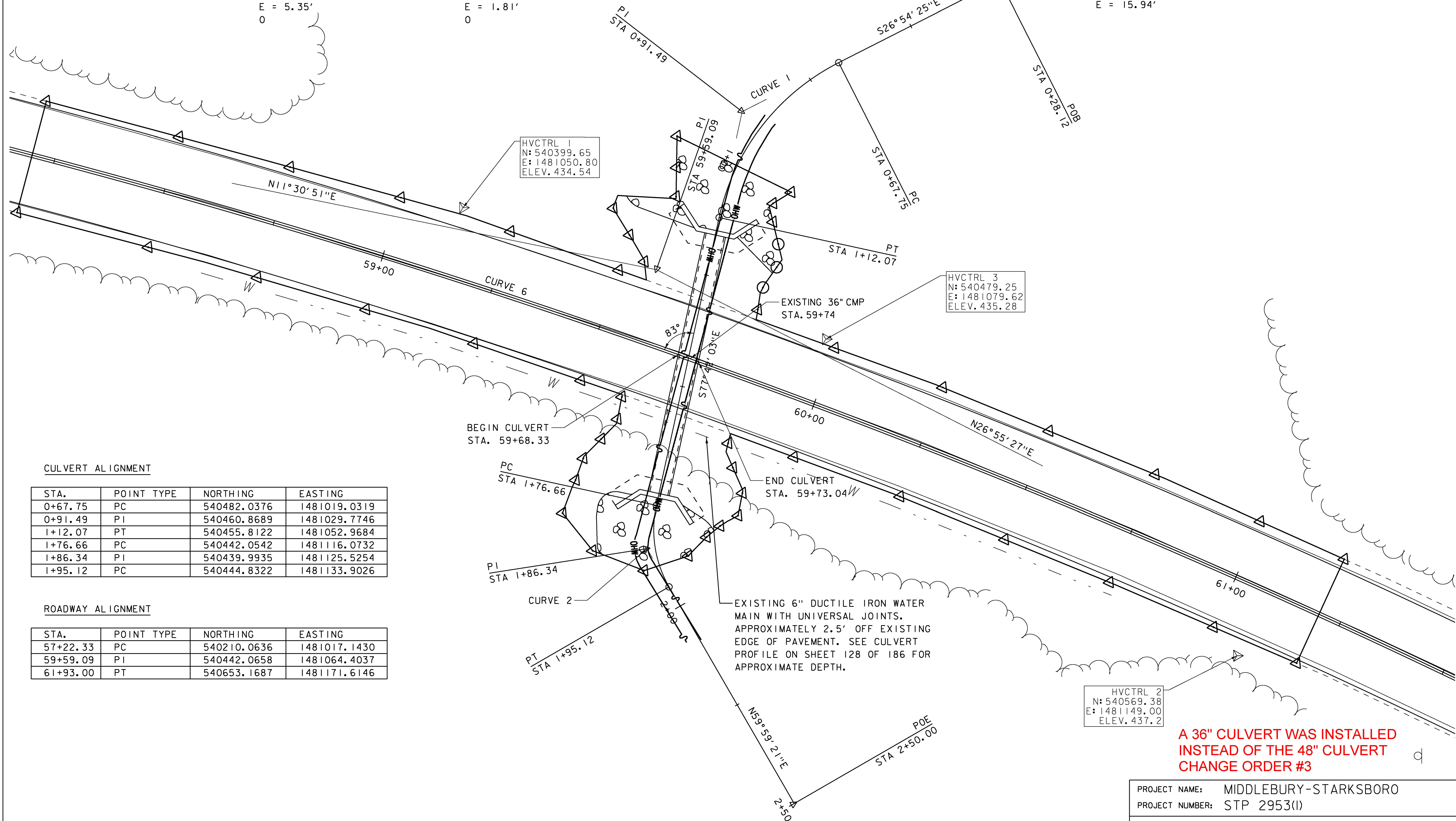
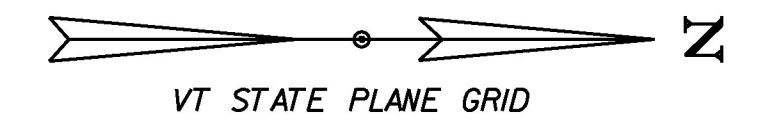

CULVERT ALIGNMENT

STA.	POINT TYPE	NORTHING	EASTING
0+67.75	PC	540482.0376	1481019.0319
0+91.49	PI	540460.8689	1481029.7746
1+12.07	PT	540455.8122	1481052.9684
1+76.66	PC	540442.0542	1481116.0732
1+86.34	PI	540439.9935	1481125.5254
1+95.12	PC	540444.8322	1481133.9026

ROADWAY ALIGNMENT

STA.	POINT TYPE	NORTHING	EASTING
57+22.33	PC	540210.0636	1481017.1430
59+59.09	PI	540442.0658	1481064.4037
61+93.00	PT	540653.1687	1481171.6146

EXISTING 6" DUCTILE IRON WATER MAIN WITH UNIVERSAL JOINTS. APPROXIMATELY 2.5' OFF EXISTING EDGE OF PAVEMENT. SEE CULVERT PROFILE ON SHEET 128 OF 186 FOR APPROXIMATE DEPTH.

HVCTRL 2
 N: 540569.38
 E: 1481149.00
 ELEV. 437.2

A 36" CULVERT WAS INSTALLED INSTEAD OF THE 48" CULVERT CHANGE ORDER #3

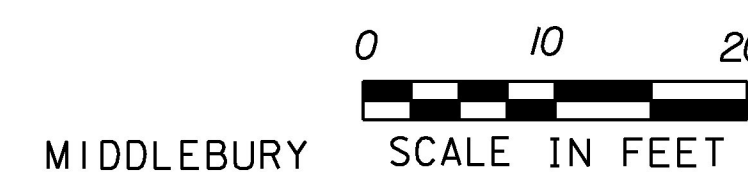

PROJECT NAME: MIDDLEBURY-STARKSBORO	PLOT DATE: 5/4/2017
PROJECT NUMBER: STP 2953(1)	DRAWN BY: S.SOLLA
FILE NAME: z14V227mml13lbr.dgn	CHECKED BY: C.LATHROP
PROJECT LEADER: C.LATHROP	SHEET 127 OF 186
DESIGNED BY: S.SOLLA	
CULVERT PLAN SHEET	