

**SPECIAL PROVISION(DURABLE 6 INCH WHITE LINE, POLYUREA)(28 MILS)**

RUTLAND TOWN (NORTHBOUND):  
 MM 0.144 - MM 0.336 DASHED CL  
 MM 0.144 - MM 0.336 SOLID RT  
 MM 0.250 - MM 0.275 DOTTED LANE LINE LT  
 MM 0.275 - MM 0.336 SOLID LANE LINE LT  
 MM 0.275 - MM 0.311 DOTTED LANE LINE RT  
 MM 0.311 - MM 0.311 SOLID LANE LINE RT

RUTLAND TOWN (SOUTHBOUND):  
 MM 0.144 - MM 0.336 DASHED CL  
 MM 0.144 - MM 0.175 SOLID LANE LINE RT  
 MM 0.144 - MM 0.320 SOLID LT  
 MM 0.175 - MM 0.214 DOTTED LANE LINE RT  
 MM 0.189 - MM 0.290 DOTTED LANE LINE LT  
 MM 0.320 - MM 0.336 SOLID LT

**TEMPORARY 6 INCH WHITE LINE, PAINT**

RUTLAND TOWN (NORTHBOUND):  
 MM 0.144 - MM 0.336 DASHED CL  
 MM 0.144 - MM 0.336 SOLID RT  
 MM 0.250 - MM 0.275 DOTTED LANE LINE LT  
 MM 0.275 - MM 0.336 SOLID LANE LINE LT  
 MM 0.275 - MM 0.311 DOTTED LANE LINE RT  
 MM 0.311 - MM 0.336 SOLID LANE LINE RT

RUTLAND TOWN (SOUTHBOUND):  
 MM 0.144 - MM 0.336 DASHED CL  
 MM 0.144 - MM 0.175 SOLID LANE LINE RT  
 MM 0.144 - MM 0.320 SOLID LT  
 MM 0.175 - MM 0.214 DOTTED LANE LINE RT  
 MM 0.189 - MM 0.290 DOTTED LANE LINE LT  
 MM 0.320 - MM 0.336 SOLID LT

**SPECIAL PROVISION(DURABLE 6 INCH YELLOW LINE, POLYUREA)(28 MILS)**

RUTLAND TOWN (NORTHBOUND):  
 MM 0.144 - MM 0.336 SOLID LT

RUTLAND TOWN (SOUTHBOUND):  
 MM 0.144 - MM 0.336 SOLID RT

**TEMPORARY 6 INCH YELLOW LINE, PAINT**

RUTLAND TOWN (NORTHBOUND):  
 MM 0.144 - MM 0.336 SOLID LT

RUTLAND TOWN (SOUTHBOUND):  
 MM 0.144 - MM 0.336 SOLID RT

**SPECIAL PROVISION(DURABLE LETTER OR SYMBOL, POLYUREA)(28 MILS)**

RUTLAND TOWN (NORTHBOUND):  
 MM 0.268 LT, ARROW (1 EA)  
 MM 0.282 LT, "O,N,L,Y" (4 EA)  
 MM 0.296 LT, ARROW (1 EA)  
 MM 0.309 RT, ARROW (1 EA)  
 MM 0.310 LT, "O,N,L,Y" (4 EA)  
 MM 0.324 LT, ARROW (1 EA)  
 MM 0.338 RT, "O,N,L,Y" (4 EA)

RUTLAND TOWN (SOUTHBOUND):  
 MM 0.144 RT, ARROW (1 EA)  
 MM 0.155 RT, "O,N,L,Y" (4 EA)  
 MM 0.166 RT, ARROW (1 EA)

**SPECIAL PROVISION(DURABLE 12 INCH WHITE LINE, POLYUREA)(28 MILS)**

RUTLAND TOWN (SOUTHBOUND):  
 MM 0.144 - MM 0.168 GORE AREA LT  
 MM 0.290 - MM 0.320 GORE AREA LT

**TEMPORARY LETTER OR SYMBOL, PAINT**

RUTLAND TOWN (NORTHBOUND):  
 MM 0.268 LT, ARROW (1 EA)  
 MM 0.282 LT, "O,N,L,Y" (4 EA)  
 MM 0.296 LT, ARROW (1 EA)  
 MM 0.309 RT, ARROW (1 EA)  
 MM 0.310 LT, "O,N,L,Y" (4 EA)  
 MM 0.324 LT, ARROW (1 EA)  
 MM 0.338 RT, "O,N,L,Y" (4 EA)

RUTLAND TOWN (SOUTHBOUND):  
 MM 0.144 RT, ARROW (1 EA)  
 MM 0.155 RT, "O,N,L,Y" (4 EA)  
 MM 0.166 RT, ARROW (1 EA)

**TEMPORARY 12 INCH WHITE LINE, PAINT**

RUTLAND TOWN (SOUTHBOUND):  
 MM 0.144 - MM 0.168 GORE AREA LT  
 MM 0.290 - MM 0.320 GORE AREA LT

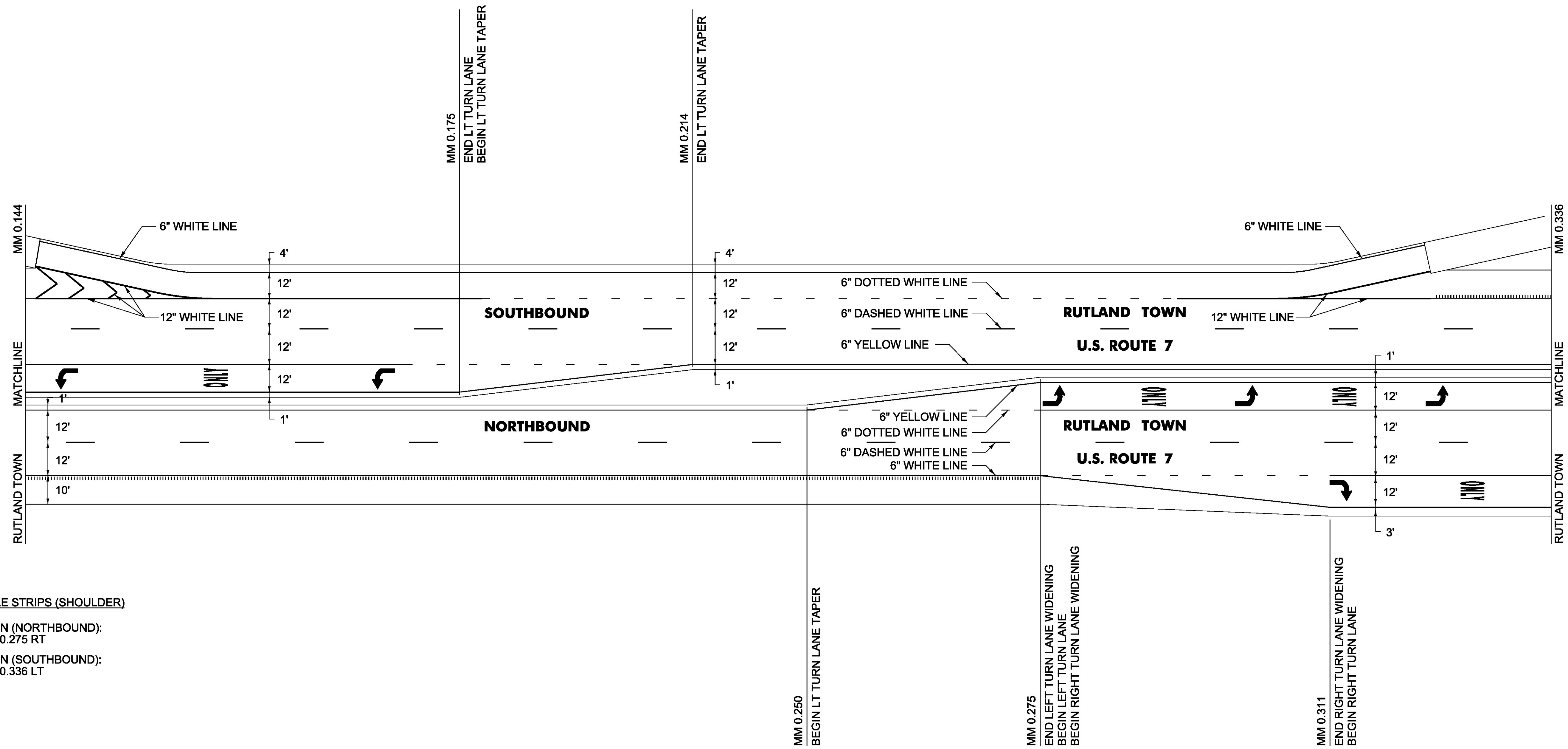

**MILLED RUMBLE STRIPS (SHOULDER)**

RUTLAND TOWN (NORTHBOUND):  
 MM 0.144 - MM 0.275 RT

RUTLAND TOWN (SOUTHBOUND):  
 MM 0.320 - MM 0.336 LT

PROJECT NAME:	MANCHESTER-RUTLAND TOWN
PROJECT NUMBER:	NH SURF(50)
FILE NAME:	layout64.dgn
PROJECT LEADER:	M. FOWLER
DESIGNED BY:	B. KIPP
PLAN SHEET	64
PLOT DATE:	1/14/2016
DRAWN BY:	B. KIPP
CHECKED BY:	M. FOWLER
SHEET	78 OF 105