

**SPECIAL PROVISION(DURABLE 6 INCH WHITE LINE, POLYUREA)(28 MILS)**

CLARENDON (NORTHBOUND):  
MM 4.500 - MM 4.749 SOLID RT  
MM 4.500 - MM 4.749 DASHED CL  
MM 4.655 - MM 4.706 DOTTED LANE LINE LT  
MM 4.706 - MM 4.749 SOLID LANE LINE LT  
MM 4.768 - MM 5.000 SOLID RT  
MM 4.768 - MM 5.000 DASHED CL

CLARENDON (SOUTHBOUND):  
MM 4.500 - MM 4.749 SOLID LT  
MM 4.500 - MM 4.749 DASHED CL  
MM 4.768 - MM 5.000 SOLID LT  
MM 4.768 - MM 5.000 DASHED CL  
MM 4.768 - MM 4.815 SOLID LANE RT  
MM 4.815 - MM 4.860 DOTTED LANE LINE RT

**SPECIAL PROVISION(DURABLE 6 INCH YELLOW LINE, POLYUREA)(28 MILS)**

CLARENDON (NORTHBOUND):  
MM 4.500 - MM 4.749 SOLID LT  
MM 4.768 - MM 5.000 SOLID LT

VT ROUTE 7B:  
MM 4.761 RT SOLID RT & LT

CLARENDON (SOUTHBOUND):  
MM 4.500 - MM 4.749 SOLID RT  
MM 4.768 - MM 5.000 SOLID RT

VT ROUTE 7B:  
MM 4.761 LT SOLID RT & LT

**MILLED RUMBLE STRIPS (SHOULDER)**

CLARENDON (NORTHBOUND):  
MM 4.500 - MM 4.749 RT  
MM 4.768 - MM 5.000 RT

CLARENDON (SOUTHBOUND):  
MM 4.500 - MM 4.749 LT  
MM 4.768 - MM 5.000 LT

**TEMPORARY 6 INCH WHITE LINE, PAINT**

CLARENDON (NORTHBOUND):  
MM 4.500 - MM 4.749 SOLID RT  
MM 4.500 - MM 4.749 DASHED CL  
MM 4.655 - MM 4.706 DOTTED LANE LINE LT  
MM 4.706 - MM 4.749 SOLID LANE LINE LT  
MM 4.768 - MM 5.000 SOLID RT  
MM 4.768 - MM 5.000 DASHED CL

CLARENDON (SOUTHBOUND):  
MM 4.500 - MM 4.749 SOLID LT  
MM 4.500 - MM 4.749 DASHED CL  
MM 4.768 - MM 5.000 SOLID LT  
MM 4.768 - MM 5.000 DASHED CL  
MM 4.768 - MM 4.815 SOLID LANE RT  
MM 4.815 - MM 4.860 DOTTED LANE LINE RT

**TEMPORARY 6 INCH YELLOW LINE, PAINT**

CLARENDON (NORTHBOUND):  
MM 4.500 - MM 4.749 SOLID LT  
MM 4.768 - MM 5.000 SOLID LT

VT ROUTE 7B:  
MM 4.761 RT SOLID RT & LT

CLARENDON (SOUTHBOUND):  
MM 4.500 - MM 4.749 SOLID RT  
MM 4.768 - MM 5.000 SOLID RT

VT ROUTE 7B:  
MM 4.761 LT SOLID RT & LT

**SPECIAL PROVISION(DURABLE LETTER OR SYMBOL, POLYUREA)(28 MILS)**

CLARENDON (NORTHBOUND):  
MM 4.706 LT, ARROW (1 EA)  
MM 4.715 LT, "O,N,L,Y" (4 EA)  
MM 4.724 LT, ARROW (1 EA)  
MM 4.733 LT, "O,N,L,Y" (4 EA)  
MM 4.742 LT, ARROW (1 EA)

VT ROUTE 7B:  
MM 4.761 RT, "S,T,O,P" (4 EA)

CLARENDON (SOUTHBOUND):  
MM 4.769 RT, ARROW (1 EA)  
MM 4.784 RT, "O,N,L,Y" (4 EA)  
MM 4.799 RT, ARROW (1 EA)

VT ROUTE 7B:  
MM 4.759 LT, "S,T,O,P" (4 EA)

**TEMPORARY LETTER OR SYMBOL, PAINT**

CLARENDON (NORTHBOUND):  
MM 4.706 LT, ARROW (1 EA)  
MM 4.715 LT, "O,N,L,Y" (4 EA)  
MM 4.724 LT, ARROW (1 EA)  
MM 4.733 LT, "O,N,L,Y" (4 EA)  
MM 4.742 LT, ARROW (1 EA)

VT ROUTE 7B:  
MM 4.761 RT, "S,T,O,P" (4 EA)

CLARENDON (SOUTHBOUND):  
MM 4.769 RT, ARROW (1 EA)  
MM 4.784 RT, "O,N,L,Y" (4 EA)  
MM 4.799 RT, ARROW (1 EA)

VT ROUTE 7B:  
MM 4.759 LT, "S,T,O,P" (4 EA)

**SPECIAL PROVISION(DURABLE 24 INCH STOP BAR, POLYUREA)(28 MILS)**

CLARENDON (NORTHBOUND):  
MM 4.761 RT, VT ROUTE 7B

CLARENDON (SOUTHBOUND):  
MM 4.759 LT, VT ROUTE 7B

**TEMPORARY 24 INCH STOP BAR, PAINT**

CLARENDON (NORTHBOUND):  
MM 4.761 RT, VT ROUTE 7B

CLARENDON (SOUTHBOUND):  
MM 4.759 LT, VT ROUTE 7B

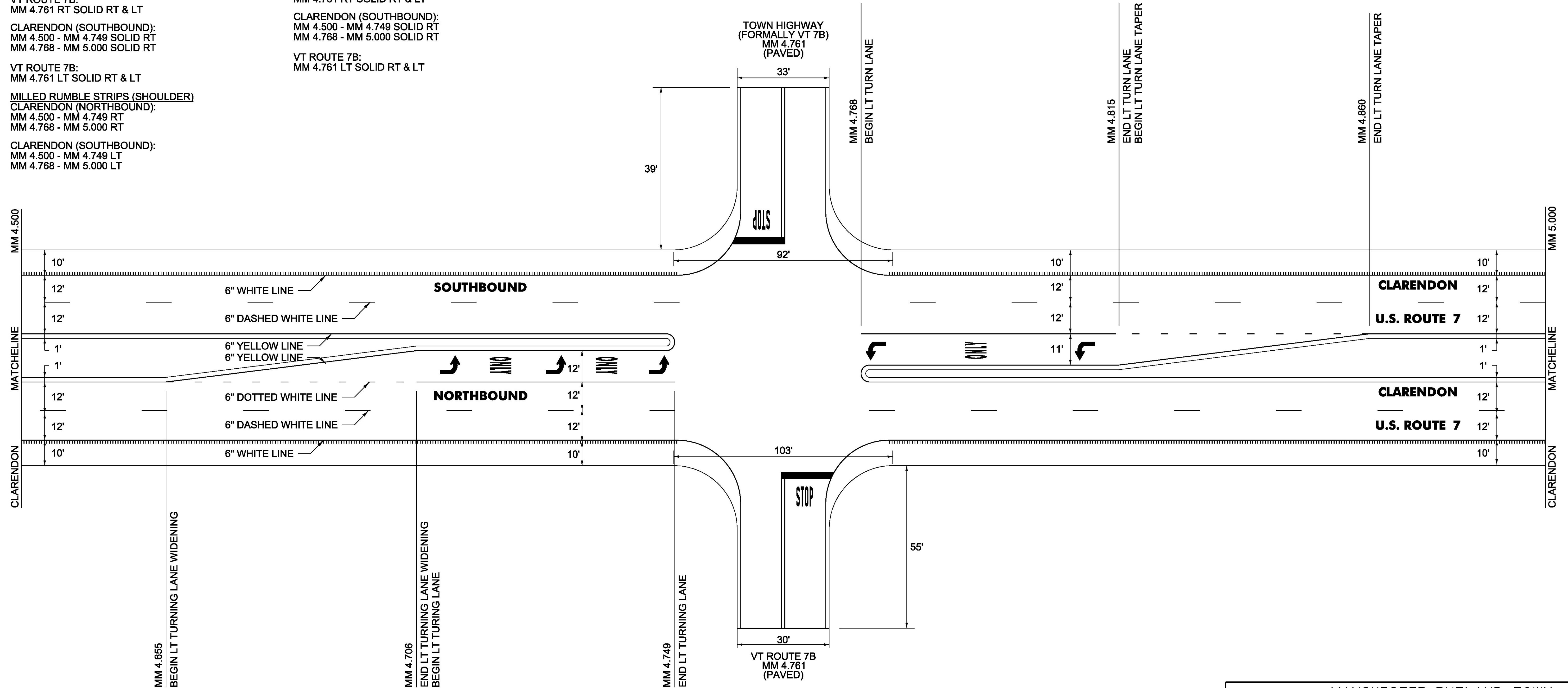

**NOT TO SCALE**

PROJECT NAME:	MANCHESTER-RUTLAND TOWN
PROJECT NUMBER:	NH SURF(50)
FILE NAME:	layout60.dgn
PROJECT LEADER:	M. FOWLER
DESIGNED BY:	B. KIPP
PLAN SHEET	60
PLOT DATE:	1/14/2016
DRAWN BY:	B. KIPP
CHECKED BY:	M. FOWLER
SHEET	74 OF 105