

SPECIAL PROVISION(DURABLE 4 INCH WHITE LINE,
POLYUREA)(28 MILS)
W 165+00 TO W 176+00 SOLID LT & RT

SPECIAL PROVISION(DURABLE 4 INCH YELLOW LINE,
POLYUREA)(28 MILS)
W 165+00 TO W 176+00 SOLID LT & RT

MILLED RUMBLE STRIPS (CENTERLINE)
W 165+00 TO W 170+13 CL
W 174+13 TO W 176+00 CL

TEMPORARY 4 INCH WHITE LINE, PAINT
W 165+00 TO W 176+00 SOLID LT & RT

TEMPORARY 4 INCH YELLOW LINE, PAINT
W 165+00 TO W 176+00 SOLID LT & RT

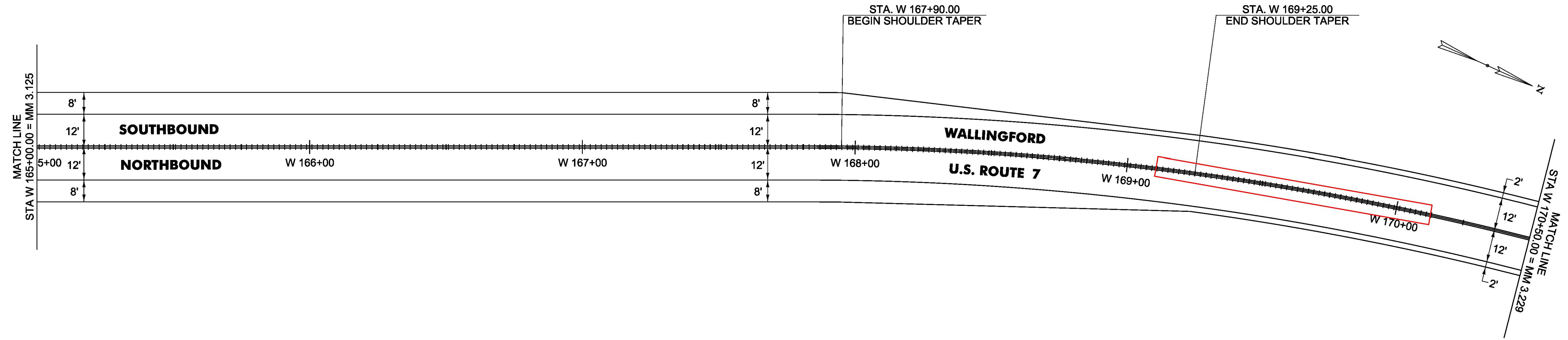

900.540 Supplemental Agreement
(Centerline Rumble Strip Removal)
Station 169+10 - 170+13 and
174+28 - 175+32: Removed due
to change in design criteria

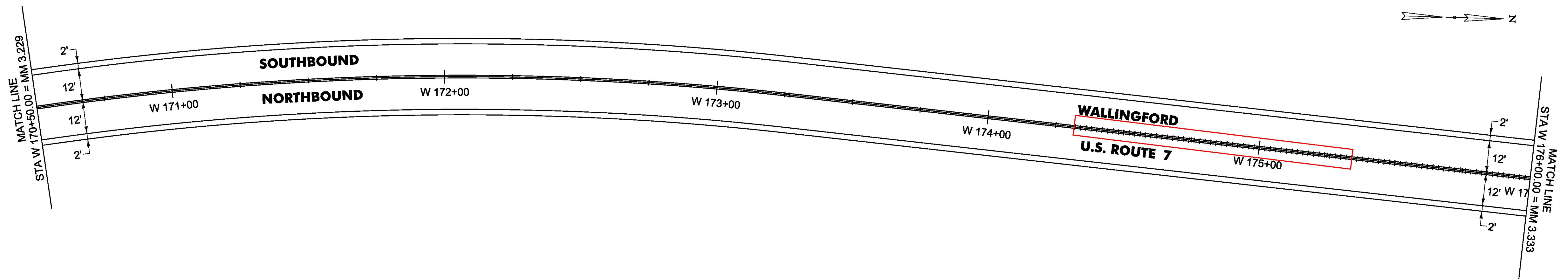

NOT TO SCALE

PROJECT NAME:	MANCHESTER-RUTLAND TOWN
PROJECT NUMBER:	NH SURF(50)
FILE NAME: layout29.dgn	PLOT DATE: 1/14/2016
PROJECT LEADER: M. FOWLER	DRAWN BY: B. KIPP
DESIGNED BY: B. KIPP	CHECKED BY: M. FOWLER
PLAN SHEET 29	SHEET 43 OF 105