

SPECIAL PROVISION(DURABLE 4 INCH WHITE LINE,
POLYUREA)(28 MILS)
W 143+00 TO W 154+00 SOLID LT & RT

TEMPORARY 4 INCH WHITE LINE, PAINT
W 143+00 TO W 154+00 SOLID LT & RT

SPECIAL PROVISION(DURABLE 4 INCH YELLOW LINE,
POLYUREA)(28 MILS)
W 143+00 TO W 147+50 SOLID LT & RT
W 147+50 TO W 153+90 SOLID LT, DASHED RT
W 153+90 TO W 154+00 DASHED CL

TEMPORARY 4 INCH YELLOW LINE, PAINT
W 143+00 TO W 147+50 SOLID LT & RT
W 147+50 TO W 153+90 SOLID LT, DASHED RT
W 153+90 TO W 154+00 DASHED CL

MILLED RUMBLE STRIPS (CENTERLINE)
W 143+00 TO W 146+60 CL
W 147+10 TO W 154+00 CL

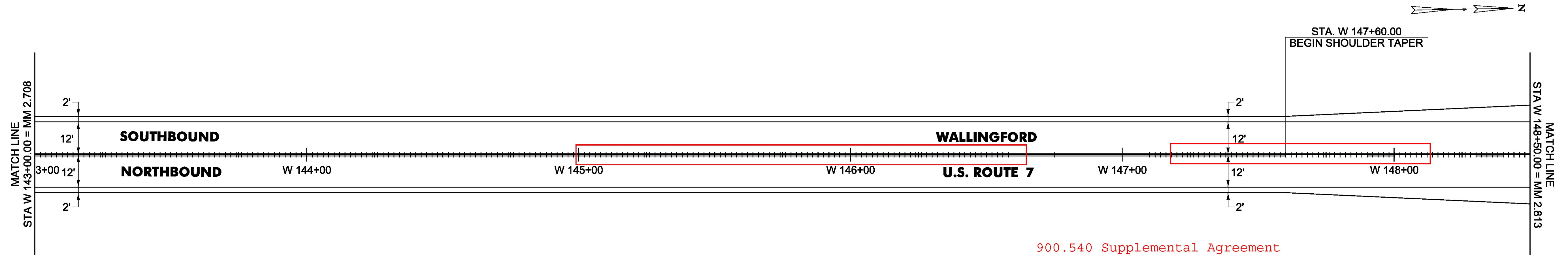

900.540 Supplemental Agreement
(Centerline Rumble Strip Removal)
Station 144+99 - 146+61 and
147+10 - 148+11: Removed due
to change in design criteria

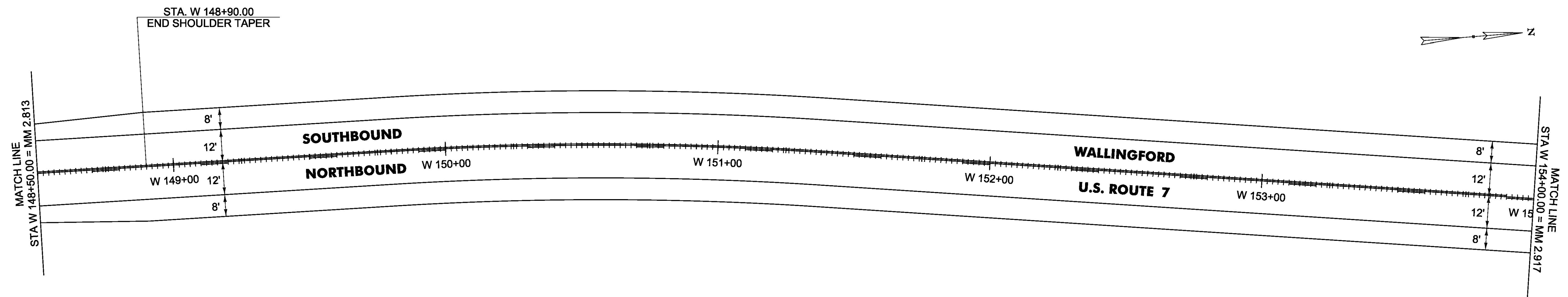

NOT TO SCALE

PROJECT NAME:	MANCHESTER-RUTLAND TOWN
PROJECT NUMBER:	NH SURF(50)
FILE NAME: layout27.dgn	PLOT DATE: 1/14/2016
PROJECT LEADER: M. FOWLER	DRAWN BY: B. KIPP
DESIGNED BY: B. KIPP	CHECKED BY: M. FOWLER
PLAN SHEET 27	SHEET 41 OF 105