

SKewed BLOCK PATTERN CROSSWALK DETAIL

NOTES:

1. THIS DETAIL IS SETUP FOR AN 11 FOOT LANE.
2. MARK LIGHT STRING LINE ON PAVEMENT ACROSS ROADWAY (CURB TO CURB).
3. ESTABLISH THE CENTERLINE OF THE ROADWAY (DOUBLE YELLOW LINE OR LANE LINE).
4. BLOCKS ARE PARALLEL TO THE CENTERLINE (DOUBLE YELLOW LINE OR LANE LINE) (OFFSET BLOCKS VERTICALLY TO ACHIEVE REQUIRED SKEW).
5. ALWAYS START MEASURING FROM THE CENTERLINE OR LANE LINE RIGHT, WITH THE FLOW OF TRAFFIC.
6. PAINTED BLOCKS SHALL BE 24 INCHES (TYPICAL).

(*). 7. THIS DISTANCE WILL INCREASE TO 1.0' FOR A 12 FOOT LANE.

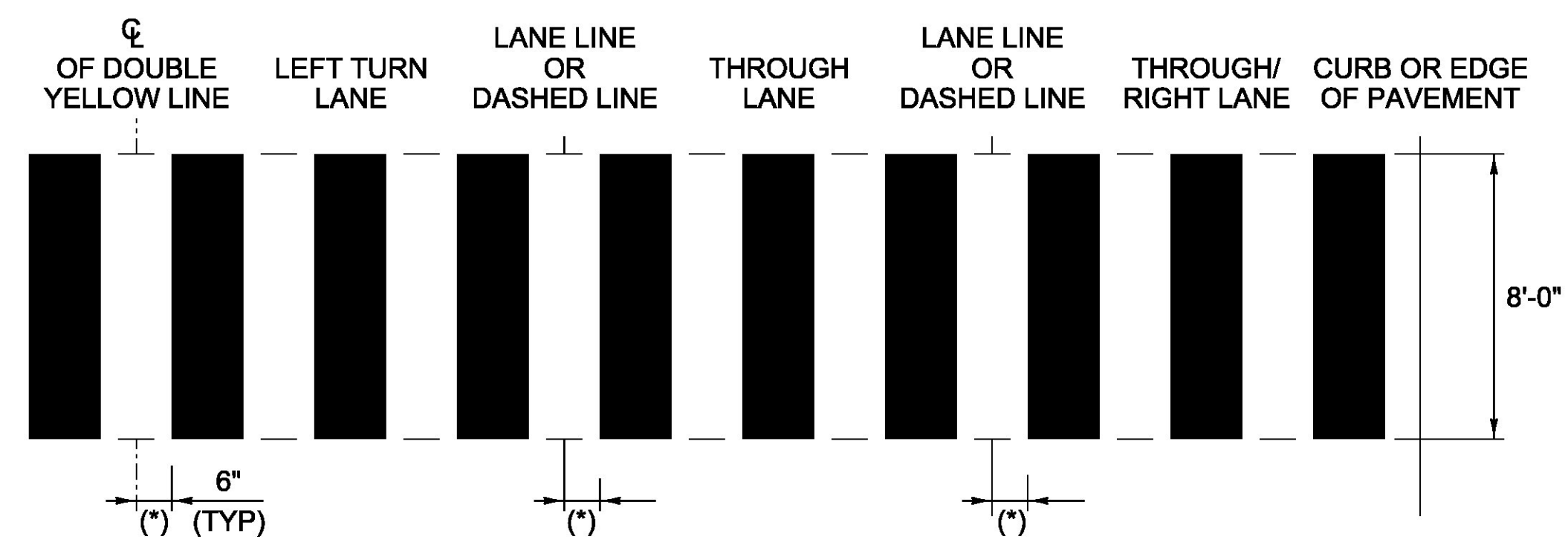

BLOCK PATTERN CROSSWALK DETAIL

NOTES:

1. THIS DETAIL IS SETUP FOR AN 11 FOOT LANE.
2. MARK LIGHT STRING LINE ON PAVEMENT ACROSS ROADWAY (CURB TO CURB).
3. ESTABLISH THE CENTERLINE OF THE ROADWAY (DOUBLE YELLOW LINE OR LANE LINE).
4. BLOCKS ARE PARALLEL TO THE CENTERLINE (DOUBLE YELLOW LINE OR LANE LINE) (OFFSET BLOCKS VERTICALLY TO ACHIEVE RQ SKEW).
5. ALWAYS START MEASURING FROM THE CENTERLINE OR LANE LINE RIGHT, WITH THE FLOW OF TRAFFIC.
6. PAINTED BLOCKS SHALL BE 24 INCHES (TYPICAL).

(*). 7. THIS DISTANCE WILL INCREASE TO 1.0' FOR A 12 FOOT LANE.

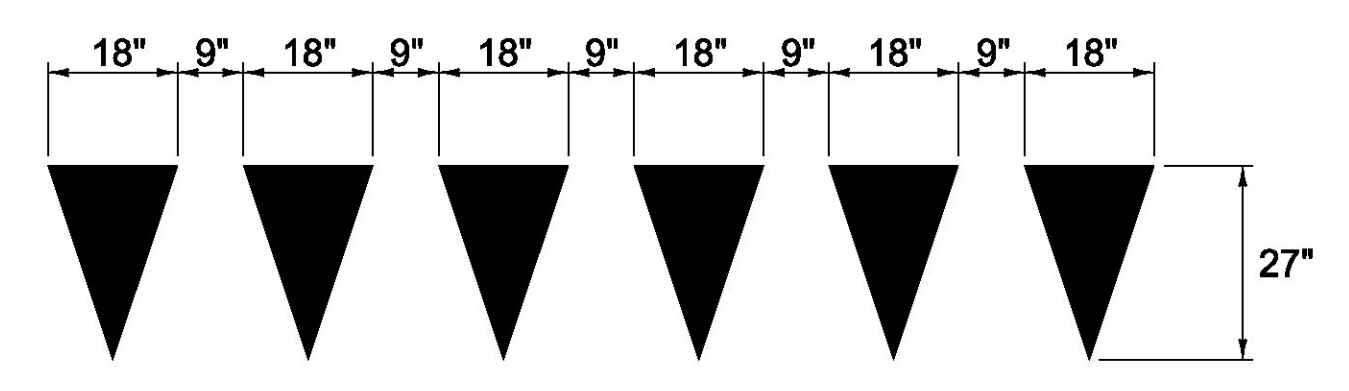

YIELD LINE DETAILS

NOTE:
1. EACH TRIANGLE WILL BE PAID FOR AS ONE EACH DURABLE LETTER OR SYMBOL.

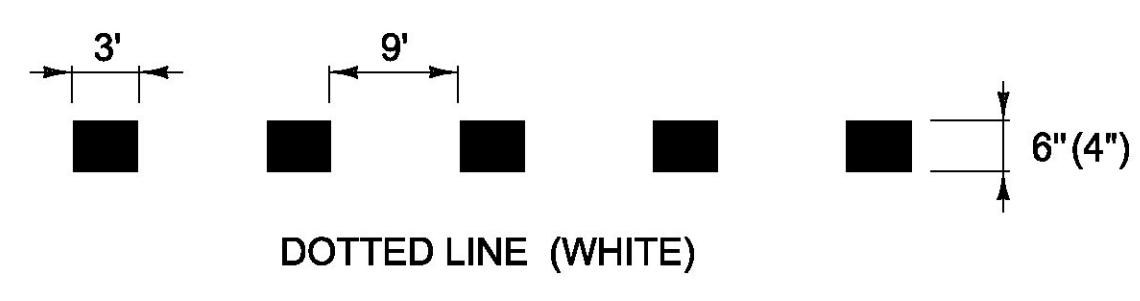

PAVEMENT MARKING LINE DETAILS

NOT TO SCALE

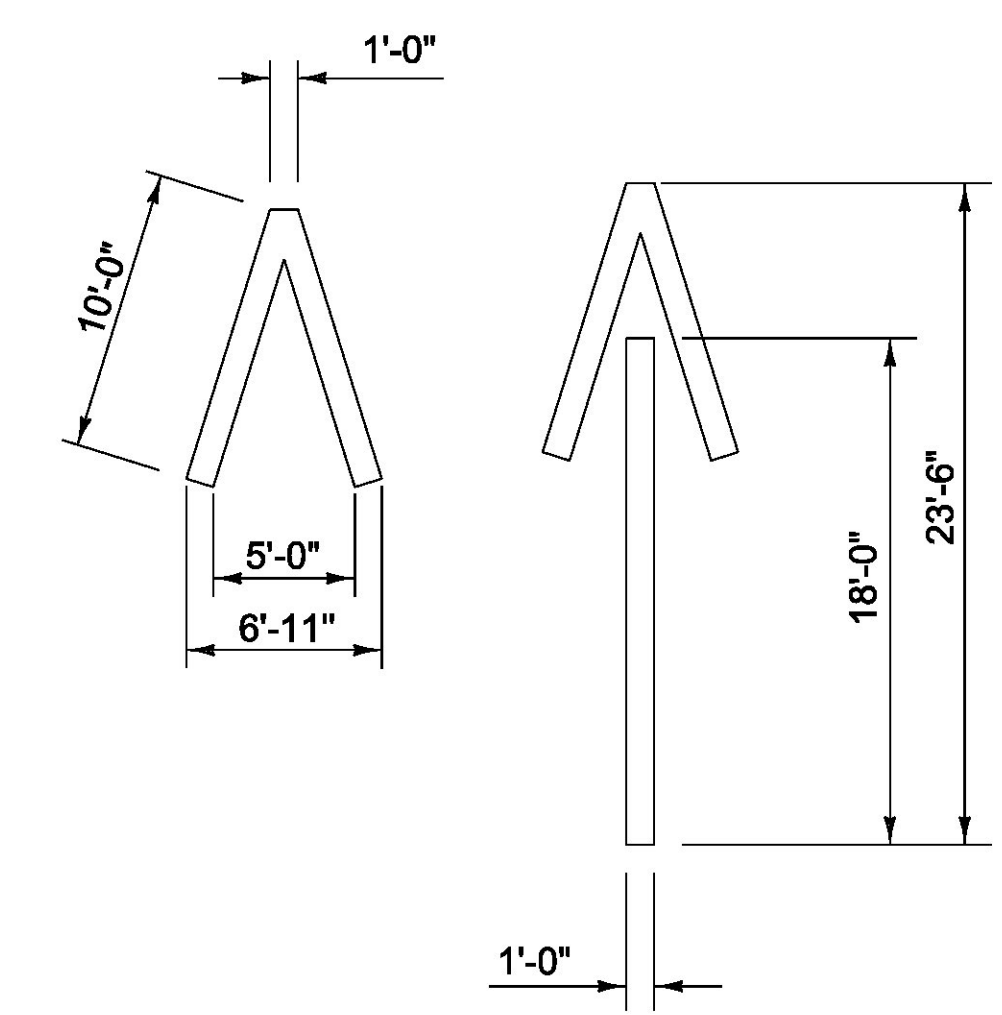

WRONG WAY ARROW

NOT TO SCALE
MARKINGS SHALL BE PLACED AT EXISTING WRONG WAY SIGN

NOT TO SCALE

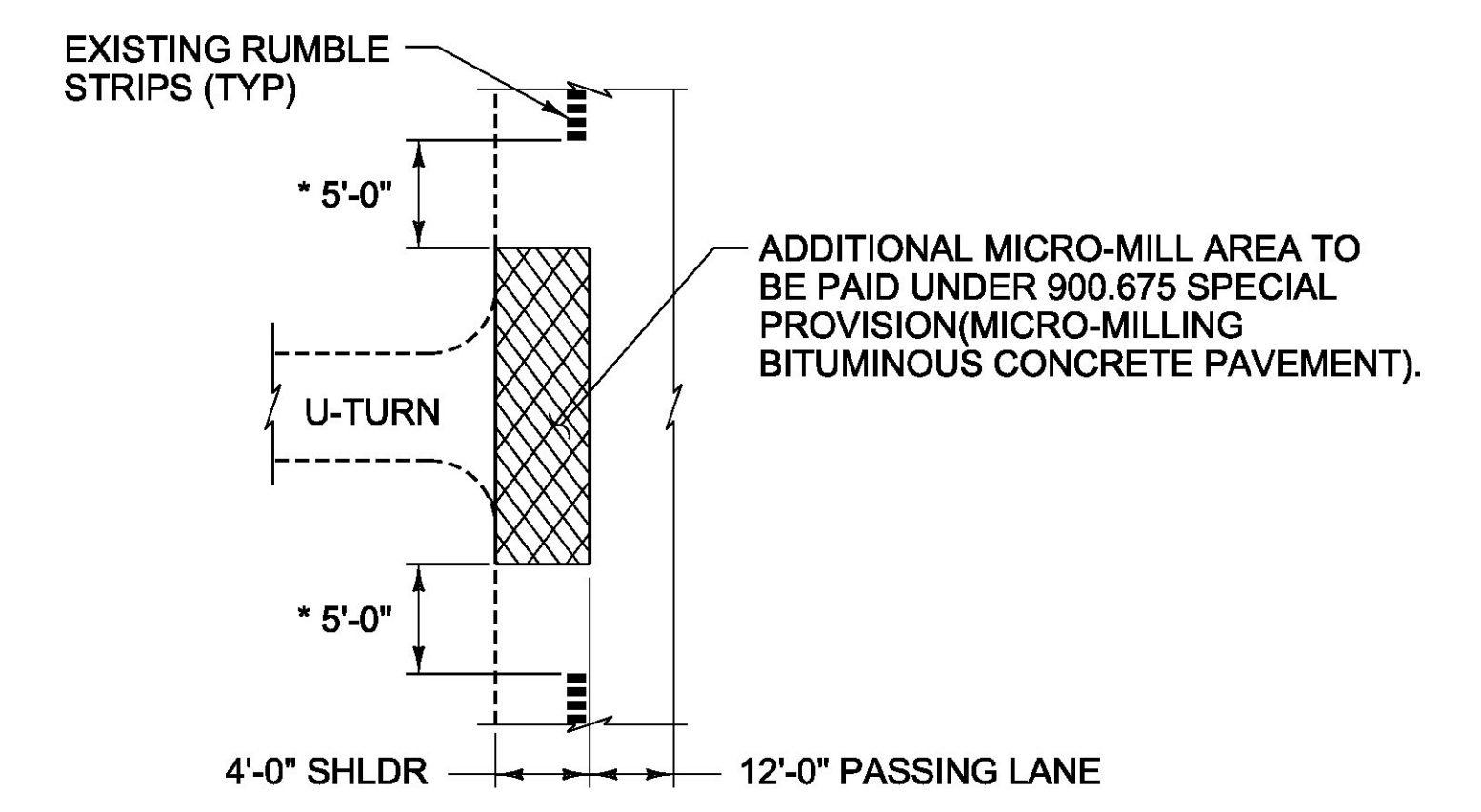

* BEGIN MICRO-MILL 5'-0" AFTER RUMBLE STRIPS END, AND END MICRO-MILL 5'-0" BEFORE RUMBLE STRIPS BEGIN

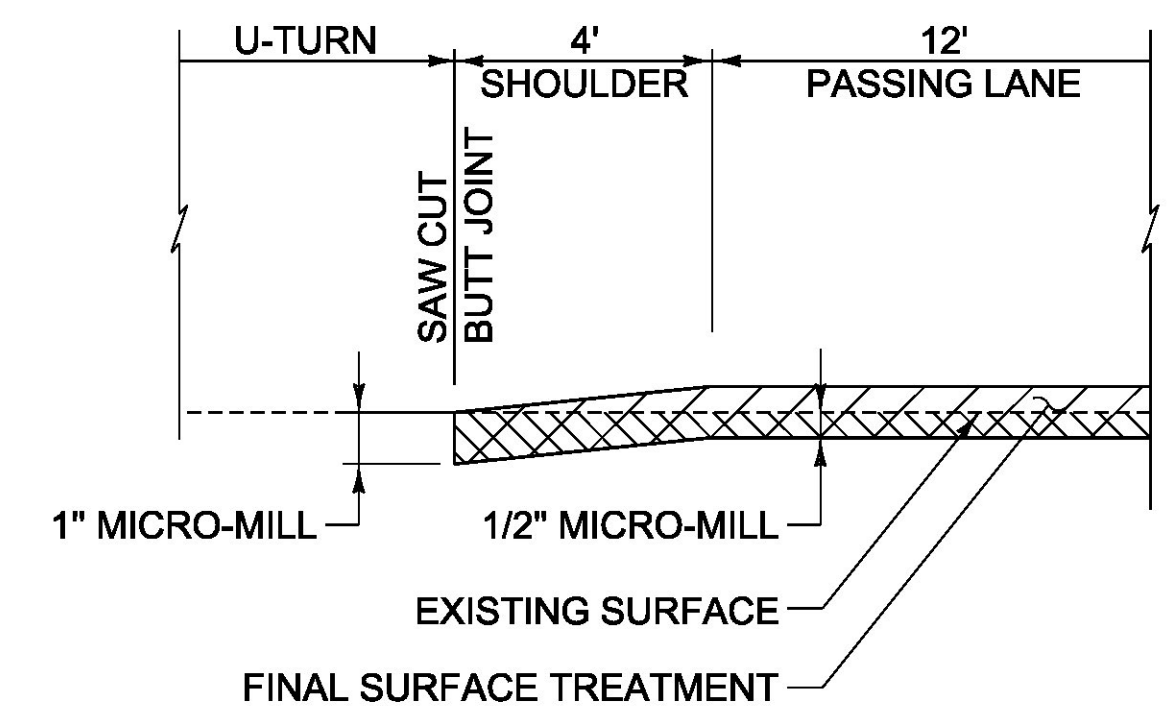

MICRO-MILL DETAIL AT U-TURNS

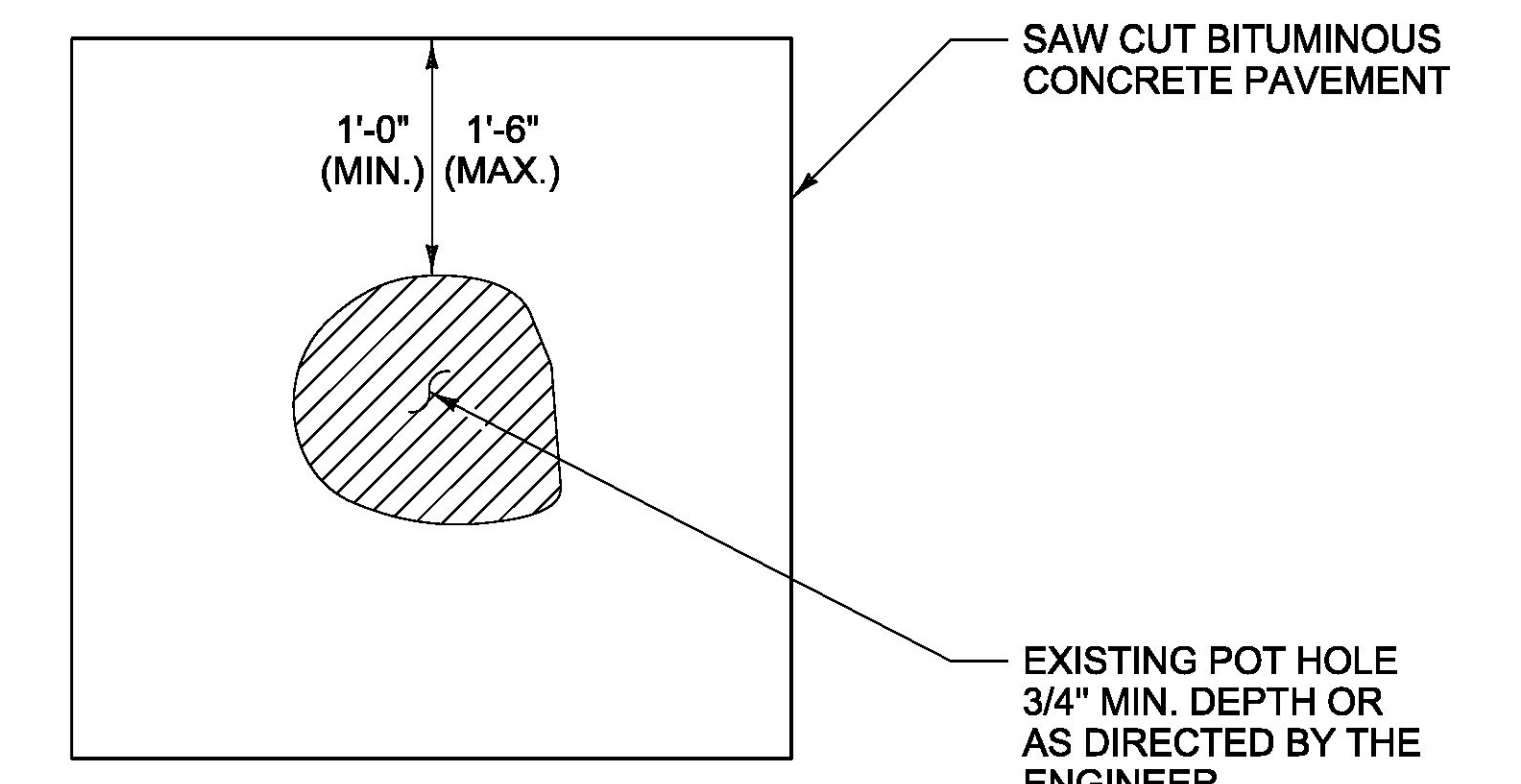

TYPICAL - POT HOLE REPAIR

NOTE:

1. EMULSIFIED ASPHALT SHALL BE APPLIED AT ALL PATCH INTERFACES AT A RATE OF 0.25 - 0.50 GAL/SY. EMULSIFIED ASPHALT SHALL MEET THE REQUIREMENTS OF SECTION 404 AND WILL BE CONSIDERED INCIDENTAL TO SPECIAL PROVISION (BITUMINOUS CONCRETE PAVEMENT SURFACE PREPARATION, TYPE I)
2. ALL WORK ASSOCIATED WITH POT HOLE REPAIR WILL BE PAID UNDER ITEM 900.680 SPECIAL PROVISION (BITUMINOUS CONCRETE PAVEMENT SURFACE PREPARATION, TYPE I)

PROJECT NAME:	MANCHESTER-RUTLAND TOWN
PROJECT NUMBER:	NH SURF(50)
FILE NAME: p14v200.dgn	PLOT DATE: 1/14/2016
PROJECT LEADER: M. FOWLER	DRAWN BY: B. KIPP
DESIGNED BY: B. KIPP	CHECKED BY: M. FOWLER
DETAIL SHEET 3	SHEET II OF 105